

MAY 23 2006

Form C-1
December 2002

For KCC Use: 52806
Effective Date: _____
District # 3
SGA? Yes No

KANSAS CORPORATION COMMISSION
OIL & GAS CONSERVATION DIVISION

Form must be Typed
CONSERVATION DIVISION
WICHITA, KS All blanks must be Filled

NOTICE OF INTENT TO DRILL

Must be approved by KCC five (5) days prior to commencing well

Expected Spud Date May 29, 2006
month day year

Spot _____ NE _____ SE _____ Sec. 31 Twp. 28 S. R. 15 East West

OPERATOR: License# 33344
Name: Quest Cherokee LLC
Address: 9520 North May Avenue, Suite 300
City/State/Zip: Oklahoma City, Oklahoma 73120
Contact Person: Richard Martin
Phone: (405) 286-9316

1980 _____ feet from N / S Line of Section
660 _____ feet from E / W Line of Section

Is SECTION Regular Irregular?

(Note: Locate well on the Section Plat on reverse side)

CONTRACTOR: License# Will be licensed by the KCC
Name: Will advise on the ACO-1

County: Wilson
Lease Name: Timmons, Nancy Well #: 31-1
Field Name: Cherokee Basin CBM

Is this a Prorated / Spaced Field? Yes No

Target Formation(s): Cherokee Coals

Nearest Lease or unit boundary: 660

Ground Surface Elevation: 920 feet MSL

Water well within one-quarter mile: Yes No

Public water supply well within one mile: Yes No

Depth to bottom of fresh water: 100

Depth to bottom of usable water: 200

Surface Pipe by Alternate: 1 2

Length of Surface Pipe Planned to be set: 25

Length of Conductor Pipe required: _____

Projected Total Depth: 1500

Formation at Total Depth: Cherokee Coals

Water Source for Drilling Operations:

Well Farm Pond Other Air

DWR Permit #: _____

(Note: Apply for Permit with DWR)

Will Cores be taken? Yes No

If Yes, proposed zone: _____

Well Drilled For: Well Class: Type Equipment:

- | | | | |
|---|-----------------------------------|---|--|
| <input type="checkbox"/> Oil | <input type="checkbox"/> Enh Rec | <input checked="" type="checkbox"/> Infield | <input type="checkbox"/> Mud Rotary |
| <input checked="" type="checkbox"/> Gas | <input type="checkbox"/> Storage | <input type="checkbox"/> Pool Ext. | <input checked="" type="checkbox"/> Air Rotary |
| <input type="checkbox"/> QWO | <input type="checkbox"/> Disposal | <input type="checkbox"/> Wildcat | <input type="checkbox"/> Cable |
| <input type="checkbox"/> Seismic; _____ # of Holes | <input type="checkbox"/> Other | | |
| <input checked="" type="checkbox"/> Other Coalbed Methane | | | |

If OWWO: old well information as follows:

Operator: _____

Well Name: _____

Original Completion Date: _____ Original Total Depth: _____

Directional, Deviated or Horizontal wellbore? Yes No

If Yes, true vertical depth: _____

Bottom Hole Location: _____

KCC DKT #: _____

AFFIDAVIT

The undersigned hereby affirms that the drilling, completion and eventual plugging of this well will comply with K.S.A. 55 et. seq.

It is agreed that the following minimum requirements will be met:

1. Notify the appropriate district office **prior** to spudding of well;
2. A copy of the approved notice of intent to drill **shall be** posted on each drilling rig;
3. The minimum amount of surface pipe as specified below **shall be set** by circulating cement to the top; in all cases surface pipe **shall be set** through all unconsolidated materials plus a minimum of 20 feet into the underlying formation.
4. If the well is dry hole, an agreement between the operator and the district office on plug length and placement is necessary **prior to plugging**;
5. The appropriate district office will be notified before well is either plugged or production casing is cemented in;
6. If an ALTERNATE II COMPLETION, production pipe shall be cemented from below any usable water to surface within **120 days** of spud date.
Or pursuant to Appendix "B" - Eastern Kansas surface casing order #133,891-C, which applies to the KCC District 3 area, alternate II cementing must be completed within 30 days of the spud date or the well shall be plugged. **In all cases, NOTIFY district office** prior to any cementing.

I hereby certify that the statements made herein are true and to the best of my knowledge and belief.

Date: 5/22/2006 Signature of Operator or Agent: Richard Martin Title: VP

For KCC Use ONLY

API # 15 - 205-26675-0000

Conductor pipe required None feet

Minimum surface pipe required 20 feet per Alt. X2

Approved by: RH 5-23-06

This authorization expires: 11-23-06
(This authorization void if drilling not started within 6 months of approval date.)

Spud date: _____ Agent: _____

Remember to:

- File Drill Pit Application (form CDP-1) with Intent to Drill;
- File Completion Form ACO-1 within 120 days of spud date;
- File acreage attribution plat according to field proration orders;
- Notify appropriate district office 48 hours prior to workover or re-entry;
- Submit plugging report (CP-4) after plugging is completed;
- Obtain written approval before disposing or injecting salt water.
- If this permit has expired (See: authorized expiration date) please check the box below and return to the address below.

Well Not Drilled - Permit Expired

Signature of Operator or Agent: _____

Date: _____

31
28
JSE

IN ALL CASES PLOT THE INTENDED WELL ON THE PLAT BELOW

Plat of acreage attributable to a well in a prorated or spaced field

If the Intended well is in a prorated or spaced field, please fully complete this side of the form. If the intended well is in a prorated or spaced field complete the plat below showing that the well will be properly located in relationship to other wells producing from the common source of supply. Please show all the wells and within 1 mile of the boundaries of the proposed acreage attribution unit for gas wells and within 1/2 mile of the boundaries of the proposed acreage attribution unit for oil wells.

API No. 15 - 205-26675-0000
 Operator: Quest Cherokee LLC
 Lease: Timmons, Nancy
 Well Number: 31-1
 Field: Cherokee Basin CBM

Number of Acres attributable to well: _____
 QTR / QTR / QTR of acreage: _____ - NE - SE

Location of Well: County: Wilson
 1980 _____ feet from N / S Line of Section
 660 _____ feet from E / W Line of Section
 Sec. 31 Twp. 28 S. R. 15 East West

Is Section: Regular or Irregular

If Section is Irregular, locate well from nearest corner boundary.

Section corner used: NE NW SE SW

PLAT

(Show location of the well and shade attributable acreage for prorated or spaced wells.)

(Show footage to the nearest lease or unit boundary line.)

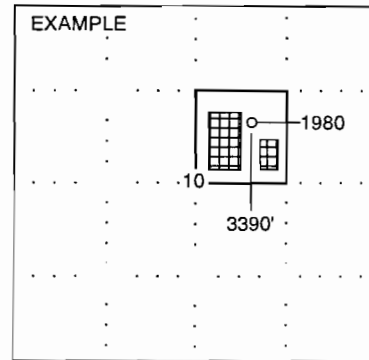
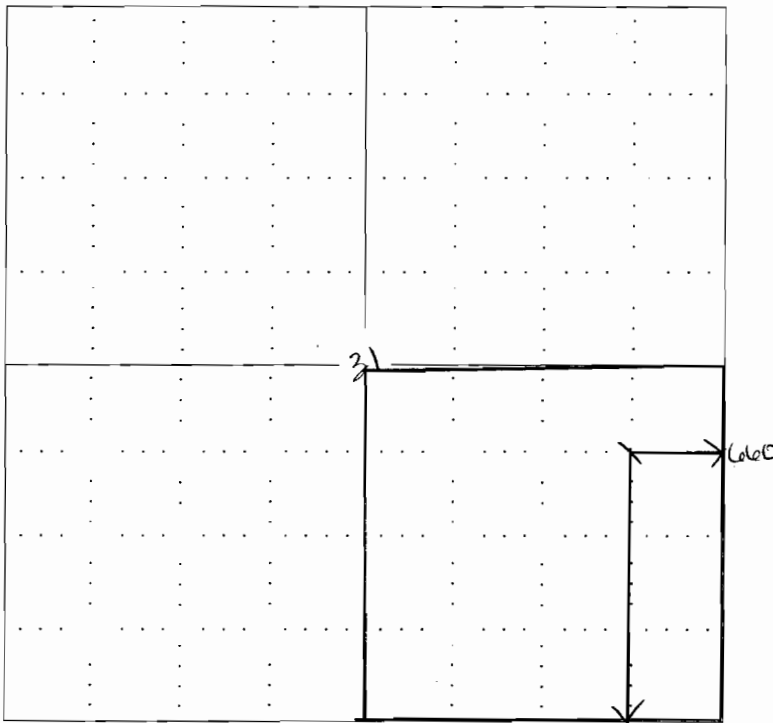

NOTE: In all cases locate the spot of the proposed drilling location.

In plotting the proposed location of the well, you must show:

1. The manner in which you are using the depicted plat by identifying section lines, i.e. 1 section, 1 section with 8 surrounding sections, 4 sections, etc.
2. The distance of the proposed drilling location from the section's south / north and east / west.
3. The distance to the nearest lease or unit boundary line.
4. If proposed location is located within a prorated or spaced field a certificate of acreage attribution plat must be attached: (CO-7 for oil wells; CG-8 for gas wells).

KANSAS CORPORATION COMMISSION
OIL & GAS CONSERVATION DIVISION
APPLICATION FOR SURFACE PIT

MAY 23 2006
Form CDP-1
April 2004
CONSERVATION DIVISION must be Typed
WICHITA, KS

Submit in Duplicate

Operator Name: Quest Cherokee LLC License Number: 33344

Operator Address: 9520 North May Avenue, Suite 300 Oklahoma City, Oklahoma 73120

Contact Person: Richard Marlin Phone Number: (405) 286 - 9316

Lease Name & Well No.: Timmons, Nancy #31-1 Pit Location (QQQQ):

Type of Pit: [] Emergency Pit [] Burn Pit [] Settling Pit [x] Drilling Pit [] Workover Pit [] Haul-Off Pit (If WP Supply API No. or Year Drilled) Pit is: [x] Proposed [] Existing If Existing, date constructed: Pit capacity: 300 (bbls) Sec. 31 Twp. 28 R. 15 [x] East [] West 1980 Feet from [] North / [x] South Line of Section 660 Feet from [x] East / [] West Line of Section Wilson County

Is the pit located in a Sensitive Ground Water Area? [] Yes [x] No Chloride concentration: mg/l (For Emergency Pits and Settling Pits only)

Is the bottom below ground level? [] Yes [x] No Artificial Liner? [] Yes [x] No How is the pit lined if a plastic liner is not used?

Pit dimensions (all but working pits): 30 Length (feet) 10 Width (feet) N/A: Steel Pits Depth from ground level to deepest point: 10 (feet)

If the pit is lined give a brief description of the liner material, thickness and installation procedure. Describe procedures for periodic maintenance and determining liner integrity, including any special monitoring. Air Drilling Operation lasting approx 3 days

Distance to nearest water well within one-mile of pit N/A feet Depth of water well feet Depth to shallowest fresh water feet. Source of information: measured well owner electric log KDWR

Emergency, Settling and Burn Pits ONLY: Producing Formation: Number of producing wells on lease: Barrels of fluid produced daily: Does the slope from the tank battery allow all spilled fluids to flow into the pit? [] Yes [] No Drilling, Workover and Haul-Off Pits ONLY: Type of material utilized in drilling/workover: Air Drilled Number of working pits to be utilized: One Abandonment procedure: Air Dry, Back Fill and Cover Drill pits must be closed within 365 days of spud date.

I hereby certify that the above statements are true and correct to the best of my knowledge and belief. 5/22/06 Date Richard Marlin Signature of Applicant or Agent

KCC OFFICE USE ONLY Date Received: 5/23/06 Permit Number: Permit Date: 5/23/06 Lease Inspection: [] Yes [x] No

15-205-21675-0000