

RECEIVED

MAY 26 2006

Form C-1

December 2002

For KCC Use: 6-4-06
Effective Date:
District #: 3
SGA? Yes No

KANSAS CORPORATION COMMISSION
OIL & GAS CONSERVATION DIVISION

NOTICE OF INTENT TO DRILL

Must be approved by KCC five (5) days prior to commencing well

KCC WICHITA
Form must be Signed
All blanks must be Filled

Expected Spud Date June 1, 2006
month day year

OPERATOR: License# 33344
Name: Quest Cherokee LLC
Address: 9520 North May Avenue, Suite 300
City/State/Zip: Oklahoma City, Oklahoma 73120
Contact Person: Richard Marlin
Phone: (405) 286-9316

CONTRACTOR: License# Will be licensed by the KCC
Name: Will advise on the ACO-1

Well Drilled For: Oil, Gas, OWWO, Seismic, Other
Well Class: Enh Rec, Storage, Disposal, Wildcat, Other
Type Equipment: Infield, Pool Ext, Wildcat, Mud Rotary, Air Rotary, Cable

If OWWO: old well information as follows:
Operator:
Well Name:
Original Completion Date:
Original Total Depth:

Directional, Deviated or Horizontal wellbore?
If Yes, true vertical depth:
Bottom Hole Location:
KCC DKT #:

Spot NE SW Sec. 32 Twp. 28 S. R. 15
1980 feet from N / S Line of Section
1980 feet from E / W Line of Section
Is SECTION Regular Irregular?

(Note: Locate well on the Section Plat on reverse side)

County: Wilson
Lease Name: Clary, Irene Well #: 32-1
Field Name: Cherokee Basin CBM

Is this a Prorated / Spaced Field?
Target Formation(s): Cherokee Coals

Nearest Lease or unit boundary: 660
Ground Surface Elevation: 932 feet MSL

Water well within one-quarter mile:
Public water supply well within one mile:

Depth to bottom of fresh water: 100
Depth to bottom of usable water: 200

Surface Pipe by Alternate: 1 2
Length of Surface Pipe Planned to be set: 25

Length of Conductor Pipe required:
Projected Total Depth: 1500

Formation at Total Depth: Cherokee Coals
Water Source for Drilling Operations: Well Farm Pond Other Air

DWR Permit #:
Will Cores be taken?
If Yes, proposed zone:

(Note: Apply for Permit with DWR)

AFFIDAVIT

The undersigned hereby affirms that the drilling, completion and eventual plugging of this well will comply with K.S.A. 55 et. seq.

It is agreed that the following minimum requirements will be met:

- 1. Notify the appropriate district office prior to spudding of well;
2. A copy of the approved notice of intent to drill shall be posted on each drilling rig;
3. The minimum amount of surface pipe as specified below shall be set by circulating cement to the top; in all cases surface pipe shall be set through all unconsolidated materials plus a minimum of 20 feet into the underlying formation.
4. If the well is dry hole, an agreement between the operator and the district office on plug length and placement is necessary prior to plugging;
5. The appropriate district office will be notified before well is either plugged or production casing is cemented in;
6. If an ALTERNATE II COMPLETION, production pipe shall be cemented from below any usable water to surface within 120 days of spud date. Or pursuant to Appendix "B" - Eastern Kansas surface casing order #133,891-C, which applies to the KCC District 3 area, alternate II cementing must be completed within 30 days of the spud date or the well shall be plugged. In all cases, NOTIFY district office prior to any cementing.

I hereby certify that the statements made herein are true and to the best of my knowledge and belief.

Date: 5/25/2006 Signature of Operator or Agent: Richard Marlin Title: VP

For KCC Use ONLY
API # 15 - 205-26692-0000
Conductor pipe required None feet
Minimum surface pipe required 20 feet per Alt.
Approved by: RHM 5-30-06
This authorization expires: 11-30-06
Spud date: Agent:

Remember to:

- File Drill Pit Application (form CDP-1) with Intent to Drill;
- File Completion Form ACO-1 within 120 days of spud date;
- File acreage attribution plat according to field proration orders;
- Notify appropriate district office 48 hours prior to workover or re-entry;
- Submit plugging report (CP-4) after plugging is completed;
- Obtain written approval before disposing or injecting salt water.
- If this permit has expired (See: authorized expiration date) please check the box below and return to the address below.

Well Not Drilled - Permit Expired
Signature of Operator or Agent:
Date:

Mail to: KCC - Conservation Division, 130 S. Market - Room 2078, Wichita, Kansas 67202

32 28 15E

**IN ALL CASES PLOT THE INTENDED WELL ON THE PLAT BELOW**

*Plat of acreage attributable to a well in a prorated or spaced field*

**If the intended well is in a prorated or spaced field, please fully complete this side of the form.** If the intended well is in a prorated or spaced field complete the plat below showing that the well will be properly located in relationship to other wells producing from the common source of supply. Please show all the wells and within 1 mile of the boundaries of the proposed acreage attribution unit for gas wells and within 1/2 mile of the boundaries of the proposed acreage attribution unit for oil wells.

API No. 15 205-26692-000  
Operator: Quest Cherokee LLC  
Lease: Clary, Irene  
Well Number: 32-1  
Field: Cherokee Basin CBM

Location of Well: County: Wilson  
1980 \_\_\_\_\_ feet from  N /  S Line of Section  
1980 \_\_\_\_\_ feet from  E /  W Line of Section  
Sec. 32 Twp. 28 S. R. 15  East  West

Number of Acres attributable to well: \_\_\_\_\_  
QTR / QTR / QTR of acreage: \_\_\_\_\_ - NE - SW

Is Section:  Regular or  Irregular

**If Section is Irregular, locate well from nearest corner boundary.**

Section corner used:  NE  NW  SE  SW

**PLAT**

*(Show location of the well and shade attributable acreage for prorated or spaced wells.)*

*(Show footage to the nearest lease or unit boundary line.)*

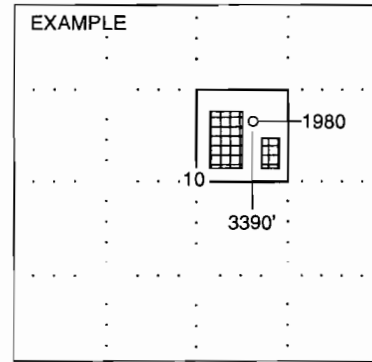
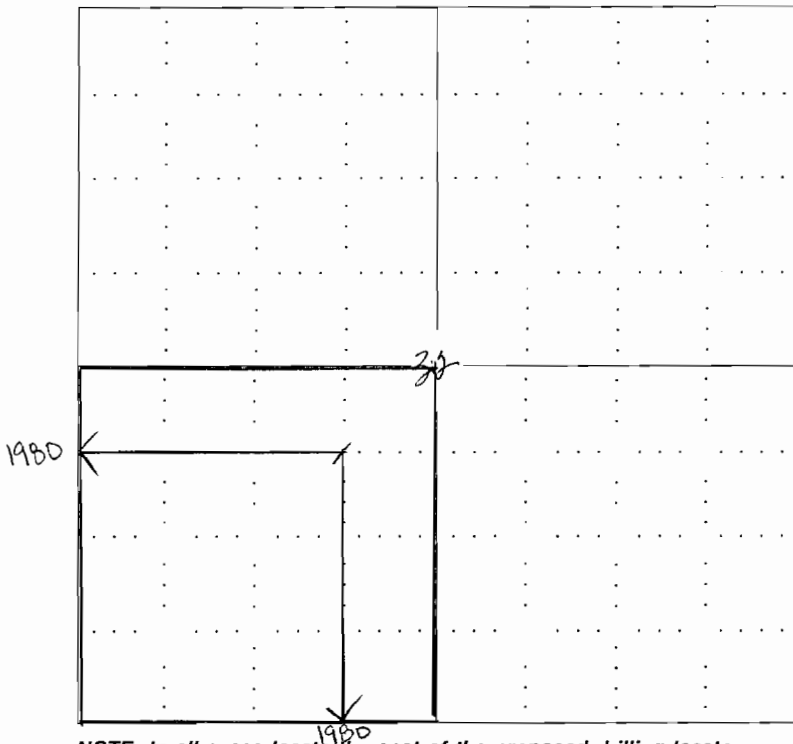

**NOTE: In all cases locate the spot of the proposed drilling location.**

**In plotting the proposed location of the well, you must show:**

1. The manner in which you are using the depicted plat by identifying section lines, i.e. 1 section, 1 section with 8 surrounding sections, 4 sections, etc.
2. The distance of the proposed drilling location from the section's south / north and east / west.
3. The distance to the nearest lease or unit boundary line.
4. If proposed location is located within a prorated or spaced field a certificate of acreage attribution plat must be attached: (CO-7 for oil wells; CG-8 for gas wells).

KANSAS CORPORATION COMMISSION  
OIL & GAS CONSERVATION DIVISION  
APPLICATION FOR SURFACE PIT

RECEIVED

Form CDP-1  
April 2004  
Form must be Typed

MAY 26 2006

KCC WICHITA

Submit in Duplicate

Operator Name: <b>Quest Cherokee LLC</b>		License Number: <b>33344</b>
Operator Address: <b>9520 North May Avenue, Suite 300 Oklahoma City, Oklahoma 73120</b>		
Contact Person: <b>Richard Marlin</b>		Phone Number: ( <b>405</b> ) <b>286 - 9316</b>
Lease Name & Well No.: <b>Clary, Irene #32-1</b>		Pit Location (QQQQ): _____ - _____ - <u>NE</u> - <u>SW</u> Sec. <u>32</u> Twp. <u>28</u> R. <u>15</u> <input checked="" type="checkbox"/> East <input type="checkbox"/> West 1980 Feet from <input type="checkbox"/> North / <input checked="" type="checkbox"/> South Line of Section 1980 Feet from <input type="checkbox"/> East / <input checked="" type="checkbox"/> West Line of Section <b>Wilson</b> County
Type of Pit: <input type="checkbox"/> Emergency Pit <input type="checkbox"/> Burn Pit <input type="checkbox"/> Settling Pit <input checked="" type="checkbox"/> Drilling Pit <input type="checkbox"/> Workover Pit <input type="checkbox"/> Haul-Off Pit <small>(If WP Supply API No. or Year Drilled)</small>	Pit is: <input checked="" type="checkbox"/> Proposed <input type="checkbox"/> Existing If Existing, date constructed: _____ Pit capacity: <u>300</u> (bbls)	
Is the pit located in a Sensitive Ground Water Area? <input type="checkbox"/> Yes <input checked="" type="checkbox"/> No		Chloride concentration: _____ mg/l <small>(For Emergency Pits and Settling Pits only)</small>
Is the bottom below ground level? <input type="checkbox"/> Yes <input checked="" type="checkbox"/> No	Artificial Liner? <input type="checkbox"/> Yes <input checked="" type="checkbox"/> No	How is the pit lined if a plastic liner is not used?
Pit dimensions (all but working pits): <u>30</u> Length (feet) <u>10</u> Width (feet) _____ N/A: Steel Pits Depth from ground level to deepest point: <u>10</u> (feet)		
If the pit is lined give a brief description of the liner material, thickness and installation procedure.		Describe procedures for periodic maintenance and determining liner integrity, including any special monitoring. <b>Air Drilling Operation lasting approx 3 days</b>
Distance to nearest water well within one-mile of pit <u>N/A</u> feet Depth of water well _____ feet	Depth to shallowest fresh water _____ feet. Source of information: _____ measured _____ well owner _____ electric log _____ KDWR	
<b>Emergency, Settling and Burn Pits ONLY:</b> Producing Formation: _____ Number of producing wells on lease: _____ Barrels of fluid produced daily: _____ Does the slope from the tank battery allow all spilled fluids to flow into the pit? <input type="checkbox"/> Yes <input type="checkbox"/> No	<b>Drilling, Workover and Haul-Off Pits ONLY:</b> Type of material utilized in drilling/workover: <u>Air Drilled</u> Number of working pits to be utilized: <u>One</u> Abandonment procedure: <u>Air Dry, Back Fill and Cover</u> Drill pits must be closed within 365 days of spud date.	
I hereby certify that the above statements are true and correct to the best of my knowledge and belief.  <u>5/25/2006</u> Date <u>Richard Marlin</u> Signature of Applicant or Agent		

15-205-26692-0000

KCC OFFICE USE ONLY			
Date Received: <u>5/26/06</u>	Permit Number: _____	Permit Date: <u>5/26/06</u>	Lease Inspection: <input type="checkbox"/> Yes <input checked="" type="checkbox"/> No

Mail to: KCC - Conservation Division, 130 S. Market - Room 2078, Wichita, Kansas 67202