

RECEIVED

MAR 27 2005

KCC WICHITA

KANSAS DRILLERS LOG

API No. 15 — 129 — 20321-0020
County Number

S. 24 T. 34 R. 42 K W
Loc. 1250' FSL, 2590' FEL
County Morton

Operator
Cities Service Company

Address
3545 N. W. 58th Street, Oklahoma City, Ok 72112

Well No. **2** Lease Name **Brown F**

Footage Location
1250 feet from **OSIX** (S) line **2590** feet from (E) **OSIX** line

Principal Contractor **Wakefield Drilling Company** Geologist

Spud Date **9-22-77** Total Depth **3320** P.B.T.D. **3286**

Date Completed **11-14-77** Oil Purchaser **KCC ops**

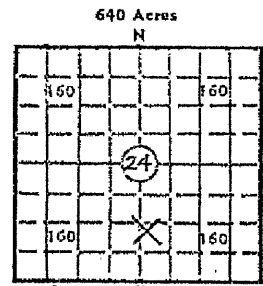

Elev.: Gr. **3479**
DF **3486** KB **3487**

CASING RECORD

Report of all strings set — surface, intermediate, production, etc.

| Purpose of string | Size hole drilled | Size casing set (in O.D.) | Weight lbs/ft. | Setting depth | Type cement | Sacks | Type and percent additives |
|-------------------|-------------------|---------------------------|----------------|---------------|--|-------|----------------------------|
| Surface | 12 1/4 | 8-5/8 | 24 | 747 | 250 sx Lite w/2% CaCl ₂ , 1/2# Flocele; 200 sx Class H w/2% CaCl ₂ & 1/2# Flocele. | | |
| Production | 7-7/8 | 5 1/2 | 14 | 3319 | 75 sx Howco Lite, 1/2# Flocele, .8% CRF-2; 100 sx 50/50 Pozmix, 10% salt, 1/2# Flocele, .8% CRF-2. | | |

LINER RECORD

PERFORATION RECORD

| Top, ft. | Bottom, ft. | Sacks cement | Shots per ft. | Size & type | Depth interval |
|----------|-------------|--------------|---------------|-------------|----------------|
| | | | 2 | .57 Jet | 3044-48 |
| | | | 2 | .57 Jet | 3118-30 |

TUBING RECORD

| Size | Setting depth | Packer set at |
|-------|---------------|---------------|
| 2-3/8 | 3262 | |

ACID, FRACTURE, SHOT, CEMENT SQUEEZE RECORD

| Amount and kind of material used | Depth interval treated |
|---|------------------------|
| Acidized Upper Topeka 3044-48 w/750 gals 15% HCL containing 2 gals J-4 & 8 gals J-7 | 3044-48 |
| Acidized Lower Topeka 3118-30 w/2000 gals 15% HCL containing 4 gals J-4 & 20 gals J-5. | 3118-30 |
| Acidized Topeka 3044-3130 w/7500 gals Sta-Live acid containing 26 gals G-10. Flushed w/74 bbls 1% KCLW w/1/2# Gal G-10W | 3044-3130 |

(Continued on backside)

INITIAL PRODUCTION

Date of first production **10-16-77** Producing method (flowing, pumping, gas lift, etc.) **Flowing**

RATE OF PRODUCTION PER 24 HOURS
Oil bbls. **CAOF 2811** Gas MCF **2811** Water bbls. **2811** Gas-oil ratio **CFPB**

Disposition of gas (vented, used on lease or sold) **To Be Sold** Producing interval(s) **3044-48 & 3118-30**

INSTRUCTIONS: As provided in KCC Rule 82-2-125, within 90 days after completion of a well, one completed copy of this Drillers Log shall be transmitted to the State Geological Survey of Kansas, 4150 Monroe Street, Wichita, Kansas 67209. Copies of this form are available from the Conservation Division, State Corporation Commission, 3830 So. Meridian (P.O. Box 17027), Wichita, Kansas 66217. Phone AC 316-522-2206. If confidential custody is desired, please note Rule 82-2-125. Drillers Logs will be an open file in the Oil and Gas Division, State Geological Survey of Kansas, Lawrence, Kansas 66044.

RECEIVED

MAR 27 2006

Operator

Cities Service Company

DESIGNATE TYPE OF COMP.: OIL, GAS, DRY HOLE, SWDW, ETC.:

Gas

Well No.

2

Lease Name

Brown F

KCC WICHITA

S 24 T 34 R 42 W

WELL LOG

Show all important zones of porosity and contents thereof; cored intervals, and all drill-stem tests, including depth interval tested, cushion used, time tool open, flowing and shut-in pressures, and recoveries.

SHOW GEOLOGICAL MARKERS, LOGS RUN, OR OTHER DESCRIPTIVE INFORMATION.

| FORMATION DESCRIPTION, CONTENTS, ETC. | TOP | BOTTOM | NAME | DEPTH | |
|---------------------------------------|------|--------|---|--|--|
| Sand & Clay | 0 | 245 | Logging: Simultaneous Dual Laterolog. Micro SFL & Simultaneous Compensated Neutron Formation Density W/ Gamma Ray & Caliper from 748 to 3319. | | |
| Red Bed & Gyp | 245 | 748 | | | |
| Red Bed | 748 | 1010 | | | |
| Sand | 1010 | 1240 | | | |
| Red Bed & Anhydrite | 1240 | 1595 | | | |
| Shale & Anhydrite | 1595 | 1890 | | | |
| Shale | 1890 | 2135 | | | |
| Shale & Lime | 2135 | 2470 | | | |
| Lime & Shale | 2470 | 2610 | | Welex Cement Bond & Collar Correlation Ldg from 2300-3284. | |
| Shale & Lime | 2610 | 2885 | | | |
| Lime & Shale | 2885 | 2995 | | | |
| Lime | 2995 | 3220 | | | |
| Lime & Shale | 3220 | 3320 | | | |
| Total Depth | | 3320 | | | |
| PBTD | | 3286 | | | |

ACID TREATMENT:

Acidized Topeka 3044-3130' w/2000 gals 7 1/2% WA (mud clean up acid) containing 6 gals J-45 (low surface tension material) & 100 gals J-40 (Mutual solvent.)
 Flushed w/59 bbls 2% KCLW w/first 20 bbls containing 2% gals J-45 & 42 gals J-40.
 Next 39 bbls containing 5 gals J-45.

USE ADDITIONAL SHEETS, IF NECESSARY, TO COMPLETE WELL RECORD.

Date Received

W. A. Givens

W. A. Givens

Signature

Engineering Manager

Title

November 23, 1977

Date



RECEIVED
MAR 27 2006
KCC WICHITA

CITIES SERVICE COMPANY
ENERGY RESOURCES GROUP

Dan H. Leininger Bldg.
3545 N. W. 58th Street
Oklahoma City, Oklahoma 73112
(405) 943-9511

November 23, 1977

Kansas State Corporation Commission
Conservation Division
245 North Water
Wichita, Kansas 67202

Kansas Geological Survey
4150 Monroe Street
Wichita, Kansas 67209

RE: Brown F-2
Section 24-34S-42W
Morton County, Kansas

Gentlemen:

Please find attached the well completion records required by your office for our recently drilled and completed Brown F, No.2, Greenwood Field, Topeka Formation gas well.

If additional information is needed, please advise.

Very truly yours,

D. B. Codner
Supervisor, Oil & Gas Systems
Mid-Continent South Region

DBC/dsg
Attachment

File

RECEIVED
MAR 27 2005
KCC WICHITA



CITIES SERVICE COMPANY
ENERGY RESOURCES GROUP

Dan H. Leininger Bldg.
3545 N. W. 58th Street
Oklahoma City, Oklahoma 73112
(405) 943-9511

November 23, 1977

Colorado Interstate Gas Company
Box 1087
Colorado Springs, Colorado 80944

Attn: Rex Fowler

RE: Brown F-2
Section 24-34S-42W
Morton County, Kansas

Gentlemen:

Please find attached the well completion records required by your office for our recently completed Brown "F" #2, Greenwood Field Gas Well. This information is forwarded to you for purposes of arranging the connection.

If additional information is needed, please advise.

Very truly yours,

D. B. Codner
Supervisor - Oil & Gas Systems
Mid-Continent South Region

DBC/dsg

Attachment

cc: File