

OWWO

RECEIVED  
KANSAS CORPORATION COMMISSION

MAY 22 2006

Form C-1

December 2002

Form must be Typed

Form must be Signed

Blank must be Filled

For KCC Use:  
Effective Date: 6-5-06  
District # 4  
SGA?  Yes  No

KANSAS CORPORATION COMMISSION  
OIL & GAS CONSERVATION DIVISION  
NOTICE OF INTENT TO DRILL

Must be approved by KCC five (5) days prior to commencing well

CONSERVATION DIVISION  
WICHITA, KS

Expected Spud Date May 30, 2006  
month day year

Spot  East  
NE - NW - SE Sec. 15 Twp. 9 S. R. 19  West

OPERATOR: License# 30598  
Name: Habit Petroleum, LLC.  
Address: 639 280th Ave.  
City/State/Zip: Hays, Ks 67601  
Contact Person: Irvin E. Haselhorst  
Phone: 785-625-6190

2,310 feet from  N /  S Line of Section  
1,650 feet from  E /  W Line of Section  
Is SECTION  Regular  Irregular?

(Note: Locate well on the Section Plat on reverse side)

CONTRACTOR: License# 33346  
Name: Alliance Well Service, Inc.  
TR Service and Rental Inc.

County: Rooks  
Lease Name: Nech Well #: 4  
Field Name: Jelinek

Is this a Prorated / Spaced Field?  Yes  No  
Target Formation(s): Arbuckle

Well Drilled For: Well Class: Type Equipment:  
 Oil  Enh Rec  Infield  Mud Rotary  
 Gas  Storage  Pool Ext.  Air Rotary  
 OWWO  Disposal  Wildcat  Cable  
 Seismic; # of Holes  Other  
 Other

Nearest Lease or unit boundary: 1,650'  
Ground Surface Elevation: 2,077' feet MSL

Water well within one-quarter mile:  Yes  No  
Public water supply well within one mile:  Yes  No

Depth to bottom of fresh water: 180'  
Depth to bottom of usable water: 800'

Surface Pipe by Alternate:  2  
Length of Surface Pipe ~~Required to be set~~: 207' AH 2.

Length of Conductor Pipe required: none

Projected Total Depth: 3,350'

Formation at Total Depth: Arbuckle

Water Source for Drilling Operations:  
 Well  Farm Pond Other /

DWR Permit #: /  
(Note: Apply for Permit with DWR )

Will Cores be taken?  Yes  No  
If Yes, proposed zone: /

If OWWO: old well information as follows:  
Operator: Phillips Petroleum Co.  
Well Name: Nech #4  
Original Completion Date: 6-11-52 Original Total Depth: 3509'

Directional, Deviated or Horizontal wellbore?  Yes  No

If Yes, true vertical depth: \_\_\_\_\_

Bottom Hole Location: \_\_\_\_\_

KCC DKT #: \_\_\_\_\_

AFFIDAVIT

The undersigned hereby affirms that the drilling, completion and eventual plugging of this well will comply with K.S.A. 55 et. seq.

It is agreed that the following minimum requirements will be met:

1. Notify the appropriate district office **prior** to spudding of well;
2. A copy of the approved notice of intent to drill **shall be** posted on each drilling rig;
3. The minimum amount of surface pipe as specified below **shall be set** by circulating cement to the top; in all cases surface pipe **shall be set** through all unconsolidated materials plus a minimum of 20 feet into the underlying formation.
4. If the well is dry hole, an agreement between the operator and the district office on plug length and placement is necessary **prior to plugging**;
5. The appropriate district office will be notified before well is either plugged or production casing is cemented in;
6. If an ALTERNATE II COMPLETION, production pipe shall be cemented from below any usable water to surface within **120 days** of spud date.  
Or pursuant to Appendix "B" - Eastern Kansas surface casing order #133,891-C, which applies to the KCC District 3 area, alternate II cementing must be completed within 30 days of the spud date or the well shall be plugged. **In all cases, NOTIFY district office** prior to any cementing.

I hereby certify that the statements made herein are true and to the best of my knowledge and belief.

Date: 5-19-2006 Signature of Operator or Agent: Irvin E. Haselhorst Title: Owner

RECEIVED

MAY 30 2006

KCC WICHITA

For KCC Use ONLY

API # 15 - 163-02242-00-01

Conductor pipe required None feet

Minimum surface pipe required 207 feet per Alt.  2

Approved by: Ret 5-31-06

This authorization expires: 11-30-06

(This authorization void if drilling not started within 6 months of approval date.)

Spud date: \_\_\_\_\_ Agent: \_\_\_\_\_

Remember to:

- File Drill Pit Application (form CDP-1) with Intent to Drill;
  - File Completion Form ACO-1 within 120 days of spud date;
  - File acreage attribution plat according to field proration orders;
  - Notify appropriate district office 48 hours prior to workover or re-entry;
  - Submit plugging report (CP-4) after plugging is completed;
  - Obtain written approval before disposing or injecting salt water.
- If this permit has expired (See: authorized expiration date) please check the box below and return to the address below.

Well Not Drilled - Permit Expired

Signature of Operator or Agent: \_\_\_\_\_

Date: \_\_\_\_\_

Mail to: KCC - Conservation Division, 130 S. Market - Room 2078, Wichita, Kansas 67202

15  
9  
194

MAY 22 2006

IN ALL CASES PLOT THE INTENDED WELL ON THE PLAT BELOW

Plat of acreage attributable to a well in a prorated or spaced field

CONSERVATION DIVISION  
WICHITA, KS

If the intended well is in a prorated or spaced field, please fully complete this side of the form. If the intended well is in a prorated or spaced field complete the plat below showing that the well will be properly located in relationship to other wells producing from the common source of supply. Please show all the wells and within 1 mile of the boundaries of the proposed acreage attribution unit for gas wells and within 1/2 mile of the boundaries of the proposed acreage attribution unit for oil wells.

OLD WELL INFORMATION:

API No. 15 - 163-02242-00-01

Operator: Phillip Petroleum Co.

Lease: Nech

Well Number: 4

Field: Jelinek

Number of Acres attributable to well: \_\_\_\_\_

QTR / QTR / QTR of acreage: \_\_\_\_\_

Location of Well: County: Rooks

2,310 feet from  N /  S Line of Section

1,650 feet from  E /  W Line of Section

Sec. 15 Twp. 9 S. R. 19  East  West

Is Section:  Regular or  Irregular

If Section is Irregular, locate well from nearest corner boundary.

Section corner used:  NE  NW  SE  SW

PLAT

(Show location of the well and shade attributable acreage for prorated or spaced wells.)

(Show footage to the nearest lease or unit boundary line.)

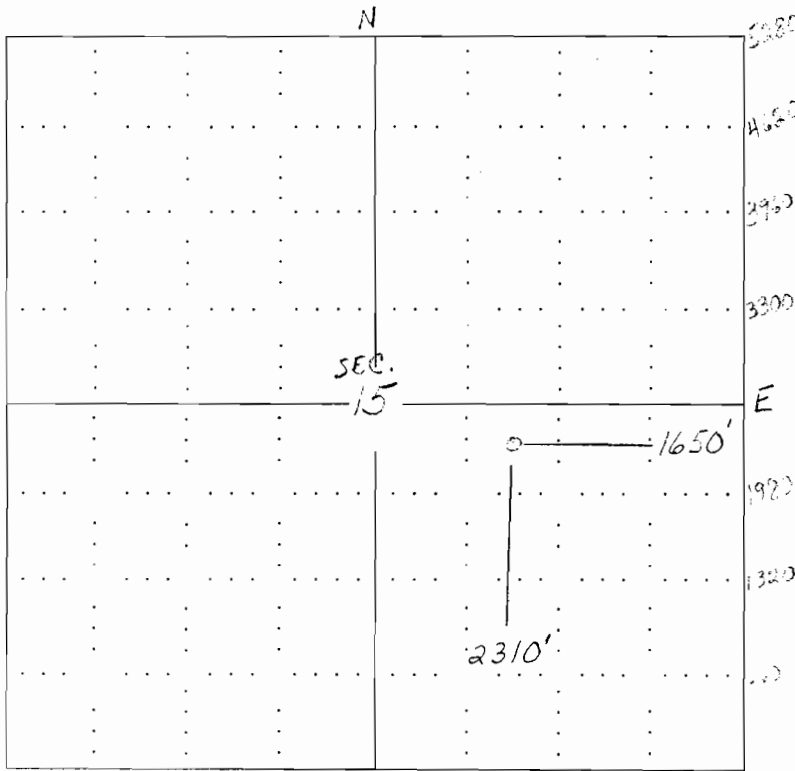

NOTE: In all cases locate the spot of the proposed drilling location.

RECEIVED  
MAY 30 2006  
KCC WICHITA

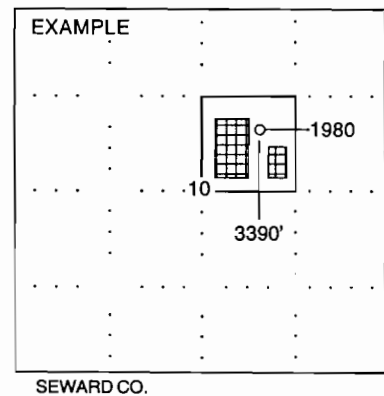

In plotting the proposed location of the well, you must show:

1. The manner in which you are using the depicted plat by identifying section lines, i.e. 1 section, 1 section with 8 surrounding sections, 4 sections, etc.
2. The distance of the proposed drilling location from the section's south / north and east / west.
3. The distance to the nearest lease or unit boundary line.
4. If proposed location is located within a prorated or spaced field a certificate of acreage attribution plat must be attached: (CO-7 for oil wells; CG-8 for gas wells).

MAY 22 2006

APPLICATION FOR SURFACE PIT CONSERVATION DIVISION  
WICHITA, KS

Submit in Duplicate

Operator Name: <u>Habit Petroleum, LLC</u>		License Number: <u>30598</u>
Operator Address: <u>639 280th Ave Hays, Ks 67601</u>		
Contact Person: <u>Irvin E. Haselhorst</u>		Phone Number: ( <u>785</u> ) <u>625 - 6190</u>
Lease Name & Well No.: <u>Nech #4</u>		Pit Location (QQQQ): <u>C - NE - NW - SE</u> Sec. <u>15</u> Twp. <u>9</u> R. <u>19</u> <input type="checkbox"/> East <input checked="" type="checkbox"/> West <u>2,310</u> Feet from <input type="checkbox"/> North / <input checked="" type="checkbox"/> South Line of Section <u>1,650</u> Feet from <input checked="" type="checkbox"/> East / <input type="checkbox"/> West Line of Section <u>Rooks</u> County
Type of Pit: <input type="checkbox"/> Emergency Pit <input type="checkbox"/> Burn Pit <input type="checkbox"/> Settling Pit <input checked="" type="checkbox"/> Drilling Pit <input checked="" type="checkbox"/> Workover Pit <input type="checkbox"/> Haul-Off Pit <small>(If WP Supply API No. or Year Drilled)</small> <u>API 15-163-02242</u>	Pit is: <input checked="" type="checkbox"/> Proposed <input type="checkbox"/> Existing If Existing, date constructed: _____ Pit capacity: <u>200</u> (bbls)	
Is the pit located in a Sensitive Ground Water Area? <input type="checkbox"/> Yes <input checked="" type="checkbox"/> No		Chloride concentration: _____ mg/l <small>(For Emergency Pits and Settling Pits only)</small>
Is the bottom below ground level? <input checked="" type="checkbox"/> Yes <input type="checkbox"/> No	Artificial Liner? <input checked="" type="checkbox"/> Yes <input type="checkbox"/> No	How is the pit lined if a plastic liner is not used?
Pit dimensions (all but working pits): <u>20'</u> Length (feet) <u>10</u> Width (feet) _____ N/A: <b>Steel Pits</b> Depth from ground level to deepest point: <u>5</u> (feet)		
If the pit is lined give a brief description of the liner material, thickness and installation procedure.  <u>10 mil plastic</u>		Describe procedures for periodic maintenance and determining liner integrity, including any special monitoring.  <u>Washdown should take two days.</u>
Distance to nearest water well within one-mile of pit <u>N/A</u> feet Depth of water well _____ feet		Depth to shallowest fresh water _____ feet. Source of information: _____ measured _____ well owner _____ electric log _____ KDWR
<b>Emergency, Settling and Burn Pits ONLY:</b> Producing Formation: _____ Number of producing wells on lease: _____ Barrels of fluid produced daily: _____ Does the slope from the tank battery allow all spilled fluids to flow into the pit? <input type="checkbox"/> Yes <input type="checkbox"/> No		<b>Drilling, Workover and Haul-Off Pits ONLY:</b> Type of material utilized in drilling/workover: <u>Fresh Water</u> Number of working pits to be utilized: <u>2</u> Abandonment procedure: <u>Empty pits and close</u> Drill pits must be closed within 365 days of spud date.
I hereby certify that the above statements are true and correct to the best of my knowledge and belief.  <u>5-19-2006</u> Date		RECEIVED MAY 30 2006 KCC WICHITA
		<u>Irvin E. Haselhorst</u> Signature of Applicant or Agent
<b>KCC OFFICE USE ONLY</b>		
Date Received: <u>5/30/06</u> Permit Number: _____ Permit Date: <u>5/30/06</u> Lease Inspection: <input type="checkbox"/> Yes <input checked="" type="checkbox"/> No		

Mail to: KCC - Conservation Division, 130 S. Market - Room 2078, Wichita, Kansas 67202

15-163-02242-00-01

15-163-02242-00-00

WELL PLUGGING RECORD

We All Information Completely  
 Make Required Affidavit

COUNTY Rooks SEC. 15 TWP. 9S RGE. 19 xR/W  
 Location as in quarters or footage from lines:  
330' ENL & 1650' FEL of SE/4

Lease Owner Phillips Petroleum Company  
 Lease Name Nech Well No. 4  
 Office Address Box 287, Great Bend, Kansas 67530  
 Character of Well (Completed as Oil, Gas or Dry Hole): Oil  
 Date Well Completed May 20, 1952  
 Application for plugging filed September 22, 1982  
 Plugging commenced October 20, 1982  
 Plugging completed October 20, 1982  
 Reason for abandonment of well or producing formation Depleted

Locate Well  
 correctly on above  
 Section Plat.

Was permission obtained from the Conservation Division or it's  
 Agent's before plugging was commenced? Yes

Name of Conservation Agent who supervised plugging of this well Dennis Hamel

Producing formation Arbuckle Depth to top 3506 bottom 3509 T.D. 3509

Show depth and thickness of all water, oil and gas formations.

OIL, GAS OR WATER RECORDS

Casing Record

Formation	Content	From	To	Size	Put in	Pulled Out
Surface	Water	0'	207'	8 5/8	210'	-0-
Production	Oil & Wtr	0'	3506'	5 1/2	3502'	-0-

Describe in detail the manner in which the well was plugged, indicating where the mud  
 fluid was placed and the method or methods used in introducing it into the hold. If cement  
 or other plugs were used, state the character of same and depth placed, from \_\_\_\_\_ feet  
 to \_\_\_\_\_ feet for each plug set. MIRU Halliburton to 5 1/2" csg & pmpd 25 sx 50-50  
Pozmix w/ 1/2 sk hulls, followed by 16 sx gel & 110 sx 50-50 Pozmix w/ 6% gel & 2 1/2 sx  
hulls. Press to 1000 PSI - press held. Conn to 8 5/8" & press to 200 PSI. Cut  
off pipe 4 1/2' below GL. Weld on plate. Well P&A 10-20-82

(If additional description is necessary, use BACK of this sheet)

Name of Plugging Contractor Halliburton Services  
Great Bend, Kansas

STATE OF Kansas COUNTY OF Barton, ss.  
C. D. Dohrer (employee of owner) or (owner or operator) of the  
 above-described well, being first duly sworn on oath, says: That I have knowledge of the  
 facts, statements, and matters herein contained and the log of the above-described well as  
 filed, and that the same are true and correct. So help me God.

(Signature) C. D. Dohrer Area Manager  
Box 287, Great Bend, Kansas 67530  
 (Address)

SUBSCRIBED AND SWORN TO before me this 22nd day of October, 19 82

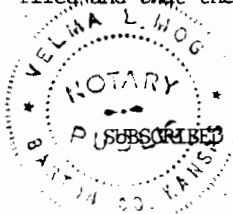

Velma L. Mog Notary Public  
 STATE CORPORATION COMMISSION

My Commission expires: February 15, 1984

OCT 26 1982

CONSERVATION DIVISION  
 Wichita, Kansas

STATE CORPORATION COMMISSION

CONSERVATION DIVISION AGENT REPORT

API Number 15-163-02242-0000

Colorado Derby Building  
Wichita, KS 67202

Operator's Full Name Phillips Petroleum Co.

Complete Address Box 387 Mt. Bond, Mo 67530

Lease Name Neck Well No. 4

Location NE-NW-SE Sec. 15 Twp. 9 Rge. 19 (East) (West)

County Rooks Total Depth 3509'

Abandoned Oil Well  Gas Well  Input Well  SWD Well  D&A

Other well as hereinafter indicated \_\_\_\_\_

Plugging Contractor Halliburton Cementing Co.

Address Ways, Kansas 67601 License No. \_\_\_\_\_

Operation Completed: Hour: 11:00 AM Day: 20 Month: 10 Year: 1982

Plugging Operations attended by Agent?: All  Part  None

The above well was plugged as follows:

8 5/8" @ 307' w/300 sv - 5 1/2" @ 3506 w/150 sv -  
2nd stage @ 307' w/375 sv cont. to surface  
Ordered 175 sv. 5% ca. 6% gel - 4 balls - 5 1/2" plug  
Injection 5 1/2" 10 cont -> 15 cont. 4 balls -> 16 gel -> Rel plug  
135 cont & Hook-up to 8 5/8" - pressured up:  
5 1/2" pressure 1000# P.S.I. 8 5/8" - 200# P.S.I. -

Amount of Surface Casing: 307'

I hereby certify that the above plugging instructions were given as herein stated.

Signed: Dennis R. Hamel  
Conservation Division Agent

I hereby state that I was not present while the above well was being plugged, however, to the best of my knowledge and belief it was plugged as herein stated. A full account for my not being present is as follows:

RECEIVED  
STATE CORPORATION COMMISSION

Signed: \_\_\_\_\_  
Conservation Division Agent  
Wichita, Kansas

OCT 26 1982

INVOICE  
11-5-82  
1500-W