

* Correction on Footage

RECEIVED

For KCC Use: Effective Date: 5-31-06 District # 2 SGA? Yes No

KANSAS CORPORATION COMMISSION OIL & GAS CONSERVATION DIVISION NOTICE OF INTENT TO DRILL

Form C-1 December 2002

JUN 01 2006 KCC WICHITA CORRECTED

Must be approved by KCC five (5) days prior to commencing well

Expected Spud Date June 5 2006 month day year

OPERATOR: License# 32802 Name: Bert Carlson Address: 1432 Nighthawk Road City/State/Zip: Yates Center, Ks. 66783 Contact Person: Bert Carlson Phone: 620-625-3307

CONTRACTOR: License# 33072 Name: Well Refined Drilling Co.

Spot N/2-SE-SW NE-SW Sec. 9 Twp. 33 S. R. 3 990 feet from N / S Line of Section 1980 feet from E / W Line of Section Is SECTION Regular Irregular?

(Note: Locate well on the Section Plat on reverse side)

County: Cowley Lease Name: McClung Well #: 9-1 Field Name: Rainbow Bend

Is this a Prorated / Spaced Field? Yes No Target Formation(s): Miss.

Nearest Lease or unit boundary: 990 ft. Ground Surface Elevation: feet MSL

Water well within one-quarter mile: Yes No Public water supply well within one mile: Yes No

Depth to bottom of fresh water: 100 Depth to bottom of usable water: 280

Surface Pipe by Alternate: 1 2 Length of Surface Pipe Planned to be set: 300 ft.

Length of Conductor Pipe required: Projected Total Depth: 3400 ft. Formation at Total Depth: Miss.

Water Source for Drilling Operations: Well Farm Pond Other DWR Permit #:

(Note: Apply for Permit with DWR)

Will Cores be taken? Yes No If Yes, proposed zone:

Table with columns: Well Drilled For, Well Class, Type Equipment. Includes checkboxes for Oil, Gas, OWWO, Seismic, Enh Rec, Storage, Disposal, Infield, Pool Ext, Wildcat, Other, Mud Rotary, Air Rotary, Cable.

If OWWO: old well information as follows: Operator: Well Name: Original Completion Date: Original Total Depth:

Directional, Deviated or Horizontal wellbore? Yes No If Yes, true vertical depth: Bottom Hole Location: KCC DKT #:

WAS: Add W/2-NE-NW-SE 2310' FSL 1720' FEL IS: N/2-SE-SW 990' FSL 1980' FWL

AFFIDAVIT

The undersigned hereby affirms that the drilling, completion and eventual plugging of this well will comply with K.S.A. 55 et. seq. It is agreed that the following minimum requirements will be met:

- 1. Notify the appropriate district office prior to spudding of well;
2. A copy of the approved notice of intent to drill shall be posted on each drilling rig;
3. The minimum amount of surface pipe as specified below shall be set by circulating cement to the top;
4. If the well is dry hole, an agreement between the operator and the district office on plug length and placement is necessary prior to plugging;
5. The appropriate district office will be notified before well is either plugged or production casing is cemented in;
6. If an ALTERNATE II COMPLETION, production pipe shall be cemented from below any usable water to surface within 120 days of spud date.

I hereby certify that the statements made herein are true and to the best of my knowledge and belief.

Date: 5/31/06 Signature of Operator or Agent: Albert J. Cooper Title: Agent

For KCC Use ONLY API # 15 - 035-24247-0000 Conductor pipe required None feet Minimum surface pipe required 300 feet per Alt. 1 Approved by: DPW 5-26-06/Ret 6-1-06 This authorization expires: 11-26-06 Spud date: Agent:

- Remember to: File Drill Pit Application (form CDP-1) with Intent to Drill; File Completion Form ACO-1 within 120 days of spud date; File acreage attribution plat according to field proration orders; Notify appropriate district office 48 hours prior to workover or re-entry; Submit plugging report (CP-4) after plugging is completed; Obtain written approval before disposing or injecting salt water.

Mail to: KCC - Conservation Division, 130 S. Market - Room 2078, Wichita, Kansas 67202

9 33 3E

RECEIVED
JUN 01 2006
KCC WICHITA

IN ALL CASES PLOT THE INTENDED WELL ON THE PLAT BELOW

Plat of acreage attributable to a well in a prorated or spaced field

If the intended well is in a prorated or spaced field, please fully complete this side of the form. If the intended well is in a prorated or spaced field complete the plat below showing that the well will be properly located in relationship to other wells producing from the common source of supply. Please show all the wells and within 1 mile of the boundaries of the proposed acreage attribution unit for gas wells and within 1/2 mile of the boundaries of the proposed acreage attribution unit for oil wells.

CORRECTED

API No. 15 - 035-24247-0000
Operator: Bert Carlson
Lease: McClung
Well Number: 9-1
Field: Rainbow Bend
Number of Acres attributable to well: _____
QTR / QTR / QTR of acreage: NE - SW - _____

Location of Well: County: Cowley
990 feet from N / S Line of Section
1980 feet from E / W Line of Section
Sec. 9 Twp. 33 S. R. 3 East West

Is Section: Regular or Irregular

If Section is Irregular, locate well from nearest corner boundary.

Section corner used: NE NW SE SW

PLAT

*(Show location of the well and shade attributable acreage for prorated or spaced wells.)
(Show footage to the nearest lease or unit boundary line.)*

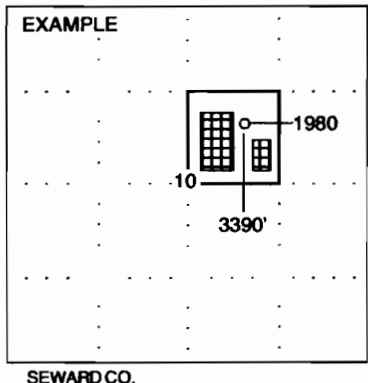
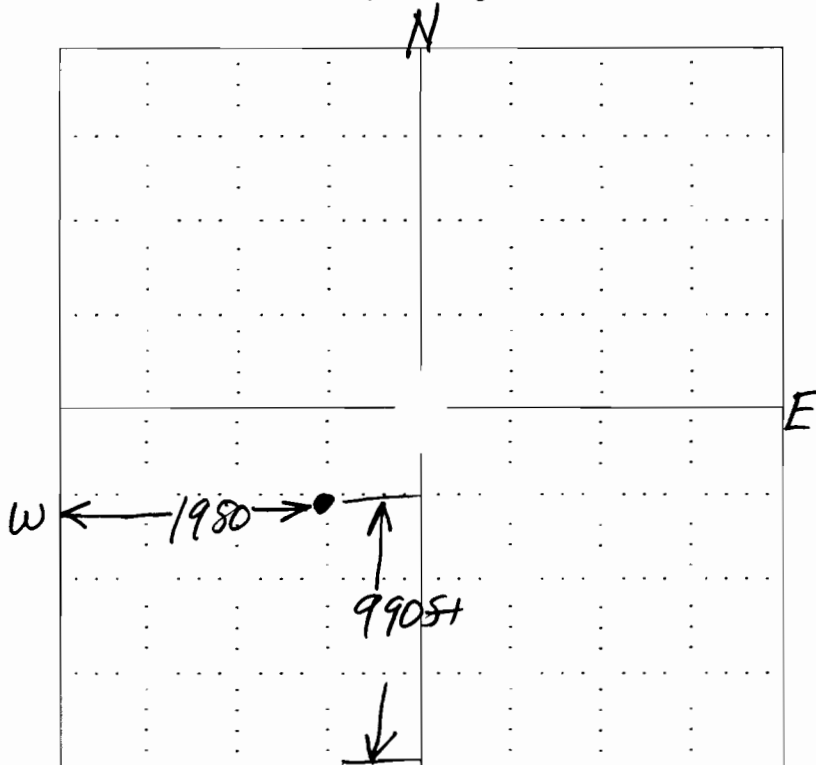

NOTE: In all cases locate the spot of the proposed drilling location.

In plotting the proposed location of the well, you must show:

1. The manner in which you are using the depicted plat by identifying section lines, i.e. 1 section, 1 section with 8 surrounding sections, 4 sections, etc.
2. The distance of the proposed drilling location from the section's south / north and east / west.
3. The distance to the nearest lease or unit boundary line.
4. If proposed location is located within a prorated or spaced field a certificate of acreage attribution plat must be attached: (CO-7 for oil wells; CG-8 for gas wells).

**Correction on Footage*
KANSAS CORPORATION COMMISSION
OIL & GAS CONSERVATION DIVISION
APPLICATION FOR SURFACE PIT

RECEIVED
JUN 01 2006
KCC WICHITA

Form GDP-1
 April 2004
 Form must be Typed

Submit in Duplicate

CORRECTED

Operator Name: Bert Carlson		License Number: 32802	
Operator Address: 1432 Nighthawk Road, Yates Center, Ks. 66783			
Contact Person: Bert Carlson		Phone Number: (620) 625 - 3307	
Lease Name & Well No.: McClung #9-1		Pit Location (QQQQ): NE - SW -	
Type of Pit: <input type="checkbox"/> Emergency Pit <input type="checkbox"/> Burn Pit <input type="checkbox"/> Settling Pit <input checked="" type="checkbox"/> Drilling Pit <input type="checkbox"/> Workover Pit <input type="checkbox"/> Haul-Off Pit (If WOP Supply API No. or Year Drilled)		Pit is: <input checked="" type="checkbox"/> Proposed <input type="checkbox"/> Existing If Existing, date constructed: _____ Pit capacity: 400 (bbls)	
Is the pit located in a Sensitive Ground Water Area? <input checked="" type="checkbox"/> Yes <input type="checkbox"/> No		Chloride concentration: _____ mg/l (For Emergency Pits and Settling Pits only)	
Is the bottom below ground level? <input checked="" type="checkbox"/> Yes <input type="checkbox"/> No		Artificial Liner? <input type="checkbox"/> Yes <input checked="" type="checkbox"/> No	
How is the pit lined if a plastic liner is not used? Dirt			
Pit dimensions (all but working pits): 60 Length (feet) 60 Width (feet) _____ N/A: Steel Pits Depth from ground level to deepest point: 8 (feet)			
If the pit is lined give a brief description of the liner material, thickness and installation procedure.		Describe procedures for periodic maintenance and determining liner integrity, including any special monitoring.	
Distance to nearest water well within one-mile of pit 2100 feet Depth of water well 70 feet		Depth to shallowest fresh water 40 feet. Source of information: _____ measured <input checked="" type="checkbox"/> well owner _____ electric log _____ KDWR	
Emergency, Settling and Burn Pits ONLY: Producing Formation: _____ Number of producing wells on lease: _____ Barrels of fluid produced daily: _____ Does the slope from the tank battery allow all spilled fluids to flow into the pit? <input type="checkbox"/> Yes <input type="checkbox"/> No		Drilling, Workover and Haul-Off Pits ONLY: Type of material utilized in drilling/workover: mud Number of working pits to be utilized: 4 Abandonment procedure: As per KCC reg. Drill pits must be closed within 365 days of spud date.	
I hereby certify that the above statements are true and correct to the best of my knowledge and belief.			
_____ Date 5/31/06		_____ Signature of Applicant or Agent	

15-035-24247-0000

KCC OFFICE USE ONLY			
Date Received: _____	Permit Number: _____	Permit Date: _____	Lease Inspection: <input type="checkbox"/> Yes <input type="checkbox"/> No

Mail to: KCC - Conservation Division, 130 S. Market - Room 2078, Wichita, Kansas 67202