

For KCC Use:  
 Effective Date: 6-7-06  
 District # 1  
 SGA?  Yes  No

KANSAS CORPORATION COMMISSION  
 OIL & GAS CONSERVATION DIVISION

RECEIVED

JUN 02 2006

Form C-1

December 2002

Form must be Typed

Form must be Signed

Blanks must be Filled

NOTICE OF INTENT TO DRILL

Must be approved by KCC five (5) days prior to commencing well

KCC WICHITA

Expected Spud Date June 20 2006  
 month day year

Spot 30's + 90' W of  
 C NE NE Sec. 14 Twp. 21 S. R. 23  East  West  
690 feet from  N /  S Line of Section  
750 feet from  E /  W Line of Section  
 Is SECTION  Regular  Irregular?

OPERATOR: License# KLN 4767  
 Name: Ritchie Exploration, Inc.  
 Address: PO Box 783188  
 City/State/Zip: Wichita, KS 67278-3188  
 Contact Person: Craig Caulk  
 Phone: 316-691-9500

(Note: Locate well on the Section Plat on reverse side)  
 County: Hodgeman  
 Lease Name: Frusher Farms Well #: 1  
 Field Name: Wildcat

CONTRACTOR: License# KLN 5822  
 Name: Val Energy, Inc.

Is this a Prorated / Spaced Field?  Yes  No

Target Formation(s): Fort Scott, Cherokee, Mississippian

Nearest Lease or unit boundary: 690'

Ground Surface Elevation: 2310 feet MSL

Water well within one-quarter mile:  Yes  No

Public water supply well within one mile:  Yes  No

Depth to bottom of fresh water: 240' 180'

Depth to bottom of usable water: 620'

Surface Pipe by Alternate:  1  2

Length of Surface Pipe Planned to be set: 260' MIN

Length of Conductor Pipe required: NONE

Projected Total Depth: 4650'

Formation at Total Depth: Mississippian

Water Source for Drilling Operations:  
 Well  Farm Pond  Other

DWR Permit #: \_\_\_\_\_

(Note: Apply for Permit with DWR )

Will Cores be taken?  Yes  No

If Yes, proposed zone: \_\_\_\_\_

Well Drilled For:	Well Class:	Type Equipment:
<input checked="" type="checkbox"/> Oil <input checked="" type="checkbox"/> Enh Rec	<input type="checkbox"/> Infield	<input checked="" type="checkbox"/> Mud Rotary
<input type="checkbox"/> Gas <input type="checkbox"/> Storage	<input type="checkbox"/> Pool Ext.	<input type="checkbox"/> Air Rotary
<input type="checkbox"/> OWWO <input type="checkbox"/> Disposal	<input checked="" type="checkbox"/> Wildcat	<input type="checkbox"/> Cable
<input type="checkbox"/> Seismic; # of Holes _____	<input type="checkbox"/> Other	
<input type="checkbox"/> Other _____		

If OWWO: old well information as follows:  
 Operator: \_\_\_\_\_  
 Well Name: \_\_\_\_\_  
 Original Completion Date: \_\_\_\_\_ Original Total Depth: \_\_\_\_\_

Directional, Deviated or Horizontal wellbore?  Yes  No

If Yes, true vertical depth: \_\_\_\_\_

Bottom Hole Location: \_\_\_\_\_

KCC DKT #: \_\_\_\_\_

AFFIDAVIT

The undersigned hereby affirms that the drilling, completion and eventual plugging of this well will comply with K.S.A. 55 et. seq.

It is agreed that the following minimum requirements will be met:

1. Notify the appropriate district office **prior** to spudding of well;
2. A copy of the approved notice of intent to drill **shall be** posted on each drilling rig;
3. The minimum amount of surface pipe as specified below **shall be set** by circulating cement to the top; in all cases surface pipe **shall be set** through all unconsolidated materials plus a minimum of 20 feet into the underlying formation.
4. If the well is dry hole, an agreement between the operator and the district office on plug length and placement is necessary **prior to plugging**;
5. The appropriate district office will be notified before well is either plugged or production casing is cemented in;
6. If an ALTERNATE II COMPLETION, production pipe shall be cemented from below any usable water to surface within **120 days** of spud date. Or pursuant to Appendix "B" - Eastern Kansas surface casing order #133,891-C, which applies to the KCC District 3 area, alternate II cementing must be completed within 30 days of the spud date or the well shall be plugged. **In all cases, NOTIFY district office** prior to any cementing.

I hereby certify that the statements made herein are true and to the best of my knowledge and belief.

Date: June 1, 2006 Signature of Operator or Agent: [Signature] Title: GIS Specialist

**For KCC Use ONLY**  
 API # 15 - 083-21518-0000  
 Conductor pipe required None feet  
 Minimum surface pipe required 200 feet per Alt. X @  
 Approved by: Ritt 6-2-06  
 This authorization expires: 12-2-06  
 (This authorization void if drilling not started within 6 months of effective date.)  
 Spud date: \_\_\_\_\_ Agent: \_\_\_\_\_

Remember to:

- File Drill Pit Application (form CDP-1) with Intent to Drill;
  - File Completion Form ACO-1 within 120 days of spud date;
  - File acreage attribution plat according to field proration orders;
  - Notify appropriate district office 48 hours prior to workover or re-entry;
  - Submit plugging report (CP-4) after plugging is completed;
  - Obtain written approval before disposing or injecting salt water.
- If this permit has expired (See: authorized expiration date) please check the box below and return to the address below.

Well Not Drilled - Permit Expired  
 Signature of Operator or Agent: \_\_\_\_\_  
 Date: \_\_\_\_\_

Mail to: KCC - Conservation Division, 130 S. Market - Room 2078, Wichita, Kansas 67202

14  
21  
23W

RECEIVED

JUN 02 2006

KCC WICHITA

IN ALL CASES PLOT THE INTENDED WELL ON THE PLAT BELOW

Plat of acreage attributable to a well in a prorated or spaced field

If the intended well is in a prorated or spaced field, please fully complete this side of the form. If the intended well is in a prorated or spaced field complete the plat below showing that the well will be properly located in relationship to other wells producing from the common source of supply. Please show all the wells and within 1 mile of the boundaries of the proposed acreage attribution unit for gas wells and within 1/2 mile of the boundaries of the proposed acreage attribution unit for oil wells.

API No. 15 - 083-21518-000

Operator: Ritchie Exploration, Inc.

Lease: Frusher Farms

Well Number: 1

Field: Wildcat

Number of Acres attributable to well:

QTR / QTR / QTR of acreage: C - NE - NE

Location of Well: County: Hodgeman

690 feet from [X] N / [ ] S Line of Section

750 feet from [X] E / [ ] W Line of Section

Sec. 14 Twp. 21 S. R. 23 [ ] East [X] West

Is Section: [X] Regular or [ ] Irregular

If Section is Irregular, locate well from nearest corner boundary.

Section corner used: [ ] NE [ ] NW [ ] SE [ ] SW

PLAT

(Show location of the well and shade attributable acreage for prorated or spaced wells.)

(Show footage to the nearest lease or unit boundary line.)

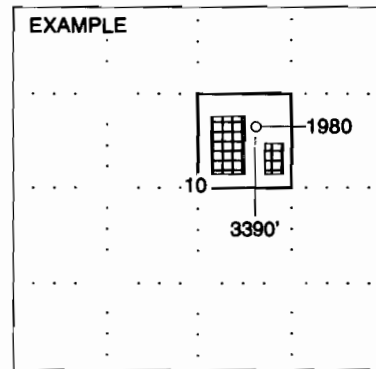
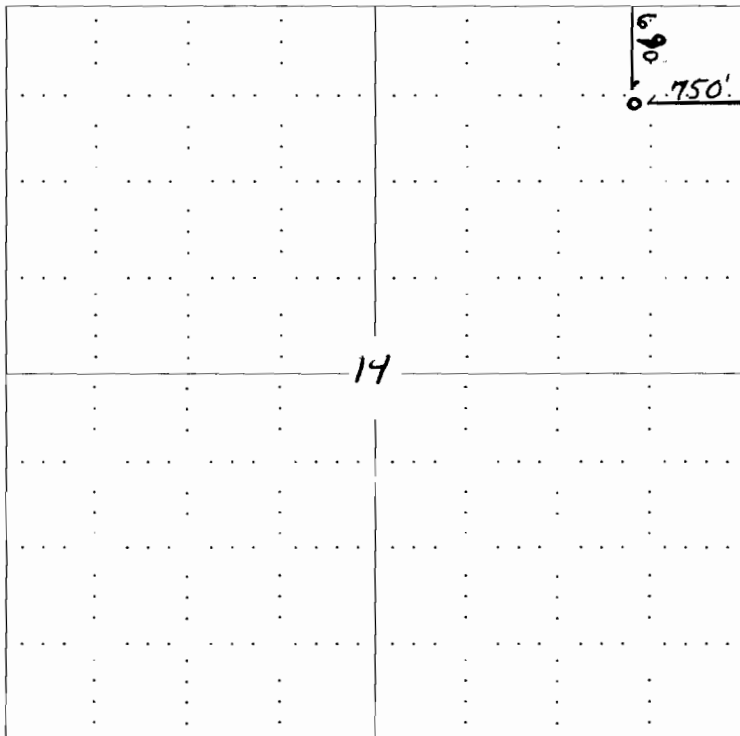

SEWARD CO.

NOTE: In all cases locate the spot of the proposed drilling location.

In plotting the proposed location of the well, you must show:

- 1. The manner in which you are using the depicted plat by identifying section lines, i.e. 1 section, 1 section with 8 surrounding sections, 4 sections, etc.
2. The distance of the proposed drilling location from the section's south / north and east / west.
3. The distance to the nearest lease or unit boundary line.
4. If proposed location is located within a prorated or spaced field a certificate of acreage attribution plat must be attached: (CO-7 for oil wells; CG-8 for gas wells).

KANSAS CORPORATION COMMISSION  
OIL & GAS CONSERVATION DIVISION  
**APPLICATION FOR SURFACE PIT**

RECEIVED

JUN 02 2006

Form CDP-1  
April 2004  
Form must be Typed

KCC WICHITA

Submit in Duplicate

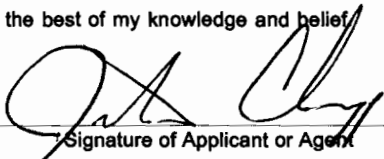
Operator Name: <b>Ritchie Exploration, Inc</b>		License Number: <b>KLN 4767</b>
Operator Address: <b>PO Box 783188 Wichita, KS 67278-3188</b>		
Contact Person: <b>Craig Caulk</b>		Phone Number: <b>( 316 ) 691 - 9500</b>
Lease Name & Well No.: <b>#1 Frusher Farms</b>		Pit Location (QQQQ): 30'S 90'W <u>  C  </u> <u>  NE  </u> <u>  NE  </u> Sec. <u>  14  </u> Twp. <u>  21  </u> R. <u>  23  </u> <input type="checkbox"/> East <input checked="" type="checkbox"/> West <u>  690  </u> Feet from <input checked="" type="checkbox"/> North / <input type="checkbox"/> South Line of Section <u>  750  </u> Feet from <input checked="" type="checkbox"/> East / <input type="checkbox"/> West Line of Section <u>  Hodgeman  </u> County
Type of Pit: <input type="checkbox"/> Emergency Pit <input type="checkbox"/> Burn Pit <input type="checkbox"/> Settling Pit <input checked="" type="checkbox"/> Drilling Pit <input type="checkbox"/> Workover Pit <input type="checkbox"/> Haul-Off Pit <small>(If WP Supply API No. or Year Drilled)</small>	Pit is: <input checked="" type="checkbox"/> Proposed <input type="checkbox"/> Existing If Existing, date constructed: _____ Pit capacity: <u>  20,517  </u> (bbls)	
Is the pit located in a Sensitive Ground Water Area? <input type="checkbox"/> Yes <input checked="" type="checkbox"/> No		Chloride concentration: _____ mg/l <small>(For Emergency Pits and Settling Pits only)</small>
Is the bottom below ground level? <input checked="" type="checkbox"/> Yes <input type="checkbox"/> No	Artificial Liner? <input type="checkbox"/> Yes <input checked="" type="checkbox"/> No	How is the pit lined if a plastic liner is not used? <b>Cottonseed Hulls / AquaGel</b>
Pit dimensions (all but working pits): <u>  120  </u> Length (feet) <u>  120  </u> Width (feet) <u>  N/A  </u> Steel Pits Depth from ground level to deepest point: <u>  8  </u> (feet)		
If the pit is lined give a brief description of the liner material, thickness and installation procedure.		Describe procedures for periodic maintenance and determining liner integrity, including any special monitoring.
Distance to nearest water well within one-mile of pit <u>  N/A  </u> feet    Depth of water well _____ feet	Depth to shallowest fresh water _____ feet. Source of information: _____ measured    _____ well owner    _____ electric log    _____ KDWR	
<b>Emergency, Settling and Burn Pits ONLY:</b> Producing Formation: _____ Number of producing wells on lease: _____ Barrels of fluid produced daily: _____ Does the slope from the tank battery allow all spilled fluids to flow into the pit? <input type="checkbox"/> Yes <input type="checkbox"/> No	<b>Drilling, Workover and Haul-Off Pits ONLY:</b> Type of material utilized in drilling/workover: <u>  Fresh / Chemical Mud  </u> Number of working pits to be utilized: <u>  3  </u> Abandonment procedure: <u>  Backfill  </u> Drill pits must be closed within 365 days of spud date.	
I hereby certify that the above statements are true and correct to the best of my knowledge and belief.		
<u>  June 1, 2006  </u> Date	 Signature of Applicant or Agent	
<b>KCC OFFICE USE ONLY</b>		
Date Received: <u>  6/2/06  </u> Permit Number: _____ Permit Date: <u>  6/2/06  </u> Lease Inspection: <input type="checkbox"/> Yes <input checked="" type="checkbox"/> No		

15-083-21518-0002