

For KCC Use: 6-10-06
Effective Date: _____
District # _____
SGA? Yes No

KANSAS CORPORATION COMMISSION
OIL & GAS CONSERVATION DIVISION

RECEIVED

Form C-1
December 2002

NOTICE OF INTENT TO DRILL

JUN 02 2006

Form must be Typed
All blanks must be Filled

Must be approved by KCC five (5) days prior to commencing well

KCC WICHITA

Expected Spud Date June 7, 2006
month day year

Spot
Approx. E/2 SE/4 Sec. 18 Twp. 31 S. R. 14 East West
1417' feet from N / S Line of Section
617' feet from E / W Line of Section
Is SECTION Regular Irregular?

OPERATOR: License# 31725
Name: Shelby Resources, LLC
Address: P.O. Box 1213
Hays, Kansas 67601
City/State/Zip: _____
Contact Person: Brian Karlin
Phone: 785-623-3290

(Note: Locate well on the Section Plat on reverse side)
County: Barber
Lease Name: Thunderbird Ranch Well #: 2-18
Field Name: Skinner

CONTRACTOR: License# 5142
Name: Sterling Drilling Company

Is this a Prorated / Spaced Field? Yes No
Target Formation(s): Arbuckle
Nearest Lease or unit boundary: 617'

Well Drilled For: Oil Gas OWWO Seismic; # of Holes _____ Other _____
 Enh Rec Storage Disposal
Well Class: Infield Pool Ext. Wildcat Other _____
Type Equipment: Mud Rotary Air Rotary Cable

Ground Surface Elevation: 1727 feet MSL
Water well within one-quarter mile: Yes No
Public water supply well within one mile: Yes No

If OWWO: old well information as follows:
Operator: _____
Well Name: _____
Original Completion Date: _____ Original Total Depth: _____

Depth to bottom of fresh water: 150'
Depth to bottom of usable water: 180'
Surface Pipe by Alternate: 1 2

Directional, Deviated or Horizontal wellbore? Yes No
If Yes, true vertical depth: _____
Bottom Hole Location: _____
KCC DKT #: _____

Length of Surface Pipe Planned to be set: 225'
Length of Conductor Pipe required: Possible
Projected Total Depth: 4650'
Formation at Total Depth: Arbuckle

Water Source for Drilling Operations:
 Well Farm Pond Other Medicine Lodge River
DWR Permit #: Contractor to apply for permit.

(Note: Apply for Permit with DWR)
Will Cores be taken? Yes No
If Yes, proposed zone: _____

AFFIDAVIT

The undersigned hereby affirms that the drilling, completion and eventual plugging of this well will comply with K.S.A. 55 et. seq.

It is agreed that the following minimum requirements will be met:

1. Notify the appropriate district office **prior** to spudding of well;
2. A copy of the approved notice of intent to drill **shall be** posted on each drilling rig;
3. The minimum amount of surface pipe as specified below **shall be set** by circulating cement to the top; in all cases surface pipe **shall be set** through all unconsolidated materials plus a minimum of 20 feet into the underlying formation.
4. If the well is dry hole, an agreement between the operator and the district office on plug length and placement is necessary **prior to plugging**;
5. The appropriate district office **will be notified before well is either plugged or production casing is cemented in**;
6. If an ALTERNATE II COMPLETION, production pipe shall be cemented from below any usable water to surface **within 120 days** of spud date.
Or pursuant to Appendix "B" - Eastern Kansas surface casing order #133,891-C, which applies to the KCC District 3 area, alternate II cementing must be completed within 30 days of the spud date or the well shall be plugged. **In all cases, NOTIFY district office** prior to any cementing.

I hereby certify that the statements made herein are true and to the best of my knowledge and belief.

Date: May 30, 2006 Signature of Operator or Agent: Brian Karlin Title: Operations Manager

For KCC Use ONLY
API # 15 - 007-23029-0000
Conductor pipe required None feet
Minimum surface pipe required 200 feet per Alt. 1
Approved by: Putt 6-5-06
This authorization expires: 12-5-06
(This authorization void if drilling not started within 6 months of approval date.)
Spud date: _____ Agent: _____

Remember to:

- File Drill Pit Application (form CDP-1) with Intent to Drill;
- File Completion Form ACO-1 within 120 days of spud date;
- File acreage attribution plat according to field proration orders;
- Notify appropriate district office 48 hours prior to workover or re-entry;
- Submit plugging report (CP-4) after plugging is completed;
- Obtain written approval before disposing or injecting salt water.
- If this permit has expired (See: authorized expiration date) please check the box below and return to the address below.

Well Not Drilled - Permit Expired

Signature of Operator or Agent: _____
Date: _____

Mail to: KCC - Conservation Division, 130 S. Market - Room 2078, Wichita, Kansas 67202

18
31
M/W

RECEIVED

JUN 02 2006

KCC WICHITA

IN ALL CASES PLOT THE INTENDED WELL ON THE PLAT BELOW

Plat of acreage attributable to a well in a prorated or spaced field

If the intended well is in a prorated or spaced field, please fully complete this side of the form. If the intended well is in a prorated or spaced field complete the plat below showing that the well will be properly located in relationship to other wells producing from the common source of supply. Please show all the wells and within 1 mile of the boundaries of the proposed acreage attribution unit for gas wells and within 1/2 mile of the boundaries of the proposed acreage attribution unit for oil wells.

API No. 15 - 007-23029-000
Operator: Shelby Resources, LLC
Lease: Thunderbird Ranch
Well Number: 2-18
Field: Skinner
Number of Acres attributable to well:
QTR / QTR / QTR of acreage: Approx. E/2 SE/4

Location of Well: County: Barber
1417' feet from N / S Line of Section
617' feet from E / W Line of Section
Sec. 18 Twp. 31 S. R. 14 East West

Is Section: Regular or Irregular

If Section is Irregular, locate well from nearest corner boundary.

Section corner used: NE NW SE SW

PLAT

(Show location of the well and shade attributable acreage for prorated or spaced wells.)

(Show footage to the nearest lease or unit boundary line.)

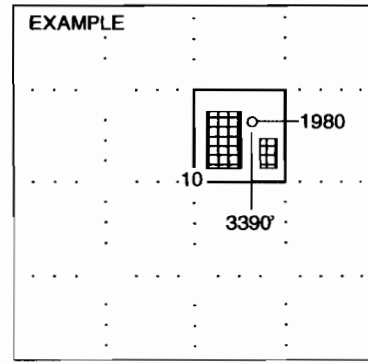
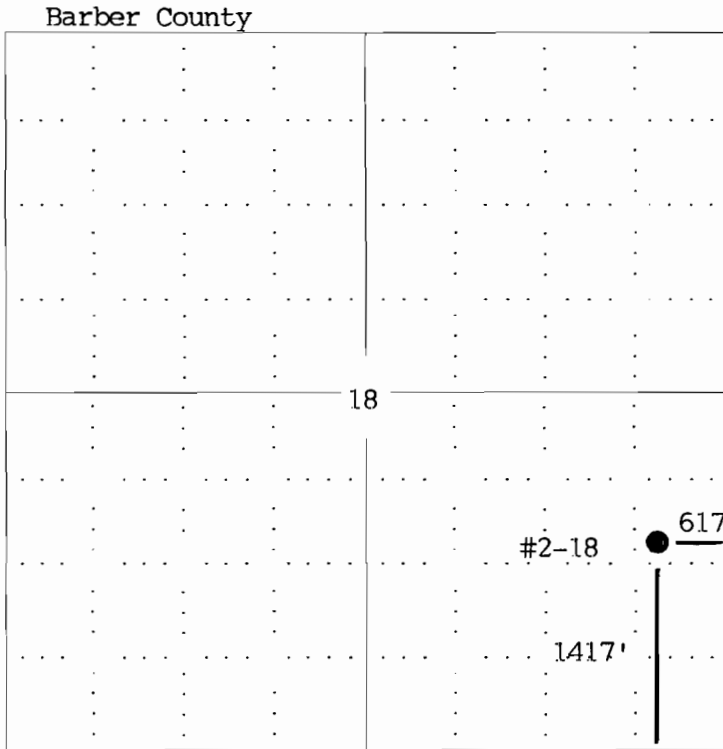

SEWARD CO.

NOTE: In all cases locate the spot of the proposed drilling location.

In plotting the proposed location of the well, you must show:

- 1. The manner in which you are using the depicted plat by identifying section lines, i.e. 1 section, 1 section with 8 surrounding sections, 4 sections, etc.
2. The distance of the proposed drilling location from the section's south / north and east / west.
3. The distance to the nearest lease or unit boundary line.
4. If proposed location is located within a prorated or spaced field a certificate of acreage attribution plat must be attached: (CO-7 for oil wells; CG-8 for gas wells).

KANSAS CORPORATION COMMISSION
OIL & GAS CONSERVATION DIVISION
APPLICATION FOR SURFACE PIT

RECEIVED
JUN 02 2006
KCC WICHITA
Form CDP-1
April 2004
perm must be Typed

Submit in Duplicate

Operator Name: Shelby Resources, LLC		License Number: 31725
Operator Address: P.O. Box 1213, Hays, Kansas 67601		
Contact Person: Brian Karlin		Phone Number: (785) 623 - 3290
Lease Name & Well No.: Thunderbird Ranch #2-18		Pit Location (QQQQ): Approx. <u>E/2</u> <u>SE/4</u> Sec. <u>18</u> Twp. <u>31</u> R. <u>14</u> <input type="checkbox"/> East <input checked="" type="checkbox"/> West <u>1417'</u> Feet from <input type="checkbox"/> North / <input checked="" type="checkbox"/> South Line of Section <u>617'</u> Feet from <input checked="" type="checkbox"/> East / <input type="checkbox"/> West Line of Section <u>Barber</u> County
Type of Pit: <input type="checkbox"/> Emergency Pit <input type="checkbox"/> Burn Pit <input type="checkbox"/> Settling Pit <input checked="" type="checkbox"/> Drilling Pit <input type="checkbox"/> Workover Pit <input type="checkbox"/> Haul-Off Pit <small>(If WP Supply API No. or Year Drilled)</small>	Pit is: <input checked="" type="checkbox"/> Proposed <input type="checkbox"/> Existing If Existing, date constructed: _____ Pit capacity: <u>4000</u> (bbls)	
Is the pit located in a Sensitive Ground Water Area? <input type="checkbox"/> Yes <input checked="" type="checkbox"/> No		Chloride concentration: _____ mg/l <small>(For Emergency Pits and Settling Pits only)</small>
Is the bottom below ground level? <input checked="" type="checkbox"/> Yes <input type="checkbox"/> No	Artificial Liner? <input type="checkbox"/> Yes <input checked="" type="checkbox"/> No	How is the pit lined if a plastic liner is not used? Lined with soil, native & fresh mud.
Pit dimensions (all but working pits): <u>80'</u> Length (feet) <u>80'</u> Width (feet) <u>N/A</u> Steel Pits Depth from ground level to deepest point: <u>4'</u> (feet)		
If the pit is lined give a brief description of the liner material, thickness and installation procedure.		Describe procedures for periodic maintenance and determining liner integrity, including any special monitoring.
Distance to nearest water well within one-mile of pit <u>N/A</u> feet Depth of water well <u>N/A</u> feet	Depth to shallowest fresh water <u>25'</u> feet. Source of information: <input type="checkbox"/> measured <input type="checkbox"/> well owner <input type="checkbox"/> electric log <input checked="" type="checkbox"/> KDWR	
Emergency, Settling and Burn Pits ONLY: Producing Formation: _____ Number of producing wells on lease: _____ Barrels of fluid produced daily: _____ Does the slope from the tank battery allow all spilled fluids to flow into the pit? <input type="checkbox"/> Yes <input type="checkbox"/> No	Drilling, Workover and Haul-Off Pits ONLY: Type of material utilized in drilling/workover: <u>Chemical drilling mud.</u> Number of working pits to be utilized: <u>3</u> Abandonment procedure: <u>Haul off excess fluid. Allow the remainder to evaporate and then refill with excavated dirt.</u> Drill pits must be closed within 365 days of spud date.	
I hereby certify that the above statements are true and correct to the best of my knowledge and belief.		
<u>5-31-2006</u> Date	<u>Brian Karlin</u> Signature of Applicant or Agent	

15-007-23029-0002

KCC OFFICE USE ONLY		RFAS
Date Received: <u>6/2/06</u>	Permit Number: _____	Permit Date: <u>6/2/06</u> Lease Inspection: <input checked="" type="checkbox"/> Yes <input type="checkbox"/> No

Mail to: KCC - Conservation Division, 130 S. Market - Room 2078, Wichita, Kansas 67202

KANSAS

CORPORATION COMMISSION

KATHLEEN SEBELIUS, GOVERNOR
BRIAN J. MOLINE, CHAIR
ROBERT E. KREHBIEL, COMMISSIONER
MICHAEL C. MOFFET, COMMISSIONER

June 2, 2006

Mr. Brian Karlin
Shelby Resources, LLC
PO Box 1213
Hays, KS 67601

Re: Drilling Pit Application
Thunderbird Ranch Lease Well No. 2-18
SE/4 Sec. 18-31S-14W
Barber County, Kansas

Dear Mr. Karlin:

District staff has inspected the above referenced location and has determined that the reserve pit shall be constructed **without slots**, the bottom shall be flat and reasonably level and the free fluids must be removed. The fluids are to be removed from the reserve pit as soon as the Hutchinson Salt section has been drilled through and displacement of the fluids into the reserve pit has occurred. The fluids should be removed again as soon as practical after drilling operations have ceased.

If production casing is set all completion fluids shall be removed from the working pits daily. NO completion fluids or non-exempt wastes shall be placed in the reserve pit.

The fluids should be taken to an authorized disposal well. Please call the District Office at (620) 225-8888 when the fluids have been removed. Please file form CDP-5 (August 2004), Exploration and Production Waste Transfer, within 30 days of fluid removal. Conservation division forms are available through our office and on the KCC web site: www.kcc.state.ks.us/conservation/forms.

A copy of this letter should be posted in the doghouse along with the approved Intent to Drill.

If you have any questions or concerns please feel free to contact the undersigned at the above address.

Sincerely,

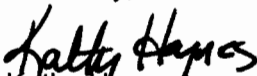
Kathy Haynes

Department of Environmental Protection and Remediation

cc: File