

RECEIVED

JUN 07 2006

Form C-1

December 2002

For KCC Use: 6-13-06
Effective Date: 4
District #: 4
SGA? Yes No

KANSAS CORPORATION COMMISSION
OIL & GAS CONSERVATION DIVISION
NOTICE OF INTENT TO DRILL

KCC WICHITA
Form must be Typed
Form must be Signed
All blanks must be Filled

Must be approved by KCC five (5) days prior to commencing well

Expected Spud Date June 22 2006
month day year

Spot SE NW SE Sec. 32 Twp. 5 S. R. 22
1800 feet from N / S Line of Section
1900 feet from E / W Line of Section

OPERATOR: License# 5004
Name: Vincent Oil Corporation
Address: 155 N. Market, Suite 700
City/State/Zip: Wichita, Kansas 67202
Contact Person: Rick Hiebsch
Phone: 316-262-3573

Is SECTION Regular Irregular?

(Note: Locate well on the Section Plat on reverse side)

CONTRACTOR: License# 33575
Name: WW Drilling, LLC

County: Norton
Lease Name: Legere Well #: 1-32
Field Name: wildcat

Is this a Prorated / Spaced Field? Yes No

Target Formation(s): Arbuckle
Nearest Lease or unit boundary: 375 ft.

Well Drilled For: Oil Gas OWWO Seismic; # of Holes
Well Class: Enh Rec Storage Disposal Other
Type Equipment: Mud Rotary Air Rotary Cable

Ground Surface Elevation: 2335 feet MSL

Water well within one-quarter mile: Yes No

Public water supply well within one mile: Yes No

Depth to bottom of fresh water: 200 250 ft.

Depth to bottom of usable water: 1200 ft.

Surface Pipe by Alternate: 1 2

Length of Surface Pipe Planned to be set: 325 ft.

Length of Conductor Pipe required: none

Projected Total Depth: 3900 ft.

Formation at Total Depth: Arbuckle

Water Source for Drilling Operations: Well Farm Pond Other unknown

DWR Permit #: (Note: Apply for Permit with DWR)

Will Cores be taken? Yes No

If Yes, proposed zone:

If OWWO: old well information as follows:
Operator:
Well Name:
Original Completion Date: Original Total Depth:

Directional, Deviated or Horizontal wellbore? Yes No

If Yes, true vertical depth:

Bottom Hole Location:

KCC DKT #:

AFFIDAVIT

The undersigned hereby affirms that the drilling, completion and eventual plugging of this well will comply with K.S.A. 55 et. seq.

It is agreed that the following minimum requirements will be met:

- 1. Notify the appropriate district office prior to spudding of well;
2. A copy of the approved notice of intent to drill shall be posted on each drilling rig;
3. The minimum amount of surface pipe as specified below shall be set by circulating cement to the top; in all cases surface pipe shall be set through all unconsolidated materials plus a minimum of 20 feet into the underlying formation.
4. If the well is dry hole, an agreement between the operator and the district office on plug length and placement is necessary prior to plugging;
5. The appropriate district office will be notified before well is either plugged or production casing is cemented in;
6. If an ALTERNATE II COMPLETION, production pipe shall be cemented from below any usable water to surface within 120 days of spud date. Or pursuant to Appendix "B" - Eastern Kansas surface casing order #133,891-C, which applies to the KCC District 3 area, alternate II cementing must be completed within 30 days of the spud date or the well shall be plugged. In all cases, NOTIFY district office prior to any cementing.

I hereby certify that the statements made herein are true and to the best of my knowledge and belief.

Date: June 6, 2006 Signature of Operator or Agent: Richard H. Diebel Title: President

For KCC Use ONLY
API # 15 - 137-20454-0000
Conductor pipe required None feet
Minimum surface pipe required 250 feet per Alt.
Approved by: R.H. Diebel
This authorization expires: 12-8-06
Spud date: Agent:

Remember to:
- File Drill Pit Application (form CDP-1) with Intent to Drill;
- File Completion Form ACO-1 within 120 days of spud date;
- File acreage attribution plat according to field proration orders;
- Notify appropriate district office 48 hours prior to workover or re-entry;
- Submit plugging report (CP-4) after plugging is completed;
- Obtain written approval before disposing or injecting salt water.
- If this permit has expired (See: authorized expiration date) please check the box below and return to the address below.
Well Not Drilled - Permit Expired
Signature of Operator or Agent:
Date:

Mail to: KCC - Conservation Division, 130 S. Market - Room 2078, Wichita, Kansas 67202

32 5 22W

**IN ALL CASES PLOT THE INTENDED WELL ON THE PLAT BELOW**

*Plat of acreage attributable to a well in a prorated or spaced field*

**If the intended well is in a prorated or spaced field, please fully complete this side of the form.** If the intended well is in a prorated or spaced field complete the plat below showing that the well will be properly located in relationship to other wells producing from the common source of supply. Please show all the wells and within 1 mile of the boundaries of the proposed acreage attribution unit for gas wells and within 1/2 mile of the boundaries of the proposed acreage attribution unit for oil wells.

API No. 15 - \_\_\_\_\_  
 Operator: Vincent Oil Corporation \_\_\_\_\_  
 Lease: Legere \_\_\_\_\_  
 Well Number: 1-32 \_\_\_\_\_  
 Field: wildcat \_\_\_\_\_  
 Number of Acres attributable to well: 40 \_\_\_\_\_  
 QTR / QTR / QTR of acreage: SE - NW - SE \_\_\_\_\_

Location of Well: County: Norton \_\_\_\_\_  
 1800 \_\_\_\_\_ feet from  N /  S Line of Section  
 1900 \_\_\_\_\_ feet from  E /  W Line of Section  
 Sec. 32 Twp. 5 S. R. 22  East  West

Is Section:  Regular or  Irregular

**If Section is Irregular, locate well from nearest corner boundary.**

Section corner used:  NE  NW  SE  SW

**PLAT**

*(Show location of the well and shade attributable acreage for prorated or spaced wells.)  
 (Show footage to the nearest lease or unit boundary line.)*

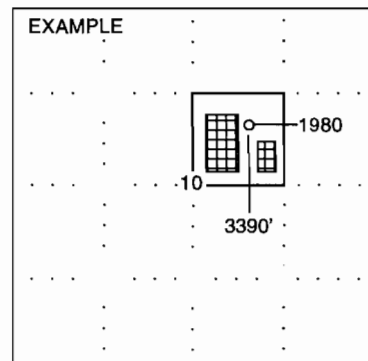
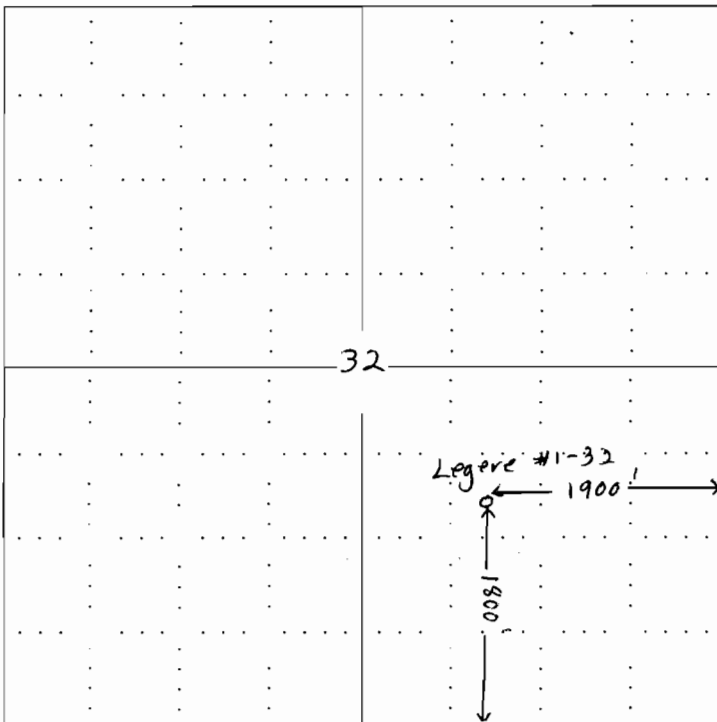

**NOTE: In all cases locate the spot of the proposed drilling location.**

**In plotting the proposed location of the well, you must show:**

1. The manner in which you are using the depicted plat by identifying section lines, i.e. 1 section, 1 section with 8 surrounding sections, 4 sections, etc.
2. The distance of the proposed drilling location from the section's south / north and east / west.
3. The distance to the nearest lease or unit boundary line.
4. If proposed location is located within a prorated or spaced field a certificate of acreage attribution plat must be attached: (CO-7 for oil wells; CG-8 for gas wells).

RECEIVED

JUN 07 2006

KANSAS CORPORATION COMMISSION  
OIL & GAS CONSERVATION DIVISION

KCC WICHITA

Form CDP-1  
April 2004  
Form must be Typed

APPLICATION FOR SURFACE PIT

Submit in Duplicate

Operator Name: Vincent Oil Corporation		License Number: 5004
Operator Address: 155 N. Market, Suite 700 Wichita, Kansas 67202		
Contact Person: Rick Hiebsch		Phone Number: ( 316 ) 262 - 3573
Lease Name & Well No.: Legere #1-32		Pit Location (QQQQ): NW - SE - NW - SE Sec. 32 Twp. 5 R. 22 <input type="checkbox"/> East <input checked="" type="checkbox"/> West 1800 Feet from <input type="checkbox"/> North / <input checked="" type="checkbox"/> South Line of Section 1900 Feet from <input checked="" type="checkbox"/> East / <input type="checkbox"/> West Line of Section Norton County
Type of Pit: <input type="checkbox"/> Emergency Pit <input type="checkbox"/> Burn Pit <input type="checkbox"/> Settling Pit <input checked="" type="checkbox"/> Drilling Pit <input type="checkbox"/> Workover Pit <input type="checkbox"/> Haul-Off Pit <i>(If WP Supply API No. or Year Drilled)</i>	Pit is: <input checked="" type="checkbox"/> Proposed <input type="checkbox"/> Existing If Existing, date constructed: _____ Pit capacity: 6000 (bbls)	
Is the pit located in a Sensitive Ground Water Area? <input type="checkbox"/> Yes <input checked="" type="checkbox"/> No		Chloride concentration: _____ mg/l <i>(For Emergency Pits and Settling Pits only)</i>
Is the bottom below ground level? <input checked="" type="checkbox"/> Yes <input type="checkbox"/> No	Artificial Liner? <input type="checkbox"/> Yes <input checked="" type="checkbox"/> No	How is the pit lined if a plastic liner is not used? native and chemical muds
Pit dimensions (all but working pits): 80 Length (feet) 80 Width (feet) N/A: Steel Pits Depth from ground level to deepest point: 3 (feet)		
If the pit is lined give a brief description of the liner material, thickness and installation procedure.		Describe procedures for periodic maintenance and determining liner integrity, including any special monitoring.
Distance to nearest water well within one-mile of pit 500 feet Depth of water well _____ feet		Depth to shallowest fresh water 50 feet. Source of information: _____ measured _____ well owner _____ electric log <input checked="" type="checkbox"/> KDWR
<b>Emergency, Settling and Burn Pits ONLY:</b> Producing Formation: _____ Number of producing wells on lease: _____ Barrels of fluid produced daily: _____ Does the slope from the tank battery allow all spilled fluids to flow into the pit? <input type="checkbox"/> Yes <input type="checkbox"/> No		<b>Drilling, Workover and Haul-Off Pits ONLY:</b> Type of material utilized in drilling/workover: water & bentonite Number of working pits to be utilized: 2 working, 1 reserve Abandonment procedure: all to dry and then backfill Drill pits must be closed within 365 days of spud date.
I hereby certify that the above statements are true and correct to the best of my knowledge and belief.		
June 6, 2006 Date		<i>Richard A. Diebel</i> Signature of Applicant or Agent

15-137-20454-0002

<b>KCC OFFICE USE ONLY</b>			
Date Received: 6/7/06	Permit Number: _____	Permit Date: 6/7/06	Lease Inspection: <input type="checkbox"/> Yes <input checked="" type="checkbox"/> No

Mail to: KCC - Conservation Division, 130 S. Market - Room 2078, Wichita, Kansas 67202