

For KCC Use: 6-20-06
Effective Date: _____
District # _____
SGA? Yes No

**KANSAS CORPORATION COMMISSION
OIL & GAS CONSERVATION DIVISION
NOTICE OF INTENT TO DRILL**

RECEIVED
MAY 30 2006

Form C-1
December 2002
Form must be Typed
Form must be signed
All blanks must be Filled

Must be approved by KCC five (5) days prior to commencing well

Expected Spud Date 07/05/06
month day year

Spot: _____
SE - SE - NE Sec. 14 Twp. 34S R. 35 East West

OPERATOR: License # 5447

_____ feet from N / S Line of Section
_____ feet from E / W Line of Section

Name: OXY USA Inc.
Address: P.O. Box 2528
City/State/Zip: Liberal, KS 67905
Contact Person: Vicki Carder
Phone: (620) 629-4242

Is SECTION x Regular _____ Irregular?
(Note: Locate well on the Section Plat on reverse side)

CONTRACTOR: License # 30606

County: Stevens
Lease Name: Clodfelter B Well #: 2
Field Name: Ski Southeast

Name: Murfin Drilling Co., Inc.

Is this a Prorated / Spaced Field? Yes No

Well Drilled For: Well Class: Type Equipment:
 Oil Enh Rec Infield Mud Rotary
 Gas Storage Pool Ext Air Rotary
 OWWO Disposal Wildcat Cable
 Seismic: _____ # of Holes Other _____
 Other _____

Target Formation(s): St. Louis
Nearest Lease or unit Boundary: 366

Ground Surface Elevation: 2988 feet MSL

Water well within one-quarter mile Yes No

Public water supply well within one mile: Yes No

Depth to bottom of fresh water: 760

Depth to bottom of usable water: 760

Surface Pipe by Alternate: 1 2

Length of Surface Pipe Planned to be set: 1750

Length of Conductor Pipe Required: _____

Projected Total Depth: 6600

Formation at Total Depth: St. Louis

Water Source for Drilling Operations: Well Farm Pond Other _____

DWR Permit # _____

(Note: Apply for Permit with DWR)

Will Cores be Taken? Yes No

If Yes, Proposed zone: _____

If OWWO: old well information as follows:
Operator: _____
Well Name: _____
Original Completion Date: _____ Original Total Depth: _____

Directional, Deviated or Horizontal wellbore? Yes No

IF Yes, true vertical depth _____

Bottom Hole Location _____

KCC DKT #: _____

Prorated, Spaced Hugoton & Panama

AFFIDAVIT Jocket PVPA 050606 Approval

The undersigned hereby affirms that the drilling, completion and eventual plugging of this well will comply with K.S.A. 55-101, et. Seq.
It is agreed that the following minimum requirements will be met:

1. Notify the appropriate district office **prior** to spudding of well;
2. A copy of the approved notice of intent to drill **shall be** posted on each drilling rig;
3. The minimum amount of surface pipe as specified below **shall be set** by circulating cement to the top; in all cases surface pipe **shall be set** through all unconsolidated materials plus a minimum of 20 feet into the underlying formation.
4. If the well is dry hole, an agreement between the operator and the district office on plug length and placement is necessary **prior to plugging**;
5. The appropriate district office will be notified before well is either plugged or production casing is cemented in;
6. If an ALTERNATE II COMPLETION, production pipe shall be cemented from below any usable water to surface within **120 days** of spud date. Or pursuant to Appendix "B" - Eastern Kansas surface casing order #133,891-C, which applies to the KCC District 3 area, alternate II cementing must be completed within 30 days of the spud date or the well shall be plugged. **In all cases, NOTIFY district office** prior to any cementing.

I hereby certify that the statements made herein are true and to the best of my knowledge and belief.

Date: 05/23/06 Signature of Operator or Agent: Vicki Carder Title: Capital Project

For KCC Use ONLY

API # 15 - 189-22535-0000

Conductor pipe required None feet

Minimum Surface pipe required 780 feet per Alt. 1

Approved by: Per 6-15-06

This authorization expires: 12-15-06

(This authorization void if drilling not started within 6 months of effective date.)
Spud date: _____ Agent: _____

Remember to:

- File Drill Pit Application (form CDP-1) with Intent to Drill;
- File Completion Form ACO-1 within 120 days of spud date;
- File acreage attribution plat according to field proation orders;
- Notify appropriate district office 48 hours prior to workover or re-entry;
- Submit plugging report (CP-4) after plugging is completed;
- Obtain written approval before disposing or injecting salt water.
- If this permit has expired (see: authorized expiration date) please check the box below and return to the address below.

Well Not Drilled - Permit Expired

Signature of Operator or Agent: _____
Date: _____

14-7345-R35W

IN ALL CASES PLOT THE INTENDED WELL ON THE PLAT BELOW

Plat of acreage attributable to a well in a prorated or spaced field

If the intended well is in a prorated or spaced field, please fully complete this side of the form. If the intended well is in a prorated or spaced field complete the plat below showing that the well will be properly located in relationship to other wells producing from the common source of supply. Please show all the wells and within 1 mile of the boundaries of the proposed acreage attribution unit for gas wells and within 1/2 mile of the boundaries of the proposed acreage attribution unit for oil wells.

API No. 15 - 189-22535-0000
 Operator: _____
 Lease: _____
 Well Number: _____
 Field: _____
 Number of Acres attributable to well: _____
 QTR / QTR / QTR of acreage: _____ - _____ - _____

Location of Well: County _____
 _____ feet from N / S Line of Section
 _____ feet from E / W Line of Section
 Sec. _____ Twp. _____ R. _____ East West
 Is Section Regular or Irregular
IF Section Is Irregular, locate well from nearest corner boundary.
 Section corner used: NE NW SE SW

PLAT

*(Show location of the well and shade attributable acreage for prorated or spaced wells.)
 (Show footage to the nearest lease or unit boundary line.)*

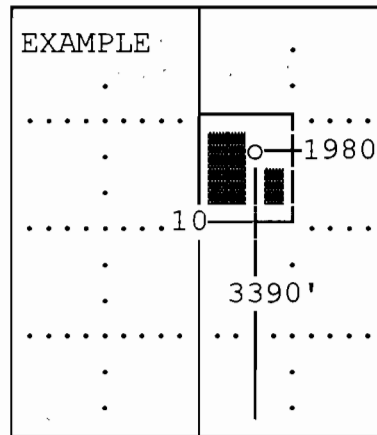
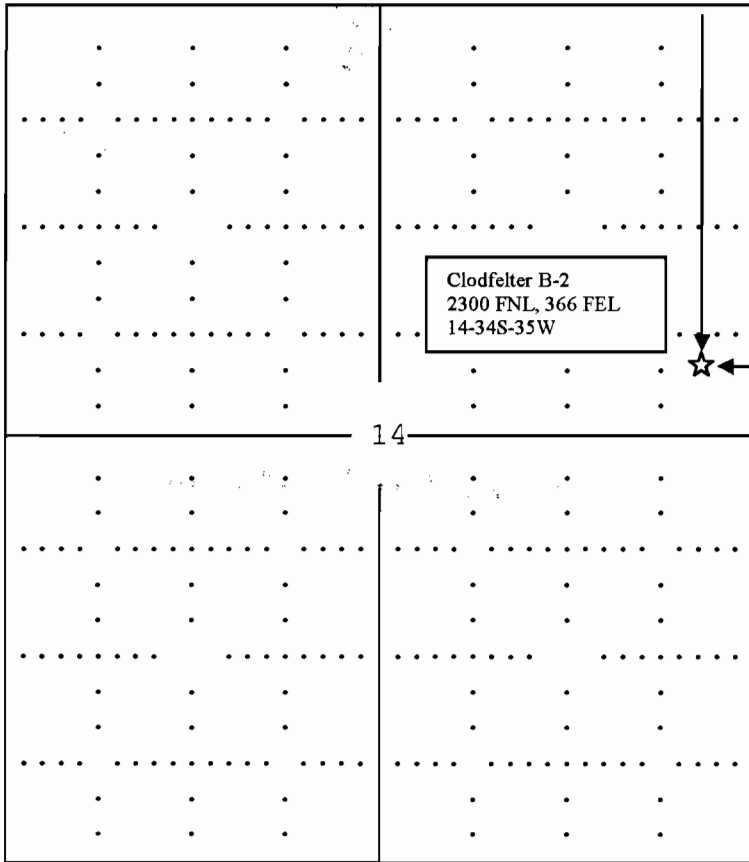

SEWARD CO.

Note: In all cases locate the spot of the proposed drilling location.

Stevens County

In plotting the proposed location of the well, you must show:

1. The manner in which you are using the depicted plat by identifying section lines, i.e. 1 section, 1 section with 8 surrounding sections, 4 sections, etc.
2. The distance of the proposed drilling location from the sections south / north and east / west.
3. The distance to the nearest lease or unit boundary line.
4. If proposed location is located within a prorated or spaced field a certificate of acreage attribution plat must be attached: (CO-7 for oil wells; CG-8 for gas wells).

Approval 6-13-06 DPW
PVPA 050606

KANSAS CORPORATION COMMISSION
CONSERVATION DIVISION
130 S. Market - Room 2078
Wichita, Kansas 67202

RECEIVED

MAY 30 2006

Form 4/01

KCC WICHITA

VERIFIED AFFIDAVIT FOR USE OF MUD AS AN
ALTERNATIVE TO THE CEMENTING REQUIREMENT IN ¶18(D)
OF THE PANOMA COUNCIL GROVE B.P.O.

FORM MUST BE TYPED

Submit in Duplicate
Attach to Drilling Permit

Operator Name OXY USA Inc.		KCC License No. 5447	
Operator Address P.O. Box 2528: Liberal, KS 67905			
Contact Person Rusty Hanna		Telephone No. (620) 629-4200	
Lease Name & No. Clodfelter B 2		API No. 15-189-22535000	KCC Lease Code No.
Location Quarter NE	Section 14	Township 34S	Range 35W
		2300 Ft. from N/S (circle one) Line of Sec.	
		366 Ft. from E/W (circle one) Line of Sec.	
County Stevens	Field Name Ski Southeast	Producing Formation Group St. Louis	Mud Weight 9.0 ppg

AFFIDAVIT CERTIFICATE OF SERVICE

All requirements of the statutes, rules and regulations promulgated to regulate the oil and gas industry have been fully complied with and the statements here are complete and correct to the best of my knowledge. The well subscribed to in this Affidavit will be completed in accordance with all applicable rules and regulations of the KCC. However, applicant intends to use drilling mud of sufficient weight across the interval between the base of the Council Grove group and the top of the Chase Group as an alternative to the cementing requirements found in paragraph 18(D) of the Panoma Council Grove B.P.O. unless timely objection is filed hereto. I hereby certify that I caused a true and correct copy of the foregoing Affidavit and any attachments of said Affidavit to be served by placing the same in the United States mail, postage prepaid, to the following parties, which represent all of the operators or lessees of record and the owners of record of unleased acreage within a one mile radius of the well, including operators and working interest owners having interests in the lands covered by the unit on which the well is to be drilled:

- | | <u>Operator/WI Owner</u> | <u>Address</u> | <u>City, State Zip</u> | <u>Contact</u> |
|-----|--------------------------|-----------------|------------------------|----------------|
| 1. | Four Star Oil and Gas | P. O. Box 36366 | Houston, TX 77236 | c/o Chevron |
| 2. | | | | |
| 3. | | | | |
| 4. | | | | |
| 5. | | | | |
| 6. | | | | |
| 7. | | | | |
| 8. | | | | |
| 9. | | | | |
| 10. | | | | |
| 11. | | | | |
| 12. | | | | |

Signature Viatic Gaudin Date 05/25/06

Title Capital Project

Subscribed and sworn to before me this 25 day of May, 2006.

Notary Public Anita Peterson

Date Commission Expires Oct. 1, 2009

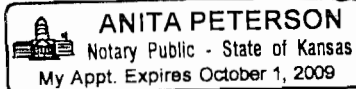

KANSAS CORPORATION COMMISSION
OIL & GAS CONSERVATION DIVISION
APPLICATION FOR SURFACE PIT

RECEIVED

MAY 30 2006

Form CDP-1
April 2004
Form must be Typed

KCC WICHITA

Submit in Duplicate

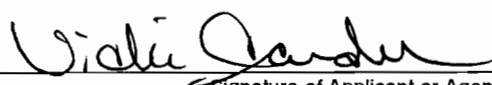
Operator Name: OXY USA Inc.		License Number: 5447
Operator Address: P. O. Box 2528, Liberal, KS 67901		
Contact Person: Gregg Fillpot		Phone Number: (620) 629 - 4200
Lease Name & Well No.: Clodfelter B-2		Pit Location (QQQQ): SE SE NE Sec. 14 Twp. 34S R. 35 <input type="checkbox"/> East <input checked="" type="checkbox"/> West 2300 Feet from <input checked="" type="checkbox"/> North / <input type="checkbox"/> South Line of Section 366 Feet from <input checked="" type="checkbox"/> East / <input type="checkbox"/> West Line of Section Stevens County
Type of Pit: <input type="checkbox"/> Emergency Pit <input type="checkbox"/> Burn Pit <input type="checkbox"/> Settling Pit <input checked="" type="checkbox"/> Drilling Pit <input type="checkbox"/> Workover Pit <input type="checkbox"/> Haul-Off Pit <small>(If WP Supply API No. or Year Drilled)</small>	Pit is: <input checked="" type="checkbox"/> Proposed <input type="checkbox"/> Existing If Existing, date constructed: _____ Pit capacity: 16000 (bbls)	
Is the pit located in a Sensitive Ground Water Area? <input checked="" type="checkbox"/> Yes <input type="checkbox"/> No		Chloride concentration: _____ mg/l <small>(For Emergency Pits and Settling Pits only)</small>
Is the bottom below ground level? <input checked="" type="checkbox"/> Yes <input type="checkbox"/> No	Artificial Liner? <input type="checkbox"/> Yes <input checked="" type="checkbox"/> No	How is the pit lined if a plastic liner is not used? Bentonite & Cuttings
Pit dimensions (all but working pits): 150 Length (feet) 150 Width (feet) N/A: Steel Pits Depth from ground level to deepest point: 4 (feet)		
If the pit is lined give a brief description of the liner material, thickness and installation procedure.		Describe procedures for periodic maintenance and determining liner integrity, including any special monitoring.
Distance to nearest water well within one-mile of pit 2056 feet Depth of water well 703 feet		Depth to shallowest fresh water 252 feet. Source of information: KACLO <input checked="" type="checkbox"/> KDWR _____ measured _____ well owner _____ electric log
Emergency, Settling and Burn Pits ONLY: Producing Formation: _____ Number of producing wells on lease: _____ Barrels of fluid produced daily: _____ Does the slope from the tank battery allow all spilled fluids to flow into the pit? <input type="checkbox"/> Yes <input type="checkbox"/> No		Drilling, Workover and Haul-Off Pits ONLY: Type of material utilized in drilling/workover: Fresh Water Mud Number of working pits to be utilized: _____ Abandonment procedure: Evaporation and Backfill Drill pits must be closed within 365 days of spud date.
I hereby certify that the above statements are true and correct to the best of my knowledge and belief.		
05/23/06 Date		 Signature of Applicant or Agent
KCC OFFICE USE ONLY		
Date Received: 5/30/06 Permit Number: _____ Permit Date: 5/31/06 Lease Inspection: <input type="checkbox"/> Yes <input checked="" type="checkbox"/> No		

15-189-22535-0000

KANSAS

CORPORATION COMMISSION

KATHLEEN SEBELIUS, GOVERNOR
BRIAN J. MOLINE, CHAIR
ROBERT E. KREHBIEL, COMMISSIONER
MICHAEL C. MOFFET, COMMISSIONER

June 15, 2006

Vicki Carder
OXY USA, Inc.
P.O. Box 2528
Liberal, KS 67905

Re: Clodfelter B #2, API #15-189-22535-0000
Docket # PVPA 050606
Sec. 14-T34S-R35W
Stevens County, Kansas

Dear Ms. Carder,

The form VPA-1 affidavit filed for the above-referenced well stated that service of the affidavit was mailed on May 25, 2006. The fifteen (15) day protest period has expired and we have not received any protests. Therefore, we are advising you that drilling this well may commence and, in lieu of cement, drilling mud of the weight specified in your affidavit may be used across the interval between the base of the Council Grove group and the top of the Chase group.

Sincerely,

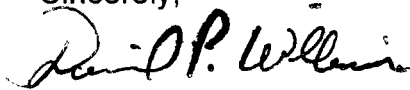

David P. Williams
Production Department

KANSAS

CORPORATION COMMISSION

KATHLEEN SEBELIUS, GOVERNOR

BRIAN J. MOLINE, CHAIR

ROBERT E. TREMBLIS, COMMISSIONER

MICHAEL C. MOTTET, COMMISSIONER

NOTICE TO OPERATORS DRILLING IN THE PANOMA- COUNCIL GROVE GAS POOL SPACED AREA

The enclosed intent is located within the Panoma-Council Grove gas pool space area. In May 1978, Panoma-Council Grove Proration Order (as amended), Docket No. 60,024-C (C-7058) under FINDINGS OF FACT AND LAW on page 31, the following language is stated that:

"The Commission finds that in order to prevent waste and protect correlative rights, the following stated rules pertaining to wells already completed, in the process of being drilled or for future wells to be drilled in the Panoma Council Grove Gas Pool Spaced area, and for wells producing from the Council Grove Formation outside of the Panoma Council Grove Gas Pool Spaced area within the Hugoton Gas Field, should be adopted."

1. "No dual completions between the Chase (Hugoton) and Council Grove Formations will be permitted for future wells drilled."
2. "Casing shall not be set above the top of the Council Grove Formation for a Council Grove producing well."
3. "The production casing of all new Council Grove wells should be cemented with a calculated volume of cement sufficient to encase the casing from the bottom of the casing to a point 500 feet above the Chase Formation."
4. "The casing shall be encased in cement in the interval between the base of the Council Grove and the top of the Chase Formation on all wells, irrespective of depth, completed below the Council Grove Formation, if they are located within the space area."
5. "The cement coverage heretofore required shall be confirmed by the running of a recognized survey, such as a temperature survey or cement bond log."

A copy of this survey and the cement tickets(s) showing that all cement work has been completed, must be filed with the ACO-1 Completion Report within 120 days from the wells "spud date."

Failure to comply with these provisions may cause the well to be shut-in until compliance has been achieved.

If you have any questions, please feel free to contact the Conservation Division's Production Department at (316) 337-6200.