

For KCC Use:
Effective Date: 6-14-06
District # 1
SGA? Yes No

**KANSAS CORPORATION COMMISSION
OIL & GAS CONSERVATION DIVISION
NOTICE OF INTENT TO DRILL**

CORRECTED: 06/13/06 Form C-1

December 2002

CORRECTED

Form must be Typed

Form must be signed

All blanks must be Filled

Must be approved by KCC five (5) days prior to commencing well

Expected Spud Date 06/20/06
month day year

Spot: East West
SE - SW - SE Sec. 16 Twp. 32S R. 34

OPERATOR: License # 5447

642 feet from N / S Line of Section

Name: OXY USA Inc.

1612 feet from E / W Line of Section

Address: P.O. Box 2528

Is SECTION X Regular Irregular?

City/State/Zip: Liberal, KS 67905

(Note: Locate well on the Section Plat on reverse side)

Contact Person: Vicki Carder

County: Seward

Phone: (620) 629-4242

Lease Name: Kapp A Well #: 6

CONTRACTOR: License # 30606

Field Name: Holt

Name: Murfin Drilling Co., Inc.

Is this a Prorated / Spaced Field? Yes No

Well Drilled For: Well Class: Type Equipment:

* Target Formation(s): St. Louis Lansing per operator
Nearest Lease or unit Boundary: 642

- Oil Enh Rec Infield Mud Rotary
 Gas Storage Pool Ext Air Rotary
 OWWO Disposal Wildcat Cable
 Seismic: # of Holes Other
 Other Re-Entry API # 15-175-21808

Ground Surface Elevation: 2926 feet MSL

Water well within one-quarter mile Yes No

Public water supply well within one mile: Yes No

Depth to bottom of fresh water: 540

Depth to bottom of usable water: 600

Surface Pipe by Alternate: 1 2

If OWWO: old well information as follows:

Length of Surface Pipe Planned to be set: 1741

Operator: OXY USA Inc.

Length of Conductor Pipe Required: _____

Well Name: Kapp A-6

* Projected Total Depth: *4450

Original Completion Date: 08/17/00 Original Total Depth: 6350

* Formation at Total Depth: St. Louis Lansing

Water Source for Drilling Operations:

Directional, Deviated or Horizontal wellbore? Yes No

Well Farm Pond Other _____

IF Yes, true vertical depth _____

DWR Permit # _____

Bottom Hole Location _____

(Note: Apply for Permit with DWR)

KCC DKT #: _____

Will Cores be Taken? Yes No

* WAS: Projected Total Depth 6350' Target Fm St. Louis

If Yes, Proposed zone: Fme TO St. Louis

IS: Projected Total Depth 4450'

AFFIDAVIT Target Fm Lansing Fme TO Lansing RECEIVED

The undersigned hereby affirms that the drilling, completion and eventual plugging of this well will comply with K.S.A. 55-101, et. Seq.

It is agreed that the following minimum requirements will be met:

1. Notify the appropriate district office prior to spudding of well;
2. A copy of the approved notice of intent to drill shall be posted on each drilling rig;
3. The minimum amount of surface pipe as specified below shall be set by circulating cement to the top; in all cases surface pipe shall be set through an unconsolidated materials plus a minimum of 20 feet into the underlying formation.
4. If the well is dry hole, an agreement between the operator and the district office on plug length and placement is necessary prior to plugging;
5. The appropriate district office will be notified before well is either plugged or production casing is cemented in;
6. If an ALTERNATE II COMPLETION, production pipe shall be cemented from below any usable water to surface within 120 days of spud date. Or pursuant to Appendix "B" - Eastern Kansas surface casing order #133,891-C, which applies to the KCC District 3 area, alternate II cementing must be completed within 30 days of the spud date or the well shall be plugged. In all cases, NOTIFY district office prior to any cementing.

I hereby certify that the statements made herein are true and to the best of my knowledge and belief.

Date: 06/13/06 Signature of Operator or Agent: Vicki Carder Title: Capital Projects

For KCC Use ONLY 15-175-21808-00-01
API # 15 - 175-21808-00-01
Conductor pipe required None feet
Minimum Surface pipe required 1741 feet per Alt. (1) *
Approved by: put 6-9-06 / put 6-16-06
This authorization expires: 12-9-06
(This authorization void if drilling not started within 6 months of effective date.)
Spud date: _____ Agent: _____

Remember to:

- File Drill Pit Application (form CDP-1) with Intent to Drill;
- File Completion Form ACO-1 within 120 days of spud date;
- File acreage attribution plat according to field proaction orders;
- Notify appropriate district office 48 hours prior to workover or re-entry;
- Submit plugging report (CP-4) after plugging is completed;
- Obtain written approval before disposing or injecting salt water.
- If this permit has expired (see: authorized expiration date) please check the box below and return to the address below.

Well Not Drilled - Permit Expired

Signature of Operator or Agent: _____

Date: _____

Mail to: KCC - Conservation Division, 130 S. Market - Room 2078, Wichita, Kansas 67202

16-3a-34w

IN ALL CASES PLOT THE INTENDED WELL ON THE PLAT BELOW

Plat of acreage attributable to a well in a prorated or spaced field

If the intended well is in a prorated or spaced field, please fully complete this side of the form. If the intended well is in a prorated or spaced field complete the plat below showing that the well will be properly located in relationship to other wells producing from the common source of supply. Please show all the wells and within 1 mile of the boundaries of the proposed acreage attribution unit for gas wells and within 1/2 mile of the boundaries of the proposed acreage attribution unit for oil wells.

API No. 15 - _____
 Operator: _____
 Lease: _____
 Well Number: _____
 Field: _____
 Number of Acres attributable to well: _____
 QTR / QTR / QTR of acreage: _____ - _____ - _____

Location of Well: County _____
 _____ feet from N / S Line of Section
 _____ feet from E / W Line of Section
 Sec. _____ Twp. _____ R. _____ East West
 Is Section Regular or Irregular
IF Section Is Irregular, locate well from nearest corner boundary.
 Section corner used: NE NW SE SW

PLAT

*(Show location of the well and shade attributable acreage for prorated or spaced wells.)
 (Show footage to the nearest lease or unit boundary line.)*

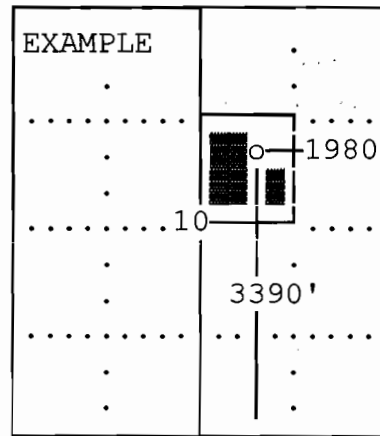
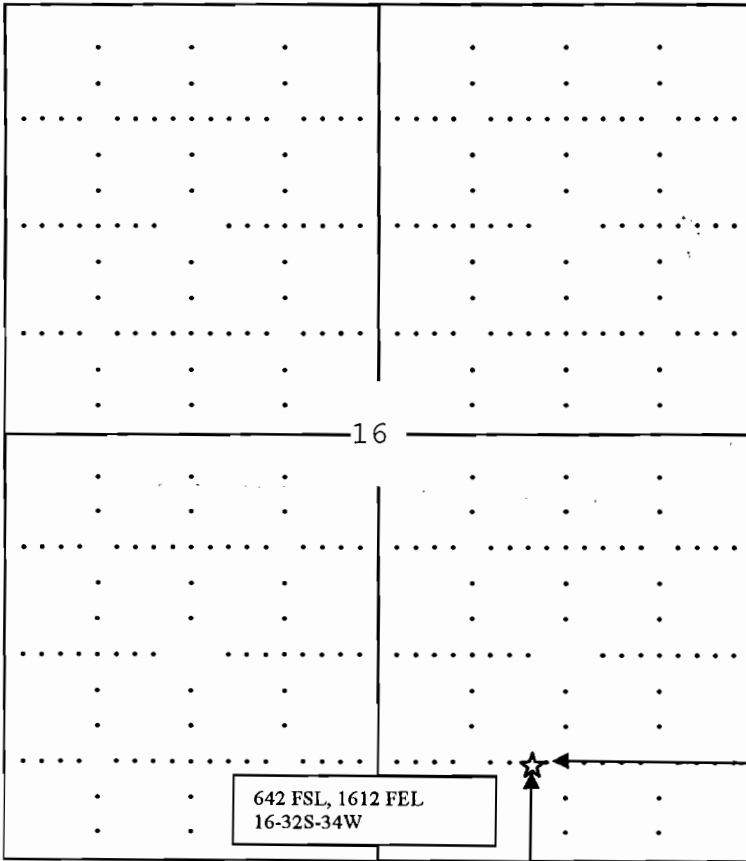

SEWARD CO.

Note: In all cases locate the spot of the proposed drilling location.

Seward County

In plotting the proposed location of the well, you must show:

1. The manner in which you are using the depicted plat by identifying section lines, i.e. 1 section, 1 section with 8 surrounding sections, 4 sections, etc.
2. The distance of the proposed drilling location from the sections south / north and east / west.
3. The distance to the nearest lease or unit boundary line.
4. If proposed location is located within a prorated or spaced field a certificate of acreage attribution plat must be attached: (CO-7 for oil wells; CG-8 for gas wells).