

For KCC Use: 7-206
Effective Date: 4
District # 4
SGA? Yes No

KANSAS CORPORATION COMMISSION
OIL & GAS CONSERVATION DIVISION

NOTICE OF INTENT TO DRILL

Must be approved by KCC five (5) days prior to commencing well

Form C-1
December 2002
Form must be Typed
Form must be Signed
All blanks must be Filled

Expected Spud Date June 26, 2006
month day year

OPERATOR: License# 31725 ✓
Name: Shelby Resources, LLC
Address: P.O. Box 1213
Hays, Kansas 67601
City/State/Zip:
Contact Person: Brian Karlin
Phone: 785-623-3290

CONTRACTOR: License# 8273 ✓
Name: Excell Services, Inc.

Well Drilled For:	Well Class:	Type Equipment:
<input checked="" type="checkbox"/> Oil <input type="checkbox"/> Enh Rec	<input checked="" type="checkbox"/> Infield <input type="checkbox"/> Pool Ext.	<input checked="" type="checkbox"/> Mud Rotary <input type="checkbox"/> Air Rotary
<input type="checkbox"/> Gas <input type="checkbox"/> Storage	<input type="checkbox"/> Wildcat	<input type="checkbox"/> Cable
<input type="checkbox"/> OWWO <input type="checkbox"/> Disposal	<input type="checkbox"/> Other	
<input type="checkbox"/> Seismic; # of Holes		
<input type="checkbox"/> Other		

If OWWO: old well information as follows:
Operator: _____
Well Name: _____
Original Completion Date: _____ Original Total Depth: _____
Directional, Deviated or Horizontal wellbore? Yes No
If Yes, true vertical depth: _____
Bottom Hole Location: _____
KCC DKT #: _____

Spot 5' N & 35' W
NW - SE - SW Sec. 36 Twp. 17 S. R. 14
985' _____ feet from N / S Line of Section
1615' _____ feet from E / W Line of Section
Is SECTION Regular Irregular?

(Note: Locate well on the Section Plat on reverse side)
County: Barton
Lease Name: McCurry Well #: 1-36
Field Name: Boyd
Is this a Prorated / Spaced Field? Yes No
Target Formation(s): Arbuckle
Nearest Lease or unit boundary: 985'
Ground Surface Elevation: 1832' feet MSL
Water well within one-quarter mile: Yes No
Public water supply well within one mile: Yes No
Depth to bottom of fresh water: 200'
Depth to bottom of usable water: 360' 340'
Surface Pipe by Alternate: 1 2
Length of Surface Pipe Planned to be set: ± 800'
Length of Conductor Pipe required: None
Projected Total Depth: 3400'
Formation at Total Depth: Arbuckle
Water Source for Drilling Operations:
 Well Farm Pond Other _____
DWR Permit #: _____

(Note: Apply for Permit with DWR)
Will Cores be taken? Yes No
If Yes, proposed zone: _____

AFFIDAVIT

The undersigned hereby affirms that the drilling, completion and eventual plugging of this well will comply with K.S.A. 55 et. seq.
It is agreed that the following minimum requirements will be met:
1. Notify the appropriate district office **prior** to spudding of well;
2. A copy of the approved notice of intent to drill **shall be** posted on each drilling rig;
3. The minimum amount of surface pipe as specified below **shall be set** by circulating cement to the top; in all cases surface pipe **shall be set** through all **unconsolidated** materials plus a minimum of 20 feet into the underlying formation.
4. If the well is dry hole, an **agreement** between the operator and the district office on plug length and placement is necessary **prior to plugging**;
5. The appropriate **district office** will be notified before well is either plugged or production casing is cemented in;
6. If an ALTERNATE II COMPLETION, production pipe shall be cemented from below any usable water to surface within **120 days** of spud date.
Or pursuant to Appendix "B" - Eastern Kansas surface casing order #133,891-C, which applies to the KCC District 3 area, alternate II cementing must be completed within 30 days of the spud date or the well shall be plugged. **In all cases, NOTIFY district office** prior to any cementing.
I hereby certify that the statements made herein are true and to the best of my knowledge and belief.

Date: June 22, 2006 Signature of Operator or Agent: Brian Karlin Title: Operations Manager

For KCC Use ONLY
API # 15 - 009-24 955-0000
Conductor pipe required None feet
Minimum surface pipe required 360 feet per Alt. (1)
Approved by: Ret 6-27-06
This authorization expires: 12-27-06
(This authorization void if drilling not started within 6 months of approval date.)
Spud date: _____ Agent: _____

Remember to:
- File Drill Pit Application (form CDP-1) with Intent to Drill;
- File Completion Form ACO-1 within 120 days of spud date;
- File acreage attribution plat according to field proration orders;
- Notify appropriate district office 48 hours prior to workover or re-entry;
- Submit plugging report (CP-4) after plugging is completed;
- Obtain written approval before disposing or injecting salt water.
- If this permit has expired (See: authorized expiration date) please check the box below and return to the address below.
 Well Not Drilled - Permit Expired
Signature of Operator or Agent: _____
Date: _____

Mail to: KCC - Conservation Division, 130 S. Market - Room 2078, Wichita, Kansas 67202

RECEIVED
JUN 26 2006
KCC WICHITA

36
17
14W

IN ALL CASES PLOT THE INTENDED WELL ON THE PLAT BELOW

Plat of acreage attributable to a well in a prorated or spaced field

If the intended well is in a prorated or spaced field, please fully complete this side of the form. If the intended well is in a prorated or spaced field complete the plat below showing that the well will be properly located in relationship to other wells producing from the common source of supply. Please show all the wells and within 1 mile of the boundaries of the proposed acreage attribution unit for gas wells and within 1/2 mile of the boundaries of the proposed acreage attribution unit for oil wells.

API No. 15 - 009-24955-0000
 Operator: Shelby Resources, LLC
 Lease: McCurry
 Well Number: 1-36
 Field: Boyd

Number of Acres attributable to well: _____
 QTR / QTR / QTR of acreage: $\frac{NW}{5' \times} - \frac{SE}{35' W} - \frac{SW}{S}$

Location of Well: County: Barton
 985' _____ feet from N / S Line of Section
 1615' _____ feet from E / W Line of Section
 Sec. 36 Twp. 17 S. R. 14 East West

Is Section: Regular or Irregular

If Section is Irregular, locate well from nearest corner boundary.
 Section corner used: NE NW SE SW

PLAT

*(Show location of the well and shade attributable acreage for prorated or spaced wells.)
 (Show footage to the nearest lease or unit boundary line.)*

Barton County

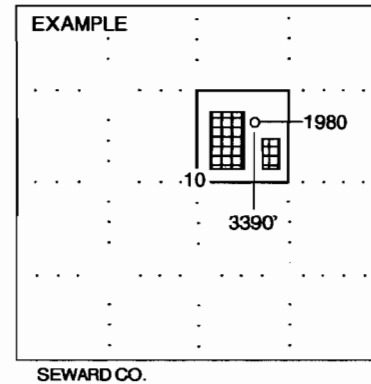
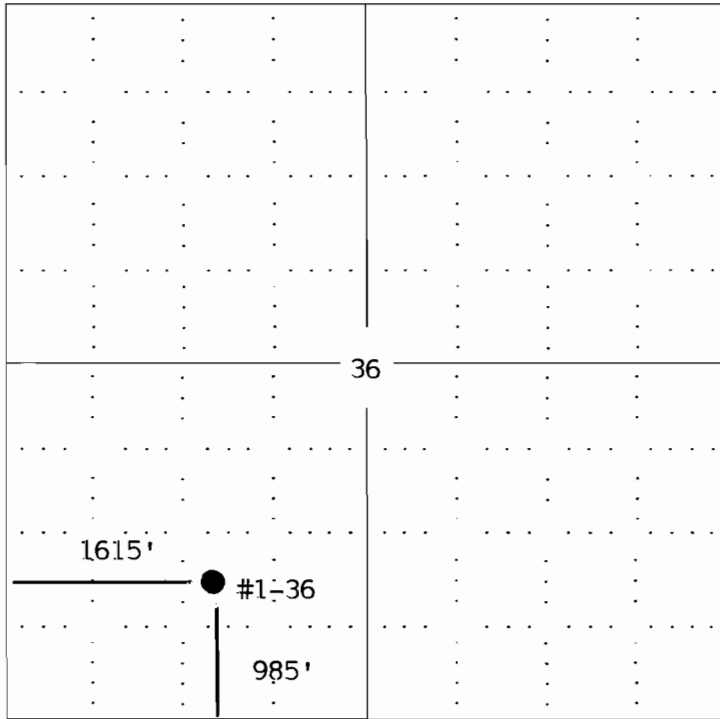

NOTE: In all cases locate the spot of the proposed drilling location.

In plotting the proposed location of the well, you must show:

1. The manner in which you are using the depicted plat by identifying section lines, i.e. 1 section, 1 section with 8 surrounding sections, 4 sections, etc.
2. The distance of the proposed drilling location from the section's south / north and east / west.
3. The distance to the nearest lease or unit boundary line.
4. If proposed location is located within a prorated or spaced field a certificate of acreage attribution plat must be attached: (CO-7 for oil wells; CG-8 for gas wells).

**RECEIVED
 JUN 26 2006
 KCC WICHITA**

KANSAS

CORPORATION COMMISSION

KATHLEEN SEBELIUS, GOVERNOR
BRIAN J. MOLINE, CHAIR
ROBERT E. KREHBIEL, COMMISSIONER
MICHAEL C. MOFFET, COMMISSIONER

June 27, 2006

Mr. Brian Karlin
Shelby Resources, LLC
PO Box 1213
Hays, KS 67601

RE: Drilling Pit Application
McCurry Lease Well No. 1-36
SW/4 Sec. 36-17S-14W
Barton County, Kansas

Dear Mr. Karlin:

District staff has inspected the above referenced location and has determined that the reserve pit shall be constructed **without slots**, the bottom shall be flat and reasonably level, and the free fluids must be removed. The fluids are to be removed from the reserve pit as soon as practical after drilling operations have ceased. **Please keep all pits away from any draws.**

If production casing is set all completion fluids shall be removed from the working pits daily. NO completion fluids or non-exempt wastes shall be placed in the reserve pit.

The fluids should be taken to an authorized disposal well. Please call the District Office at (785) 625-0550 when the fluids have been removed. Please file form CDP-5 (August 2004), Exploration and Production Waste Transfer, within 30 days of fluid removal. Conservation division forms are available through our office and on the KCC web site: www.kcc.state.ks.us/conservation/forms.

A copy of this letter should be posted in the doghouse along with the approved Intent to Drill. If you have any questions or concerns please feel free to contact the undersigned at the above address.

Sincerely,

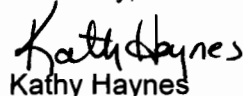

Kathy Haynes
Environmental Protection and Remediation Department

cc: File