

For KCC Use: 7-16-06
Effective Date: 4
District #: 4
SGA? Yes No

KANSAS CORPORATION COMMISSION
OIL & GAS CONSERVATION DIVISION

NOTICE OF INTENT TO DRILL

Must be approved by KCC five (5) days prior to commencing well

OWWO

Form C-1
December 2002

Form must be Typed
Form must be Signed
All blanks must be Filled

Expected Spud Date July 14 2006
month day year

OPERATOR: License# 4472 ✓
Name: NF Producers, Inc.
Address: Box 237
City/State/Zip: Norton, KS 67654
Contact Person: Brett Hildebrand
Phone: 785-874-4827 ✓

CONTRACTOR: License# ALBERTON
Name: ALBERTON

Well Drilled For:	Well Class:	Type Equipment:
<input checked="" type="checkbox"/> Oil ✓	<input type="checkbox"/> Enh Rec	<input checked="" type="checkbox"/> Infield ✓
<input type="checkbox"/> Gas	<input type="checkbox"/> Storage	<input type="checkbox"/> Mud Rotary
<input checked="" type="checkbox"/> OWWO	<input type="checkbox"/> Disposal	<input type="checkbox"/> Pool Ext.
<input type="checkbox"/> Seismic; # of Holes	<input type="checkbox"/> Other	<input type="checkbox"/> Wildcat
<input type="checkbox"/> Other		<input checked="" type="checkbox"/> Cable ✓

If OWWO: old well information as follows:
Operator: Al Abercrombie
Well Name: Huff B #3
Original Completion Date: 11-6-69 Original Total Depth: 3355

Directional, Deviated or Horizontal wellbore? Yes No
If Yes, true vertical depth: _____
Bottom Hole Location: _____
KCC DKT #: _____

Spot 140' N
C- NE SE Sec. 8 Twp. 1 S. R. 26 East West
2120 feet from N / S Line of Section
660 feet from E / W Line of Section
Is SECTION Regular Irregular?

(Note: Locate well on the Section Plat on reverse side)

County: Decatur
Lease Name: Huff B Well #: 3
Field Name: Bless

Is this a Prorated / Spaced Field? Yes No ✓
Target Formation(s): Lansing - Kansas City

Nearest Lease or unit boundary: Alberton 660'
Ground Surface Elevation: 2453 feet MSL

Water well within one-quarter mile: Yes No ✓
Public water supply well within one mile: Yes No ✓

Depth to bottom of fresh water: 60' ±
Depth to bottom of usable water: 1800' 120'

Surface Pipe by Alternate: 1 2
Length of Surface Pipe ~~Planned to be set:~~ 223

Length of Conductor Pipe required: _____
Projected Total Depth: 3400'

Formation at Total Depth: Kansas City

Water Source for Drilling Operations:
 Well Farm Pond Other LSF Water

DWR Permit #: _____
(Note: Apply for Permit with DWR)

Will Cores be taken? Yes No
If Yes, proposed zone: _____

AFFIDAVIT

The undersigned hereby affirms that the drilling, completion and eventual plugging of this well will comply with K.S.A. 55 et. seq.
It is agreed that the following minimum requirements will be met:

1. Notify the appropriate district office **prior** to spudding of well;
2. A copy of the approved notice of intent to drill **shall be** posted on each drilling rig;
3. The minimum amount of surface pipe as specified below **shall be set** by circulating cement to the top; in all cases surface pipe **shall be set** through all unconsolidated materials plus a minimum of 20 feet into the underlying formation.
4. If the well is dry hole, an agreement between the operator and the district office on plug length and placement is necessary **prior to plugging**;
5. The appropriate district office will be notified before well is either plugged or production casing is cemented in;
6. If an ALTERNATE II COMPLETION, production pipe shall be cemented from below any usable water to surface within **120 days** of spud date.
Or pursuant to Appendix "B" - Eastern Kansas surface casing order #133,891-C, which applies to the KCC District 3 area, alternate II cementing must be completed within 30 days of the spud date or the well shall be plugged. **In all cases, NOTIFY district office** prior to any cementing.

I hereby certify that the statements made herein are true and to the best of my knowledge and belief.

Date: 7-30-06 Signature of Operator or Agent: Brett Hildebrand Title: Superintendent

RECEIVED
JUL 05 2006
KCC WICHITA

For KCC Use ONLY
API # 15 - 639-20113-00-01
Conductor pipe required None feet
Minimum surface pipe required 223 feet per Alt. X(2)
Approved by: 7-11-06
This authorization expires: 1-11-07
(This authorization void if drilling not started within 6 months of approval date.)
Spud date: _____ Agent: _____

Remember to:

- File Drill Pit Application (form CDP-1) with Intent to Drill;
- File Completion Form ACO-1 within 120 days of spud date;
- File acreage attribution plat according to field proration orders;
- Notify appropriate district office 48 hours prior to workover or re-entry;
- Submit plugging report (CP-4) after plugging is completed;
- Obtain written approval before disposing or injecting salt water.
- If this permit has expired (See: authorized expiration date) please check the box below and return to the address below.

Well Not Drilled - Permit Expired

Signature of Operator or Agent: _____
Date: _____

Mail to: KCC - Conservation Division, 130 S. Market - Room 2078, Wichita, Kansas 67202

RECEIVED
JUL 10 2006
KCC WICHITA

IN ALL CASES PLOT THE INTENDED WELL ON THE PLAT BELOW

Plat of acreage attributable to a well in a prorated or spaced field

If the intended well is in a prorated or spaced field, please fully complete this side of the form. If the intended well is in a prorated or spaced field complete the plat below showing that the well will be properly located in relationship to other wells producing from the common source of supply. Please show all the wells and within 1 mile of the boundaries of the proposed acreage attribution unit for gas wells and within 1/2 mile of the boundaries of the proposed acreage attribution unit for oil wells.

API No. 15 - 039-20113 - 00-01
 Operator: NF Producers
 Lease: Huff B
 Well Number: 3
 Field: Blees

Number of Acres attributable to well: 10
 QTR / QTR / QTR of acreage: C - NE - SE

Location of Well: County: Decatur
2120 feet from N / S Line of Section
660 feet from E / W Line of Section
 Sec. 8 Twp. 1 S. R. 26 East West

Is Section: Regular or Irregular

If Section is Irregular, locate well from nearest corner boundary.

Section corner used: NE NW SE SW

PLAT

(Show location of the well and shade attributable acreage for prorated or spaced wells.)

(Show footage to the nearest lease or unit boundary line.)

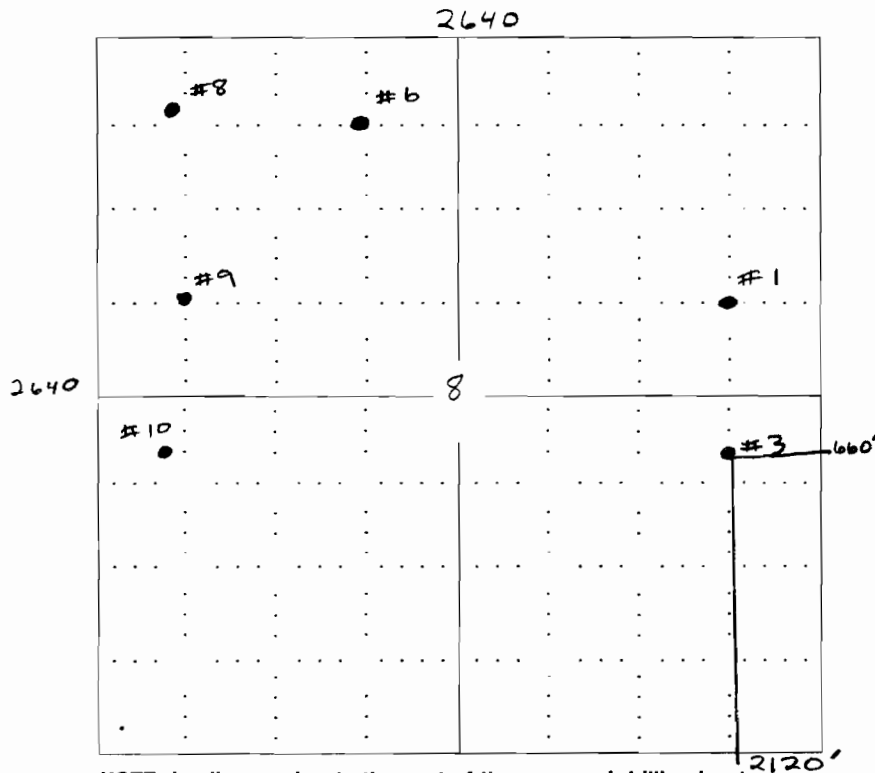

RECEIVED
 JUN 5 2006
KCC WICHITA

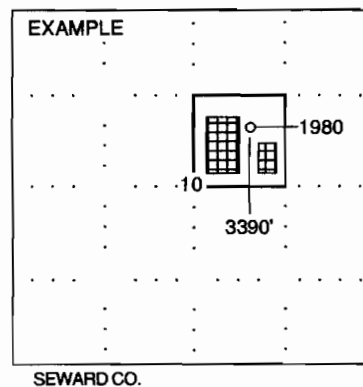

NOTE: In all cases locate the spot of the proposed drilling location.

In plotting the proposed location of the well, you must show:

1. The manner in which you are using the depicted plat by identifying section lines, i.e. 1 section, 1 section with 8 surrounding sections, 4 sections, etc.
2. The distance of the proposed drilling location from the section's south / north and east / west.
3. The distance to the nearest lease or unit boundary line.
4. If proposed location is located within a prorated or spaced field a certificate of acreage attribution plat must be attached: (CO-7 for oil wells, CG-8 for gas wells).

RECEIVED
 JUL 10 2006
KCC WICHITA

**KANSAS CORPORATION COMMISSION
OIL & GAS CONSERVATION DIVISION
APPLICATION FOR SURFACE PIT**

Form CDP-1
April 2004
Form must be Typed

Submit in Duplicate

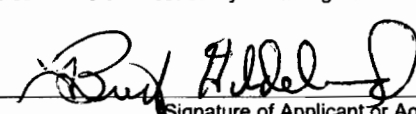
Operator Name: NF Producers		License Number: 4472
Operator Address: Box 237, Norton, KS 67654		
Contact Person: Brett Hildebrand		Phone Number: (785) 874 - 4827
Lease Name & Well No.: Huff B #3		Pit Location (QQQQ): C NE SE
Type of Pit: <input type="checkbox"/> Emergency Pit <input type="checkbox"/> Burn Pit <input type="checkbox"/> Settling Pit <input checked="" type="checkbox"/> Drilling Pit <input checked="" type="checkbox"/> Workover Pit <input type="checkbox"/> Haul-Off Pit <small>(If WP Supply API No. or Year Drilled)</small>	Pit is: <input checked="" type="checkbox"/> Proposed <input type="checkbox"/> Existing If Existing, date constructed: Pit capacity: 160 (bbls)	Sec. 8 Twp. 1 R. 26 <input type="checkbox"/> East <input checked="" type="checkbox"/> West 2120 Feet from <input type="checkbox"/> North / <input checked="" type="checkbox"/> South Line of Section 660 Feet from <input checked="" type="checkbox"/> East / <input type="checkbox"/> West Line of Section Decatur County
Is the pit located in a Sensitive Ground Water Area? <input checked="" type="checkbox"/> Yes <input checked="" type="checkbox"/> No		Chloride concentration: _____ mg/l <small>(For Emergency Pits and Settling Pits only)</small>
Is the bottom below ground level? <input checked="" type="checkbox"/> Yes <input type="checkbox"/> No	Artificial Liner? <input checked="" type="checkbox"/> Yes <input type="checkbox"/> No	How is the pit lined if a plastic liner is not used?
Pit dimensions (all but working pits): _____ Length (feet) _____ Width (feet) N/A: Steel Pits Depth from ground level to deepest point: _____ ⁶ (feet)		
If the pit is lined give a brief description of the liner material, thickness and installation procedure. Plastic, 6mm liner installed by rig crew and anchored by pit dirt on outer edges.		Describe procedures for periodic maintenance and determining liner integrity, including any special monitoring.
Distance to nearest water well within one-mile of pit 2970 ²⁴³⁴ feet Depth of water well 61 feet		Depth to shallowest fresh water 20 feet. Source of information: KH KCS  _____ measured _____ well owner _____ electric log _____ KDWR
Emergency, Settling and Burn Pits ONLY: Producing Formation: _____ Number of producing wells on lease: _____ Barrels of fluid produced daily: _____ Does the slope from the tank battery allow all spilled fluids to flow into the pit? <input type="checkbox"/> Yes <input type="checkbox"/> No		Drilling, Workover and Haul-Off Pits ONLY: Type of material utilized in drilling/workover: Plastic Number of working pits to be utilized: 1 Abandonment procedure: Suck pit dry with vac truck and push in with backhoe Drill pits must be closed within 365 days of spud date.
I hereby certify that the above statements are true and correct to the best of my knowledge and belief.		
_____ June 30, 2006 Date		 Signature of Applicant or Agent
KCC OFFICE USE ONLY		
Date Received: 7/10/06 Permit Number: _____ Permit Date: 7/10/06 Lease Inspection: <input type="checkbox"/> Yes <input checked="" type="checkbox"/> No		

Mail to: KCC - Conservation Division, 130 S. Market - Room 2078, Wichita, Kansas 67202

**RECEIVED
JUL 10 2006
KCC WICHITA**

15-039-20113-00-01

TO:
STATE CORPORATION COMMISSION
CONSERVATION DIVISION - PLUGGING
130 SOUTH MARKET, SUITE 2078
WICHITA, KANSAS 67202

API Well Number: 15-039-20113-00-00
Spot: NESE Sec/Twnshp/Rge: 8-1S-26W
2120 feet from S Section Line, 660 feet from E Section Line
Lease/Unit Name: HUFF B Well Number: 3
County: DECATUR Total Vertical Depth: 3560 feet

Operator License No.: 4472
Op Name: N.F. PRODUCERS, INC.
Address: 940 WADSWORTH - #300
LAKWOOD, CO 80215

Conductor Pipe: Size feet: 8 1/2
Surface Casing: Size 7.625 feet: 223 w/125 sxs cmt
Production: Size 4.5 feet: 3453 w/375 sxs cmt
Liner: Size feet:

Well Type: OIL UIC Docket No: Date/Time to Plug: 07/26/2002 12:15 PM
Plug Co. License No.: 4472 Plug Co. Name: N.F. PRODUCERS, INC.
Proposal Rcvd. from: HAROLD BELLERIEVE Company: N.F. PRODUCERS, INC. Phone: (303) 232-2707

Proposed Plugging Method: Order 225 sxs 60/40 pozmix - 10% gel and hulls.
Plug with tubing.

Plugging Proposal Received By: HERB DEINES Witness Type: Plugging Operations Were Not Witnessed
Date/Time Plugging Completed: 07/26/2002 3:00 PM KCC Agent: HERB DEINES

Actual Plugging Report:

7 5/8" to 223' w/125 sxs. 4 1/2" to 3453' w/375 sxs.
Perf 1986' and squeezed with 200 sxs. Other undocumented squeezes to repair hole in casing.
CIBP at 3150'. Ran tubing and tagged CIBP.
Pulled up 10' and pumped 75 sxs cement.
Pulled tubing to 1650' and circulated cement with 55 sxs.
Pulled tubing and tied onto production casing.
Pumped 10 sxs cement with Max. P.S.I. 800#. S.I.P. 300#.
Annulus full of cement.

RECEIVED
AUG 01 2002
KCC WICHITA

Remarks: ALLIED CEMENTING COMPANY.

Plugged through: TBG

District: 04

Signed



(TECHNICIAN)

INVOICED

Form CP-2/3

DATE 8-5-02

INV. NO. 2003060154

JUL 31 2002