

For KCC Use: 7-16-06
 Effective Date: 4
 District #: 4
 SGA? Yes No

KANSAS CORPORATION COMMISSION
 OIL & GAS CONSERVATION DIVISION
NOTICE OF INTENT TO DRILL

OWWO

Form C-1
 December 2002
Form must be Typed
Form must be Signed
All blanks must be Filled

Must be approved by KCC five (5) days prior to commencing well

Expected Spud Date August 1 2006
month day year

Spot East
 NW NE SE Sec. 33 Twp. 15 S. R. 20 West
2310 feet from N / S Line of Section
990 feet from E / W Line of Section
 Is SECTION Regular Irregular?

OPERATOR: License# 33786
 Name: Double "D" s LLC
 Address: P.O. Box 668 133 E 12th St.
 City/State/Zip: Hays, Kansas 67601
 Contact Person: Duane Bieker
 Phone: 785-230-0113

(Note: Locate well on the Section Plat on reverse side)
 County: Ellis
 Lease Name: Staab/Moran Well #: 1
 Field Name: Wallace

CONTRACTOR: License# 4356-33771
 Name: Ultimate Well Service

Is this a Prorated / Spaced Field? Yes No
 Target Formation(s): Conglomerate Sand

<input type="checkbox"/> Oil	<input type="checkbox"/> Enh Rec	<input checked="" type="checkbox"/> Infield	<input type="checkbox"/> Mud Rotary
<input type="checkbox"/> Gas	<input type="checkbox"/> Storage	<input type="checkbox"/> Pool Ext.	<input type="checkbox"/> Air Rotary
<input checked="" type="checkbox"/> OWD	<input type="checkbox"/> Disposal	<input type="checkbox"/> Wildcat	<input checked="" type="checkbox"/> Cable
<input type="checkbox"/> Seismic; # of Holes	<input type="checkbox"/> Other		

Nearest Lease or unit boundary:
 Ground Surface Elevation: 2225 east Topo feet MSL

If OWWO: old well information as follows:
 Operator: Rains & Williamson Oil Company
 Well Name: Moran #3
 Original Completion Date: 3/20/1969 Original Total Depth: 3929

Water well within one-quarter mile: Yes No
 Public water supply well within one mile: Yes No

Directional, Deviated or Horizontal wellbore? Yes No
 If Yes, true vertical depth: _____
 Bottom Hole Location: _____
 KCC DKT #: _____

Depth to bottom of fresh water: 140'
 Depth to bottom of usable water: 600'

Surface Pipe by Alternate: 1 2
 Length of Surface Pipe ~~Planned to be set:~~ 554

Length of Conductor Pipe required: _____
 Projected Total Depth: 3929'
 Formation at Total Depth: 3918'

Water Source for Drilling Operations:
 Well Farm Pond Other saltwater

DWR Permit #: _____
 (Note: Apply for Permit with DWR)
 Will Cores be taken? Yes No
 If Yes, proposed zone: _____

AFFIDAVIT

The undersigned hereby affirms that the drilling, completion and eventual plugging of this well will comply with K.S.A. 55 et. seq.
 It is agreed that the following minimum requirements will be met:

RECEIVED
 JUL 10 2006
 KCC WICHITA

1. Notify the appropriate district office **prior** to spudding of well;
2. A copy of the approved notice of intent to drill **shall be** posted on each drilling rig;
3. The minimum amount of surface pipe as specified below **shall be set** by circulating cement to the top; in all cases surface pipe **shall be set** through all unconsolidated materials plus a minimum of 20 feet into the underlying formation.
4. If the well is dry hole, an agreement between the operator and the district office on plug length and placement is necessary **prior to plugging**;
5. The appropriate district office will be notified before well is either plugged or production casing is cemented in;
6. If an ALTERNATE II COMPLETION, production pipe shall be cemented from below any usable water to surface within **120 days** of spud date.
 Or pursuant to Appendix "B" - Eastern Kansas surface casing order #133,891-C, which applies to the KCC District 3 area, alternate II cementing must be completed within 30 days of the spud date or the well shall be plugged. **in all cases, NOTIFY district office** prior to any cementing.

I hereby certify that the statements made herein are true and to the best of my knowledge and belief.

Date: 7/7/06 Signature of Operator or Agent: Duane Bieker Title: owner/partner

For KCC Use ONLY
 API # 15 - 051-20393-00-01
 Conductor pipe required None feet
 Minimum surface pipe required 554 feet per Alt. X(2)
 Approved by: Part 7-11-06
 This authorization expires: 1-11-07
 (This authorization void if drilling not started within 6 months of approval date.)
 Spud date: _____ Agent: _____

Remember to:

- File Drill Pit Application (form CDP-1) with Intent to Drill;
- File Completion Form ACO-1 within 120 days of spud date;
- File acreage attribution plat according to field proration orders;
- Notify appropriate district office 48 hours prior to workover or re-entry;
- Submit plugging report (CP-4) after plugging is completed;
- Obtain written approval before disposing or injecting salt water.
- If this permit has expired (See: authorized expiration date) please check the box below and return to the address below.

Well Not Drilled - Permit Expired
 Signature of Operator or Agent: _____
 Date: _____

Mall to: KCC - Conservation Division, 130 S. Market - Room 2078, Wichita, Kansas 67202

33
 15
 20w

IN ALL CASES PLOT THE INTENDED WELL ON THE PLAT BELOW

Plat of acreage attributable to a well in a prorated or spaced field

If the intended well is in a prorated or spaced field, please fully complete this side of the form. If the intended well is in a prorated or spaced field complete the plat below showing that the well will be properly located in relationship to other wells producing from the common source of supply. Please show all the wells and within 1 mile of the boundaries of the proposed acreage attribution unit for gas wells and within 1/2 mile of the boundaries of the proposed acreage attribution unit for oil wells.

API No. 15 - 051-20393-00-01
Operator: Double "D" s LLC
Lease: Staab/Moran
Well Number: 1
Field: Wallace

Number of Acres attributable to well: _____
QTR / QTR / QTR of acreage: NW - NE - SE

Location of Well: County: Ellis
2310 feet from N / S Line of Section
990 feet from E / W Line of Section
Sec. 33 Twp. 15 S. R. 20 East West

Is Section: Regular or Irregular

If Section is Irregular, locate well from nearest corner boundary.

Section corner used: NE NW SE SW

PLAT

*(Show location of the well and shade attributable acreage for prorated or spaced wells.)
(Show footage to the nearest lease or unit boundary line.)*

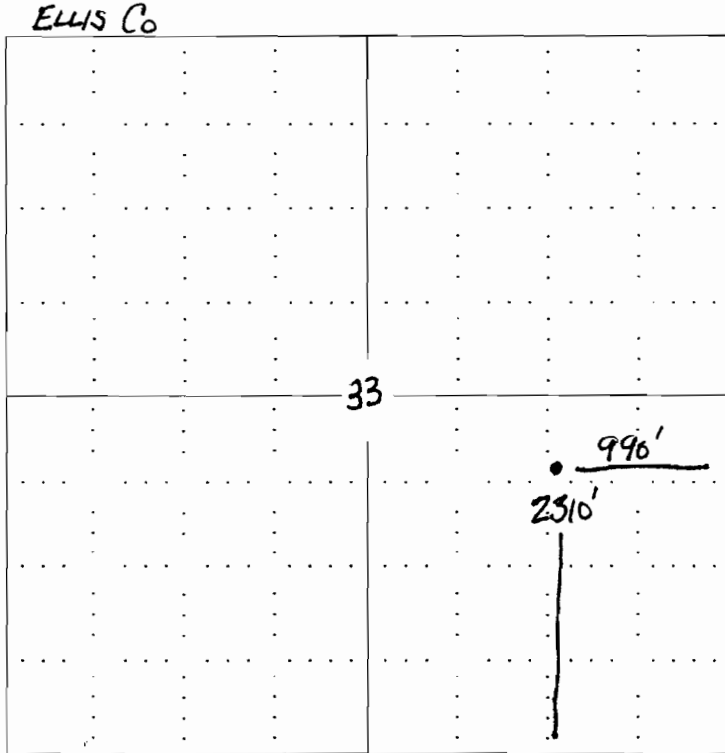

RECEIVED
JUL 10 2006
KCC WICHITA

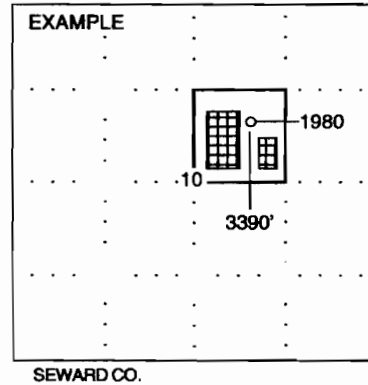

NOTE: In all cases locate the spot of the proposed drilling locaton.

In plotting the proposed location of the well, you must show:

1. The manner in which you are using the depicted plat by identifying section lines, i.e. 1 section, 1 section with 8 surrounding sections, 4 sections, etc.
2. The distance of the proposed drilling location from the section's south / north and east / west.
3. The distance to the nearest lease or unit boundary line.
4. If proposed location is located within a prorated or spaced field a certificate of acreage attribution plat must be attached: (CO-7 for oil wells; CG-8 for gas wells).

**KANSAS CORPORATION COMMISSION
OIL & GAS CONSERVATION DIVISION
APPLICATION FOR SURFACE PIT**

Form CDP-1
April 2004
Form must be Typed

Submit in Duplicate

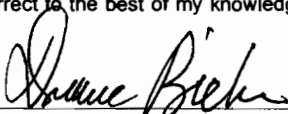
Operator Name: Double "D" s LLC		License Number: 33786
Operator Address: P.O. Box 668		
Contact Person: Duane Bieker		Phone Number: (785) 230 - 0113
Lease Name & Well No.: #1 Staab/Moran		Pit Location (QQQQ): nw - ne - se - Sec. 33 Twp. 15 R. 20 <input type="checkbox"/> East <input checked="" type="checkbox"/> West 2310 Feet from <input type="checkbox"/> North / <input checked="" type="checkbox"/> South Line of Section 990 Feet from <input checked="" type="checkbox"/> East / <input type="checkbox"/> West Line of Section ELLIS County
Type of Pit: <input type="checkbox"/> Emergency Pit <input type="checkbox"/> Burn Pit <input type="checkbox"/> Settling Pit <input checked="" type="checkbox"/> Drilling Pit <input checked="" type="checkbox"/> Workover Pit <input type="checkbox"/> Haul-Off Pit <small>(If WP Supply API No. or Year Drilled)</small>	Pit is: <input checked="" type="checkbox"/> Proposed <input type="checkbox"/> Existing If Existing, date constructed: _____ Pit capacity: 200 (bbls)	
Is the pit located in a Sensitive Ground Water Area? <input type="checkbox"/> Yes <input checked="" type="checkbox"/> No		Chloride concentration: _____ mg/l <small>(For Emergency Pits and Settling Pits only)</small>
Is the bottom below ground level? <input checked="" type="checkbox"/> Yes <input type="checkbox"/> No	Artificial Liner? <input checked="" type="checkbox"/> Yes <input type="checkbox"/> No	How is the pit lined if a plastic liner is not used?
Pit dimensions (all but working pits): 15' Length (feet) 6' Width (feet) N/A: Steel Pits Depth from ground level to deepest point: 8' (feet)		
If the pit is lined give a brief description of the liner material, thickness and installation procedure. regular Plastic pit liner		Describe procedures for periodic maintenance and determining liner integrity, including any special monitoring. RECEIVED JUL 10 2006 KCC WICHITA
Distance to nearest water well within one-mile of pit N/A feet Depth of water well _____ feet		Depth to shallowest fresh water _____ feet. Source of information: _____ measured _____ well owner _____ electric log _____ KDWR
Emergency, Settling and Burn Pits ONLY: Producing Formation: _____ Number of producing wells on lease: _____ Barrels of fluid produced daily: _____ Does the slope from the tank battery allow all spilled fluids to flow into the pit? <input type="checkbox"/> Yes <input type="checkbox"/> No		Drilling, Workover and Haul-Off Pits ONLY: Type of material utilized in drilling/workover: salt water Number of working pits to be utilized: 2 Abandonment procedure: haul off any water and refill pit Drill pits must be closed within 365 days of spud date.
I hereby certify that the above statements are true and correct to the best of my knowledge and belief.		
7/7/06 Date		 Signature of Applicant or Agent
KCC OFFICE USE ONLY		
Date Received: 7/10/06 Permit Number: _____ Permit Date: 7/10/06 Lease Inspection: <input type="checkbox"/> Yes <input checked="" type="checkbox"/> No		

15-051-20393-00-01

Mail to: KCC - Conservation Division, 130 S. Market - Room 2078, Wichita, Kansas 67202

OF KANSAS
CORPORATION COMMISSION
Colorado Derby Building
Wichita, Kansas. 67202

WELL PLUGGING RECORD
K.A.R.-82-3-117

15-051-20393-00-00

API NUMBER 2-13-69

LEASE NAME Naran

WELL NUMBER #3

Approx. 2310 Ft. from S Section Line

Approx. 990 Ft. from E Section Line

SEC. 33 TWP. 15S RGE. 20 (S) or (W)

COUNTY Ellis

Date Well Completed 2-13-69

Plugging Commenced 9-25-87

Plugging Completed 9-25-87

TYPE OR PRINT
NOTICE: Fill out completely
and return to Cons. Div.
office within 30 days.

LEASE OPERATOR Rains & Williamson Oil Co. Inc.

ADDRESS 435 Page Court, 220 W. Douglas, Wichita, Kan.

PHONE # (316) 265-9686 OPERATORS LICENSE NO. 5146

Character of Well Oil

(Oil, Gas, D&A, SWD, Input, Water Supply Well)

Did you notify the KCC/KDHE Joint District Office prior to plugging this well? Yes

Which KCC/KDHE Joint Office did you notify? Hays

Is ACO-1 filed? Yes If not, is well log attached? _____

Producing Formation Conglom. Sand Depth to Top 3919 Bottom 3927 T.D. 3927

Show depth and thickness of all water, oil and gas formations.

OIL, GAS OR WATER RECORDS

CASING RECORD

Formation	Content	From	To	Size	Put In	Pulled out
<u>Conglom. Sand</u>	<u>Oil</u>	<u>3919</u>	<u>3927</u>	<u>5 1/2</u>	<u>3922</u>	<u>None</u>

Describe in detail the manner in which the well was plugged, indicating where the mud fluid was placed and the method or methods used in introducing it into the hole. If cement or other plugs were used, state the character, of same and depth placed, from feet to feet each set.
B-J Titan to plug. Hooked on to 5 1/2 casing, pumped in 155 sk. thrifty mix cement mixed with 4 sk. balls. Max. pressure 1200 lbs. Shut in at 500 lbs. State agent Ed Schumacher.

(If additional description is necessary, use BACK of this form.)

Name of Plugging Contractor Paul Stephens License No. 683

Address P.O. Box 166 Pratt, Kansas

STATE OF Kansas COUNTY OF Pratt, ss.

Rains & Williamson Oil Co. Inc. (Employee of Operator) or (Operator) of above-described well, being first duly sworn on oath, says: That I have knowledge of the facts, statements, and matters herein contained and the log of the above-described well as filed the same are true and correct, so help me God.

(Signature) Paul Stephens
(Address) Pratt, Kansas

SUBSCRIBED AND SWORN TO before me this 1st day of Oct, 19 87

Mary Alice Rupp
Notary Public

My Commission Expires: 2-29-88

