

RECEIVED

KANSAS CORPORATION COMMISSION OIL & GAS CONSERVATION DIVISION

Form C-1 December 2002 Form must be Typed Form must be Signed All blanks must be Filled

For KCC Use: Effective Date: 7-23-06 District # 4 SGA? Yes No

NOTICE OF INTENT TO DRILL

Must be approved by KCC five (5) days prior to commencing well

CONSERVATION DIVISION WICHITA, KS

Expected Spud Date July 22, 2006 month day year

Spot 170'S & 170'E of C SE Sec. 18 Twp. 20 S. R. 12 feet from N/S Line of Section feet from E/W Line of Section Is SECTION X Regular Irregular?

OPERATOR: License# 4058 Name: AMERICAN WARRIOR, INC. Address: P. O. Box 399 City/State/Zip: Garden City, Kansas 67846-0399 Contact Person: Cecil O'Brate Phone: 620/275-9231

County: Barton Lease Name: ROSE Well #: 1-18 Field Name: Is this a Prorated / Spaced Field? Yes No

CONTRACTOR: License# 5929 Name: DUKE DRILLING CO., INC.

Well Drilled For: Oil Gas OWWO Seismic Other Well Class: Enh Rec Storage Disposal Wildcat Other Type Equipment: Mud Rotary Air Rotary Cable

Target Information(s): Arbuckle Nearest Lease or unit boundary: 1150' Ground Surface Elevation: Est 1860 TOPO Water well within one-quarter mile: Public water supply well within one mile: Depth to bottom of fresh water: 120' Depth to bottom of usable water: 180' 230' Surface Pipe by Alternate: 1 2 Length of Surface Pipe Planned to be set: 300' Length of Conductor Pipe required: N/A Projected Total Depth: 3600' Formation at Total Depth: Arbuckle Water Source for Drilling Operations: Well Farm Pond Other X DWR Permit #:

If OWWO: old well information as follows: Operator: Well Name: Original Completion Date: Original Total Depth:

Directional, Deviated or Horizontal wellbore? Yes No If Yes, true vertical depth: Bottom Hole Location: KCC DKT #:

(Note: Apply for Permit with DWR) Will Cores be taken? Yes No If Yes, proposed zone:

AFFIDAVIT

The undersigned hereby affirms that the drilling, completion and eventual plugging of this well will comply with K.S.A. 55 et. seq.

It is agreed that the following minimum requirements will be met:

- 1. Notify the appropriate district office prior to spudding of well; 2. A copy of the approved notice of intent to drill shall be posted on each drilling rig; 3. The minimum amount of surface pipe as specified below shall be set by circulating cement to the top; in all cases surface pipe shall be set through all unconsolidated materials plus a minimum of 20 feet into the underlying formation. 4. If the well is dry hole, an agreement between the operator and the district office on plug length and placement is necessary prior to plugging; 5. The appropriate district office will be notified before well is either plugged or production casing is cemented in; 6. If an ALTERNATE II COMPLETION, production pipe shall be cemented from below any usable water to surface within 120 days of spud date. Or pursuant to Appendix "B" - Eastern Kansas surface casing order #133,891-C, which applies to the KCC District 3 area, alternate II cementing must be completed within 30 days of the spud date or the well shall be plugged. In all cases, NOTIFY district office prior to any cementing.

I hereby certify that the statements made herein are true and to the best of my knowledge and belief.

Date: 7/18/06 Signature of Operator or Agent: Sally R. Byers Title: Agent Remember to:

For KCC Use ONLY API # 15 - 009-24963-0000 Conductor pipe required None feet Minimum surface pipe required 250 feet per Alt. 1 Approved by: 7-18-06 This authorization expires: 1-18-07 (This authorization void if drilling not started within 6 months of effective date.) Spud date: Agent:

- File Drill Pit Application (form CDP-1) with Intent to Drill; - File Completion Form ACO-1 within 120 days of spud date; - File acreage attribution plat according to field proration orders; - Notify appropriate district office 48 hours prior to workover or re-entry; - Submit plugging report (CP-4) after plugging is completed; - Obtain written approval before disposing or injecting salt water. - If this permit has expired (See: authorized expiration date) please check the box below and return to the address below. Well Not Drilled - Permit Expired Signature of Operator or Agent: Date:

Mail to: KCC - Conservation Division, 130 S. Market - Room 2078, Wichita, Kansas 67202

18 20 12W

**IN ALL CASES PLOT THE INTENDED WELL ON THE PLAT BELOW**

*Plat of acreage attributable to a well in a prorated or spaced field*

If the intended well is in a prorated or spaced field, please fully complete this side of the form. If the intended well is in a prorated or spaced field complete the plat below showing that the well will be properly located in relationship to other wells producing from the common source of supply. Please show all the wells and within 1 mile of the boundaries of the proposed acreage attribution unit for gas wells and within 1/2 mile of the boundaries of the proposed acreage attribution unit for oil wells.

API No. 15 - 009-24963-0000  
 Operator: \_\_\_\_\_  
 Lease: \_\_\_\_\_  
 Well Number: \_\_\_\_\_  
 Field: \_\_\_\_\_  
 Number of Acres attributable to well: \_\_\_\_\_  
 QTR / QTR / QTR of acreage: \_\_\_\_\_ - \_\_\_\_\_ - \_\_\_\_\_

Location of Well: County: \_\_\_\_\_  
 \_\_\_\_\_ feet from  N /  S Line of Section  
 \_\_\_\_\_ feet from  E /  W Line of Section  
 Sec. \_\_\_\_\_ Twp. \_\_\_\_\_ S. R. \_\_\_\_\_  East  West

Is Section:  Regular or  Irregular

If Section is Irregular, locate well from nearest corner boundary.  
 Section corner used:  NE  NW  SE  SW

**PLAT**

*(Show location of the well and shade attributable acreage for prorated or spaced wells.)  
 (Show footage to the nearest lease or unit boundary line.)*

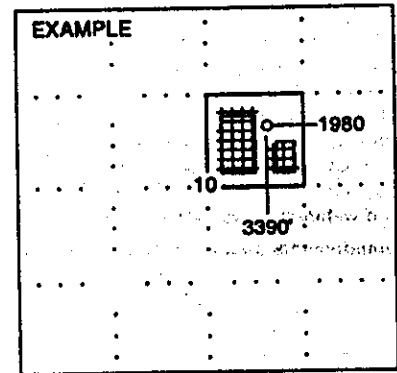
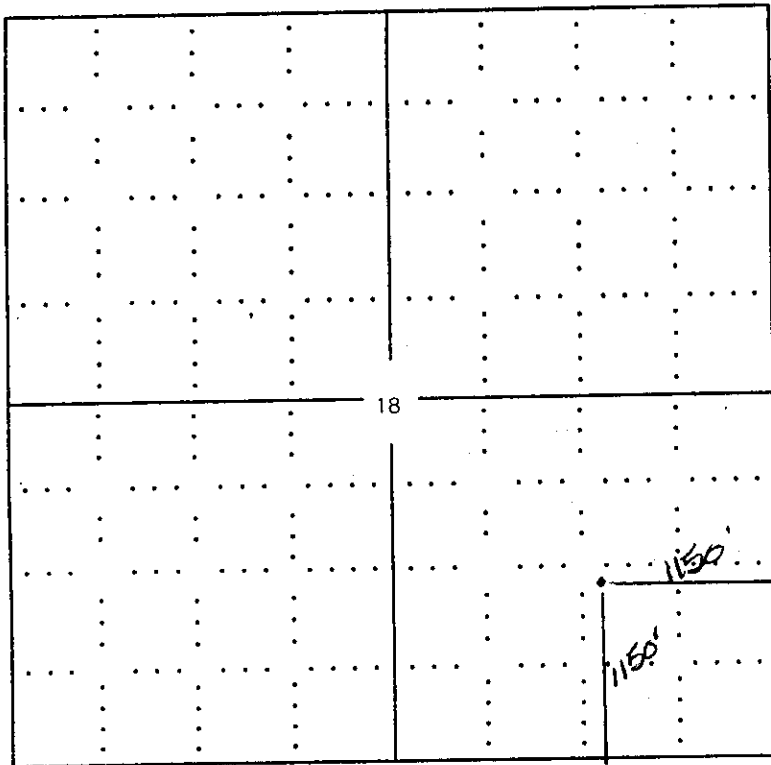

**NOTE: In all cases locate the spot of the proposed drilling location.**

BARTON COUNTY

**In plotting the proposed location of the well, you must show:**

1. The manner in which you are using the depicted plat by identifying section lines, i.e. 1 section, 1 section with 8 surrounding sections, 4 sections, etc.
2. The distance of the proposed drilling location from the section's south / north and east / west.
3. The distance to the nearest lease or unit boundary line.
4. If proposed location is located within a prorated or spaced field a certificate of acreage attribution plat must be attached: (CO-7 for oil wells; CG-8 for gas wells).

KANSAS CORPORATION COMMISSION  
OIL & GAS CONSERVATION DIVISION

RECEIVED  
KANSAS CORPORATION COMMISSION

JUL 18 2006

Form CDP-1  
April 2004  
Form must be Typed

APPLICATION FOR SURFACE PIT

CONSERVATION DIVISION  
WICHITA, KS

Submit in Duplicate

Operator Name: <b>AMERICAN WARRIOR, INC.</b>		License Number: <b>4058</b>
Operator Address: <b>P. O. Box 399, Garden City, Kansas 67846-0399</b>		
Contact Person: <b>Cecil O'Brate</b>		Phone Number: ( <b>620</b> ) <b>275 - 9231</b>
Lease Name & Well No.: <b>ROSE #1-18</b>		Pit Location (QQQQ): 170'S & 170'E of <u>    C    </u> SE Sec. <u>18</u> Twp. <u>20S</u> R. <u>12</u> <input type="checkbox"/> East <input checked="" type="checkbox"/> West <u>1150</u> Feet from <input type="checkbox"/> North / <input checked="" type="checkbox"/> South Line of Section <u>1150</u> Feet from <input checked="" type="checkbox"/> East / <input type="checkbox"/> West Line of Section <u>Barton</u> County
Type of Pit: <input type="checkbox"/> Emergency Pit <input type="checkbox"/> Burn Pit <input type="checkbox"/> Settling Pit <input checked="" type="checkbox"/> Drilling Pit <input type="checkbox"/> Workover Pit <input type="checkbox"/> Haul-Off Pit <small>(If WP Supply API No. or Year Drilled)</small>	Pit is: <input checked="" type="checkbox"/> Proposed <input type="checkbox"/> Existing If Existing, date constructed: _____ Pit capacity: _____ (bbls)	
Is the pit located in a Sensitive Ground Water Area? <input checked="" type="checkbox"/> Yes <input type="checkbox"/> No		Chloride concentration: _____ mg/l <small>(For Emergency Pits and Settling Pits only)</small>
Is the bottom below ground level? <input checked="" type="checkbox"/> Yes <input type="checkbox"/> No	Artificial Liner? <input type="checkbox"/> Yes <input checked="" type="checkbox"/> No	How is the pit lined if a plastic liner is not used?
Pit dimensions (all but working pits): <u>100</u> Length (feet) <u>100</u> Width (feet) _____ N/A: Steel Pits Depth from ground level to deepest point: <u>4</u> (feet)		
If the pit is lined give a brief description of the liner material, thickness and installation procedure.		Describe procedures for periodic maintenance and determining liner integrity, including any special monitoring.
Distance to nearest water well within one-mile of pit <u>1426</u> feet    Depth of water well <u>62</u> feet		Depth to shallowest fresh water <u>30</u> feet. Source of information: <u>LHK63</u> _____ measured _____ well owner _____ electric log <input checked="" type="checkbox"/> KDWR
<b>Emergency, Settling and Burn Pits ONLY:</b> Producing Formation: _____ Number of producing wells on lease: _____ Barrels of fluid produced daily: _____ Does the slope from the tank battery allow all spilled fluids to flow into the pit? <input type="checkbox"/> Yes <input type="checkbox"/> No		<b>Drilling, Workover and Haul-Off Pits ONLY:</b> Type of material utilized in drilling/workover: <u>Fresh</u> Number of working pits to be utilized: <u>3</u> Abandonment procedure: <u>evaporate then backfill</u> Drill pits must be closed within 365 days of spud date.
I hereby certify that the above statements are true and correct to the best of my knowledge and belief.		
July 18, 2006 Date		<u>Sally R. Byers</u> Signature of Applicant or Agent
<b>KCC OFFICE USE ONLY</b>		
Date Received: <u>7/18/06</u> Permit Number: _____ Permit Date: <u>7/18/06</u> Lease Inspection: <input checked="" type="checkbox"/> Yes <input type="checkbox"/> No		

15-009-24903-0000

# KANSAS

CORPORATION COMMISSION

KATHLEEN SEBELIUS, GOVERNOR

BRIAN J. MOLINE, CHAIR

ROBERT E. KREHBIEL, COMMISSIONER

MICHAEL C. MOFFET, COMMISSIONER

July 18, 2006

Mr. Cecil O'Brate  
American Warrior, Inc.  
PO Box 399  
Garden City, Ks 67846-0399

Re: Drilling Pit Application  
Rose Lease Well No. 1-18  
SE/4 Sec. 18-20S-12W  
Barton County, Kansas

Dear Mr. O'Brate:

District staff has inspected the above referenced location and has determined that the reserve pit shall be constructed **without slots**, the bottom shall be flat and reasonably level and the free fluids must be removed. The fluids are to be removed from the reserve pit as soon as the Hutchinson Salt section has been drilled through and displacement of the fluids into the reserve pit has occurred. The fluids should be removed again as soon as practical after drilling operations have ceased. **Please keep all pits away from any draws.**

**If production casing is set all completion fluids shall be removed from the working pits daily. NO completion fluids or non-exempt wastes shall be placed in the reserve pit.**

The fluids should be taken to an authorized disposal well. Please call the District Office at (785) 625-0550 when the fluids have been removed. Please file form CDP-5 (August 2004), Exploration and Production Waste Transfer, within 30 days of fluid removal. Conservation division forms are available through our office and on the KCC web site: [www.kcc.state.ks.us/conservation/forms](http://www.kcc.state.ks.us/conservation/forms).

**A copy of this letter should be posted in the doghouse along with the approved Intent to Drill.**

If you have any questions or concerns please feel free to contact the undersigned at the above address.

Sincerely,

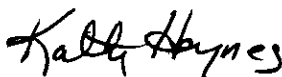

Kathy Haynes  
Department of Environmental Protection and Remediation

cc: File