

CORRECTED

AMENDED WELL NUMBER

For KCC Use: 7-2-06
Effective Date: 3
District # 3
SGA? Yes No

KANSAS CORPORATION COMMISSION
OIL & GAS CONSERVATION DIVISION
NOTICE OF INTENT TO DRILL

Must be approved by KCC five (5) days prior to commencing well

Form C-1
December 2002
Form must be Signed
All blanks must be Filled

Expected Spud Date June 26, 2006
month day year

OPERATOR: License# 33344
Name: Quest Cherokee, LLC
Address: 9520 N. May Ave, Suite 300
City/State/Zip: Oklahoma City, OK 73120
Contact Person: Richard Marlin
Phone: 405-488-1304

CONTRACTOR: License# Will be licensed by KCC
Name: Will Advise on ACO -1

Well Drilled For: Oil Gas OAWD Selamic; # of Holes Other
Well Class: Enh Rec Storage Disposal Other
Type Equipment: Infield Pool Ext. Wildcat Other
 Mud Rotary Air Rotary Cable

If OWWO: old well information as follows:
Operator: _____
Well Name: _____
Original Completion Date: _____ Original Total Depth: _____

Directional, Deviated or Horizontal wellbore? Yes No

If Yes, true vertical depth: _____
Bottom Hole Location: _____
KCC DKT #: _____

Was: Well # 3-1
Is Well # 3-2

RECEIVED
KANSAS CORPORATION COMMISSION

JUN 27 2006

CONSERVATION DIVISION
WICHITA, KS

AFFIDAVIT

The undersigned hereby affirms that the drilling, completion and eventual plugging of this well will comply with K.S.A. 55 et. seq.
It is agreed that the following minimum requirements will be met:

1. Notify the appropriate district office **prior** to spudding of well;
2. A copy of the approved notice of intent to drill **shall be posted** on each drilling rig;
3. The minimum amount of surface pipe as specified below **shall be set** by circulating cement to the top; in all cases surface pipe shall be set through all unconsolidated materials plus a minimum of 20 feet into the underlying formation.
4. If the well is dry hole, an agreement between the operator and the district office on plug length and placement is necessary **prior to plugging**;
5. The appropriate district office will be notified before well is either plugged or production casing is cemented in;
6. If an ALTERNATE II COMPLETION, production pipe shall be cemented from below any usable water to surface within **120 days** of spud date. Or pursuant to Appendix "B" - Eastern Kansas surface casing order #133,891-C, which applies to the KCC District 3 area, alternate II cementing must be completed within 30 days of the spud date or the well shall be plugged. **In all cases, NOTIFY district office** prior to any cementing.

I hereby certify that the statements made herein are true and to the best of my knowledge and belief.

Date: 6/26/06 Signature of Operator or Agent: Richard Marlin Title: Vice President

For KCC Use ONLY
API # 15 - 205-26805-0000
Conductor pipe required None feet
Minimum surface pipe required 20 feet per Alt. X2
Approved by: R/M 6-27-06 / P/M 7-24-06
This authorization expires: 12-27-06
(This authorization void if drilling not started within 6 months of effective date.)
Spud date: _____ Agent: _____

Spot East
NE NE Sec. 3 Twp. 28 S. R. 17 West
660 feet from N / S Line of Section
550 feet from E / W Line of Section
Is SECTION Regular Irregular?

(Note: Locate well on the Section Plat on reverse side)
County: Wilson
Lease Name: Brant, Jerry W Well #: 3-2
Field Name: Cherokee Basin CBM

Is this a Prorated / Spaced Field? Yes No
Target Information(s): Arbuckle Dolomite
Nearest Lease or unit boundary: 550

Ground Surface Elevation: 1010 feet MSL
Water well within one-quarter mile: Yes No
Public water supply well within one mile: Yes No

Depth to bottom of fresh water: 100
Depth to bottom of usable water: 200
Surface Pipe by Alternate: 1 2

Length of Surface Pipe Planned to be set: 25
Length of Conductor Pipe required: _____
Projected Total Depth: 1500

Formation at Total Depth: Arbuckle Dolomite
Water Source for Drilling Operations:
 Well Farm Pond Other Air

DWR Permit #: _____
(Note: Apply for Permit with DWR)

Will Cores be taken? Yes No
If Yes, proposed zone: _____

RECEIVED
KANSAS CORPORATION COMMISSION

JUL 24 2006

CONSERVATION DIVISION
WICHITA, KS

Remember to:

- File Drill Pit Application (form CDP-1) with Intent to Drill;
- File Completion Form ACO-1 within 120 days of spud date;
- File acreage attribution plat according to field prorations orders;
- Notify appropriate district office 48 hours prior to workover or re-entry;
- Submit plugging report (CP-4) after plugging is completed;
- Obtain written approval before disposing or injecting salt water.
- If this permit has expired (See: authorized expiration date) please check the box below and return to the address below.

Well Not Drilled - Permit Expired
Signature of Operator or Agent: _____
Date: _____

Mail to: KCC - Conservation Division, 130 S. Market - Room 2078, Wichita, Kansas 67202

3
28
17E

CORRECTED

IN ALL CASES PLOT THE INTENDED WELL ON THE PLAT BELOW

Plat of acreage attributable to a well in a prorated or spaced field

If the intended well is in a prorated or spaced field, please fully complete this side of the form. If the intended well is in a prorated or spaced field complete the plat below showing that the well will be properly located in relationship to other wells producing from the common source of supply. Please show all the wells and within 1 mile of the boundaries of the proposed acreage attribution unit for gas wells and within 1/2 mile of the boundaries of the proposed acreage attribution unit for oil wells.

API No. 15 - 205-26805-000
 Operator: Quest Cherokee, LLC
 Lease: Brant, Jerry W
 Well Number: X 3-2
 Field: Cherokee Basin CBM
 Number of Acres attributable to well: 120
 QTR / QTR / QTR of acreage: NE - NE

Location of Well: County: Wilson
660 feet from N / S Line of Section
550 feet from E / W Line of Section
 Sec. 3 Twp. 28 S. R. 17 East West
 Is Section: Regular or Irregular
 If Section is Irregular, locate well from nearest corner boundary.
 Section corner used: NE NW SE SW

PLAT

*(Show location of the well and shade attributable acreage for prorated or spaced wells.)
 (Show footage to the nearest lease or unit boundary line.)*

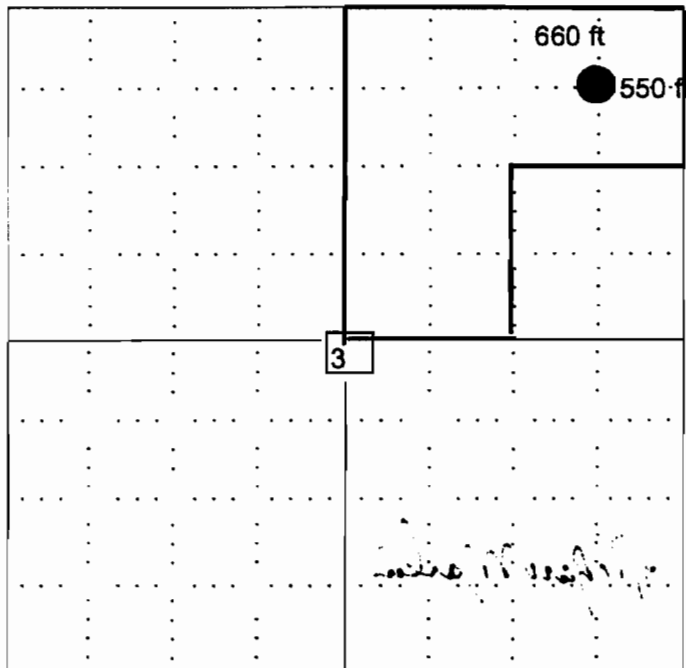

RECEIVED
 KANSAS CORPORATION COMMISSION
 JUL 24 2006
 CONSERVATION DIVISION
 WICHITA, KS

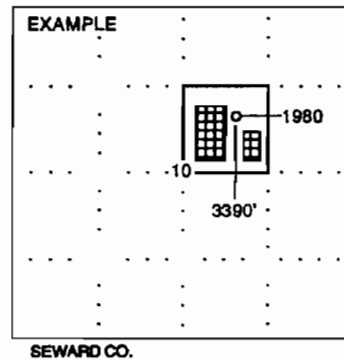

NOTE: In all cases locate the spot of the proposed drilling location.

In plotting the proposed location of the well, you must show:

1. The manner in which you are using the depicted plat by identifying section lines, i.e. 1 section, 1 section with 8 surrounding sections, 4 sections, etc.
2. The distance of the proposed drilling location from the section's south / north and east / west.
3. The distance to the nearest lease or unit boundary line.
4. If proposed location is located within a prorated or spaced field a certificate of acreage attribution plat must be attached: (CO-7 for oil wells; CG-8 for gas wells).

RECEIVED
KANSAS CORPORATION COMMISSION

JUN 27 2006

CONSERVATION DIVISION
WICHITA, KS

KANSAS CORPORATION COMMISSION
OIL & GAS CONSERVATION DIVISION

APPLICATION FOR SURFACE PIT

Submit in Duplicates

RECEIVED
KANSAS CORPORATION COMMISSION

JUL 24 2006

CONSERVATION DIVISION
WICHITA, KS

Form CDP-1
April 2004
Form must be typed

CORRECTED

Operator Name: Quest Cherokee, LLC		License Number: 33344
Operator Address: 9520 N. May Ave, Suite		
Contact Person: Richard Marlin		Phone Number: (405) 488 - 1304
Lease Name & Well No.: Brant, Jerry W 3-1 #3-2		Pit Location (QQQQ): _____ NE . NE
Type of Pit: <input type="checkbox"/> Emergency Pit <input type="checkbox"/> Burn Pit <input type="checkbox"/> Settling Pit <input checked="" type="checkbox"/> Drilling Pit <input type="checkbox"/> Workover Pit <input type="checkbox"/> Haul-Off Pit <i>(If WP Supply API No. or Year Drilled)</i>	Pit is: <input checked="" type="checkbox"/> Proposed <input type="checkbox"/> Existing If Existing, date constructed: _____ Pit capacity: 300 (bbls)	Sec. 3 Twp. 28 R. 17 <input checked="" type="checkbox"/> East <input type="checkbox"/> West 660 Feet from <input checked="" type="checkbox"/> North / <input type="checkbox"/> South Line of Section 550 Feet from <input checked="" type="checkbox"/> East / <input type="checkbox"/> West Line of Section Wilson County
Is the pit located in a Sensitive Ground Water Area? <input type="checkbox"/> Yes <input checked="" type="checkbox"/> No		Chloride concentration: _____ mg/l <i>(For Emergency Pits and Settling Pits only)</i>
Is the bottom below ground level? <input type="checkbox"/> Yes <input checked="" type="checkbox"/> No	Artificial Liner? <input type="checkbox"/> Yes <input checked="" type="checkbox"/> No	How is the pit lined if a plastic liner is not used?
Pit dimensions (all but working pits): 30 Length (feet) 10 Width (feet) _____ N/A: Steel Pits Depth from ground level to deepest point: 10 (feet)		
If the pit is lined give a brief description of the liner material, thickness and installation procedure.		Describe procedures for periodic maintenance and determining liner integrity, including any special monitoring. Air Drilling Operation lasting approx. 3 days
Distance to nearest water well within one-mile of pit N/A feet Depth of water well _____ feet		Depth to shallowest fresh water _____ feet. Source of information: _____ measured _____ well owner _____ electric log _____ KDWR
Emergency, Settling and Burn Pits ONLY: Producing Formation: _____ Number of producing wells on lease: _____ Barrels of fluid produced daily: _____ Does the slope from the tank battery allow all spilled fluids to flow into the pit? <input type="checkbox"/> Yes <input type="checkbox"/> No		Drilling, Workover and Haul-Off Pits ONLY: Type of material utilized in drilling/workover: Air Drilled Number of working pits to be utilized: One Abandonment procedure: Air dry, backfill and cover _____ Drill pits must be closed within 365 days of spud date.
I hereby certify that the above statements are true and correct to the best of my knowledge and belief.		
_____ Date: 6/26/06		Richard Marlin Signature of Applicant or Agent

15-205-26205-0002

KCC OFFICE USE ONLY

Date Received: 6/27/06 Permit Number: _____ Permit Date: 6/27/06 Lease Inspection: Yes No