

For KCC Use:
 Effective Date: 7-30-06
 District # 1
 SGA? Yes No

KANSAS CORPORATION COMMISSION
 OIL & GAS CONSERVATION DIVISION

Form C-1
 December 2002

Form must be Typed
 Form must be Signed
 All blanks must be Filled

NOTICE OF INTENT TO DRILL

Must be approved by KCC five (5) days prior to commencing well

Expected Spud Date July 31 2006
month day year

Spot 20' S ; 70' W OF
 E/2 - W/2 - NE Sec. 21 Twp. 30 S. R. 18
 East
 West
 3940 feet from N / S Line of Section
 1720 feet from E / W Line of Section

OPERATOR: License# 32781
 Name: Roberts Resources, Inc.
 Address: 520 S. Holland - Suite 207
 City/State/Zip: Wichita, KS 67209
 Contact Person: Kent Roberts
 Phone: 316-721-2817

Is SECTION Regular Irregular?

(Note: Locate well on the Section Plat on reverse side)

CONTRACTOR: License# 5929
 Name: Duke Drilling Co., Inc.

County: Kiowa
 Lease Name: Cobb Well #: 1-21
 Field Name: Alford

Is this a Prorated / Spaced Field? Yes No

Target Formation(s): Marmaton, Mississippi

Nearest Lease or unit boundary: 920'

Ground Surface Elevation: 2188 feet MSL

Water well within one-quarter mile: Yes No

Public water supply well within one mile: Yes No

Depth to bottom of fresh water: 200

Depth to bottom of usable water: 210

Surface Pipe by Alternate: 1 2

Length of Surface Pipe Planned to be set: 600

Length of Conductor Pipe required: None

Projected Total Depth: 5200

Formation at Total Depth: Mississippi

Water Source for Drilling Operations:

Well Farm Pond Other

DWR Permit #: pending

(Note: Apply for Permit with DWR)

Will Cores be taken? Yes No

If Yes, proposed zone:

Well Drilled For: Oil Gas OWWO Seismic; # of Holes Other
 Enh Rec Storage Disposal
 Well Class: Infield Pool Ext. Wildcat Other
 Type Equipment: Mud Rotary Air Rotary Cable

If OWWO: old well information as follows:
 Operator:
 Well Name:
 Original Completion Date: Original Total Depth:

Directional, Deviated or Horizontal wellbore? Yes No

If Yes, true vertical depth:

Bottom Hole Location:

KCC DKT #:

AFFIDAVIT

The undersigned hereby affirms that the drilling, completion and eventual plugging of this well will comply with K.S.A. 55 et. seq.

It is agreed that the following minimum requirements will be met:

1. Notify the appropriate district office **prior** to spudding of well;
2. A copy of the approved notice of intent to drill **shall be** posted on each drilling rig;
3. The minimum amount of surface pipe as specified below **shall be set** by circulating cement to the top; in all cases surface pipe **shall be set** through all unconsolidated materials plus a minimum of 20 feet into the underlying formation.
4. If the well is dry hole, an agreement between the operator and the district office on plug length and placement is necessary **prior to plugging**;
5. The appropriate district office will be notified before well is either plugged or production casing is cemented in;
6. If an ALTERNATE II COMPLETION, production pipe shall be cemented from below any usable water to surface within **120 days** of spud date. Or pursuant to Appendix "B" - Eastern Kansas surface casing order #133,891-C, which applies to the KCC District 3 area, alternate II cementing must be completed within 30 days of the spud date or the well shall be plugged. **In all cases, NOTIFY district office** prior to any cementing.

I hereby certify that the statements made herein are true and to the best of my knowledge and belief.

Date: 7/20/06 Signature of Operator or Agent: Kent Roberts Title: President **RECEIVED JUL 24 2006**

For KCC Use ONLY
 API # 15 - D97-21599-0000
 Conductor pipe required None feet
 Minimum surface pipe required 230 feet per Alt. 1
 Approved by: Per 7-25-06
 This authorization expires: 1-25-07
 (This authorization void if drilling not started within 6 months of approval date.)
 Spud date: Agent:

Remember to:

- File Drill Pit Application (form CDP-1) with Intent to Drill;
- File Completion Form ACO-1 within 120 days of spud date;
- File acreage attribution plat according to field proration orders;
- Notify appropriate district office 48 hours prior to workover or re-entry;
- Submit plugging report (CP-4) after plugging is completed;
- Obtain written approval before disposing or injecting salt water.

- If this permit has expired (See: authorized expiration date) please check the box below and return to the address below.

Well Not Drilled - Permit Expired

Signature of Operator or Agent:

Date:

Mail to: KCC - Conservation Division, 130 S. Market - Room 2078, Wichita, Kansas 67202

21 30 18W

IN ALL CASES PLOT THE INTENDED WELL ON THE PLAT BELOW

Plat of acreage attributable to a well in a prorated or spaced field

If the intended well is in a prorated or spaced field, please fully complete this side of the form. If the intended well is in a prorated or spaced field complete the plat below showing that the well will be properly located in relationship to other wells producing from the common source of supply. Please show all the wells and within 1 mile of the boundaries of the proposed acreage attribution unit for gas wells and within 1/2 mile of the boundaries of the proposed acreage attribution unit for oil wells.

API No. 15 - 097-21599-0000
 Operator: Roberts Resources, Inc.
 Lease: Cobb
 Well Number: 1-21
 Field: Alford
 Number of Acres attributable to well: _____
 QTR / QTR / QTR of acreage: E/2 - W/2 - NE

Location of Well: County: Kiowa
 _____ feet from N / S Line of Section
 _____ feet from E / W Line of Section
 Sec. 21 Twp. 30 S. R. 18 East West

Is Section: Regular or Irregular

If Section is Irregular, locate well from nearest corner boundary.

Section corner used: NE NW SE SW

PLAT

(Show location of the well and shade attributable acreage for prorated or spaced wells.)

(Show footage to the nearest lease or unit boundary line.)

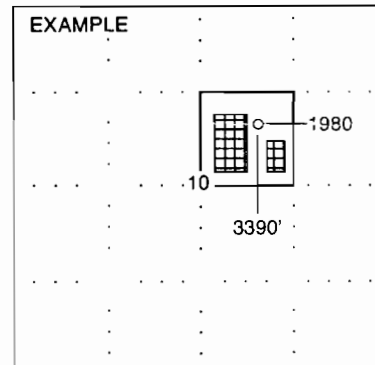
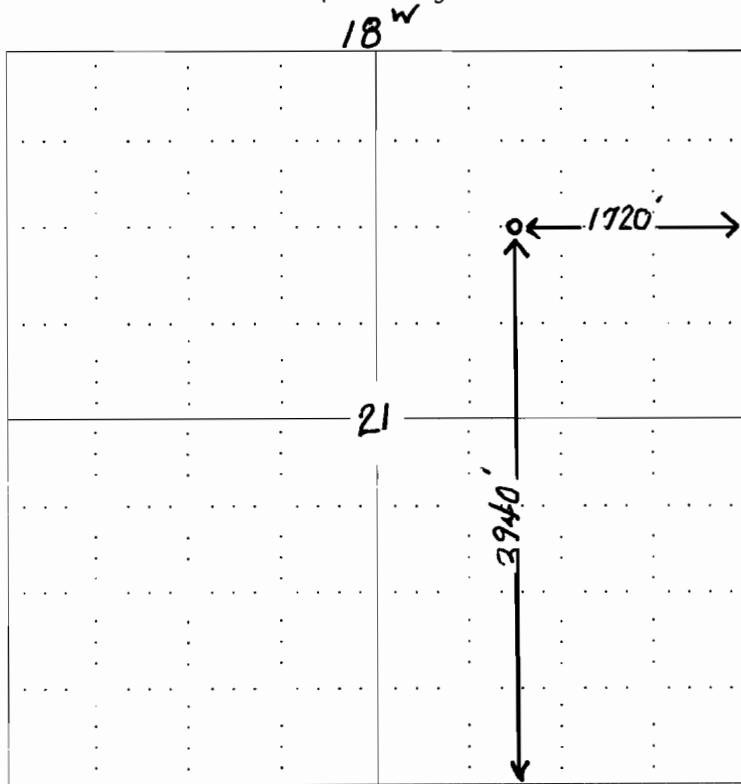

NOTE: In all cases locate the spot of the proposed drilling location.

In plotting the proposed location of the well, you must show:

1. The manner in which you are using the depicted plat by identifying section lines, i.e. 1 section, 1 section with 8 surrounding sections, 4 sections, etc.
2. The distance of the proposed drilling location from the section's south / north and east / west.
3. The distance to the nearest lease or unit boundary line.
4. If proposed location is located within a prorated or spaced field a certificate of acreage attribution plat must be attached: (CO-7 for oil wells; CG-8 for gas wells).

RECEIVED

JUL 24 2006

KCC WICHITA

**KANSAS CORPORATION COMMISSION
OIL & GAS CONSERVATION DIVISION
APPLICATION FOR SURFACE PIT**

Form GDP-1
April 2004
Form must be Typed

Submit in Duplicate

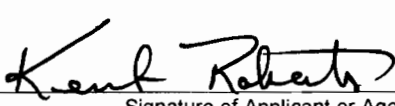
Operator Name: Roberts Resources, Inc.		License Number: 32781
Operator Address: 520 S. Holland, Suite 207 Wichita, KS 67209		
Contact Person: Kent Roberts		Phone Number: (316) 721 -2817
Lease Name & Well No.: Cobb 1-21		Pit Location (QQQQ): NW NE SW NE E/2 - W/2 - NE ✓
Type of Pit: <input type="checkbox"/> Emergency Pit <input type="checkbox"/> Burn Pit <input type="checkbox"/> Settling Pit <input checked="" type="checkbox"/> Drilling Pit <input type="checkbox"/> Workover Pit <input type="checkbox"/> Haul-Off Pit <small>(If WP Supply API No. or Year Drilled)</small>	Pit is: <input type="checkbox"/> Proposed <input type="checkbox"/> Existing If Existing, date constructed: _____ Pit capacity: _____ (bbls)	Sec. 21 Twp. 30 R. 18 <input type="checkbox"/> East <input checked="" type="checkbox"/> West _____ Feet from <input type="checkbox"/> North / <input checked="" type="checkbox"/> South Line of Section 1720 Feet from <input checked="" type="checkbox"/> East / <input type="checkbox"/> West Line of Section _____ County
Is the pit located in a Sensitive Ground Water Area? <input type="checkbox"/> Yes <input checked="" type="checkbox"/> No ✓		Chloride concentration: 15,000 mg/l <small>(For Emergency Pits and Settling Pits only)</small>
Is the bottom below ground level? <input checked="" type="checkbox"/> Yes <input type="checkbox"/> No	Artificial Liner? <input type="checkbox"/> Yes <input checked="" type="checkbox"/> No	How is the pit lined if a plastic liner is not used? Natural clay and rotary mud
Pit dimensions (all but working pits): 150 Length (feet) 150 Width (feet) N/A: Steel Pits Depth from ground level to deepest point: 3 (feet)		
If the pit is lined give a brief description of the liner material, thickness and installation procedure.		Describe procedures for periodic maintenance and determining liner integrity, including any special monitoring.
Distance to nearest water well within one-mile of pit 3204 feet Depth of water well 240 feet	Depth to shallowest fresh water 220 feet. Source of information: _____ measured _____ well owner _____ electric log _____ KDWR	
Emergency, Settling and Burn Pits ONLY: Producing Formation: _____ Number of producing wells on lease: _____ Barrels of fluid produced daily: _____ Does the slope from the tank battery allow all spilled fluids to flow into the pit? <input type="checkbox"/> Yes <input type="checkbox"/> No	Drilling, Workover and Haul-Off Pits ONLY: Type of material utilized in drilling/workover: Chemical Mud Number of working pits to be utilized: 1 Abandonment procedure: Let dry then backfill _____ Drill pits must be closed within 365 days of spud date.	
I hereby certify that the above statements are true and correct to the best of my knowledge and belief.		
7/20/06 Date	 Signature of Applicant or Agent	RECEIVED JUL 24 2006
KCC OFFICE USE ONLY		
Date Received: 7/24/06	Permit Number: _____	Permit Date: 7/24/06 Lease Inspection: <input type="checkbox"/> Yes <input checked="" type="checkbox"/> No

Mail to: KCC - Conservation Division, 130 S. Market - Room 2078, Wichita, Kansas 67202

15-097-21599-0000

Handwritten initials