

RECEIVED

APR 14 2006

KANSAS CORPORATION COMMISSION
OIL & GAS CONSERVATION DIVISION
WELL PLUGGING APPLICATION
Please TYPE Form and File ONE Copy

KCC WICHITA

Form CP-1
September 2003
This Form must be Typed
Form must be Signed
All blanks must be Filled

API # 15-145-20,524-00-00 (Identifier Number of this well). This must be listed for wells drilled since 1967; if no API # was issued,

indicate original spud or completion date 5/23/78

Well Operator: Fred J Nuss (Owner / Company Name) KCC License #: 31273 (Operator's)

Address: 158 East State Rd City: Hosington

State: Kansas Zip Code: 67544 Contact Phone: (620) 653 2594

Lease: Fox Well #: 1 NW 1/4 Sec. 21 Twp. 22 S. R. 15 East West

SE - NW - NW Spot Location / QQQQ County: Pawnee

990 Feet (in exact footage) From North / South (from nearest outside section corner) Line of Section (Not Lease Line)

990 Feet (in exact footage) From East / West (from nearest outside section corner) Line of Section (Not Lease Line)

Check One: Oil Well Gas Well D&A Cathodic Water Supply Well
 SWD Docket # _____ ENHR Docket # _____ Other: _____

Conductor Casing Size: _____ Set at: _____ Cemented with: _____ Sacks

Surface Casing Size: 8-5/8 Set at: 350 Cemented with: 300 Sacks

Production Casing Size: 4 1/2 Set at: 4045 Cemented with: unknown Sacks

List (ALL) Perforations and Bridgeplug Sets: 4004-7 2870-80 2315 plug

2036-2039 cement retainer 2026 1897-1900 1985-1994

Elevation: 2003 (G.L. / K.B.) T.D.: unknown PBTD: unknown Anhydrite Depth: 965
(Stone Corral Formation)

Condition of Well: Good Poor Casing Leak Junk in Hole

Proposed Method of Plugging (attach a separate page if additional space is needed): XXXXXXXXXXXXX
As per instructions and requirements of the K.C.C.

Is Well Log attached to this application as required? Yes No Is ACO-1 filed? Yes No

If not explain why? _____

Plugging of this Well will be done in accordance with K.S.A. 55-101 et. seq. and the Rules and Regulations of the State Corporation Commission.

List Name of Company Representative authorized to be in charge of plugging operations: Fred J Nuss

Phone: (620) 653 2594 82

Address: 158 East State Rd 4 City / State: Hosington Kansas

Plugging Contractor: Kelso Milkes Testing & Salvage, Inc KCC License #: 31529

Address: P.O. Box 467 Chase KS Phone: (620) 938 2943 (Contractor's)

Proposed Date and Hour of Plugging (if known?): as soon as they can get to it 60 days

Payment of the Plugging Fee (K.A.R. 82-3-118) will be guaranteed by Operator or Agent

Date: 4/10/2006 Authorized Operator / Agent: Fred J Nuss (Signature)

Mail to: KCC - Conservation Division, 130 S. Market - Room 2078, Wichita, Kansas 67202

WELL COMPLETION REPORT AND DRILLER'S LOG

State 21 T. 22 S. 15 W
 Loc. SE NW NW '011

API No. 15 — 145 — 20,524
 County Number

County Pawnee
 640 Acres

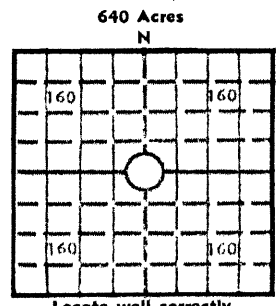

Elev.: Gr. _____
 DF _____ KB _____ 2003

Operator F & M OIL CO., INC.

Address 422 Union Center, Wichita, Kansas 67202

Well No. 1 Lease Name Fox

Footage Location 990 feet from (N) ~~XX~~ line 990 feet from ~~XX~~ (W) line

Principal Contractor Union Drilling Co., Inc. Geologist Glenn D. Tarcy

Spud Date 5-23-78 Date Completed 6-7-78 Total Depth 4047 P.B.T.D. _____

Directional Deviation _____ Oil and/or Gas Purchaser _____

CASING RECORD

Report of all strings set — surface, intermediate, production, etc.

Purpose of string	Size hole drilled	Size casing set (in O.D.)	Weight lbs./ft.	Setting depth	Type cement	Sacks	Type and percent additives
Surface	12 1/4"	8-5/8"		350'	common	300	2% gel, 3% cc
Production		4 1/2"		4045			

LINER RECORD

PERFORATION RECORD

Top, ft.	Bottom, ft.	Sacks cement	Shots per ft.	Size & type	Depth interval
					4004-4007

TUBING RECORD

Size	Setting depth	Packer set at

ACID, FRACTURE, SHOT, CEMENT SQUEEZE RECORD

Amount and kind of material used	Depth interval treated
500 gal. MCA	4004-4007

INITIAL PRODUCTION

Date of first production 7-8-78 Producing method (flowing, pumping, gas lift, etc.) Pumping

RATE OF PRODUCTION PER 24 HOURS	Oil <u>139</u> bbls.	Gas _____ MCF	Water <u>Tr.</u> bbls.	Gas-oil ratio _____ CFPB
---------------------------------	----------------------	---------------	------------------------	--------------------------

Disposition of gas (vented, used on lease or sold) _____ Producing interval (s) _____

INSTRUCTIONS: As provided in KCC Rule 82-2-125, within 90 days after completion of a well, one completed copy of this Drillers Log shall be transmitted to the State Geological Survey of Kansas, 4150 Monroe Street, Wichita, Kansas 67209. Copies of this form are available from the Conservation Division, State Corporation Commission, 245 No. Water, Wichita, Kansas 67202. Phone AC 316-522-2206. If confidential custody is desired, please note Rule 82-2-125. Drillers Logs will be on an open file in the Oil and Gas Division, State Geological Survey of Kansas, Lawrence, Kansas 66044.

Operator **F & M OIL CO., INC.** **RECEIVED** DESIGNATE TYPE OF COMP.: OIL, GAS, DRY HOLE, SWDW, ETC.:

Well No. **1** Lease Name **Fox** **APR 14 2006** **Oil**

S 21 T 22S R 15W E **KCC WICHITA**

WELL LOG

Show all important zones of porosity and contents thereof; cored intervals, and all drill-stem tests, including depth interval tested, cushion used, time tool open, flowing and shut-in pressures, and recoveries.

SHOW GEOLOGICAL MARKERS, LOGS RUN, OR OTHER DESCRIPTIVE INFORMATION.

FORMATION DESCRIPTION, CONTENTS, ETC.	TOP	BOTTOM	NAME	DEPTH
<p>DST#1 2854-2910, 30-45-60-45. Strong blow, recovered 600' gassy cut water. FP's 189-263, BHP's 1310-1174, 10 unit gas kick in Tarkio.</p> <p>DST#2 2950-3000, Miss run, too plugged, 17 unit gas kick in Howard.</p> <p>DST#3 2950-3030, 30-45-60-45. Strong blow - gas to surface in 5". First opening - Gauged: 10" 105,000 MCF 20" 120,000 MCF 30" 128,000 MCF Second Opening - gauged: 10" 138,000 MCF 20" 140,000 MCF 30" 141,500 MCF 40" 143,000 MCF - stabilized, recovered 250' gassy muddy water. FP's 88-162, BHP's 1100-1100#. Temp. 99°.</p> <p>DST#4 3636-65, 30-45-60-45. Weak to fair blow, recovered 330' SL.MW, FP's 66-162, BHP's 1172-1157.</p> <p>DST#5 3645-82, 30-45-60-45. Weak to fair blow, recovered 325' slight muddy water. FP's 44-199, BHP's 1172-1172.</p> <p>DST#6 3854-3909, 30-30-30-30. Strong blow, recovered 75' gassy mud. FP's 66-80#, IBHP's (failed) FBHP's 248#.</p> <p>DST#7 3854-3945, 30-30-30-30. Strong blow recovered 2800' GIP, 75' SL.G. CM. FP's 81-103, BHP's 140-125#.</p> <p>DST#8 3945-3985, 20-20-20-20. Weak 8" blow (flushed tool). recovered 125' mud. (S.O) FP's 96-118, BHP's 125-147#.</p>			<p>Sample Tops:</p> <p>Anhydrite 965 (+1038)</p> <p>B/Anhydrite 993 (+1010)</p> <p>Tarkio 2844 (- 841)</p> <p>Elmont 2905 (- 902)</p> <p>Howard 2981 (- 978)</p> <p>Topeka 3052 (-1049)</p> <p>Electric Log Tops:</p> <p>Tarkio 2846 (- 843)</p> <p>Elmont 2908 (- 905)</p> <p>Howard 2976 (-973)</p> <p>Topeka 3050 (-1047)</p> <p>Heebner 3426 (-1537)</p> <p>Br. Lime 3540 (-1537)</p> <p>Lansing 3548 (=1545)</p> <p>Viola 3884 (-1881)</p> <p>1st Simpson Sn. 3974 (=1971)</p> <p>2nd Simpson Sn. 3997 (-1994)</p> <p>Arbuckle 4033 (-2030)</p> <p>RTD 4047</p> <p>DST#9 3982-4001, 30-45-60-45. Weak blow, recovered 600' GIP 200' muddy oil. FP's 44-96, BHP's 1136-991#.</p>	
USE ADDITIONAL SHEETS, IF NECESSARY, TO COMPLETE WELL RECORD.				

Date Received	
	Signature
	President
	Title
	9-6-78
	Date

KANSAS

CORPORATION COMMISSION

Kathleen Sebelius, Governor Brian J. Moline, Chair Robert E. Krehbiel, Commissioner Michael C. Moffet, Commissioner

NOTICE OF RECEIPT OF WELL PLUGGING APPLICATION (CP-1)

June 21, 2006

Fred Nuss
158 East State Rd.
Hoisington, KS 67544

Re: FOX #1
API 15-145-20524-00-00
SENWNW 21-22S-15W, 990 FNL 990 FWL
PAWNEE COUNTY, KANSAS

Dear Operator:

This letter is to notify you that the Conservation Division is in receipt of your plugging proposal, form CP-1, for the above-captioned well.

Your CP-1 has been reviewed by the Conservation Division central office for completeness and to verify license numbers. The plugging proposal will now be forwarded to the district office listed below for review of your proposed method of plugging.

Please contact the district office for approval of your proposed plugging method at least five (5) days before plugging the well, pursuant to K.A.R. 82-3-113 (b). If a workover pit will be used during the plugging of the well it must be permitted. A CDP-1 form must be filed and approved prior to the use of the pit.

The Conservation Division's review of form CP-1, either in the central or district office, does not include an inquiry into well ownership or the filing operator's legal right to plug the well.

This notice in no way constitutes authorization to plug the above-captioned well by persons not having legal rights of ownership or interest in the well. This notice is void after ninety (90) days from the above date.

District: #1
210 E Frontview, Suite A
Dodge City, KS 67801
(620) 225-8888

Sincerely



David P. Williams
Production Supervisor