

For KCC Use:
Effective Date: 8-7-06
District #: 3
SGA? [X] Yes [] No

KANSAS CORPORATION COMMISSION
OIL & GAS CONSERVATION DIVISION

Form C-1
December 2002
Form must be Typed
Form must be Signed
All blanks must be Filled

NOTICE OF INTENT TO DRILL

Must be approved by KCC five (5) days prior to commencing well

Expected Spud Date August 8, 2006
month day year

Spot East
SW NW Sec. 10 Twp. 28S S. R. 18
1980 feet from N / S Line of Section
660 feet from E / W Line of Section

OPERATOR: License# 33344
Name: Quest Cherokee LLC
Address: 9520 North May Avenue, Suite 300
City/State/Zip: Oklahoma City, Oklahoma 73120
Contact Person: Richard Marlin
Phone: (405) 286-9316

Is SECTION [X] Regular [] Irregular?
(Note: Locate well on the Section Plat on reverse side)

CONTRACTOR: License# Will be licensed by the KCC
Name: Will advise on the ACO-1

County: Neosho
Lease Name: Roecker, Matt W. Well #: 10-1
Field Name: Cherokee Basin CBM

Well Drilled For: Oil [] Gas [X] OAWD [] Seismic [] Other [X]
Well Class: Enh Rec [] Storage [] Disposal [] Other []
Type Equipment: Infield [X] Pool Ext. [] Wildcat [] Other []
Mud Rotary [] Air Rotary [X] Cable []

Is this a Prorated / Spaced Field? [] Yes [X] No
Target Formation(s): Cherokee Coals
Nearest Lease or unit boundary: 660

If OWWO: old well information as follows:
Operator:
Well Name:
Original Completion Date: Original Total Depth:

Ground Surface Elevation: 970 feet MSL
Water well within one-quarter mile: [] Yes [X] No
Public water supply well within one mile: [] Yes [X] No

Directional, Deviated or Horizontal wellbore? [] Yes [X] No
If Yes, true vertical depth:
Bottom Hole Location:
KCC DKT #:

Depth to bottom of fresh water: 100
Depth to bottom of usable water: 200
Surface Pipe by Alternate: [] 1 [X] 2

Length of Surface Pipe Planned to be set: 25
Length of Conductor Pipe required:
Projected Total Depth: 1500

Formation at Total Depth: Cherokee Coals
Water Source for Drilling Operations: [] Well [] Farm Pond Other Air [X]

DWR Permit #:
(Note: Apply for Permit with DWR [])

Will Cores be taken? [] Yes [X] No
If Yes, proposed zone:

AFFIDAVIT

The undersigned hereby affirms that the drilling, completion and eventual plugging of this well will comply with K.S.A. 55 et. seq.
It is agreed that the following minimum requirements will be met:

- 1. Notify the appropriate district office prior to spudding of well;
2. A copy of the approved notice of intent to drill shall be posted on each drilling rig;
3. The minimum amount of surface pipe as specified below shall be set by circulating cement to the top;
4. If the well is dry hole, an agreement between the operator and the district office on plug length and placement is necessary prior to plugging;
5. The appropriate district office will be notified before well is either plugged or production casing is cemented in;
6. If an ALTERNATE II COMPLETION, production pipe shall be cemented from below any usable water to surface within 120 days of spud date.

I hereby certify that the statements made herein are true and to the best of my knowledge and belief.

Date: August 1, 2006 Signature of Operator or Agent: Title: VP

RECEIVED
KANSAS CORPORATION COMMISSION
AUG 02 2006
CONSERVATION DIVISION
WICHITA, KS

For KCC Use ONLY
API # 15 - 133-26679-0000
Conductor pipe required None feet
Minimum surface pipe required 20 feet per Alt.
Approved by: Pitt 8-2-06
This authorization expires: 2-2-07
Spud date: Agent:

Remember to:
- File Drill Pit Application (form CDP-1) with Intent to Drill;
- File Completion Form ACO-1 within 120 days of spud date;
- File acreage attribution plat according to field proration orders;
- Notify appropriate district office 48 hours prior to workover or re-entry;
- Submit plugging report (CP-4) after plugging is completed;
- Obtain written approval before disposing or injecting salt water.
- If this permit has expired (See: authorized expiration date) please check the box below and return to the address below.
[] Well Not Drilled - Permit Expired
Signature of Operator or Agent:
Date:

10
28
18E

IN ALL CASES PLOT THE INTENDED WELL ON THE PLAT BELOW

Plat of acreage attributable to a well in a prorated or spaced field

If the intended well is in a prorated or spaced field, please fully complete this side of the form. If the intended well is in a prorated or spaced field complete the plat below showing that the well will be properly located in relationship to other wells producing from the common source of supply. Please show all the wells and within 1 mile of the boundaries of the proposed acreage attribution unit for gas wells and within 1/2 mile of the boundaries of the proposed acreage attribution unit for oil wells.

API No. 15 - 133-26679-0000
 Operator: Quest Cherokee LLC
 Lease: Roecker, Matt W.
 Well Number: 10-1
 Field: Cherokee Basin CBM
 Number of Acres attributable to well: _____
 QTR / QTR / QTR of acreage: _____ - SW - NW

Location of Well: County: Neosho
 1980 _____ feet from N / S Line of Section
 660 _____ feet from E / W Line of Section
 Sec. 10 Twp. 28S S. R. 18 East West

Is Section: Regular or Irregular

If Section is Irregular, locate well from nearest corner boundary.

Section corner used: NE NW SE SW

PLAT

(Show location of the well and shade attributable acreage for prorated or spaced wells.)

(Show footage to the nearest lease or unit boundary line.)

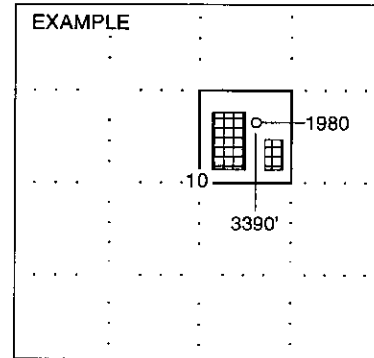
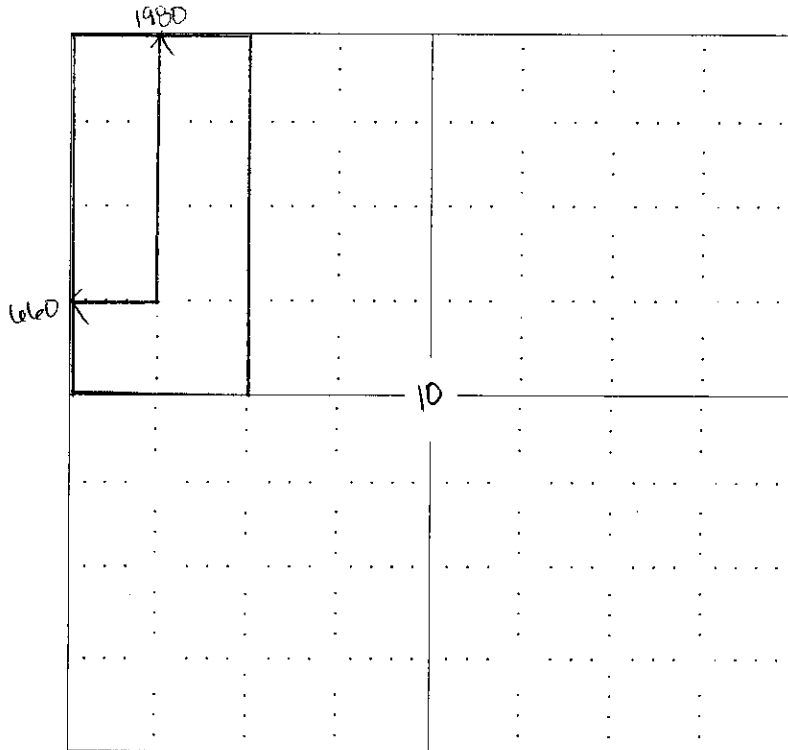

SEWARD CO.

NOTE: In all cases locate the spot of the proposed drilling locaton.

In plotting the proposed location of the well, you must show:

1. The manner in which you are using the depicted plat by identifying section lines, i.e. 1 section, 1 section with 8 surrounding sections, 4 sections, etc.
2. The distance of the proposed drilling location from the section's south / north and east / west.
3. The distance to the nearest lease or unit boundary line.
4. If proposed location is located within a prorated or spaced field a certificate of acreage attribution plat must be attached: (CO-7 for oil wells; CG-8 for gas wells).

**KANSAS CORPORATION COMMISSION
OIL & GAS CONSERVATION DIVISION
APPLICATION FOR SURFACE PIT**

Form CDP-1
April 2004
Form must be Typed

Submit in Duplicate

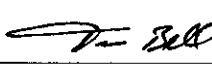
Operator Name: Quest Cherokee LLC		License Number: 33344
Operator Address: 9520 North May Avenue, Suite 300 Oklahoma City, Oklahoma 73120		
Contact Person: Richard Marlin		Phone Number: (405) 286 - 9316
Lease Name & Well No.: Roecker, Matt W. #10-1		Pit Location (QQQQ): _____ SW _____ NW
Type of Pit: <input type="checkbox"/> Emergency Pit <input type="checkbox"/> Burn Pit <input type="checkbox"/> Settling Pit <input checked="" type="checkbox"/> Drilling Pit <input type="checkbox"/> Workover Pit <input type="checkbox"/> Haul-Off Pit <small>(If WP Supply API No. or Year Drilled)</small>	Pit is: <input checked="" type="checkbox"/> Proposed <input type="checkbox"/> Existing If Existing, date constructed: _____ Pit capacity: _____ 300 _____ (bbls)	Sec. 10 Twp. 28 R. 18 <input checked="" type="checkbox"/> East <input type="checkbox"/> West _____ Feet from <input checked="" type="checkbox"/> North / <input type="checkbox"/> South Line of Section 660 _____ Feet from <input type="checkbox"/> East / <input checked="" type="checkbox"/> West Line of Section Neosho _____ County
Is the pit located in a Sensitive Ground Water Area? <input type="checkbox"/> Yes <input checked="" type="checkbox"/> No		Chloride concentration: _____ mg/l <small>(For Emergency Pits and Settling Pits only)</small>
Is the bottom below ground level? <input type="checkbox"/> Yes <input checked="" type="checkbox"/> No	Artificial Liner? <input type="checkbox"/> Yes <input checked="" type="checkbox"/> No	How is the pit lined if a plastic liner is not used?
Pit dimensions (all but working pits): _____ 30 _____ Length (feet) _____ 10 _____ Width (feet) _____ N/A: Steel Pits Depth from ground level to deepest point: _____ 10 _____ (feet)		
If the pit is lined give a brief description of the liner material, thickness and installation procedure.		Describe procedures for periodic maintenance and determining liner integrity, including any special monitoring. Air Drilling Operation lasting approx 3 days
Distance to nearest water well within one-mile of pit _____ 1400 _____ feet Depth of water well _____ 120 _____ feet		Depth to shallowest fresh water _____ 35 _____ feet. Source of information: _____ KHK65 _____ (1) _____ measured _____ well owner _____ electric log _____ KDWR
Emergency, Settling and Burn Pits ONLY: Producing Formation: _____ Number of producing wells on lease: _____ Barrels of fluid produced daily: _____ Does the slope from the tank battery allow all spilled fluids to flow into the pit? <input type="checkbox"/> Yes <input type="checkbox"/> No		Drilling, Workover and Haul-Off Pits ONLY: Type of material utilized in drilling/workover: Air Drilled Number of working pits to be utilized: One Abandonment procedure: Air Dry, Back Fill and Cover Drill pits must be closed within 365 days of spud date.
I hereby certify that the above statements are true and correct to the best of my knowledge and belief.		
August 1, 2006 Date		 Signature of Applicant or Agent

15-133-26679-0220

RECEIVED
KANSAS CORPORATION COMMISSION
AUG 02 2006
CONSERVATION DIVISION
WICHITA, KS

KCC OFFICE USE ONLY			
Date Received: 8/2/06	Permit Number: _____	Permit Date: 8/2/06	Lease Inspection: <input type="checkbox"/> Yes <input checked="" type="checkbox"/> No

Mail to: KCC - Conservation Division, 130 S. Market - Room 2078, Wichita, Kansas 67202