

For KCC Use: 8-12-07  
 Effective Date: 8-12-07  
 District # 1  
 SGA?  Yes  No

KANSAS CORPORATION COMMISSION  
 OIL & GAS CONSERVATION DIVISION

*OWWO*

Form C-1  
 December 2002  
 Form must be Typed  
 Form must be Signed  
 All blanks must be Filled

**NOTICE OF INTENT TO DRILL**

Must be approved by KCC five (5) days prior to commencing well

O.W.W.O. / Re-Entry  
 Expected Spud Date August 9th 2006  
 month day year

OPERATOR: License# 5614  
 Name: Wm. S. Hutchinson d/b/a Hutchinson Oil Co.  
 Address: P.O. Box 521  
 City/State/Zip: Derby, KS 67037-0521  
 Contact Person: Steve Hutchinson  
 Phone: a/c316-788-5440

CONTRACTOR: License# 33369  
 Name: EXTREME WELL SERVICE, INC.

5 1/2 inch production casing in hole  
 Well Drilled For: Well Class: Type Equipment:

- |  |                                   |   |   |
|--|-----------------------------------|---|---|
| <input checked="" type="checkbox"/> Oil      | <input type="checkbox"/> Enh Rec  | <input checked="" type="checkbox"/> Infield | <input type="checkbox"/> Mud Rotary       |
| <input checked="" type="checkbox"/> Gas      | <input type="checkbox"/> Storage  | <input type="checkbox"/> Pool Ext.          | <input type="checkbox"/> Air Rotary       |
| <input checked="" type="checkbox"/> OWWO     | <input type="checkbox"/> Disposal | <input type="checkbox"/> Wildcat            | <input checked="" type="checkbox"/> Cable |
| <input type="checkbox"/> Seismic; # of Holes | <input type="checkbox"/> Other    |   |   |
| <input type="checkbox"/> Other               |                                   |   |   |

If OWWO: old well information as follows:  
 Operator: Bergman Oil Company/Marshel O & G, Inc.  
 Well Name: SCHEIB #1  
 Original Completion Date: 4/15/76 Original Total Depth: 3685'

Directional, Deviated or Horizontal wellbore?  Yes  No  
 If Yes, true vertical depth: \_\_\_\_\_  
 Bottom Hole Location: RECEIVED  
KANSAS CORPORATION COMMISSION  
 KCC DKT #: \_\_\_\_\_

**AUG 03 2006**

Spot SW SE NW Sec. 27 Twp. 22 S. R. 12 East  West   
2310 feet from  N /  S Line of Section  
1650 feet from  E /  W Line of Section  
 Is SECTION  Regular  Irregular?

(Note: Locate well on the Section Plat on reverse side)

County: Stafford  
 Lease Name: Scheib OWWO Well #: 1  
 Field Name: Spangenberg South

Is this a Prorated / Spaced Field?  Yes  No  
 Target Information(s): Arbuckle & Lansing Zones

Nearest Lease or unit boundary: 330'  
 Ground Surface Elevation: 1855' feet MSL

Water well within one-quarter mile:  Yes  No  
 Public water supply well within one mile:  Yes  No

Depth to bottom of fresh water: 160'  
 Depth to bottom of usable water: 200' 180'

Surface Pipe by Alternate:  1  2  
 Length of Surface Pipe Planned to be set: 8 5/8ths already set @ 298'

Length of Conductor Pipe required: None  
 Projected Total Depth: 3685'

Formation at Total Depth: Arbuckle

Water Source for Drilling Operations:  
 Well  Farm Pond Other Water Haul

DWR Permit #: \_\_\_\_\_

(Note: Apply for Permit with DWR )

Will Cores be taken?  Yes  No

If Yes, proposed zone: \_\_\_\_\_

**CONSERVATION DIVISION AFFIDAVIT**

The undersigned hereby affirms that the drilling operation and eventual plugging of this well will comply with K.S.A. 55 et. seq.  
 It is agreed that the following minimum requirements will be met:

1. Notify the appropriate district office **prior** to spudding of well;
2. A copy of the approved notice of intent to drill **shall be** posted on each drilling rig;
3. The minimum amount of surface pipe as specified below **shall be set** by circulating cement to the top; in all cases surface pipe **shall be set** through all unconsolidated materials plus a minimum of 20 feet into the underlying formation.
4. If the well is dry hole, an agreement between the operator and the district office on plug length and placement is necessary **prior to plugging**;
5. The appropriate district office will be notified before well is either plugged or production casing is cemented in;
6. If an ALTERNATE II COMPLETION, production pipe shall be cemented from below any usable water to surface within **120 days** of spud date.  
 Or pursuant to Appendix "B" - Eastern Kansas surface casing order #133,891-C, which applies to the KCC District 3 area, alternate II cementing must be completed within 30 days of the spud date or the well shall be plugged. **In all cases, NOTIFY district office** prior to any cementing.

I hereby certify that the statements made herein are true and to the best of my knowledge and belief.

Date: 7/27/06 Signature of Operator or Agent: [Signature] Title: Owner/Operator

**Remember to:**

- File Drill Pit Application (form CDP-1) with Intent to Drill;
- File Completion Form ACO-1 within 120 days of spud date;
- File acreage attribution plat according to field proration orders;
- Notify appropriate district office 48 hours prior to workover or re-entry;
- Submit plugging report (CP-4) after plugging is completed;
- Obtain written approval before disposing or injecting salt water.
- If this permit has expired (See: authorized expiration date) please check the box below and return to the address below.

Well Not Drilled - Permit Expired

Signature of Operator or Agent: \_\_\_\_\_  
 Date: \_\_\_\_\_

27 22 12W

**For KCC Use ONLY**  
 API # 15 - 185-20634-00-01  
 Conductor pipe required None feet  
 Minimum surface pipe required 298 feet per Alt. 1  
 Approved by: RH 8-7-06  
 This authorization expires: 2-7-07  
 (This authorization void if drilling not started within 6 months of effective date.)  
 Spud date: \_\_\_\_\_ Agent: \_\_\_\_\_

**IN ALL CASES PLOT THE INTENDED WELL ON THE PLAT BELOW**

*Plat of acreage attributable to a well in a prorated or spaced field*

*If the intended well is in a prorated or spaced field, please fully complete this side of the form.* If the intended well is in a prorated or spaced field complete the plat below showing that the well will be properly located in relationship to other wells producing from the common source of supply. Please show all the wells and within 1 mile of the boundaries of the proposed acreage attribution unit for gas wells and within 1/2 mile of the boundaries of the proposed acreage attribution unit for oil wells.

API No. 15 - \_\_\_\_\_  
 Operator: \_\_\_\_\_  
 Lease: \_\_\_\_\_  
 Well Number: \_\_\_\_\_  
 Field: \_\_\_\_\_  
 Number of Acres attributable to well: \_\_\_\_\_  
 QTR / QTR / QTR of acreage: \_\_\_\_\_ - \_\_\_\_\_ - \_\_\_\_\_

Location of Well: County: \_\_\_\_\_  
 \_\_\_\_\_ feet from  N /  S Line of Section  
 \_\_\_\_\_ feet from  E /  W Line of Section  
 Sec. \_\_\_\_\_ Twp. \_\_\_\_\_ S. R. \_\_\_\_\_  East  West  
 Is Section:  Regular or  Irregular  
**If Section is Irregular, locate well from nearest corner boundary.**  
 Section corner used:  NE  NW  SE  SW

**PLAT**

*(Show location of the well and shade attributable acreage for prorated or spaced wells.)  
 (Show footage to the nearest lease or unit boundary line.)*

12 West

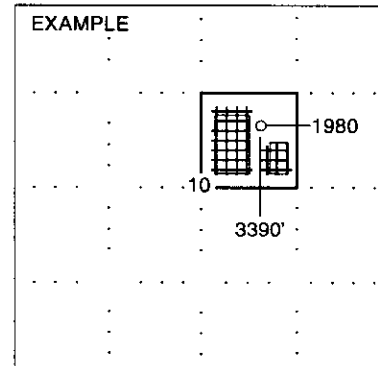
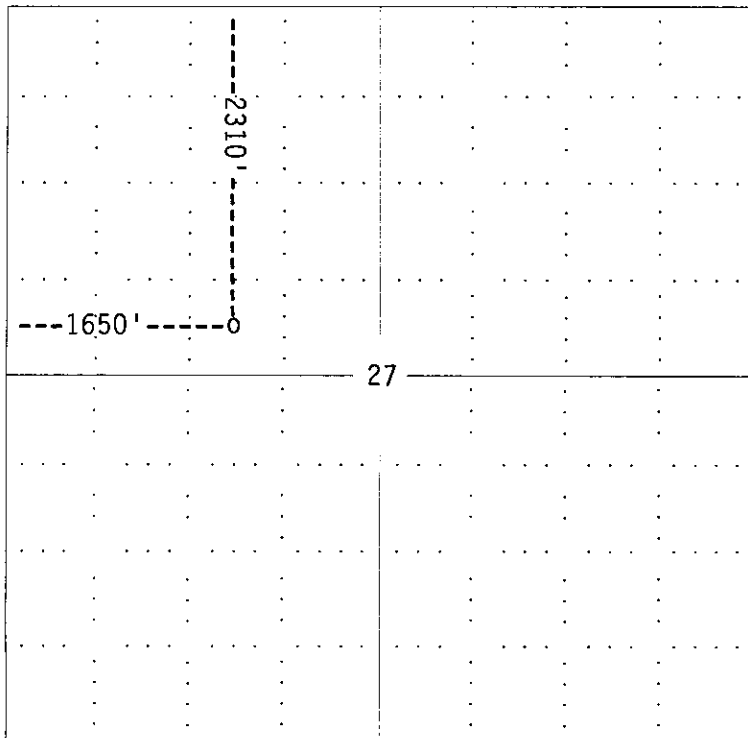

SEWARD CO.

**NOTE: In all cases locate the spot of the proposed drilling locaton.**  
 Stafford Co., KS

**In plotting the proposed location of the well, you must show:**

1. The manner in which you are using the depicted plat by identifying section lines, i.e. 1 section, 1 section with 8 surrounding sections, 4 sections, etc.
2. The distance of the proposed drilling location from the section's south / north and east / west.
3. The distance to the nearest lease or unit boundary line.
4. If proposed location is located within a prorated or spaced field a certificate of acreage attribution plat must be attached: (CO-7 for oil wells; CG-8 for gas wells).

KANSAS CORPORATION COMMISSION  
OIL & GAS CONSERVATION DIVISION  
APPLICATION FOR SURFACE PIT

AUG 03 2006

Form GDP-1  
April 2004

CONSERVATION DIVISION  
WICHITA, KS

Form must be Typed

Submit in Duplicate

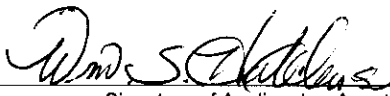
Operator Name: Wm. S. Hutchinson d/b/a Hutchinson Oil Co.		License Number: 5614
Operator Address: P.O. Box 521, Derby, KS 67037-0521		
Contact Person: Steve Hutchinson		Phone Number: ( 316 ) 788 - 5440
Lease Name & Well No.: Scheib #1		Pit Location (QQQQ): SW SE NW Sec. 27 Twp. 22S R. 12 <input type="checkbox"/> East <input checked="" type="checkbox"/> West 2310 Feet from <input checked="" type="checkbox"/> North / <input type="checkbox"/> South Line of Section 1650 Feet from <input type="checkbox"/> East / <input checked="" type="checkbox"/> West Line of Section Stafford County
Type of Pit: <input type="checkbox"/> Emergency Pit <input type="checkbox"/> Burn Pit <input type="checkbox"/> Settling Pit <input type="checkbox"/> Drilling Pit <input checked="" type="checkbox"/> Workover Pit <input type="checkbox"/> Haul-Off Pit <small>(If WP Supply API No. or Year Drilled)</small>	Pit is: <input checked="" type="checkbox"/> Proposed <input type="checkbox"/> Existing If Existing, date constructed: Pit capacity: 80 (bbls)	
Is the pit located in a Sensitive Ground Water Area? <input checked="" type="checkbox"/> Yes <input type="checkbox"/> No		Chloride concentration: 5,000 mg/l <small>(For Emergency Pits and Settling Pits only)</small>
Is the bottom below ground level? <input checked="" type="checkbox"/> Yes <input type="checkbox"/> No	Artificial Liner? <input checked="" type="checkbox"/> Yes <input type="checkbox"/> No	How is the pit lined if a plastic liner is not used?
Pit dimensions (all but working pits): 15 Length (feet) 10 Width (feet) N/A: Steel Pits Depth from ground level to deepest point: 3 feet (feet)		
If the pit is lined give a brief description of the liner material, thickness and installation procedure. A manufactured liner composed of a synthetic material approximately 8 ml in thickness will be doubled and over lapped on surface.		Describe procedures for periodic maintenance and determining liner integrity, including any special monitoring. Pit will be emptied at the end of completion
Distance to nearest water well within one-mile of pit 1320 feet Depth of water well 79 feet		Depth to shallowest fresh water 60 17 feet. ① Source of information: KHGS measured <input checked="" type="checkbox"/> well owner <input type="checkbox"/> electric log <input type="checkbox"/> KDWR
<b>Emergency, Settling and Burn Pits ONLY:</b> Producing Formation: Number of producing wells on lease: Barrels of fluid produced daily: Does the slope from the tank battery allow all spilled fluids to flow into the pit? <input type="checkbox"/> Yes <input type="checkbox"/> No		<b>Drilling, Workover and Haul-Off Pits ONLY:</b> Type of material utilized in drilling/workover: saltwater Number of working pits to be utilized: one (1) Abandonment procedure: pull all free fluids, haul to a licensed Saltwater Disposal & backfill pit. Drill pits must be closed within 365 days of spud date.
I hereby certify that the above statements are true and correct to the best of my knowledge and belief.		
7/27/06 Date		 Signature of Applicant or Agent

<b>KCC OFFICE USE ONLY</b>		RFAC
Date Received: 8/3/06	Permit Number:	Permit Date: 8/7/06
		Lease Inspection: <input checked="" type="checkbox"/> Yes <input type="checkbox"/> No

15-185-20634-00-00

TYPE

# NOTICE OF INTENTION TO DRILL

C-1

TO BE FILED WITH THE STATE CORPORATION COMMISSION  
PRIOR TO COMMENCEMENT OF WELL

API Number 15-185-20634  
(For office use only)

1. Operator Bergman Oil Etal

Starting Date December 31, 1975

Address 520 Union Center, Wichita, Kansas 67202

County Stafford

2. Contractor Bergman Drilling, Inc.

Sec 27 Twp 22 S Rge 12 <sup>E</sup>W

Address 520 Union Center, Wichita, Kansas 67202

Spot Location Aprox. SW SE NW

3. Type of Equipment: Rotary  Cable Tool \_\_\_\_\_

Nearest Lease Line 330' ft.

4. Well to be Drilled for: Oil  Gas \_\_\_\_\_

Lease Name Scheib

Disposal \_\_\_\_\_ Input \_\_\_\_\_ Other \_\_\_\_\_

5. Depth of Deepest Fresh Water within 1 mile 25 ft.

Well No. # 1

6. Depth of Municipal Water Well within 3 miles NONE ft.

7. Depth to Protect all Fresh Water 200 ft.

Est. Total Depth 3700 ft.

8. Amount of Surface Casing to be set 300 ft.

9. Alternate No. 1 \_\_\_\_\_ No. 2

REMARKS:

OPERATOR STATES THAT HE WILL COMPLY WITH K. S. A. 55-128

Signature of Operator

Harold I. Bergman



# KANSAS

CORPORATION COMMISSION

KATHLEEN SEBELIUS, GOVERNOR  
BRIAN J. MOLINE, CHAIR  
ROBERT E. KREHBIEL, COMMISSIONER  
MICHAEL C. MOFFET, COMMISSIONER

August 7, 2006

Mr. Steve Hutchinson  
Hutchinson Oil Co.  
PO Box 521  
Derby, KS 67037-0521

RE: Drilling Pit Application  
Scheib OWWO Lease Well No. 1  
NW/4 Sec. 27-22S-12W  
Stafford County, Kansas

Dear Mr. Hutchinson:

District staff has inspected the above referenced location and has determined that the reserve pit shall be constructed **without slots**, the bottom shall be flat and reasonably level, and the free fluids must be removed. The fluids are to be removed from the reserve pit as soon as practical after drilling operations have ceased.

**If production casing is set all completion fluids shall be removed from the working pits daily. NO completion fluids or non-exempt wastes shall be placed in the reserve pit.**

The fluids should be taken to an authorized disposal well. Please call the District Office at (620) 225-8888 when the fluids have been removed. Please file form CDP-5 (August 2004), Exploration and Production Waste Transfer, within 30 days of fluid removal. Conservation division forms are available through our office and on the KCC web site:  
[www.kcc.state.ks.us/conservation/forms](http://www.kcc.state.ks.us/conservation/forms).

**A copy of this letter should be posted in the doghouse along with the approved Intent to Drill.** If you have any questions or concerns please feel free to contact the undersigned at the above address.

Sincerely,

  
Kathy Haynes

Environmental Protection and Remediation Department

cc: File