

O W W O

For KCC Use: 8-14-06  
Effective Date: 4  
District # 4  
SGA?  Yes  No

KANSAS CORPORATION COMMISSION  
OIL & GAS CONSERVATION DIVISION

Form C-1  
December 2002

Form must be Typed  
Form must be Signed  
All blanks must be Filled

NOTICE OF INTENT TO DRILL

Must be approved by KCC five (5) days prior to commencing well

Expected Spud Date 08 07 06  
month day year

Spot NE - NW - NW Sec. 7 Twp. 10 S. R. 19  East  West  
330 feet from  N /  S Line of Section  
990 feet from  E /  W Line of Section  
Is SECTION  Regular  Irregular?

OPERATOR: License# 32158  
Name: H & B Petroleum Corporation  
Address: P O Box 277  
City/State/Zip: Ellinwood, Kansas 67526  
Contact Person: Al Hammersmith  
Phone: 620-564-3002

(Note: Locate well on the Section Plat on reverse side)  
County: Rooks  
Lease Name: Ouderkirk Well #: 9  
Field Name: Marcotte

CONTRACTOR: License# 33369  
Name: Xtreme Well Service, Inc

Is this a Prorated / Spaced Field?  Yes  No  
Target Formation(s): Arbuckle  
Nearest Lease or unit boundary: 330

Well Drilled For:  Oil  Enh Rec  Gas  Storage  O W O  Disposal  Seismic; # of Holes  Other Steel Pit  
Well Class:  Infield  Pool Ext.  Wildcat  Other  
Type Equipment:  Mud Rotary  Air Rotary  Cable

Ground Surface Elevation: 2227? feet MSL  
Water well within one-quarter mile:  Yes  No  
Public water supply well within one mile:  Yes  No

If O W W O: old well information as follows:  
Operator: Nadel & Gussman, Inc  
Well Name: Ouderkirk #9  
Original Completion Date: 03-02-1951 Original Total Depth: 3773

Depth to bottom of fresh water: 140  
Depth to bottom of usable water: 950  
Surface Pipe by Alternate:  1  2  
Length of Surface Pipe Planned to be set: 8 5/8 @ 164

Directional, Deviated or Horizontal wellbore?  Yes  No

If Yes, true vertical depth: \_\_\_\_\_

Bottom Hole Location: \_\_\_\_\_

KCC DKT #: \_\_\_\_\_

Length of Conductor Pipe required: None  
Projected Total Depth: 3773

Formation at Total Depth: \_\_\_\_\_

Water Source for Drilling Operations:  Well  Farm Pond Other \_\_\_\_\_  
DWR Permit #: \_\_\_\_\_

(Note: Apply for Permit with DWR )

Will Cores be taken?  Yes  No

If Yes, proposed zone: \_\_\_\_\_

AFFIDAVIT

The undersigned hereby affirms that the drilling, completion and eventual plugging of this well will comply with K.S.A. 55 et. seq.

It is agreed that the following minimum requirements will be met:

1. Notify the appropriate district office **prior** to spudding of well;
2. A copy of the approved notice of intent to drill **shall be** posted on each drilling rig;
3. The minimum amount of surface pipe as specified below **shall be set** by circulating cement to the top; in all cases surface pipe **shall be set** through all unconsolidated materials plus a minimum of 20 feet into the underlying formation.
4. If the well is dry hole, an agreement between the operator and the district office on plug length and placement is necessary **prior to plugging**;
5. The appropriate district office will be notified before well is either plugged or production casing is cemented in;
6. If an ALTERNATE II COMPLETION, production pipe shall be cemented from below any usable water to surface within **120 days** of spud date.  
Or pursuant to Appendix "B" - Eastern Kansas surface casing order #133,891-C, which applies to the KCC District 3 area, alternate II cementing must be completed within 30 days of the spud date or the well shall be plugged. **In all cases, NOTIFY district office** prior to any cementing.

I hereby certify that the statements made herein are true and to the best of my knowledge and belief.

Date: 08-08-06 Signature of Operator or Agent: [Signature] Title: Vice-President

For KCC Use ONLY  
API # 15 - 163-01912-00-01  
Conductor pipe required None feet  
Minimum surface pipe required 164 feet per Alt. X 2  
Approved by: [Signature] 8-8-06  
This authorization expires: 2-9-07  
(This authorization void if drilling not started within 6 months of approval date.)  
Spud date: \_\_\_\_\_ Agent: \_\_\_\_\_

Remember to:  
- File Drill Pit Application (form CDP-1) with Intent to Drill;  
- File Completion Form ACO-1 within 120 days of spud date;  
- File acreage attribution plat according to field proration orders;  
- Notify appropriate district office 48 hours prior to workover or re-entry;  
- Submit plugging report (CP-4) after plugging is completed;  
- Obtain written approval before disposing or injecting salt water.  
- If this permit has expired (See: authorized expiration date) please check the box below and return to the address below.  
 Well Not Drilled - Permit Expired  
Signature of Operator or Agent: \_\_\_\_\_  
Date: \_\_\_\_\_

Mail to: KCC - Conservation Division, 130 S. Market - Room 2078, Wichita, Kansas 67202

RECEIVED  
AUG 08 2006  
KCC WICHITA

7  
10  
1961

**IN ALL CASES PLOT THE INTENDED WELL ON THE PLAT BELOW**

*Plat of acreage attributable to a well in a prorated or spaced field*

**If the intended well is in a prorated or spaced field, please fully complete this side of the form.** If the intended well is in a prorated or spaced field complete the plat below showing that the well will be properly located in relationship to other wells producing from the common source of supply. Please show all the wells and within 1 mile of the boundaries of the proposed acreage attribution unit for gas wells and within 1/2 mile of the boundaries of the proposed acreage attribution unit for oil wells.

API No. 15 - 163-01912-00-01  
 Operator: H & B Petroleum Corporation  
 Lease: Ouderkirk  
 Well Number: 9  
 Field: Marcotte

Number of Acres attributable to well: \_\_\_\_\_  
 QTR / QTR / QTR of acreage: NE - NW - NW

Location of Well: County: Rooks  
330 feet from  N /  S Line of Section  
990 feet from  E /  W Line of Section  
 Sec. 7 Twp. 10 S. R. 19  East  West

Is Section:  Regular or  Irregular

**If Section is Irregular, locate well from nearest corner boundary.**

Section corner used:  NE  NW  SE  SW

**PLAT**

*(Show location of the well and shade attributable acreage for prorated or spaced wells.)  
 (Show footage to the nearest lease or unit boundary line.)*

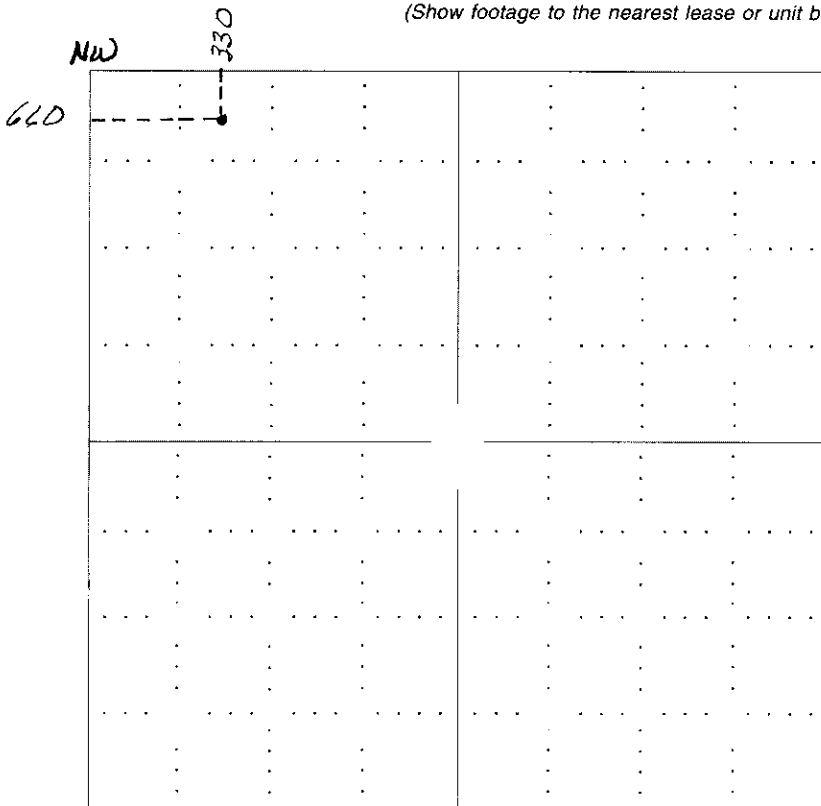

RECEIVED  
 AUG 08  
 KCC WICHITA

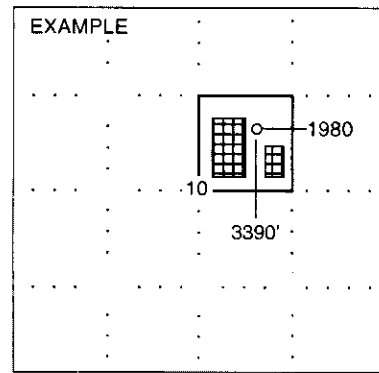

SEWARD CO.

**NOTE: In all cases locate the spot of the proposed drilling location.**

**In plotting the proposed location of the well, you must show:**

1. The manner in which you are using the depicted plat by identifying section lines, i.e. 1 section, 1 section with 8 surrounding sections, 4 sections, etc.
2. The distance of the proposed drilling location from the section's south / north and east / west.
3. The distance to the nearest lease or unit boundary line.
4. If proposed location is located within a prorated or spaced field a certificate of acreage attribution plat must be attached: (CO-7 for oil wells; CG-8 for gas wells).

RECEIVED

AUG 08 2006

KCC WICHITA

KANSAS CORPORATION COMMISSION  
OIL & GAS CONSERVATION DIVISION  
APPLICATION FOR SURFACE PIT

Form CDP-1  
April 2004  
Form must be Typed

Submit in Duplicate

Operator Name: <b>H &amp; B Petroleum Corporation</b>		License Number: <b>32158</b>
Operator Address: <b>PO Box 277, Ellinwood, Kansas 67526-0277</b>		
Contact Person: <b>Al Hammersmith</b>		Phone Number: ( <b>620</b> ) <b>564 - 3002</b>
Lease Name & Well No.: <b>Ouder Kirk # 9</b>		Pit Location (QQQQ): <b>NE - NW - NW - <del>NW</del></b>
Type of Pit: <input type="checkbox"/> Emergency Pit <input type="checkbox"/> Burn Pit <input type="checkbox"/> Settling Pit <input type="checkbox"/> Drilling Pit <input checked="" type="checkbox"/> Workover Pit <input type="checkbox"/> Haul-Off Pit <small>(If WP Supply API No. or Year Drilled)</small>	Pit is: <input type="checkbox"/> Proposed <input type="checkbox"/> Existing If Existing, date constructed: _____ Pit capacity: _____ (bbls)	Sec. <b>7</b> Twp. <b>10</b> R. <b>19</b> <input type="checkbox"/> East <input checked="" type="checkbox"/> West <b>330</b> Feet from <input checked="" type="checkbox"/> North / <input type="checkbox"/> South Line of Section <b>990</b> Feet from <input type="checkbox"/> East / <input checked="" type="checkbox"/> West Line of Section <b>Rooks</b> County
Is the pit located in a Sensitive Ground Water Area? <input type="checkbox"/> Yes <input checked="" type="checkbox"/> No		Chloride concentration: <b>20,000</b> mg/l <small>(For Emergency Pits and Settling Pits only)</small>
Is the bottom below ground level? <input checked="" type="checkbox"/> Yes <input type="checkbox"/> No	Artificial Liner? <input checked="" type="checkbox"/> Yes <input type="checkbox"/> No	How is the pit lined if a plastic liner is not used? <b>To be lined</b>
Pit dimensions (all but working pits): <b>30</b> Length (feet) <b>8</b> Width (feet) <b>N/A: Steel Pits</b> Depth from ground level to deepest point: <b>5</b> (feet)		
If the pit is lined give a brief description of the liner material, thickness and installation procedure. <b>10 mil-laid in and cover edges</b>		Describe procedures for periodic maintenance and determining liner integrity, including any special monitoring. <b>Pit to be used for cuttings only after the water is pulled from the 220 bl steel pit.</b>
Distance to nearest water well within one-mile of pit <b>N/A</b> <b>4290</b> feet    Depth of water well <b>65</b> feet		Depth to shallowest fresh water _____ feet. Source of information: _____ measured _____ well owner _____ electric log _____ KDWR
<b>Emergency, Settling and Burn Pits ONLY:</b> Producing Formation: _____ Number of producing wells on lease: _____ Barrels of fluid produced daily: _____ Does the slope from the tank battery allow all spilled fluids to flow into the pit? <input type="checkbox"/> Yes <input type="checkbox"/> No		<b>Drilling, Workover and Haul-Off Pits ONLY:</b> Type of material utilized in drilling/workover: <b>drilling cmt w/fresh water</b> Number of working pits to be utilized: <b>1-underground/1 steel pit</b> Abandonment procedure: <b>Pull off fluid from steel and put the cutting in the ground pit to dry.</b> Drill pits must be closed within 365 days of spud date.
I hereby certify that the above statements are true and correct to the best of my knowledge and belief.		
<b>08-07-06</b> Date		 Signature of Applicant or Agent
<b>KCC OFFICE USE ONLY</b>		
Date Received: <b>8/8/06</b> Permit Number: _____ Permit Date: <b>8/8/06</b> Lease Inspection: <input type="checkbox"/> Yes <input checked="" type="checkbox"/> No		

15-163-01912-00-01

API NUMBER 15-163-01912-00-00

LEASE NAME Ouderkirk

WELL NUMBER 9

330 Ft. from N Section Line

990 Ft. from W Section Line

SEC. 7 TWP. 10S RGE. 19 (X) or (W)

COUNTY Rooks

Date Well Completed 3-2-51

Plugging Commenced 10-2-91

Plugging Completed 10-2-91

TYPE OR PRINT  
 NOTICE: Fill out completely  
 and return to Cons. Div.  
 office within 30 days.

LEASE OPERATOR Nadel and Gussman

ADDRESS 3200 First National Tower, Tulsa, OK 74103

PHONE# (918) 583-3333 OPERATORS LICENSE NO. 5337

Character of Well Oil

(Oil, Gas, D&A, SWD, Input, Water Supply Well)

The plugging proposal was approved on July 30, 1991 (date)

by David P. Williams (KCC District Agent's Name).

Is ACO-1 filed? n/a If not, is well log attached? Yes

Producing Formation Arbuckle (Openhole) Depth to Top 3762 Bottom 3773 T.D. 3773

Show depth and thickness of all water, oil and gas formations.

OIL, GAS OR WATER RECORDS

CASING RECORD

Formation	Content	From	To	Size	Put In	Pulled out
Arbuckle	Oil & water	0	164	8-5/8	164	0
		0	3762	5-1/2	3762	0

RECEIVED  
 STATE CORPORATION COMMISSION  
 OCT 09 1991

Describe in detail the manner in which the well was plugged, indicating where the mud fluid was placed and the method or methods used in introducing it into the hole. If cement or other plugs were used, state the character of same and depth placed, from feet to feet each set.  
CIBP set @ 3500. Spotted 150 sks cement from 3490 back to 1500 ft. via tubing. Spotted 100 sks from 1500 ft. back to surface via tubing. Hooked on to 5-1/2 casing & squeezed in 40 sks @ 400 psi. Shut-in @ 200 psi. Hooked on to 8-5/8 and pumped 2 sks of hulls and 75 sks cement down annulus. SIP 200 psi.

(If additional description is necessary, use BACK of this form.)

Name of Plugging Contractor C & L Well Service License No. 08052

Address Box 162, Plainville, KS 67663

NAME OF PARTY RESPONSIBLE FOR PLUGGING FEES: Nadel and Gussman

STATE OF Oklahoma COUNTY OF Tulsa, ss.

Joe G. Anderson (Employee of Operator) or (Operator) of above-described well, being first duly sworn on oath, says: That I have knowledge of the facts, statements, and matters herein contained and the log of the above-described well as filed that the same are true and correct, so help me God.

(Signature) Joe Anderson

(Address) 3200 First National Tower  
 Tulsa, OK 74103

SUBSCRIBED AND SWORN TO before me this 7th day of October, 19 91

Kathy Garrow Kathy Garrow  
 Notary Public

My Commission Expires: 8-1-95