

For KCC Use:
 Effective Date: 9-4-06
 District # _____
 SGA? Yes No

**KANSAS CORPORATION COMMISSION
 OIL & GAS CONSERVATION DIVISION**

Skid Rig

Form C-1
 December 2002

Form must be Typed
 Form must be Signed
 All blanks must be Filled

NOTICE OF INTENT TO DRILL

Must be approved by KCC five (5) days prior to commencing well

Expected Spud Date September 1, 2006
 month day year

Spot 120'S & ^{95'} ~~125'~~ E of _____ East
 C - SE Sec. 32 Twp. 33 S. R. 32 East
 1200 feet from N / S Line of Section
 1225 feet from E / W Line of Section
 Is SECTION Regular Irregular?

OPERATOR: License# 4058 ✓
 Name: AMERICAN WARRIOR, INC.
 Address: P. O. Box 399
 City/State/Zip: Garden City, Kansas 67846-0399
 Contact Person: Cecil O'Brate
 Phone: 620/275-9231

(Note: Locate well on the Section Plat on reverse side)

County: Seward
 Lease Name: LIGHT Well #: 2-32A

CONTRACTOR: License# 5929 ✓
 Name: DUKE DRILLING CO., INC.

Field Name: Arkalan
 Is this a Prorated / Spaced Field? Yes No

Tarrest Information(s): Morrow, ST. Louis
 Nearest Lease or unit boundary: 1200

Well Drilled For: Oil Enh Rec Gas Storage OWWO Disposal Seismic; # of Holes Other

Well Class: Infield Pool Ext. Wildcat Other

Type Equipment: Mud Rotary Air Rotary Cable

Ground Surface Elevation: 2744 feet MSL
 Water well within one-quarter mile: Yes No

Public water supply well within one mile: Yes No
 Depth to bottom of fresh water: 380' ~~120'~~

Depth to bottom of usable water: 520' ~~180'~~
 Surface Pipe by Alternate: 1 2

Length of Surface Pipe Planned to be set: 1500
 Length of Conductor Pipe required: N/A

Projected Total Depth: 6150'
 Formation at Total Depth: St Louis

Water Source for Drilling Operations:
 Well Farm Pond Other _____

DWR Permit #: _____
 (Note: Apply for Permit with DWR)

Will Cores be taken? Yes No
 If Yes, proposed zone: _____

If OWWO: old well information as follows:
 Operator: _____
 Well Name: _____
 Original Completion Date: _____ Original Total Depth: _____

Directional, Deviated or Horizontal wellbore? Yes No

If Yes, true vertical depth: _____

Bottom Hole Location: _____

KCC DKT #: _____

PRORATED & SPACED HUBBARD
* Skid Rig from 15-175-22061-0000

AFFIDAVIT

RECEIVED
 KANSAS CORPORATION COMMISSION

AUG 30 2006

CONSERVATION DIVISION
 WICHITA, KS

The undersigned hereby affirms that the drilling, completion and eventual plugging of this well will comply with K.S.A. 55 et. seq.

It is agreed that the following minimum requirements will be met:

1. Notify the appropriate district office prior to spudding of well;
2. A copy of the approved notice of intent to drill shall be posted on each drilling rig;
3. The minimum amount of surface pipe as specified below shall be set by circulating cement to the top; in all cases surface pipe shall be set through all unconsolidated materials plus a minimum of 20 feet into the underlying formation.
4. If the well is dry hole, an agreement between the operator and the district office on plug length and placement is necessary prior to plugging;
5. The appropriate district office will be notified before well is either plugged or production casing is cemented in;
6. If an ALTERNATE II COMPLETION, production pipe shall be cemented from below any usable water to surface within 120 days of spud date. Or pursuant to Appendix "B" - Eastern Kansas surface casing order #133,891-C, which applies to the KCC District 3 area, alternate II cementing must be completed within 30 days of the spud date or the well shall be plugged. In all cases, NOTIFY district office prior to any cementing.

I hereby certify that the statements made herein are true and to the best of my knowledge and belief.

Date: 8/30/06 Signature of Operator or Agent: Sally R. Byers Title: Agent

For KCC Use ONLY
 API # 15 - 175-22062-0000
 Conductor pipe required None feet
 Minimum surface pipe required 540 feet per Alt.
 Approved by: Kurt 8-30-06
 This authorization expires: 2-28-07
 (This authorization void if drilling not started within 6 months of effective date.)
 Spud date: _____ Agent: _____

Remember to:

- File Drill Pit Application (form GDP-1) with Intent to Drill;
- File Completion-Form ACO-1 within 120 days of spud date;
- File acreage attribution plat according to field proration orders;
- Notify appropriate district office 48 hours prior to workover or re-entry;
- Submit plugging report (CP-4) after plugging is completed;
- Obtain written approval before disposing or injecting salt water.
- If this permit has expired (See: authorized expiration date) please check the box below and return to the address below.

Well Not Drilled - Permit Expired
 Signature of Operator or Agent: _____
 Date: _____

Mail to: KCC - Conservation Division, 130 S. Market - Room 2078, Wichita, Kansas 67202

32
 33
 34W

IN ALL CASES PLOT THE INTENDED WELL ON THE PLAT BELOW

Plat of acreage attributable to a well in a prorated or spaced field

If the intended well is in a prorated or spaced field, please fully complete this side of the form. If the intended well is in a prorated or spaced field complete the plat below showing that the well will be properly located in relationship to other wells producing from the common source of supply. Please show all the wells and within 1 mile of the boundaries of the proposed acreage attribution unit for gas wells and within 1/2 mile of the boundaries of the proposed acreage attribution unit for oil wells.

API No. 15- 175-22062-0000
 Operator: AMERICAN WARRIOR, INC.
 Lease: LIGHT
 Well Number: 2-32A
 Field: Arkalan
 Number of Acres attributable to well: 160
 QTR / QTR / QTR of acreage: SE

Location of Well: County: Seward
1200 feet from N / S Line of Section
1225 feet from E / W Line of Section
 Sec. 32 Twp. 33 S. R. 32 East West
 Is Section: Regular or Irregular
 If Section is Irregular, locate well from nearest corner boundary.
 Section corner used: NE NW SE SW

PLAT

*(Show location of the well and shade attributable acreage for prorated or spaced wells.)
 (Show footage to the nearest lease or unit boundary line.)*

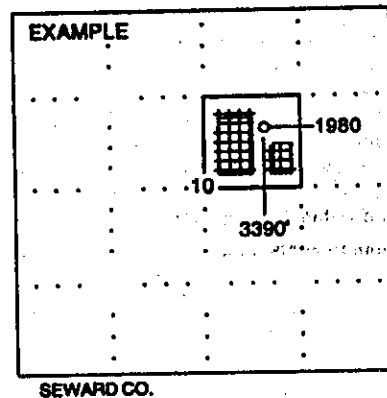
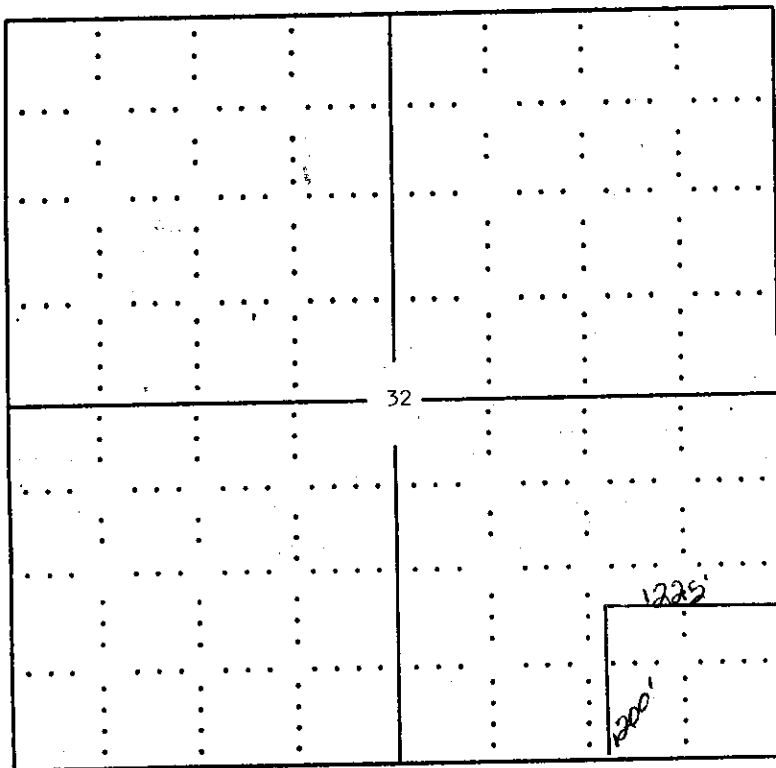

NOTE: In all cases locate the spot of the proposed drilling location.

SEWARD COUNTY

In plotting the proposed location of the well, you must show:

1. The manner in which you are using the depicted plat by identifying section lines, i.e. 1 section, 1 section with 8 surrounding sections, 4 sections, etc.
2. The distance of the proposed drilling location from the section's south / north and east / west.
3. The distance to the nearest lease or unit boundary line.
4. If proposed location is located within a prorated or spaced field a certificate of acreage attribution plat must be attached: (CO-7 for oil wells; CG-8 for gas wells).

**KANSAS CORPORATION COMMISSION
OIL & GAS CONSERVATION DIVISION
APPLICATION FOR SURFACE PIT**

Form COP-1
April 2004
Form must be Typed

Submit in Duplicate

SKID Rig - NO pits @ this loc.

Operator Name: AMERICAN WARRIOR, INC.		License Number: 4058
Operator Address: P. O. Box 399, Garden City, Kansas 67846-0399		
Contact Person: Cecil O'Brate		Phone Number: (620) 275 - 9231
Lease Name & Well No.: LIGHT #2-23A		Pit Location (QQQQ): _____ SE
Type of Pit: <input type="checkbox"/> Emergency Pit <input type="checkbox"/> Burn Pit <input type="checkbox"/> Settling Pit <input checked="" type="checkbox"/> Drilling Pit <input type="checkbox"/> Workover Pit <input type="checkbox"/> Haul-Off Pit <i>(If WWP Supply API No. or Year Drilled)</i>		Pit is: <input type="checkbox"/> Proposed <input checked="" type="checkbox"/> Existing If Existing, date constructed: _____ Pit capacity: _____ (bbls)
Is the pit located in a Sensitive Ground Water Area? <input checked="" type="checkbox"/> Yes <input type="checkbox"/> No		Chloride concentration: _____ mg/l <i>(For Emergency Pits and Settling Pits only)</i>
Is the bottom below ground level? <input checked="" type="checkbox"/> Yes <input type="checkbox"/> No	Artificial Liner? <input type="checkbox"/> Yes <input checked="" type="checkbox"/> No	How is the pit lined if a plastic liner is not used? Bentonite from drilling fluids
Pit dimensions (all but working pits): _____ 125 Length (feet) _____ 125 Width (feet) _____ N/A: Steel Pits Depth from ground level to deepest point: _____ 4 _____ (feet)		
If the pit is lined give a brief description of the liner material, thickness and installation procedure.		Describe procedures for periodic maintenance and determining liner integrity, including any special monitoring.
Distance to nearest water well within one-mile of pit _____ 1200 _____ feet Depth of water well _____ 401 _____ feet		Depth to shallowest fresh water _____ 100 _____ feet. ✓ Source of information: _____ measured _____ well owner <input checked="" type="checkbox"/> KGS <input checked="" type="checkbox"/> electric log <input checked="" type="checkbox"/> KDWR
Emergency, Settling and Burn Pits ONLY: Producing Formation: _____ Number of producing wells on lease: _____ Barrels of fluid produced daily: _____ Does the slope from the tank battery allow all spilled fluids to flow into the pit? <input type="checkbox"/> Yes <input type="checkbox"/> No		Drilling, Workover and Haul-Off Pits ONLY: Type of material utilized in drilling/workover: _____ Fresh _____ Number of working pits to be utilized: _____ 0 _____ Abandonment procedure: _____ evaporate then backfill _____ Drill pits must be closed within 365 days of spud date.
I hereby certify that the above statements are true and correct to the best of my knowledge and belief.		
_____ August 30, 2006 Date		_____ <i>Sally R. Byers</i> Signature of Applicant or Agent

Permitted Under <i>15-175-22061-0000</i> KCC OFFICE USE ONLY <i>SKID RIG</i>		
Date Received: <i>8/30/06</i>	Permit Number: _____	Permit Date: <i>8/30/06</i> Lease Inspection: <input checked="" type="checkbox"/> Yes <input type="checkbox"/> No

Mail to: KCC - Conservation Division, 130 S. Market - Room 2078, Wichita, Kansas 67202

RECEIVED
AUG 30 2006

**CONSERVATION DIVISION
WICHITA, KS**

15-175-22061-0000