

KANSAS CORPORATION COMMISSION
OIL & GAS CONSERVATION DIVISION

Form ACO-1
September 1999
Form Must Be Typed

WELL COMPLETION FORM
WELL HISTORY - DESCRIPTION OF WELL & LEASE

ORIGINAL

Operator: License # 32109
Name: Dakota Production Co. Inc.
Address: Rt. 2 Box 255
City/State/Zip: Neodesha, Kansas 66757
Purchaser: Oneok
Operator Contact Person: Doug Shay
Phone: (620) 325-5189
Contractor: Name: McPherson Drilling
License: 5675

Wellsite Geologist: Doug Shay
Designate Type of Completion:
 New Well Re-Entry Workover
 Oil SWD SIOW Temp. Abd.
 Gas ENHR SIGW
 Dry Other (Core, WSW, Expl., Cathodic, etc)

If Workover/Re-entry: Old Well Info as follows:

Operator: _____
Well Name: _____
Original Comp. Date: _____ Original Total Depth: _____
 Deepening Re-perf. Conv. to Enhr./SWD
 Plug Back Plug Back Total Depth
 Commingled Docket No. _____
 Dual Completion Docket No. _____
 Other (SWD or Enhr.?) Docket No. _____

12-11-01 12-12-01 4-8-03
Spud Date or Date Reached TD Completion Date or
Recompletion Date Recompletion Date

API No. 15-205-25505-0000
Wilson
County: _____
S/2 NW/NE Sec. 18 Twp. 30 S. R. 17 East West
4290 feet from S / N (circle one) Line of Section
1980 feet from E / W (circle one) Line of Section

Footages Calculated from Nearest Outside Section Corner:
(circle one) NE SE NW SW
Lease Name: Plummer Well #: 7

Field Name: Neodesha
Producing Formation: Mulkey-Summit
Elevation: Ground: 940' Kelly Bushing: _____
Total Depth: 781' Plug Back Total Depth: _____
Amount of Surface Pipe Set and Cemented at 23' Feet
Multiple Stage Cementing Collar Used? Yes No
If yes, show depth set _____ Feet
If Alternate II completion, cement circulated from 0'
feet depth to 23' 722 w A 132 sx cmt.

Drilling Fluid Management Plan AK-11 on 5-12-03
(Data must be collected from the Reserve Pit)
Chloride content _____ ppm Fluid volume _____ bbls
Dewatering method used _____

Location of fluid disposal if hauled offsite: _____
Operator Name: _____
Lease Name: _____ License No.: _____
Quarter _____ Sec. _____ Twp. _____ S. R. _____ East West
County: _____ Docket No.: _____

RECEIVED
MAY 07 2003
KCC WICHITA

INSTRUCTIONS: An original and two copies of this form shall be filed with the Kansas Corporation Commission, 130 S. Market - Room 2078, Wichita, Kansas 67202, within 120 days of the spud date, recompletion, workover or conversion of a well. Rule 82-3-130, 82-3-106 and 82-3-107 apply. Information of side two of this form will be held confidential for a period of 12 months if requested in writing and submitted with the form (see rule 82-3-107 for confidentiality in excess of 12 months). One copy of all wireline logs and geologist well report shall be attached with this form. ALL CEMENTING TICKETS MUST BE ATTACHED. Submit CP-4 form with all plugged wells. Submit CP-111 form with all temporarily abandoned wells.

All requirements of the statutes, rules and regulations promulgated to regulate the oil and gas industry have been fully complied with and the statements herein are complete and correct to the best of my knowledge.

Signature: [Signature]
Title: Owner Date: 4/25/03

Subscribed and sworn to before me this 25th day of April

2003
Notary Public: Jenni Boden Farwell

Date Commission Expires: 2-10-06

KCC Office Use ONLY
 Letter of Confidentiality Attached
If Denied, Yes Date: _____
 Wireline Log Received
 Geologist Report Received

TERRI BODEN FARWELL
Notary Public - State of Kansas
My App. Expires 2-10-06

Operator Name: Dakota Prod. Co. Inc. Lease Name: Plummer Well #: 7
 Sec. 18 Twp. 30 S. R. 17 East West County: Wilson

INSTRUCTIONS: Show important tops and base of formations penetrated. Detail all cores. Report all final copies of drill stems tests giving interval tested, time tool open and closed, flowing and shut-in pressures, whether shut-in pressure reached static level, hydrostatic pressures, bottom hole temperature, fluid recovery, and flow rates if gas to surface test, along with final chart(s). Attach extra sheet if more space is needed. Attach copy of all Electric Wireline Logs surveyed. Attach final geological well site report.

Drill Stem Tests Taken Yes No
 (Attach Additional Sheets)

Samples Sent to Geological Survey Yes No

Cores Taken Yes No

Electric Log Run Yes No
 (Submit Copy)

Log Formation (Top), Depth and Datum Sample
 Name Top Datum

List All E. Logs Run:

CASING RECORD <input type="checkbox"/> New <input checked="" type="checkbox"/> Used							
Report all strings set-conductor, surface, intermediate, production, etc.							
Purpose of String	Size Hole Drilled	Size Casing Set (In O.D.)	Weight Lbs. / Ft.	Setting Depth	Type of Cement	# Sacs Used	Type and Percent Additives
Surface	11"	8 5/8	32#	23'	Portland	4	
Production	8 5/8"	4 1/2"	8#3	728'	OWC	121	6sx Bentonite

ADDITIONAL CEMENTING / SQUEEZE RECORD				
Purpose:	Depth Top Bottom	Type of Cement	#Sacks Used	Type and Percent Additives
<input type="checkbox"/> Perforate				
<input type="checkbox"/> Protect Casing				
<input type="checkbox"/> Plug Back TD				
<input type="checkbox"/> Plug Off Zone				

Shots Per Foot	PERFORATION RECORD - Bridge Plugs Set/Type Specify Footage of Each Interval Perforated		Acid, Fracture, Shot, Cement Squeeze Record (Amount and Kind of Material Used)		Depth
	4	640'	to 648'	30 sx 20-40	
4	658'	to 664'	50 7/8	Ball Sealers	
			1 Gal.	Gel Breaker	

TUBING RECORD	Size	Set At	Packer At	Liner Run <input type="checkbox"/> Yes <input type="checkbox"/> No
---------------	------	--------	-----------	--

Date of First, Resumerd Production, SWD or Enhr. 4-24-03	Producing Method <input checked="" type="checkbox"/> Flowing <input type="checkbox"/> Pumping <input type="checkbox"/> Gas Lift <input type="checkbox"/> Other (Explain)			
Estimated Production Per 24 Hours	Oil Bbls.	Gas Mcf	Water Bbls.	Gas-Oil Ratio Gravity
		10	2	

Disposition of Gas Vented Sold Used on Lease (If vented, Sumit ACO-18.)

METHOD OF COMPLETION Open Hole Perf. Dually Comp. Commingled Other (Specify)

Production Interval

**Drillers Log
McPherson Drilling LLC**

ORIGINAL

Rig: 3
API No. 15- 205-25505
Operator: Dakota Production Co.
Address: Rt. 2 Box 255 Neodesha, KS 66757
Well No: 7 Lease Name: Plummer
Footage Location: 4290 ft. from the South Line
1980 ft. from the East Line
Drilling Contractor: McPherson Drilling LLC
Spud date: 12/11/01 Geologist: Doug Shay
Date Completed: 12/12/01 Total Depth: 781

S. 18 T. 30 R. 17e
Loc:
County: Wilson

Gas Tests:		
645'	3.92	MCF
661'	5.6	MCF
781'	6.01	MCF

RECEIVED

Casing Record		
	Surface	Production
Size Hole:	11"	6 3/4"
Size Casing:	8 5/8"	
Weight:	32#	
Setting Depth:	23' ✓	
Type Cement:	Portland	
Sacks:	4	

MAY 07 2003
KCC WICHITA

Rig Time:	Work Performed:

Well Log								
Formation	Top	Btm.	Formation	Top	Btm.	Formation	Top	Btm.
sand stone	0	8	mulkey	655	659			
shale	8	11	3rd oswego	659	664			
sand	11	24	shale	664	691			
shale	24	54	sand/shale	691	700 odor			
lime	54	57	sand	700	762			
shale	57	85	sand/shale	762	777			
lime	85	89	lime/shale	777	781 TD			
sand/shale	89	105						
lime	105	183						
shale	183	211						
lime	211	330						
shale	330	408						
lime	408	421						
shale	421	462						
sand	462	485 odor						
sand/shale	485	548						
lime	548	577						
shale	577	583						
sand/shale	583	591						
sand	591	614 odor						
1st oswego	614	636						
summit	636	641						
2nd oswego	641	655						

ORIGINAL

Invoice

Rick's Well Service

P.O. Box 268
129 Railroad
Cherryvale, KS 67335

DATE	INVOICE #
1/9/02	747

BILL TO
Dakota Production Rt. 2 Box 255 Neodesha, KS 66757

RECEIVED
MAY 07 2003
KCC WICHITA

SERVICED	DESCRIPTION	HOURS	RATE	AMOUNT
12/20/01	Plummer #7 - Run in 4 1/2" casing. Pulling unit	3.5	60.00	210.00T
12/21/01	Plummer #7 - Cement 4 1/2" casing.			
	Pump charge		425.00	425.00T
	121 sacks cement ✓	121	7.25	877.25T
	6 sacks of bentonite	6	10.00	60.00T
	4 1/2" cement wiper plug		25.20	25.20T
	Water truck	3	50.00	150.00T
	Sales Tax		7.00%	122.32

MAKE CHECKS PAYABLE TO:
Rick's Well Service
THANK YOU!

Total \$1,869.77

KCC OIL/GAS REGULATORY OFFICES

Date 18-Apr-03 XXX New Situation
Response to Request
Follow-up

Qtr, Qtr E 1/2 Sec. 18 Twp. 30 Rge. 17E

Operator DAKOTA PRODUCTION COMPANY License # 32109

Address RT 2, BOX 255

Address NEODESHA, KS. 66757 Lease/Well # PLUMMER

Phone # 972-567-0569 County WILSON

Lease Inspection XXX Complaint _____ Field Report XXX

RECEIVED
APR 24 2003
KCC WICHITA

Problem REQUEST FROM DAVE WILLIAMS IN CENTRAL OFFICE FOR LEASE INSPECTION.

Persons Contacted _____

Findings INSPECTION OF THIS LEASE REVEALED 7 PRODUCING GAS WELLS. ALL WELLS ARE COMPLETED WITH 4 1/2 INCH CASING AND TUBING. ALL WELLS WITH THE EXCEPTION OF ONE ARE EQUIPPED WITH PUMP JACKS AND WERE IN OPERATION AT THE TIME OF THIS INSPECTION. THE REMAINING WELL WAS SET UP TO FLOW INTO THE SYSTEM. THE PUMPER OF THIS LEASE REPORTED ALL THE SALTWATER FROM THIS WENT TO THE YORK DISPOSAL WELL LOCATED 4950 FSL AND 1320 FEL 16-30-17E WL. DOCKET # D-27,681

Photos Taken NO

Actions/Recommendations FOUND NO APPARENT VIOLATIONS OF THIS LEASE

FORWARD TO DAVE WILLIAMS

GPS SURVEY TO FOLLOW

By: TONY D. WILLIAMS

P.I.R.T. DISTRICT # 3

Retain 1 copy District Office
Send 1 copy Conservation Division

W 95° 37' 19.932"
N 37° 27' 20.560"

W 95° 32' 58.172"
N 37° 27' 26.291"

Plummer Lse: WL CO: S18 T30S R17E
Operator: Dakota Production Lic# 32109
Compiled: 05-02-2003

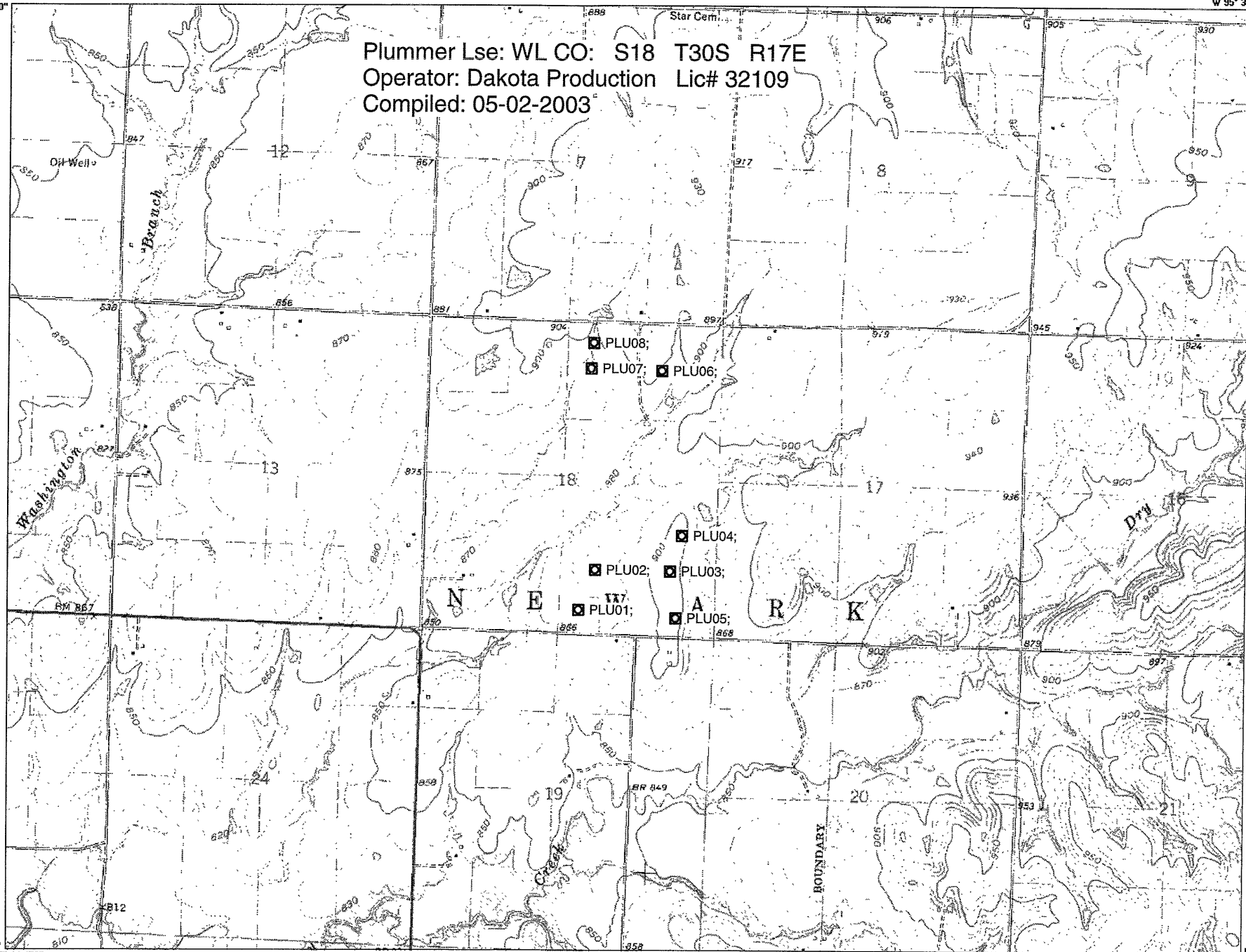

N 37° 24' 44.053"
W 95° 37' 14.470"

N 37° 24' 49.776"
W 95° 32' 52.862"

1927 North American Datum; 1,000-meter UTM grid zone 15
Generated by BigT oPo (www.igage.com)
Map compiled from USGS Quads: Morehead; KS

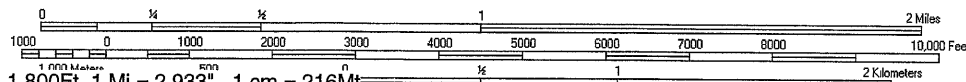

'Plummer Lse WL CO.IT3'; Scale: 1" = 0.341Mi 549Mt 1,800Ft, 1 Mi = 2.933", 1 cm = 216Mt

Plummer Lease

COUNTY	LEASE	SES.PT	ATTR.	DESC.	PRIORITY	LEVEL	Q3	Q2	Q1	SEC	TWP	RGE	FEL	FSL	OPERATOR
--------	-------	--------	-------	-------	----------	-------	----	----	----	-----	-----	-----	-----	-----	----------

WL

Total Wells In County 8

Plummer	PLU01	GAS_AC	4.5C2TRPJ	0			SW	SW	SE	18	30	17	-2280	414	Dakota Production
Plummer	PLU02	GAS_AC	4.5C2TRPJ	0			NW	SW	SE	18	30	17	-2014	1093	Dakota Production
Plummer	PLU03	GAS_AC	8S4.5C2TRPJ	0			NW	SE	SE	18	30	17	-740	1106	Dakota Production
Plummer	PLU04	GAS_AC	8S4.5C2TRPJ	0			SE	NE	SE	18	30	17	-556	1713	Dakota Production
Plummer	PLU05	GAS_AC	4.5C2TRPJ	0			SE	SE	SE	18	30	17	-620	322	Dakota Production
Plummer	PLU06	GAS_AC	4.5C	0			SW	NE	NE	18	30	17	-997	4479	Dakota Production
Plummer	PLU07	GAS_AC	8S4.5C2TRPJ	0			SW	NW	NE	18	30	17	-2193	4486	Dakota Production
Plummer	PLU08	GAS_PN		0			NW	NW	NE	18	30	17	-2165	4917	Dakota Production

TOTAL WELLS 8

