

For KCC Use: 95-06
Effective Date: _____
District # _____
SGA? Yes No

KANSAS CORPORATION COMMISSION
OIL & GAS CONSERVATION DIVISION

Form C-1
December 2002
Form must be Typed
Form must be Signed
All blanks must be Filled

NOTICE OF INTENT TO DRILL

Must be approved by KCC five (5) days prior to commencing well

Expected Spud Date September 7, 2006
month day year

OPERATOR: License# 33168
Name: WOOLSEY OPERATING COMPANY, LLC
Address: 125 N. Market, Suite 1000
City/State/Zip: Wichita, Kansas 67202
Contact Person: Dean Pattison
Phone: 316-267-4379 ext 107

CONTRACTOR: License# _____
Name: To be determined - will advise on ACO

Well Drilled For:	Well Class:	Type Equipment:
<input checked="" type="checkbox"/> Oil <input checked="" type="checkbox"/> Gas <input type="checkbox"/> OWWO <input type="checkbox"/> Seismic; # of Holes <input type="checkbox"/> Other	<input checked="" type="checkbox"/> Infield <input type="checkbox"/> Pool Ext. <input type="checkbox"/> Wildcat <input type="checkbox"/> Other	<input checked="" type="checkbox"/> Mud Rotary <input type="checkbox"/> Air Rotary <input type="checkbox"/> Cable

If OWWO: old well information as follows:
Operator: n/a
Well Name: _____
Original Completion Date: _____ Original Total Depth: _____

Directional, Deviated or Horizontal wellbore? Yes No
If Yes, true vertical depth: _____
Bottom Hole Location: _____
KCC DKT #: _____

Spot 120' W of _____ East
S2 S2 SE Sec. 10 Twp. 31 S. R. 17 West
330' FSL feet from N / S Line of Section
1440' FEL feet from E / W Line of Section
Is SECTION Regular Irregular?

(Note: Locate well on the Section Plat on reverse side)

County: Comanche
Lease Name: Shane Yost Well #: 1
Field Name: Wilmore

Is this a Prorated / Spaced Field? Yes No
Target Formation(s): Mississippian
Nearest Lease or unit boundary: 330'

Ground Surface Elevation: 2056' feet MSL
Water well within one-quarter mile: Yes No
Public water supply well within one mile: Yes No

Depth to bottom of fresh water: 150'
Depth to bottom of usable water: 180'

Surface Pipe by Alternate: 1 2
Length of Surface Pipe Planned to be set: 250'

Length of Conductor Pipe required: n/a
Projected Total Depth: 5400'

Formation at Total Depth: Viola
Water Source for Drilling Operations:
 Well Farm Pond Other To be hauled

DWR Permit #: _____
(Note: Apply for Permit with DWR)

Will Cores be taken? Yes No
If Yes, proposed zone: _____

AFFIDAVIT

The undersigned hereby affirms that the drilling, completion and eventual plugging of this well will comply with K.S.A. 55 et. seq.
It is agreed that the following minimum requirements will be met:

1. Notify the appropriate district office **prior** to spudding of well;
2. A copy of the approved notice of intent to drill **shall be** posted on each drilling rig;
3. The minimum amount of surface pipe as specified below **shall be set** by circulating cement to the top; in all cases surface pipe **shall be set** through all unconsolidated materials plus a minimum of 20 feet into the underlying formation.
4. If the well is dry hole, an agreement between the operator and the district office on plug length and placement is necessary **prior to plugging**;
5. The appropriate district office will be notified before well is either plugged or production casing is cemented in;
6. If an ALTERNATE II COMPLETION, production pipe shall be cemented from below any usable water to surface within **120 days** of spud date. Or pursuant to Appendix "B" - Eastern Kansas surface casing order #133,891-C, which applies to the KCC District 3 area, alternate II cementing must be completed within 30 days of the spud date or the well shall be plugged. **In all cases, NOTIFY district office** prior to any cementing.

I hereby certify that the statements made herein are true and to the best of my knowledge and belief.

Date: 08/28/06 Signature of Operator or Agent: Dean Pattison Title: Operations Manager

For KCC Use ONLY
API # 15 - 033-21479-0000
Conductor pipe required None feet
Minimum surface pipe required 200 feet per Alt. 1
Approved by: RH 8-31-06
This authorization expires: 2-28-07
(This authorization void if drilling not started within 6 months of approval date.)
Spud date: _____ Agent: _____

Remember to:
- File Drill Pit Application (form CDP-1) with Intent to Drill;
- File Completion Form ACO-1 within 120 days of spud date;
- File acreage attribution plat according to field proration orders;
- Notify appropriate district office 48 hours prior to workover or re-entry;
- Submit plugging report (CP-4) after plugging is completed;
- Obtain written approval before disposing or injecting salt water.
- If this permit has expired (See: authorized expiration date) please check the box below and return to the address below.
 Well Not Drilled - Permit Expired
Signature of Operator or Agent: _____
Date: _____

Mail to: KCC - Conservation Division, 130 S. Market - Room 2078, Wichita, Kansas 67202

RECEIVED
KANSAS CORPORATION COMMISSION
AUG 29 2006
CONSERVATION DIVISION
WICHITA, KS

10
31
17W

IN ALL CASES PLOT THE INTENDED WELL ON THE PLAT BELOW

Plat of acreage attributable to a well in a prorated or spaced field

If the intended well is in a prorated or spaced field, please fully complete this side of the form. If the intended well is in a prorated or spaced field complete the plat below showing that the well will be properly located in relationship to other wells producing from the common source of supply. Please show all the wells and within 1 mile of the boundaries of the proposed acreage attribution unit for gas wells and within 1/2 mile of the boundaries of the proposed acreage attribution unit for oil wells.

API No. 15 - 033-21479-0000
 Operator: WOOLSEY OPERATING COMPANY, LLC
 Lease: Shane Yost
 Well Number: 1
 Field: Wilmore
 Number of Acres attributable to well: _____
 QTR / QTR / QTR of acreage: S2 - S2 - SE

Location of Well: County: Comanche
330' FSL feet from N / S Line of Section
1440' FEL feet from E / W Line of Section
 Sec. 10 Twp. 31 S. R. 17 East West

Is Section: Regular or Irregular

If Section is Irregular, locate well from nearest corner boundary.
 Section corner used: NE NW SE SW

PLAT

*(Show location of the well and shade attributable acreage for prorated or spaced wells.)
 (Show footage to the nearest lease or unit boundary line.)*

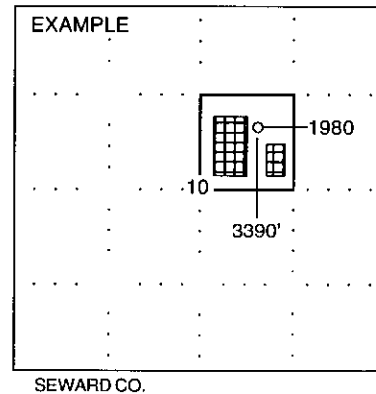
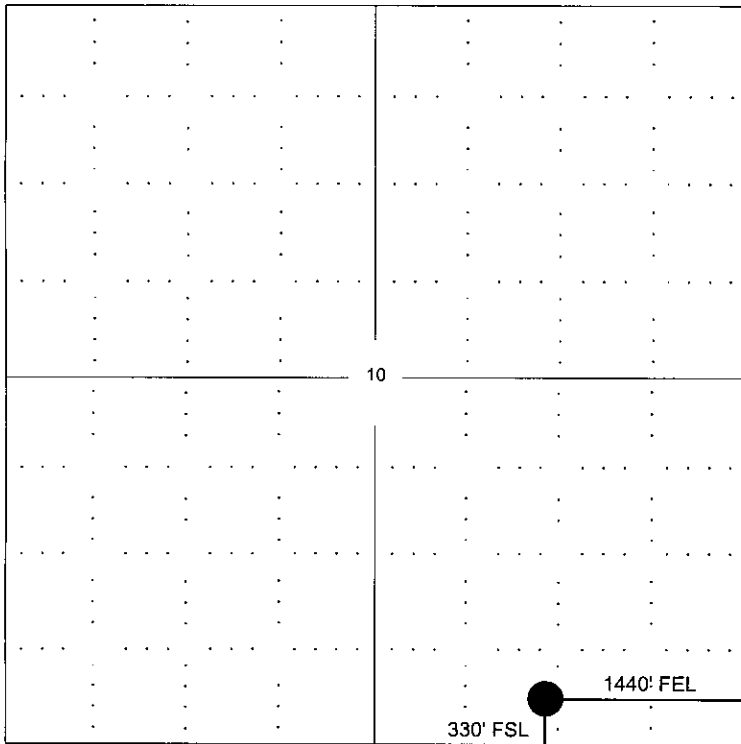

NOTE: In all cases locate the spot of the proposed drilling location.

In plotting the proposed location of the well, you must show:

1. The manner in which you are using the depicted plat by identifying section lines, i.e. 1 section, 1 section with 8 surrounding sections, 4 sections, etc.
2. The distance of the proposed drilling location from the section's south / north and east / west.
3. The distance to the nearest lease or unit boundary line.
4. If proposed location is located within a prorated or spaced field a certificate of acreage attribution plat must be attached: (CO-7 for oil wells; CG-8 for gas wells).

**KANSAS CORPORATION COMMISSION
OIL & GAS CONSERVATION DIVISION
APPLICATION FOR SURFACE PIT**

Form CDP-1
April 2004
Form must be Typed

Submit in Duplicate

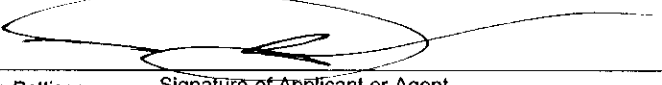
Operator Name: Woolsey Operating Company, LLC		License Number: 33168
Operator Address: 125 N. Market, Suite 1000, Wichita, Kansas 67202		
Contact Person: Carl W. Durr, Field Supervisor		Phone Number: (620) 886 - 5606 ext 27
Lease Name & Well No.: Shane Yost 1		Pit Location (QQQQ): 120' W. <u> S2 </u> <u> S2 </u> <u> SE </u> Sec. <u> 10 </u> Twp. <u> 31 </u> R. <u> 17 </u> <input type="checkbox"/> East <input checked="" type="checkbox"/> West <u> 330 </u> ' Feet from <input type="checkbox"/> North / <input checked="" type="checkbox"/> South Line of Section <u> 1440 </u> ' Feet from <input checked="" type="checkbox"/> East / <input type="checkbox"/> West Line of Section <u> Comanche </u> County
Type of Pit: <input type="checkbox"/> Emergency Pit <input type="checkbox"/> Burn Pit <input type="checkbox"/> Settling Pit <input checked="" type="checkbox"/> Drilling Pit <input type="checkbox"/> Workover Pit <input type="checkbox"/> Haul-Off Pit <small>(If WP Supply API No. or Year Drilled)</small>	Pit is: <input checked="" type="checkbox"/> Proposed <input type="checkbox"/> Existing If Existing, date constructed: _____ Pit capacity: _____ (bbls)	
Is the pit located in a Sensitive Ground Water Area? <input checked="" type="checkbox"/> Yes <input type="checkbox"/> No		Chloride concentration: _____ mg/l <small>(For Emergency Pits and Settling Pits only)</small>
Is the bottom below ground level? <input checked="" type="checkbox"/> Yes <input type="checkbox"/> No	Artificial Liner? <input type="checkbox"/> Yes <input checked="" type="checkbox"/> No	How is the pit lined if a plastic liner is not used? Clays from mud will provide sealer.
Pit dimensions (all but working pits): <u> 80 </u> Length (feet) <u> 80 </u> Width (feet) _____ N/A: Steel Pits Depth from ground level to deepest point: <u> 4 </u> (feet)		
If the pit is lined give a brief description of the liner material, thickness and installation procedure.		Describe procedures for periodic maintenance and determining liner integrity, including any special monitoring. Monitor pits until thoroughly dry.
Distance to nearest water well within one-mile of pit <u> NA </u> feet Depth of water well _____ feet		Depth to shallowest fresh water _____ feet. Source of information: _____ measured _____ well owner _____ electric log _____ KDWR
Emergency, Settling and Burn Pits ONLY: Producing Formation: _____ Number of producing wells on lease: _____ Barrels of fluid produced daily: _____ Does the slope from the tank battery allow all spilled fluids to flow into the pit? <input type="checkbox"/> Yes <input type="checkbox"/> No		Drilling, Workover and Haul-Off Pits ONLY: Type of material utilized in drilling/workover: <u> Fresh </u> Number of working pits to be utilized: <u> 3 </u> Abandonment procedure: <u> When dry, backfill and restore location. </u> Drill pits must be closed within 365 days of spud date.
I hereby certify that the above statements are true and correct to the best of my knowledge and belief.		
<u> August 29, 2006 </u> Date	 Dean Pattison Signature of Applicant or Agent	
KCC OFFICE USE ONLY		
Date Received: <u> 8/29/06 </u> Permit Number: _____ Permit Date: <u> 8/31/06 </u> Lease Inspection: <input checked="" type="checkbox"/> Yes <input type="checkbox"/> No	RFAS-4C	

RECEIVED
KANSAS CORPORATION COMMISSION
AUG 29 2006
CONSERVATION DIVISION
WICHITA, KS

15-033-21479-0000

KANSAS

CORPORATION COMMISSION

KATHLEEN SEBELIUS, GOVERNOR
BRIAN J. MOLINE, CHAIR
ROBERT E. KREHBIEL, COMMISSIONER
MICHAEL C. MOFFET, COMMISSIONER

August 31, 2006

Mr. Dean Pattisson
Woolsey Operating Company, LLC
125 N. Market Ste 1000
Wichita, KS 67202

RE: Drilling Pit Application
Shane Yost Lease Well No. 1
SE/4 Sec. 10-31S-17W
Comanche County, Kansas

Dear Mr. Pattisson:

District staff has inspected the above referenced location and has determined that the reserve pit shall be constructed **without slots**, the bottom shall be flat and reasonably level and the free fluids must be removed. The fluids are to be removed from the reserve pit as soon as the Hutchinson Salt section has been drilled through and displacement of the fluids into the reserve pit has occurred. The fluids should be removed again as soon as practical after drilling operations have ceased.

If production casing is set all completion fluids shall be removed from the working pits daily. NO completion fluids or non-exempt wastes shall be placed in the reserve pit.

The fluids should be taken to an authorized disposal well. Please call the District Office at (620) 225-8888 when the fluids have been removed. Please file form CDP-5 (August 2004), Exploration and Production Waste Transfer, within 30 days of fluid removal. Conservation division forms are available through our office and on the KCC web site: www.kcc.state.ks.us/conservation/forms.

A copy of this letter should be posted in the doghouse along with the approved Intent to Drill.

If you have any questions or concerns please feel free to contact the undersigned at the above address.

Sincerely,

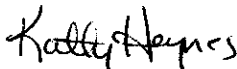

Kathy Haynes
Department of Environmental Protection and Remediation

cc: File