

Owwo

For KCC Use: 9-6-06  
Effective Date: \_\_\_\_\_  
District # 1  
SGA?  Yes  No

### KANSAS CORPORATION COMMISSION OIL & GAS CONSERVATION DIVISION

Form C-1  
December 2002  
Form must be Typed  
Form must be Signed  
All blanks must be Filled

## NOTICE OF INTENT TO DRILL

Must be approved by KCC five (5) days prior to commencing well

Expected Spud Date 09-15-06  
month day year

Spot NW 12 NE 22 Sec. 16 Twp. 22 S. R. 16  East  West  
4950 feet from  N /  S Line of Section  
2310 feet from  E /  W Line of Section

OPERATOR: License# 3180  
Name: Deutsch Oil Company  
Address: 8100 E. 22nd Street North, Bldg. 600  
City/State/Zip: Wichita, Kansas 67226  
Contact Person: Kent Deutsch  
Phone: 316-681-3587

is SECTION  Regular  Irregular?  
(Note: Locate well on the Section Plat on reverse side)

CONTRACTOR: License# 6426  
Name: Express Well Service

County: Pawnee  
Lease Name: Meyer Farms Well # OWWO 1-12  
Field Name: \_\_\_\_\_

Well Drilled For:  Oil  Enh Rec  Infield  Mud Rotary  
 Gas  Storage  Pool Ext.  Air Rotary  
 OWWO  Disposal  Wildcat  Cable  
 Seismic; # of Holes \_\_\_\_\_  Other \_\_\_\_\_  
 Other \_\_\_\_\_

Is this a Prorated / Spaced Field?  Yes  No  
Target Formation(s): Arbuckle  
Nearest Lease or unit boundary: 330  
Ground Surface Elevation: 1992 feet MSL

If OWWO: old well information as follows:  
Operator: Graham-Miller  
Well Name: #1 Boyd  
Original Completion Date: 03-02-56 Original Total Depth: 3925

Water well within one-quarter mile:  Yes  No  
Public water supply well within one mile:  Yes  No  
Depth to bottom of fresh water: 100  
Depth to bottom of usable water: 200

Directional, Deviated or Horizontal wellbore?  Yes  No  
If Yes, true vertical depth: \_\_\_\_\_  
Bottom Hole Location: \_\_\_\_\_  
KCC DKT #: \_\_\_\_\_

Surface Pipe by Alternate:  1  2  
Length of Surface Pipe ~~Planned to be set~~: 665  
Length of Conductor Pipe required: none  
Projected Total Depth: 3925

Formation at Total Depth: Arbuckle  
Water Source for Drilling Operations:  
 Well  Farm Pond Other Trucked

DWR Permit #: \_\_\_\_\_  
(Note: Apply for Permit with DWR )  
Will Cores be taken?  Yes  No  
If Yes, proposed zone: \_\_\_\_\_

### AFFIDAVIT

The undersigned hereby affirms that the drilling, completion and eventual plugging of this well will comply with K.S.A. 55 et. seq.  
It is agreed that the following minimum requirements will be met:

RECEIVED  
AUG 31 2006  
KCC WICHITA

1. Notify the appropriate district office *prior* to spudding of well;
2. A copy of the approved notice of intent to drill *shall be* posted on each drilling rig;
3. The minimum amount of surface pipe as specified below *shall be set* by circulating cement to the top; in all cases surface pipe *shall be set* through all unconsolidated materials plus a minimum of 20 feet into the underlying formation.
4. If the well is dry hole, an agreement between the operator and the district office on plug length and placement is necessary *prior to plugging*;
5. The appropriate district office will be notified before well is either plugged or production casing is cemented in;
6. If an ALTERNATE II COMPLETION, production pipe shall be cemented from below any usable water to surface within **120 days** of spud date. Or pursuant to Appendix "B" - Eastern Kansas surface casing order #133,891-C, which applies to the KCC District 3 area, alternate II cementing must be completed within 30 days of the spud date or the well shall be plugged. **In all cases, NOTIFY district office** prior to any cementing.

I hereby certify that the statements made herein are true and to the best of my knowledge and belief.  
Date: 08-31-06 Signature of Operator or Agent: \_\_\_\_\_ Title: Owner

For KCC Use ONLY  
API # 15 - 145-30166-00-02  
Conductor pipe required NONE feet  
Minimum surface pipe required 665 feet per Alt. 1  
Approved by: [Signature]  
This authorization expires: 3-1-07  
(This authorization void if drilling not started within 6 months of approval date.)  
Spud date: \_\_\_\_\_ Agent: \_\_\_\_\_

Remember to:  
- File Drill Pit Application (form CDP-1) with Intent to Drill;  
- File Completion Form ACO-1 within 120 days of spud date;  
- File acreage attribution plat according to field proration orders;  
- Notify appropriate district office 48 hours prior to workover or re-entry;  
- Submit plugging report (CP-4) after plugging is completed;  
- Obtain written approval before disposing or injecting salt water.  
- If this permit has expired (See: authorized expiration date) please check the box below and return to the address below.  
 Well Not Drilled - Permit Expired  
Signature of Operator or Agent: \_\_\_\_\_  
Date: \_\_\_\_\_

Mail to: KCC - Conservation Division, 130 S. Market - Room 2078, Wichita, Kansas 67202

1/2  
222  
16W

**IN ALL CASES PLOT THE INTENDED WELL ON THE PLAT BELOW**

*Plat of acreage attributable to a well in a prorated or spaced field*

*If the intended well is in a prorated or spaced field, please fully complete this side of the form.* If the intended well is in a prorated or spaced field complete the plat below showing that the well will be properly located in relationship to other wells producing from the common source of supply. Please show all the wells and within 1 mile of the boundaries of the proposed acreage attribution unit for gas wells and within 1/2 mile of the boundaries of the proposed acreage attribution unit for oil wells.

API No. 15 - 145-30166-00-02  
 Operator: Deutsch Oil Company  
 Lease: Meyer Farms  
 Well Number: 12-OWWO  
1-12  
 Field: \_\_\_\_\_  
 Number of Acres attributable to well: \_\_\_\_\_  
 QTR / QTR / QTR of acreage: NW - NW - NE

Location of Well: County: Pawnee  
 4950 \_\_\_\_\_ feet from  N /  S Line of Section  
 2310 \_\_\_\_\_ feet from  E /  W Line of Section  
 Sec. 12 Twp. 22 S. R. 16  East  West

Is Section:  Regular or  Irregular

If Section is Irregular, locate well from nearest corner boundary.  
 Section corner used:  NE  NW  SE  SW

**PLAT**

*(Show location of the well and shade attributable acreage for prorated or spaced wells.)  
 (Show footage to the nearest lease or unit boundary line.)*

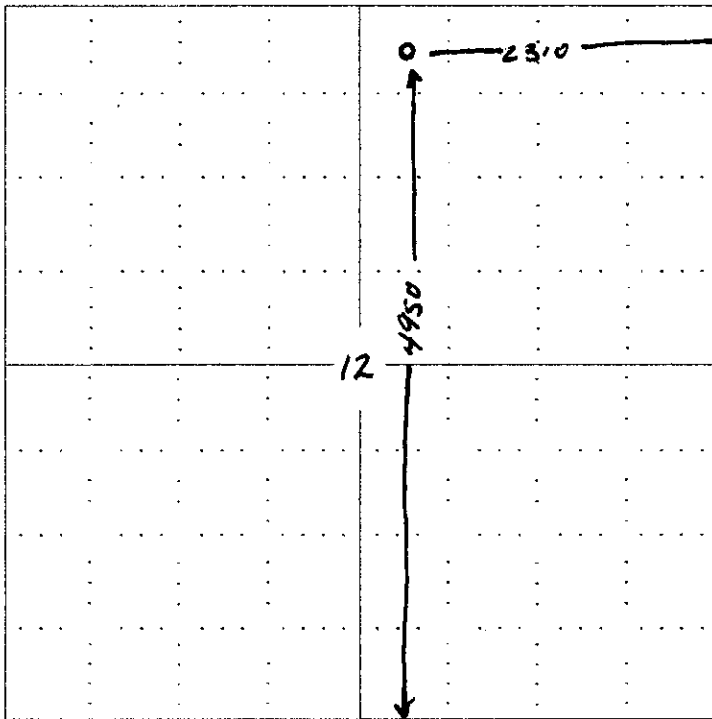

RECEIVED  
 AUG 31 2006  
 KCC WICHITA

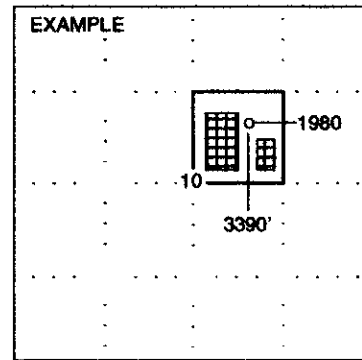

SEWARD CO.

**NOTE: In all cases locate the spot of the proposed drilling location.**

**In plotting the proposed location of the well, you must show:**

1. The manner in which you are using the depicted plat by identifying section lines, i.e. 1 section, 1 section with 8 surrounding sections, 4 sections, etc.
2. The distance of the proposed drilling location from the section's south / north and east / west.
3. The distance to the nearest lease or unit boundary line.
4. If proposed location is located within a prorated or spaced field a certificate of acreage attribution plat must be attached: (CO-7 for oil wells; CG-8 for gas wells).

**KANSAS CORPORATION COMMISSION  
OIL & GAS CONSERVATION DIVISION  
APPLICATION FOR SURFACE PIT**

Form CDP-1  
April 2004  
Form must be Typed

*Submit in Duplicate*

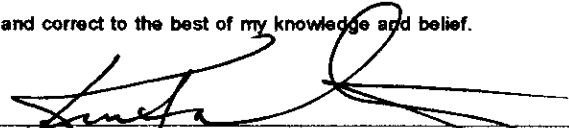
Operator Name: <b>Deutsch Oil Company</b>		License Number: <b>3180</b>
Operator Address: <b>8100 E. 22nd Street North Bldg. 600 Wichita, Ks 67226</b>		
Contact Person: <b>Kent Deutsch</b>		Phone Number: ( <b>316</b> ) <b>681 - 3567</b>
Lease Name & Well No.: <b>Meyer Farms #1-12 OWWO</b>		Pit Location (QQQQ): <b>NW . NW . NE .</b>
Type of Pit: <input type="checkbox"/> Emergency Pit <input type="checkbox"/> Burn Pit <input type="checkbox"/> Settling Pit <input type="checkbox"/> Drilling Pit <input checked="" type="checkbox"/> Workover Pit <input type="checkbox"/> Haul-Off Pit <small>(If WP Supply API No. or Year Drilled)</small>	Pit is: <input checked="" type="checkbox"/> Proposed <input type="checkbox"/> Existing If Existing, date constructed: _____ Pit capacity: <b>120</b> (bbls)	Sec. <b>12</b> Twp. <b>22</b> R. <b>16</b> <input type="checkbox"/> East <input checked="" type="checkbox"/> West <b>4950</b> Feet from <input type="checkbox"/> North / <input checked="" type="checkbox"/> South Line of Section <b>2310</b> Feet from <input type="checkbox"/> East / <input checked="" type="checkbox"/> West Line of Section <b>Pawnee</b> County
Is the pit located in a Sensitive Ground Water Area? <input checked="" type="checkbox"/> Yes <input type="checkbox"/> No		Chloride concentration: _____ mg/l <small>(For Emergency Pits and Settling Pits only)</small>
Is the bottom below ground level? <input checked="" type="checkbox"/> Yes <input type="checkbox"/> No	Artificial Liner? <input type="checkbox"/> Yes <input checked="" type="checkbox"/> No	How is the pit lined if a plastic liner is not used? <b>Mud gel from drilling mud</b>
Pit dimensions (all but working pits): <b>30</b> Length (feet) <b>15</b> Width (feet) <b>N/A: Steel Pits</b> Depth from ground level to deepest point: <b>5</b> (feet)		
If the pit is lined give a brief description of the liner material, thickness and installation procedure.		Describe procedures for periodic maintenance and determining liner integrity, including any special monitoring.
Distance to nearest water well within one-mile of pit <b>14</b> feet    Depth of water well <b>80</b> feet		Depth to shallowest fresh water <b>100 33</b> feet. Source of information: <b>KHKW</b> <sup>①</sup> _____ measured <input checked="" type="checkbox"/> well owner    _____ electric log    _____ KDWR
<b>Emergency, Settling and Burn Pits ONLY:</b> Producing Formation: _____ Number of producing wells on lease: _____ Barrels of fluid produced daily: _____ Does the slope from the tank battery allow all spilled fluids to flow into the pit? <input type="checkbox"/> Yes <input type="checkbox"/> No		<b>Drilling, Workover and Haul-Off Pits ONLY:</b> Type of material utilized in drilling/workover: <b>drilling mud &amp; water</b> Number of working pits to be utilized: <b>2</b> Abandonment procedure: <b>haul off free water, allow to dry then backfill</b> Drill pits must be closed within 365 days of spud date.
I hereby certify that the above statements are true and correct to the best of my knowledge and belief.		
08-31-06 Date	 Signature of Applicant or Agent	
<b>KCC OFFICE USE ONLY</b>		
Date Received: <b>8/31/06</b> Permit Number: _____ Permit Date: <b>8/31/06</b> Lease Inspection: <input checked="" type="checkbox"/> Yes <input type="checkbox"/> No	<b>RFAC</b>	

**RECEIVED  
AUG 31 2006  
KCC WICHITA**

**15-145-30166-00-02**

# KANSAS

CORPORATION COMMISSION

KATHLEEN SEBELIUS, GOVERNOR

BRIAN J. MOLINE, CHAIR

ROBERT E. KREHBIEL, COMMISSIONER

MICHAEL C. MOFFET, COMMISSIONER

August 31, 2006

Mr. Kent Deutsch  
Deutsch Oil Company  
8100 E. 22<sup>nd</sup> St North, Bldg. 600  
Wichita, KS 67226

RE: Drilling Pit Application  
Meyer Farms Lease Well No. 1-12 OWWO  
NE/4 Sec. 12-22S-16W  
Pawnee County, Kansas

Dear Mr. Deutsch:

District staff has inspected the above referenced location and has determined that the reserve pit shall be constructed **without slots**, the bottom shall be flat and reasonably level, and the free fluids must be removed. The fluids are to be removed from the reserve pit as soon as practical after drilling operations have ceased.

**If production casing is set all completion fluids shall be removed from the working pits daily. NO completion fluids or non-exempt wastes shall be placed in the reserve pit.**

The fluids should be taken to an authorized disposal well. Please call the District Office at (620) 225-8888 when the fluids have been removed. Please file form CDP-5 (August 2004), Exploration and Production Waste Transfer, within 30 days of fluid removal. Conservation division forms are available through our office and on the KCC web site:  
[www.kcc.state.ks.us/conservation/forms](http://www.kcc.state.ks.us/conservation/forms).

**A copy of this letter should be posted in the doghouse along with the approved Intent to Drill.** If you have any questions or concerns please feel free to contact the undersigned at the above address.

Sincerely,

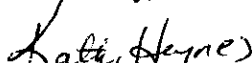
  
Kathy Haynes

Environmental Protection and Remediation Department

cc: File

15-145-30166-00-00

STATE OF KANSAS  
CORPORATION COMMISSION

Information Completely  
Verified Affidavit  
Plumber Report to  
Conservation Division  
Corporation Commission  
No. Broadway  
Wichita, Kansas

WELL PLUGGING RECORD

Pawnee County, Sec. 12 Twp. 22 Rge. 16 (E) (W) X  
NW NW NE

Location as "NE/CNW&SWX" or footage from lines  
Lease Owner Messman-Rinehart Oil Co.  
Lease Name Kathy Boyd Well No. #1  
Office Address 518 Petroleum Bldg., Wichita, Kansas  
Character of Well (completed as Oil, Gas or Dry Hole)  
Date well completed \_\_\_\_\_ 19\_\_\_\_  
Application for plugging filed \_\_\_\_\_ 19\_\_\_\_  
Application for plugging approved \_\_\_\_\_ 19\_\_\_\_  
Plugging commenced 12-10-62 \_\_\_\_\_ 19\_\_\_\_  
Plugging completed 12-16-62 \_\_\_\_\_ 19\_\_\_\_  
Reason for abandonment of well or producing formation \_\_\_\_\_

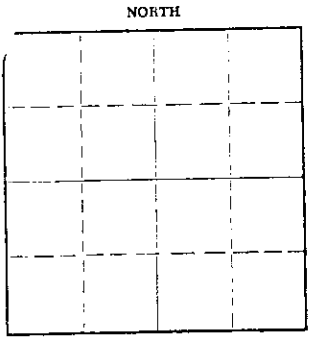

Locate well correctly on above  
Section Plat

Name of Conservation Agent who supervised plugging of this well Hugh E. Scott  
Producing formation \_\_\_\_\_ Depth to top \_\_\_\_\_ Bottom \_\_\_\_\_ Total Depth of Well 3929' Feet  
Show depth and thickness of all water, oil and gas formations.

OIL, GAS OR WATER RECORDS

CASING RECORD

FORMATION	CONTENT	FROM	TO	SIZE	PUT IN	PULLED OUT

Describe in detail the manner in which the well was plugged, indicating where the mud fluid was placed and the method or methods used in introducing it into the hole. If cement or other plugs were used, state the character of same and depth placed, from \_\_\_\_\_ feet to \_\_\_\_\_ feet for each plug set.

Checked hole and found top of sand at 3910'. Mixed and dumped 5 sacks cement thru dump bailor.  
Squeeze hold with 15 sacks gel and 100 sacks cement by Globe Oil Well Cementing

DEC 18 1962

CONSERVATION DIVISION  
WICHITA, KANSAS

Name of Plugging Contractor Southwest Casing Pulling Co., Inc  
Address Box 364, Great Bend, Kansas

STATE OF Kansas, COUNTY OF Barton, ss.  
Southwest Casing Pulling Co., Inc. (employee of owner) or (owner or operator) of the above-described well, being first duly sworn on oath, says: That I have knowledge of the facts, statements, and matters herein contained and the log of the above-described well as filed and that the same are true and correct. So help me God.

(Signature) W. C. Spencer  
Box 364, Great Bend, Kansas  
(Address)

SUBSCRIBED AND SWORN TO before me this 17 day of December, 1962

My commission expires 21 October 1964  
Sidney S. Miller  
Notary Public.

15-145-30166-00-00

NO. 1 BOYD

WELL LOG

Location: Nw Nw NE, 12-223-16W  
 Pawnee County, Kansas

Operator: Gramschart-Miller Oil Company  
 1005 East Second, Wichita, Kansas

Contractor: Graham-Messman-Rinshart Drilling Co.  
 1005 East Second, Wichita, Kansas

Casing Records: 8 5/8" @ 665' w/300 sacks cement  
 5 1/2" @ 3925' w/75 sacks cement

Commenced: February 21, 1956  
 Completed: March 2, 1956  
 Elevation: 1992 KB  
 Production:

.....L O G.....

Sand-Clay	100
Shale-Shells	330
Red Bed-Shale	415
Sand	505
Red Bed-Sand	555
Red Bed	960
Anhydrite	983
Shale-Red Bed	1130
Shale	1855
Limn-Shale	2065
Limn	2207
Limn-Shale	2430
Limn-Shale streaks	2505
Limn	2720
Limn-Shale	2950
Limn	3145
Limn-Shale	3235
Limn	3369
Limn-Shale	3480
Shale	3505
Brown Limn	3515
Lansing - Limn	3833
Conglomerate	3874
Simpson	3920
Arbuckle	3927 N.T.D.

STATE CORPORATION COMMISSION

JAN 9 1963

CONSERVATION DIVISION  
 Wichita, Kansas

Log Tops:

- Reebner 3395 (-1403)
- Bra Limn 3506 (-1514)
- Lansing-K.O. 3516 (-1524)
- Bra Kansas City 3756 (-1764)
- Penn Cherty Congl. 3834 (-1842)
- Simpson 3874 (-1882)
- Arbuckle 3920 (-1928)

The undersigned, GRAHAM-MESSMAN-RINSHART DRILLING COMPANY, hereby certifies that the above log is a true and correct log of the formation encountered in drilling the above well as reflected by the Daily Drilling Report.

GRAHAM-MESSMAN-RINSHART DRILLING COMPANY

By: J. A. Gilliland  
 J. A. Gilliland

Subscribed and sworn to before me  
 this 13th day of March 1956.

Juanita L. Louis  
 Notary Public

My Commission Expires: November 5, 1958