

OWWO

For KCC Use: Effective Date: 9-23-06 District # 4 SGA? Yes No

KANSAS CORPORATION COMMISSION OIL & GAS CONSERVATION DIVISION

Form C-1 December 2002 Form must be Typed Form must be Signed All blanks must be Filled

NOTICE OF INTENT TO DRILL

Must be approved by KCC five (5) days prior to commencing well

Expected Spud Date 9/18/06 month day year

OPERATOR: License# 31171 Name: Continental Operating Co. Address: 1 Houston Center 1221 McKinney Ste. 3700 Houston Tx. 77010 Contact Person: Melton Smith Phone: 713-209-1110

CONTRACTOR: License# 32128 Name: Western Well Servicing

Well Drilled For: Oil Gas Seismic; # of Holes Other Enh Rec Storage Disposal Infield Pool Ext. Wildcat Other Mud Rotary Air Rotary Cable

If OWWO: old well information as follows: Operator: Darby - Bothwell Well Name: Husted B-1 Original Completion Date: 5-16-46 Original Total Depth: 3588'

Directional, Deviated or Horizontal wellbore? Yes No If Yes, true vertical depth: Bottom Hole Location: KCC DKT #:

Spot NE SE SW Sec. 11 Twp. 10 S. R. 19 East West 990' feet from N / S Line of Section 2970' feet from E / W Line of Section Is SECTION Regular Irregular?

(Note: Locate well on the Section Plat on reverse side) County: Rooks Lease Name: Husted Well #: B-1 Field Name: Vohs Is this a Prorated / Spaced Field? Yes No Target Formation(s): Arbuckle Nearest Lease or unit boundary: 990' Ground Surface Elevation: 2093' feet MSL Water well within one-quarter mile: Yes No Public water supply well within one mile: Yes No Depth to bottom of fresh water: 180' Depth to bottom of usable water: 800' Surface Pipe by Alternate: 1 2 Length of Surface Pipe Planned to be set: 1440' Length of Conductor Pipe required: NONE Projected Total Depth: 3588' Formation at Total Depth: Arbuckle Water Source for Drilling Operations: Well Farm Pond Other Truck DWR Permit #:

(Note: Apply for Permit with DWR) Will Cores be taken? Yes No If Yes, proposed zone:

AFFIDAVIT

The undersigned hereby affirms that the drilling, completion and eventual plugging of this well will comply with K.S.A. 55 et. seq. It is agreed that the following minimum requirements will be met:

- 1. Notify the appropriate district office prior to spudding of well;
2. A copy of the approved notice of intent to drill shall be posted on each drilling rig;
3. The minimum amount of surface pipe as specified below shall be set by circulating cement to the top; in all cases surface pipe shall be set through all unconsolidated materials plus a minimum of 20 feet into the underlying formation.
4. If the well is dry hole, an agreement between the operator and the district office on plug length and placement is necessary prior to plugging;
5. The appropriate district office will be notified before well is either plugged or production casing is cemented in;
6. If an ALTERNATE II COMPLETION, production pipe shall be cemented from below any usable water to surface within 120 days of spud date. Or pursuant to Appendix "B" - Eastern Kansas surface casing order #:33,897-C, which applies to the KCC District 3 area, alternate II cementing must be completed within 30 days of the spud date or the well shall be plugged. In all cases, NOTIFY district office prior to any cementing.

I hereby certify that the statements made herein are true and to the best of my knowledge and belief. Date: 9/11/06 Signature of Operator or Agent: [Signature] Title: Prod. Mgr.

For KCC Use ONLY API # 15 - 163-01915-00-01 Conductor pipe required None feet Minimum surface pipe required 1440 feet per Alt. OX Approved by: [Signature] 9-18-06 This authorization expires: 3-18-07 (This authorization void if drilling not started within 6 months of approval date.) Spud date: Agent:

Remember to: - File Drill Pit Application (form CDP-1) with Intent to Drill; - File Completion Form ACO-1 within 120 days of spud date; - File acreage attribution plat according to field protraction orders; - Notify appropriate district office 48 hours prior to workover or re-entry; - Submit plugging report (CP-4) after plugging is completed; - Obtain written approval before disposing or injecting salt water. - If this permit has expired (See: authorized expiration date) please check the box below and return to the address below. Well Not Drilled - Permit Expired Signature of Operator or Agent: Date:

Mail to: KCC - Conservation Division, 130 S. Market - Room 2078, Wichita, Kansas 67202

RECEIVED SEP 15 2006 KCC WICHITA

11 10 19W

IN ALL CASES PLOT THE INTENDED WELL ON THE PLAT BELOW

Plat of acreage attributable to a well in a prorated or spaced field

If the intended well is in a prorated or spaced field, please fully complete this side of the form. If the intended well is in a prorated or spaced field complete the plat below showing that the well will be properly located in relationship to other wells producing from the common source of supply. Please show all the wells and within 1 mile of the boundaries of the proposed acreage attribution unit for gas wells and within 1/2 mile of the boundaries of the proposed acreage attribution unit for oil wells.

API No. 15 - 163-01915 - 00-01

Operator: Continental Operating Co.

Lease: Husted

Well Number: B-1

Field: Vohs

Number of Acres attributable to well: _____

QTR / QTR / QTR of acreage: NE - SE - SW

Location of Well: County: Rooks

990' feet from N / S Line of Section

2970' feet from E / W Line of Section

Sec. 11 Twp. 10 S. R. 19 East West

Is Section: Regular or Irregular

If Section is Irregular, locate well from nearest corner boundary.

Section corner used: NE NW SE SW

PLAT

(Show location of the well and shade attributable acreage for prorated or spaced wells.)
(Show footage to the nearest lease or unit boundary line.)

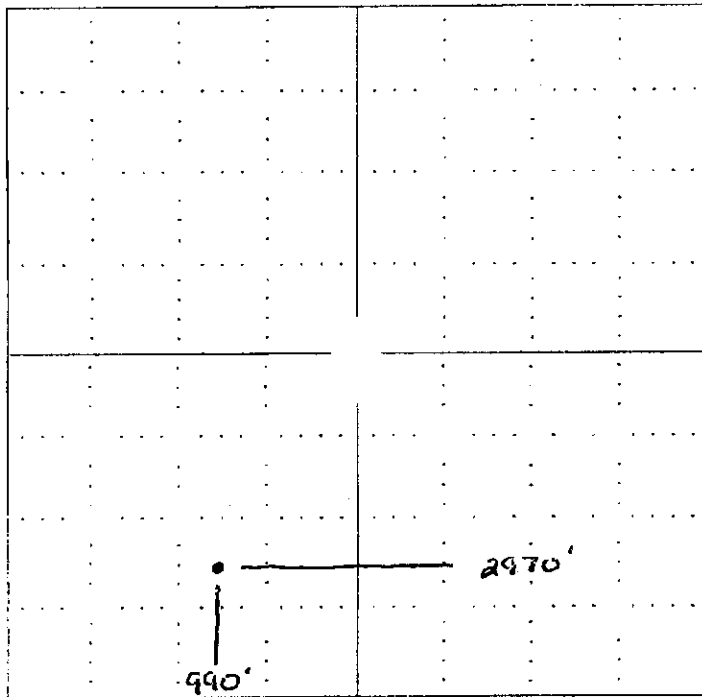

RECEIVED
SEP 15 2006
KCC WICHITA

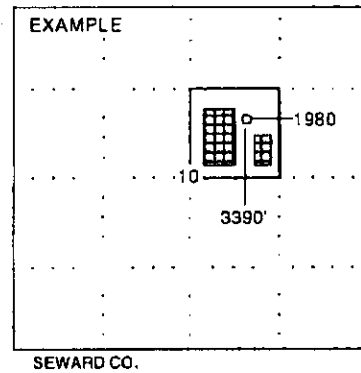

NOTE: In all cases locate the spot of the proposed drilling location.

In plotting the proposed location of the well, you must show:

1. The manner in which you are using the depicted plat by identifying section lines, i.e. 1 section, 1 section with 8 surrounding sections, 4 sections, etc.
2. The distance of the proposed drilling location from the section's south / north and east / west.
3. The distance to the nearest lease or unit boundary line.
4. If proposed location is located within a prorated or spaced field a certificate of acreage attribution plat must be attached: (CO-7 for oil wells; CG-8 for gas wells).

KANSAS CORPORATION COMMISSION
OIL & GAS CONSERVATION DIVISION

Form CDP-1
April 2004
Form must be Typed

APPLICATION FOR SURFACE PIT

Submit in Duplicate

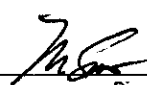
Operator Name: Continental Operating Co.		License Number: 31171
Operator Address: 1 Houston Center 1221 McKinney Ste. 3700		
Contact Person: Melton Smith		Phone Number: (713) 209 - 1110
Lease Name & Well No.: Husted B-1		Pit Location (QQQQ): NE SE SW _____ Sec. 11 Twp. 10 R. 19 <input type="checkbox"/> East <input checked="" type="checkbox"/> West 990' Feet from <input type="checkbox"/> North / <input checked="" type="checkbox"/> South Line of Section 2970' Feet from <input checked="" type="checkbox"/> East / <input type="checkbox"/> West Line of Section Rooks _____ County
Type of Pit: <input type="checkbox"/> Emergency Pit <input type="checkbox"/> Burn Pit <input type="checkbox"/> Settling Pit <input checked="" type="checkbox"/> Drilling Pit <input checked="" type="checkbox"/> Workover Pit <input type="checkbox"/> Haul-Off Pit <small>(If WP Supply API No or Year Drilled)</small>	Pit is: <input type="checkbox"/> Proposed <input type="checkbox"/> Existing If Existing, date constructed: steel pit Pit capacity: 110 (bbls)	
Is the pit located in a Sensitive Ground Water Area? <input type="checkbox"/> Yes <input checked="" type="checkbox"/> No		Chloride concentration: _____ mg/l <small>(For Emergency Pits and Settling Pits only)</small>
Is the bottom below ground level? <input type="checkbox"/> Yes <input checked="" type="checkbox"/> No	Artificial Liner? <input type="checkbox"/> Yes <input checked="" type="checkbox"/> No	How is the pit lined if a plastic liner is not used? NONE
Pit dimensions (all but working pits): _____ Length (feet) _____ Width (feet) X N/A: Steel Pits Depth from ground level to deepest point: _____ (feet)		
If the pit is lined give a brief description of the liner material, thickness and installation procedure.		Describe procedures for periodic maintenance and determining liner integrity, including any special monitoring.
		RECEIVED SEP 15 2006 KCC WICHITA
Distance to nearest water well within one-mile of pit 4430 feet Depth of water well 52 feet	Depth to shallowest fresh water 37 feet Source of information: KRKC3 (3) _____ measured _____ well owner _____ electric log _____ KDWR	
Emergency, Settling and Burn Pits ONLY: Producing Formation: _____ Number of producing wells on lease: _____ Barrels of fluid produced daily: _____ Does the slope from the tank battery allow all spilled fluids to flow into the pit? <input type="checkbox"/> Yes <input type="checkbox"/> No	Drilling, Workover and Haul-Off Pits ONLY: Type of material utilized in drilling/workover: water Number of working pits to be utilized: 1 Abandonment procedure: _____ Drill pits must be closed within 365 days of spud date.	
I hereby certify that the above statements are true and correct to the best of my knowledge and belief.		
<u>9/14/06</u> Date		<u></u> Signature of Applicant or Agent
KCC OFFICE USE ONLY		
Date Received: <u>9/15/06</u> Permit Number: _____ Permit Date: <u>9/15/06</u> Lease Inspection: <input type="checkbox"/> Yes <input checked="" type="checkbox"/> No		Steel pits

15-163-01915-00-01

KANSAS

CORPORATION COMMISSION

KATHLEEN SEBELIUS, GOVERNOR

BRIAN J. MOLINE, CHAIR

ROBERT E. KREHBIEL, COMMISSIONER

MICHAEL C. MOFFET, COMMISSIONER

HAUL-OFF PIT APPLICATION FILING REQUIREMENTS

82-3-607. DISPOSAL OF DIKE AND PIT CONTENTS.

- (a) Each operator shall perform one of the following when disposing of dike or pit contents:
- (1) Remove the liquid contents to a disposal well or other oil and gas operation approved by the commission or to road maintenance or construction locations approved by the department;
 - (2) dispose of reserve pit waste down the annular space of a well completed according to the alternate I requirements of K.A.R. 82-3-106, if the waste to be disposed of was generated during the drilling and completion of the well; or
 - (3) dispose of the remaining solid contents in any manner required by the commission. The requirements may include any of the following:
 - (A) Burial in place, in accordance with the grading and restoration requirements in K.A.R. 82-3-602 (f);
 - (B) removal and placement of the contents in an on-site disposal area approved by the commission;
 - (C) removal and placement of the contents in an off-site disposal area on acreage owned by the same landowner or to another producing lease or unit operated by the same operator, if prior written permission from the landowner has been obtained; or
 - (D) removal of the contents to a permitted off-site disposal area approved by the department.
- (b) Each violation of this regulation shall be punishable by the following:
- (1) A \$1,000 penalty for the first violation;
 - (2) a \$2,500 penalty for the second violation; and
 - (3) a \$5,000 penalty and an operator license review for the third violation.

Complete and return with Haul-Off Pit Application, Form CDP1(2004)

Haul-off pit will be located in an on-site disposal area: Yes No

Haul-off pit is located in an off-site disposal area on acreage owned by the same landowner:

Yes No If yes, written permission from the land owner must be obtained. Attach written permission to haul-off pit application.

Haul-off pit is located in an off-site disposal area on another **producing** lease or unit operated by the same operator: Yes No If yes, written permission from the land owner must be obtained. Attach permission and a copy of the lease assignment that covers the acreage where the haul-off pit is to be located, to the haul-off pit application.

Conservation Division, Finney State Office Building, 130 S. Market, Room 2078, Wichita, KS 67202-3802

Voice 316.337.6200 Fax 316.337.6211 www.kcc.state.ks.us

15-163-01915-00-00

WELL PLUGGING RECORD

Give All Information Completely
Make Required Affidavit
Mail or Deliver Report to:
Conservation Division
State Corporation Commission
212 No. Market
Wichita, Kansas

NORTH

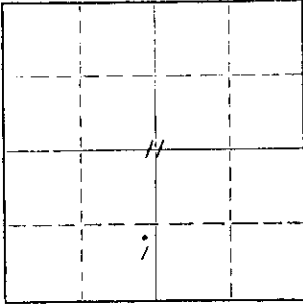

Locate well correctly on above
Section Plat

Rooks County, Sec. **11** Twp. **108** Rge. (E) **19W** (W)
Location as "NE:CNW&SWK" or footage from lines. **NE SE SW**
Lease Owner: **Kowamee Oil Company**
Lease Name: **Husted B** Well No. **1**
Office Address: **P. O. Box 360, Hoisington, Kansas 67544**
Character of Well (completed as Oil, Gas or Dry Hole): **Oil**
Date well completed: **May 16, 19 46**
Application for plugging filed: **August 6, 19 70**
Application for plugging approved: **August 7, 19 70**
Plugging commenced: **September 10, 19 70**
Plugging completed: **September 12, 19 70**
Reason for abandonment of well or producing formation: **not economical**
If a producing well is abandoned, date of last production: **July 19 70**
Was permission obtained from the Conservation Division or its agents before plugging was commenced? **Yes**

Name of Conservation Agent who supervised plugging of this well: **Leo Massey**
Producing formation: **Arbuckle** Depth to top: **3582** Bottom: **3588** Total Depth of Well: **3588** Feet
Show depth and thickness of all water, oil and gas formations.

OIL, GAS OR WATER RECORDS

CASING RECORD

FORMATION	CONTENT	FROM	TO	SIZE	PUT IN	PULLED OUT
				8-5/8"	1450'	none
				5-1/2"	3583'	2612'

Describe in detail the manner in which the well was plugged, indicating where the mud fluid was placed and the method or methods used in introducing it into the hole. If cement or other plugs were used, state the character of same and depth placed, from _____ feet to _____ feet for each plug set.

Made bottom hole plug back with sand to 3560'. Mixed and ran 4 sacks cement. Sand to 3100'. Mixed and ran 4 sacks cement thru dump baller. Mudded hole to 670', set 20' rock bridge. Mixed and ran 3 yards of cement. Mudded hole to 235' and set 10' rock bridge. Mixed and dumped 3 yards of cement to base of cellar.

(If additional description is necessary, use BACK of this sheet)

Name of Plugging Contractor: **Southwest Casing Pulling Company**
Address: **Box 364, Great Bend, Kansas 67530**

STATE OF Kansas COUNTY OF Sedgwick, ss.
Bill Patton (employee of owner) or (owner or operator) of the above-described well, being first duly sworn on oath, says: That I have knowledge of the facts, statements, and matters herein contained and the log of the above-described well as filed and that the same are true and correct. So help me God.

(Signature) *Bill Patton*

P. O. Box 360, Hoisington, Kansas 67544
(Address)

Signed and sworn to before me this **16th** day of **September**, 19 **70**

Sam B. McMatt
Notary Public.

