

OWWO

For KCC Use: 9-2406
Effective Date: _____
District # 2
SGA? Yes No

KANSAS CORPORATION COMMISSION
OIL & GAS CONSERVATION DIVISION
NOTICE OF INTENT TO DRILL

Form C-1
December 2002
Form must be Typed
Form must be Signed
All blanks must be Filled

Must be approved by KCC five (5) days prior to commencing well

Expected Spud Date October, 14 2006
month day year

OPERATOR: License# 5214
Name: Lario Oil & Gas Co.
Address: 301 South Market
City/State/Zip: Wichita, KS 67202
Contact Person: Jay G. Schweikert
Phone: 316-265-5611

CONTRACTOR: License# 33350
Name: Southwind Drilling, Inc.

Well Drilled For: Oil Enh Rec Gas Storage OWO Disposal Seismic; # of Holes Other
Well Class: Infield Pool Ext. Wildcat Other
Type Equipment: Mud Rotary Air Rotary Cable

If OWWO: old well information as follows:
Operator: Vincent Oil Corporation
Well Name: Dieffenbacher #1
Original Completion Date: 07/05/77 Original Total Depth: 3837

Directional, Deviated or Horizontal wellbore? Yes No
If Yes, true vertical depth: _____
Bottom Hole Location: _____
KCC DKT #: _____

Spot East
SW - SE - SW Sec. 36 Twp. 27S S. R. 05 West
330 feet from N / S Line of Section
1650 feet from E / W Line of Section
Is SECTION Regular Irregular?

(Note: Locate well on the Section Plat on reverse side)

County: Kingman
Lease Name: Dieffenbacher Trust Well #: 1-36 RE
Field Name: Broadway North

Is this a Prorated / Spaced Field? Yes No
Target Formation(s): Mississippian
Nearest Lease or unit boundary: 330

Ground Surface Elevation: 1435 est. feet MSL
Water well within one-quarter mile: Yes No
Public water supply well within one mile: Yes No

Depth to bottom of fresh water: 150
Depth to bottom of usable water: 180
Surface Pipe by Alternate: 1 2
Length of Surface Pipe Planned to be set existing @ 265' 225'

Length of Conductor Pipe required: None
Projected Total Depth: 4100 ft.
Formation at Total Depth: Mississippian

Water Source for Drilling Operations: Well Farm Pond Other _____
DWR Permit #: _____

(Note: Apply for Permit with DWR)

Will Cores be taken? Yes No
If Yes, proposed zone: _____

AFFIDAVIT

The undersigned hereby affirms that the drilling, completion and eventual plugging of this well will comply with K.S.A. 55 et. seq.
It is agreed that the following minimum requirements will be met:

RECEIVED
SEP 18 2006
KCC WICHITA

1. Notify the appropriate district office *prior* to spudding of well;
2. A copy of the approved notice of intent to drill *shall be* posted on each drilling rig;
3. The minimum amount of surface pipe as specified below *shall be set* by circulating cement to the top; in all cases surface pipe *shall be set* through all unconsolidated materials plus a minimum of 20 feet into the underlying formation.
4. If the well is dry hole, an agreement between the operator and the district office on plug length and placement is necessary *prior to plugging*;
5. The appropriate district office will be notified before well is either plugged or production casing is cemented in;
6. If an ALTERNATE II COMPLETION, production pipe shall be cemented from below any usable water to surface within **120 days** of spud date. Or pursuant to Appendix "B" - Eastern Kansas surface casing order #133,891-C, which applies to the KCC District 3 area, alternate II cementing must be completed within 30 days of the spud date or the well shall be plugged. **In all cases, NOTIFY district office** prior to any cementing.

I hereby certify that the statements made herein are true and to the best of my knowledge and belief.

Date: 9/15/06 Signature of Operator or Agent: Jay G. Schweikert Title: Operations Engineer

For KCC Use ONLY
API # 15 - 095-20598-0001
Conductor pipe required None feet
Minimum surface pipe required 225 feet per Alt. 1
Approved by: fw 9-19-06
This authorization expires: 3-19-07
(This authorization void if drilling not started within 6 months of effective date.)
Spud date: _____ Agent: _____

Remember to:

- File Drill Pit Application (form CDP-1) with Intent to Drill;
- File Completion Form ACO-1 within 120 days of spud date;
- File acreage attribution plat according to field proration orders;
- Notify appropriate district office 48 hours prior to workover or re-entry;
- Submit plugging report (CP-4) after plugging is completed;
- Obtain written approval before disposing or injecting salt water.
- If this permit has expired (See: authorized expiration date) please check the box below and return to the address below.

Well Not Drilled - Permit Expired

Signature of Operator or Agent: _____
Date: _____

Mail to: KCC - Conservation Division, 130 S. Market - Room 2078, Wichita, Kansas 67202

36
27
SW

IN ALL CASES PLOT THE INTENDED WELL ON THE PLAT BELOW

Plat of acreage attributable to a well in a prorated or spaced field

If the intended well is in a prorated or spaced field, please fully complete this side of the form. If the intended well is in a prorated or spaced field complete the plat below showing that the well will be properly located in relationship to other wells producing from the common source of supply. Please show all the wells and within 1 mile of the boundaries of the proposed acreage attribution unit for gas wells and within 1/2 mile of the boundaries of the proposed acreage attribution unit for oil wells.

API No. 15 - 095-20598-00-01
Operator: Lario Oil & Gas Co.
Lease: Dieffenbacher Trust
Well Number: 1-36 RE
Field: Broadway North
Number of Acres attributable to well: 40
QTR / QTR / QTR of acreage: SW - SE - SW

Location of Well: County: Kingman
330 feet from N / S Line of Section
1650 feet from E / W Line of Section
Sec. 36 Twp. 27S S. R. 05 East West

Is Section: Regular or Irregular

If Section is Irregular, locate well from nearest corner boundary.

Section corner used: NE NW SE SW

PLAT

(Show location of the well and shade attributable acreage for prorated or spaced wells.)

(Show footage to the nearest lease or unit boundary line.)

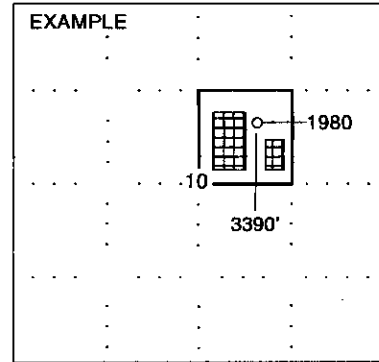
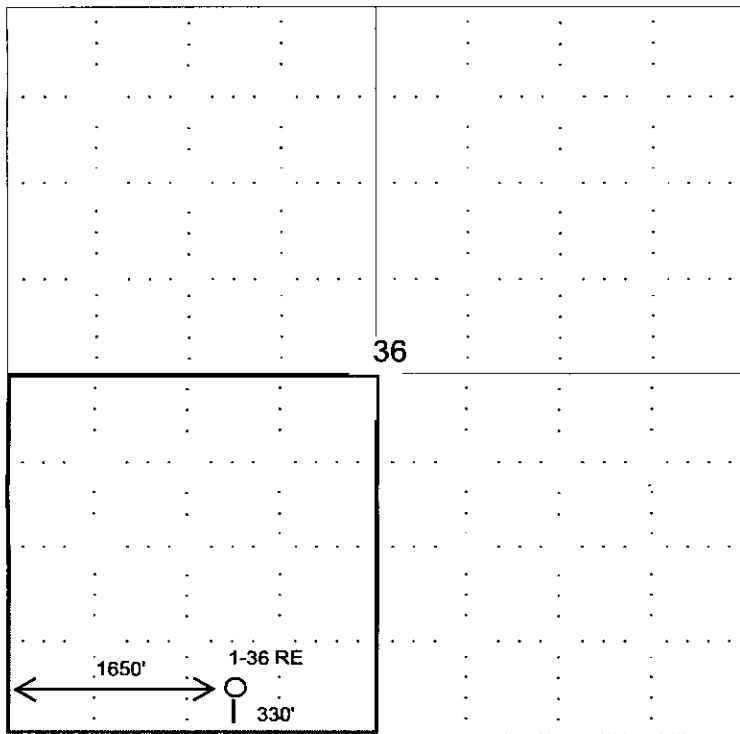

NOTE: In all cases locate the spot of the proposed drilling location.

Lease

In plotting the proposed location of the well, you must show:

1. The manner in which you are using the depicted plat by identifying section lines, i.e. 1 section, 1 section with 8 surrounding sections, 4 sections, etc.
2. The distance of the proposed drilling location from the section's south / north and east / west.
3. The distance to the nearest lease or unit boundary line.
4. If proposed location is located within a prorated or spaced field a certificate of acreage attribution plat must be attached: (CO-7 for oil wells; CG-8 for gas wells).

KANSAS CORPORATION COMMISSION
OIL & GAS CONSERVATION DIVISION
APPLICATION FOR SURFACE PIT

Form CDP-1
April 2004
Form must be Typed

Submit in Duplicate

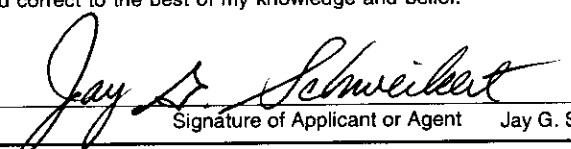
Operator Name: Lario Oil & Gas Company		License Number: 5214	
Operator Address: 301 South Market		Wichita, KS 67202	
Contact Person: Jay G. Schweikert		Phone Number: (316) 265 5611	
Lease Name & Well No.: Dieffenbacher Trust #1-36RE		Pit Location (QQQQ): _____ SW _____ SE _____ SW Sec. 36 Twp. 27S R. 05 <input type="checkbox"/> East <input checked="" type="checkbox"/> West 330 Feet from <input type="checkbox"/> North / <input checked="" type="checkbox"/> South Line of Section 1650 Feet from <input type="checkbox"/> East / <input checked="" type="checkbox"/> West Line of Section Kingman County	
Type of Pit: <input type="checkbox"/> Emergency Pit <input type="checkbox"/> Burn Pit <input type="checkbox"/> Settling Pit <input checked="" type="checkbox"/> Drilling Pit <input type="checkbox"/> Workover Pit <input type="checkbox"/> Haul-Off Pit <small>(If WP Supply API No. or Year Drilled)</small>	Pit is: <input checked="" type="checkbox"/> Proposed <input type="checkbox"/> Existing If Existing, date constructed: _____ Pit capacity: 4500 (bbls)		
Is the pit located in a Sensitive Ground Water Area? <input type="checkbox"/> Yes <input checked="" type="checkbox"/> No		Chloride concentration: _____ mg/l <small>(For Emergency Pits and Settling Pits only)</small>	
Is the bottom below ground level? <input checked="" type="checkbox"/> Yes <input type="checkbox"/> No	Artificial Liner? <input type="checkbox"/> Yes <input checked="" type="checkbox"/> No	How is the pit lined if a plastic liner is not used?	
Pit dimensions (all but working pits): 80 Length (feet) 80 Width (feet) N/A: Steel Pits Depth from ground level to deepest point: 4 (feet)			
If the pit is lined give a brief description of the liner material, thickness and installation procedure.		Describe procedures for periodic maintenance and determining liner integrity, including any special monitoring.	
		RECEIVED SEP 18 2006 KCC WICHITA	
Distance to nearest water well within one-mile of pit 1100 feet Depth of water well 115 feet		Depth to shallowest fresh water 30 feet. Source of information: _____ measured _____ well owner _____ electric log <input checked="" type="checkbox"/> KDWR	
Emergency, Settling and Burn Pits ONLY: Producing Formation: _____ Number of producing wells on lease: _____ Barrels of fluid produced daily: _____ Does the slope from the tank battery allow all spilled fluids to flow into the pit? <input type="checkbox"/> Yes <input type="checkbox"/> No		Drilling, Workover and Haul-Off Pits ONLY: Type of material utilized in drilling/workover: Bentonite Mud Number of working pits to be utilized: 2 Abandonment procedure: Allow for evaporation. Fill in & cover pits. Drill pits must be closed within 365 days of spud date.	
I hereby certify that the above statements are true and correct to the best of my knowledge and belief.			
9/15/06 Date	 Signature of Applicant or Agent Jay G. Schweikert		

15-095-20598-03-01

KCC OFFICE USE ONLY			
Date Received: 9/18/06	Permit Number: _____	Permit Date: 9/18/06	Lease Inspection: <input type="checkbox"/> Yes <input checked="" type="checkbox"/> No

Mail to: KCC - Conservation Division, 130 S. Market - Room 2078, Wichita, Kansas 67202

15 095-20598-00-00

STATE OF KANSAS
STATE CORPORATION COMMISSION

WELL PLUGGING RECORD

Give All Information Completely
Make Required Affidavit
Mail or Deliver Report to
Conservation Division
State Corporation Comm.
245 North Water
Wichita, KS 67202

Kingman County, Sec. 36 Twp. 27S Rge. 5 E/W
Location as "NE/CNW/SW" or footage from lines _____
SW SE SW
Lease Owner Vincent Oil Corporation
Lease Name Dieffenbacher Well No. One
Office Address 901 Union Center Building Wichita, Kansas
Character of Well (Completed as Oil, Gas or Dry Hole) _____
Dry Hole
Date Well completed 7-5-77 19____
Application for plugging filed 7-5-77 19____
Application for plugging approved 7-5-77 19____
Plugging commenced 7-5-77 19____
Plugging completed 7-5-77 19____
Reason for abandonment of well or producing formation _____
Dry Hole
If a producing well is abandoned, date of last production _____ 19____

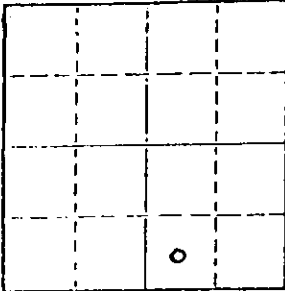

Locate well correctly on above
Section Plot

Name of Conservation Agent who supervised plugging of this well J. H. Metz
Producing formation None Depth to top _____ Bottom _____ Total Depth of Well 337
Show depth and thickness of all water, oil and gas formations.

OIL, GAS OR WATER RECORDS

CASING RECORD

FORMATION	CONTENT	FROM	TO	SIZE	PUT IN	PULLED OUT
				8 5/8"	225	None

Describe in detail the manner in which the well was plugged, indicating where the mud fluid was placed and the method or methods used in introducing it into the hold. If cement or other plugs were used, state the character of same and depth placed, from _____ feet to _____ feet for each plug set.

Plug @ 40' W/10sks Cement
Plug @ 240' W 40 sks Cement
Mud 240' to 3837
s sks rat hole

RECORDED
JUL 12 1977
CONSERVATION DIVISION
WICHITA, KANSAS

(If additional description is necessary, use BACK of this sheet)

Name of Plugging Contractor Big Springs Drilling, Inc.

STATE OF Kansas COUNTY OF Sedgwick, ss.
Paul A. Seymour, Jr. (employee of owner) or (owner or operator)
of the above-described well, being first duly sworn on oath, says: That I have knowledge of the facts, statements, and matters herein contained and the log of the above-described well as filed and that the same are true and correct. So help me God.

(Signature) Paul A. Seymour, Jr.
P. O. Box 8287, Munder Station
(Address) Wichita, Kansas

SUBSCRIBED AND SWORN TO before me this 11th day of July, 1977

Ruth M. Bassett
Ruth M. Bassett Notary Public.
My commission expires May 30, 1979