

*** CORRECTION ***

For KCC Use:
Effective Date: 8-20-06
District # 4
SGA? Yes No

KANSAS CORPORATION COMMISSION
OIL & GAS CONSERVATION DIVISION

CORRECTED

Form C-1

December 2002

Form must be Typed

Form must be Signed

All blanks must be Filled

NOTICE OF INTENT TO DRILL

Must be approved by KCC five (5) days prior to commencing well

Expected Spud Date 10/1/2006
month day year

OPERATOR: License# 33657
Name: Ohio Kentucky Oil Corporation
Address: 110 E. Lowry Lane
City/State/Zip: Lexington, Kentucky 40503
Contact Person: DEANNA MCDOWELL
Phone: 859-389-9127

CONTRACTOR: License# 33493
Name: American Eagle Drilling

Well Drilled For:	Well Class:	Type Equipment:
<input checked="" type="checkbox"/> Oil	<input type="checkbox"/> Enh Rec	<input checked="" type="checkbox"/> Mud Rotary
<input type="checkbox"/> Gas	<input type="checkbox"/> Storage	<input type="checkbox"/> Air Rotary
<input type="checkbox"/> OWO	<input type="checkbox"/> Disposal	<input type="checkbox"/> Cable
<input type="checkbox"/> Seismic; # of Holes	<input type="checkbox"/> Wildcat	
<input type="checkbox"/> Other	<input type="checkbox"/> Other	

If OWWO: old well information as follows:
Operator: _____
Well Name: _____
Original Completion Date: _____ Original Total Depth: _____

Directional, Deviated or Horizontal wellbore? Yes No

If Yes, true vertical depth: _____

Bottom Hole Location: _____

KCC DKT #: _____

*** WAS: NE-SW-NW 1050' FNL 990' FNL
IS: SE-NW-NW 1072' FNL 825' FNL**

AFFIDAVIT

The undersigned hereby affirms that the drilling, completion and eventual plugging of this well will comply with K.S.A. 55 et. seq.

It is agreed that the following minimum requirements will be met:

1. Notify the appropriate district office **prior** to spudding of well;
2. A copy of the approved notice of intent to drill **shall be** posted on each drilling rig;
3. The minimum amount of surface pipe as specified below **shall be set** by circulating cement to the top; in all cases surface pipe **shall be set** through all unconsolidated materials plus a minimum of 20 feet into the underlying formation.
4. If the well is dry hole, an agreement between the operator and the district office on plug length and placement is necessary **prior to plugging**;
5. The appropriate district office will be notified before well is either plugged or production casing is cemented in;
6. If an ALTERNATE II COMPLETION, production pipe shall be cemented from below any usable water to surface within **120 days** of spud date.
Or pursuant to Appendix "B" - Eastern Kansas surface casing order #133,891-C, which applies to the KCC District 3 area, alternate II cementing must be completed within 30 days of the spud date or the well shall be plugged. **In all cases, NOTIFY district office** prior to any cementing.

I hereby certify that the statements made herein are true and to the best of my knowledge and belief.

Date: 9-14-06 Signature of Operator or Agent: [Signature] Title: VICE-PRESIDENT

For KCC Use ONLY
 API # 15 - 195-22385-0000
 Conductor pipe required None feet
 Minimum surface pipe required 200 feet per Alt. **X2**
 Approved by: [Signature] 8-15-06 / [Signature] 9-20-06
 This authorization expires: 2-15-07
 (This authorization void if drilling not started within 6 months of effective date.)
 Spud date: _____ Agent: _____

Remember to:

- File Drill Pit Application (form CDP-1) with Intent to Drill;
- File Completion Form ACO-1 within 120 days of spud date;
- File acreage attribution plat according to field proration orders;
- Notify appropriate district office 48 hours prior to workover or re-entry;
- Submit plugging report (CP-4) after plugging is completed;
- Obtain written approval before disposing or injecting salt water.
- If this permit has expired (See: authorized expiration date) please check the box below and return to the address below.

Well Not Drilled - Permit Expired

Signature of Operator or Agent: _____
Date: _____

Mail to: KCC - Conservation Division, 130 S. Market - Room 2078, Wichita, Kansas 67202

**RECEIVED
SEP 20 2006
KCC WICHITA**

12
11
24W

IN ALL CASES PLOT THE INTENDED WELL ON THE PLAT BELOW

Plat of acreage attributable to a well in a prorated or spaced field

CORRECTED

If the intended well is in a prorated or spaced field, please fully complete this side of the form. If the intended well is in a prorated or spaced field complete the plat below showing that the well will be properly located in relationship to other wells producing from the common source of supply. Please show all the wells and within 1 mile of the boundaries of the proposed acreage attribution unit for gas wells and within 1/2 mile of the boundaries of the proposed acreage attribution unit for oil wells.

Correction *

API No. 15 - 195-22385-0000

Operator: Ohio Kentucky Oil Corporation

Lease: R Vreeland

Well Number: 2

Field: Saline Valley East

Location of Well: County: Trego

1072 feet from N / S Line of Section

825 feet from E / W Line of Section

Sec. 12 Twp. 11s S. R. 24w East West

Is Section: Regular or Irregular

If Section is Irregular, locate well from nearest corner boundary.

Section corner used: NE NW SE SW

Number of Acres attributable to well:

QTR / QTR / QTR of acreage: NE SW NW

PLAT

(Show location of the well and shade attributable acreage for prorated or spaced wells.)

(Show footage to the nearest lease or unit boundary line.)

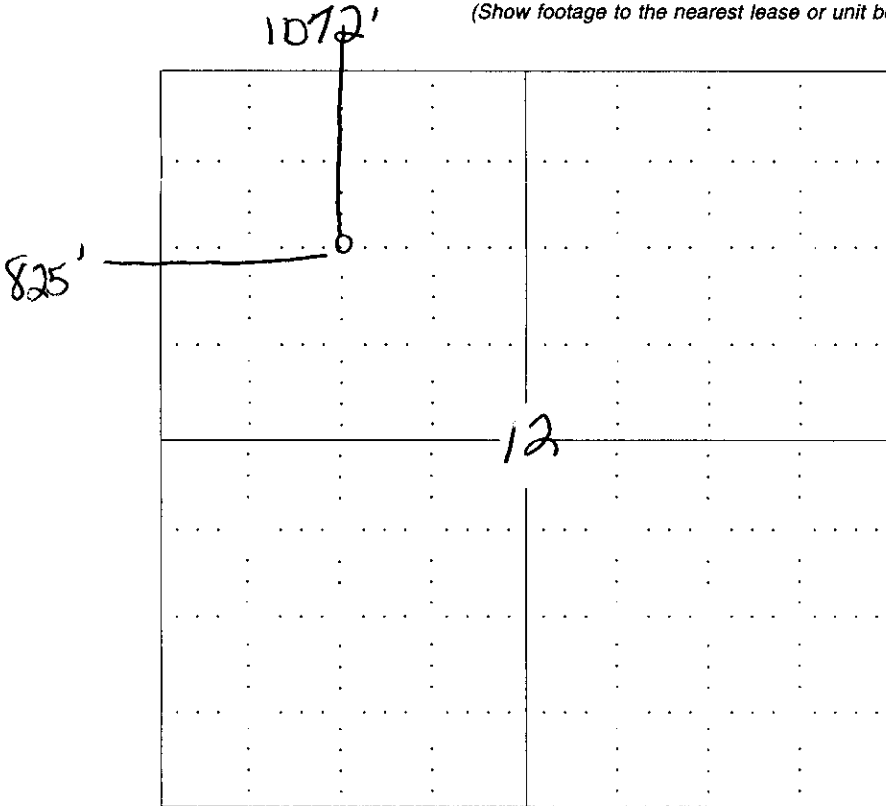

RECEIVED SEP 20 2006 KCC WICHITA

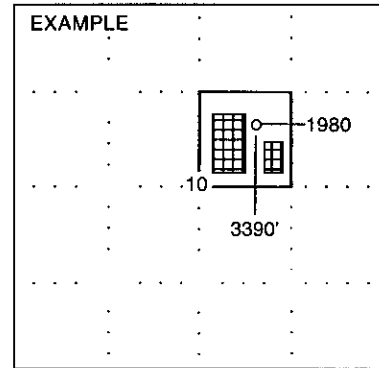

SEWARD CO.

NOTE: In all cases locate the spot of the proposed drilling location.

In plotting the proposed location of the well, you must show:

- 1. The manner in which you are using the depicted plat by identifying section lines, i.e. 1 section, 1 section with 8 surrounding sections, 4 sections, etc.
2. The distance of the proposed drilling location from the section's south / north and east / west.
3. The distance to the nearest lease or unit boundary line.
4. If proposed location is located within a prorated or spaced field a certificate of acreage attribution plat must be attached: (CO-7 for oil wells; CG-8 for gas wells).

15-195-22385-0000

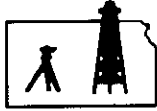

ROBINSON SERVICES
Oil Field & Construction Staking
P.O. Box 2324
Garden City, Kansas 67846
Office/Fax: (620) 276-6159
Cell: (620) 272-1499

6264
INVOICE NO.

CORRECTED

002006-C
FLAT NO.

Ohio Kentucky Oil Corporation
OPERATOR

R. Vreeland #2
LEASE NAME

Trego County, KS.
COUNTY

12
Sec.

11s
Twp.

24w
Rng.

Main Loc. = 1072'FNL - 825'FWL = 2279.0 gr.

Alt. #1 = 1202'FNL - 825'FWL = 2291.9 gr.
Alt. #2 = 851'FNL - 825'FWL = 2279.4 gr.

SCALE: **1" = 1000'**
DATE: **Aug 28th, 2006**
MEASURED BY: **Tom West**
DRAWN BY: **Burt West**
AUTHORIZED BY: **Jim Berkdull**



This drawing is for construction purposes only

Directions: From the Southeast side of Wakeoney, KS. (at the intersections of Hwy 283 North & I-70) - Now go North 7.3 miles on Hwy 283 - Now go 3.6 miles West - Now go South to gate on East side of road - Now go approx. 1670 ft. SE into Main Loc. and also into the South Alt. Loc. through pasture grass (both are on the South side of creek) (North Alt. is on the North side of creek).

