

For KCC Use:  
Effective Date: 10-10-06  
District #: 1  
SGA? ☐ Yes ☒ No

KANSAS CORPORATION COMMISSION  
OIL & GAS CONSERVATION DIVISION  
**NOTICE OF INTENT TO DRILL**

Must be approved by KCC five (5) days prior to commencing well

Form C-1  
December 2002  
Form must be Typed  
Form must be Signed  
All blanks must be Filled

Expected Spud Date: November 2, 2006  
month day year

OPERATOR: License# 5214 ✓  
Name: Lario Oil & Gas Co.  
Address: 301 South Market  
City/State/Zip: Wichita, KS 67202  
Contact Person: Jay G. Schweikert  
Phone: 316-265-5611

CONTRACTOR: License# 5822 ✓  
Name: VAL ENERGY, Inc.

Well Drilled For:	Well Class:	Type Equipment:
<input checked="" type="checkbox"/> Oil	<input type="checkbox"/> Enh Rec	<input checked="" type="checkbox"/> Mud Rotary
<input type="checkbox"/> Gas	<input type="checkbox"/> Storage	<input type="checkbox"/> Air Rotary
<input type="checkbox"/> OWWO	<input type="checkbox"/> Disposal	<input type="checkbox"/> Cable
<input type="checkbox"/> Seismic; # of Holes	<input checked="" type="checkbox"/> Wildcat	
<input type="checkbox"/> Other	<input type="checkbox"/> Other	

If OWWO: old well information as follows:

Operator: \_\_\_\_\_  
Well Name: \_\_\_\_\_  
Original Completion Date: \_\_\_\_\_ Original Total Depth: \_\_\_\_\_

Directional, Deviated or Horizontal wellbore? ☐ Yes ☒ No

If Yes, true vertical depth: \_\_\_\_\_

Bottom Hole Location: \_\_\_\_\_

KCC DKT #: \_\_\_\_\_

\*\*Approx 30N & 75E of

Spot  
E2 W2 NE Sec. 6 Twp. 18 S. R. 30 ☐ East ☒ West  
1290 feet from ☒ N / ☐ S Line of Section  
1575 feet from ☒ E / ☐ W Line of Section

Is SECTION ☒ Regular ☐ Irregular?

(Note: Locate well on the Section Plat on reverse side)

County: Lane

Lease Name: Curran Well #: 1-6

Field Name: Wildcat

Is this a Prorated / Spaced Field? ☐ Yes ☒ No

Target Formation(s): Lansing, Marmaton & Cherokee

Nearest Lease or unit boundary: 1290

Ground Surface Elevation: 2890' est feet MSL

Water well within one-quarter mile: ☐ Yes ☒ No

Public water supply well within one mile: ☐ Yes ☒ No

Depth to bottom of fresh water: 140

Depth to bottom of usable water: 1500

Surface Pipe by Alternate: ☐ 1 ☒ 2

Length of Surface Pipe Planned to be set: 300'

Length of Conductor Pipe required: None

Projected Total Depth: 4700 ft.

Formation at Total Depth: Mississippian

Water Source for Drilling Operations:

☐ Well ☐ Farm Pond ☒ Other X

DWR Permit #: \_\_\_\_\_

(Note: Apply for Permit with DWR ☒)

Will Cores be taken? ☐ Yes ☒ No

If Yes, proposed zone: \_\_\_\_\_

**AFFIDAVIT**

The undersigned hereby affirms that the drilling, completion and eventual plugging of this well will comply with K.S.A. 55 et. seq.

It is agreed that the following minimum requirements will be met:

1. Notify the appropriate district office **prior** to spudding of well;
2. A copy of the approved notice of intent to drill **shall be posted** on each drilling rig;
3. The minimum amount of surface pipe as specified below **shall be set** by circulating cement to the top; in all cases surface pipe **shall be set** through all unconsolidated materials plus a minimum of 20 feet into the underlying formation.
4. If the well is dry hole, an agreement between the operator and the district office on plug length and placement is necessary **prior to plugging**;
5. The appropriate district office will be notified before well is either plugged or production casing is cemented in;
6. If an ALTERNATE II COMPLETION, production pipe shall be cemented from below any usable water to surface within **120 days** of spud date.  
Or pursuant to Appendix "B" - Eastern Kansas surface casing order #133,891-C, which applies to the KCC District 3 area, alternate II cementing must be completed within 30 days of the spud date or the well shall be plugged. **In all cases, NOTIFY district office** prior to any cementing.

I hereby certify that the statements made herein are true and to the best of my knowledge and belief.

Date: 10/3/06 Signature of Operator or Agent: Jay G. Schweikert Title: Operations Engineer

Jay G. Schweikert  
Remember to:

- File Drill Pit Application (form CDP-1) with Intent to Drill;
- File Completion Form ACO-1 within 120 days of spud date;
- File acreage attribution plat according to field proration orders;
- Notify appropriate district office 48 hours prior to workover or re-entry;
- Submit plugging report (CP-4) after plugging is completed;
- Obtain written approval before disposing or injecting salt water.

- If this permit has expired (See: authorized expiration date) please check the box below and return to the address below.

☐ Well Not Drilled - Permit Expired

Signature of Operator or Agent: \_\_\_\_\_

Date: \_\_\_\_\_

**For KCC Use ONLY**

API # 15 - 101-21972-0000

Conductor pipe required None feet

Minimum surface pipe required 200 feet per Alt. X(2)

Approved by: 10-5-06

This authorization expires: 4-5-07

(This authorization void if drilling not started within 6 months of effective date.)

Spud date: \_\_\_\_\_ Agent: \_\_\_\_\_

Mail to: KCC - Conservation Division, 130 S. Market - Room 2078, Wichita, Kansas 67202

RECEIVED

OCT - 4 2006

KCC WICHITA

**IN ALL CASES PLOT THE INTENDED WELL ON THE PLAT BELOW***Plat of acreage attributable to a well in a prorated or spaced field*

If the intended well is in a prorated or spaced field, please fully complete this side of the form. If the intended well is in a prorated or spaced field complete the plat below showing that the well will be properly located in relationship to other wells producing from the common source of supply. Please show all the wells and within 1 mile of the boundaries of the proposed acreage attribution unit for gas wells and within 1/2 mile of the boundaries of the proposed acreage attribution unit for oil wells.

API No. 15 - 101-21972-000  
 Operator: Lario Oil & Gas Co.  
 Lease: Curran  
 Well Number: 1-6  
 Field: Wildcat

Number of Acres attributable to well: 40  
 QTR / QTR / QTR of acreage: E2 - W2 - NE  
 Approx. 150' S of

Location of Well: County: \_\_\_\_\_ Lane \_\_\_\_\_  
1290 feet from ☒ N / ☐ S Line of Section  
1575 feet from ☒ E / ☐ W Line of Section  
 Sec. 6 Twp. 18 S. R. 30 ☐ East ☒ West

Is Section: ☒ Regular or ☐ Irregular

If Section is Irregular, locate well from nearest corner boundary.

Section corner used: ☐ NE ☐ NW ☐ SE ☐ SW

**PLAT**

(Show location of the well and shade attributable acreage for prorated or spaced wells.)

(Show footage to the nearest lease or unit boundary line.)

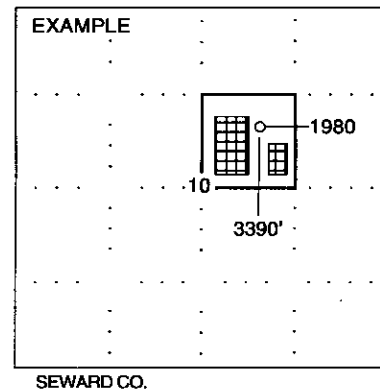
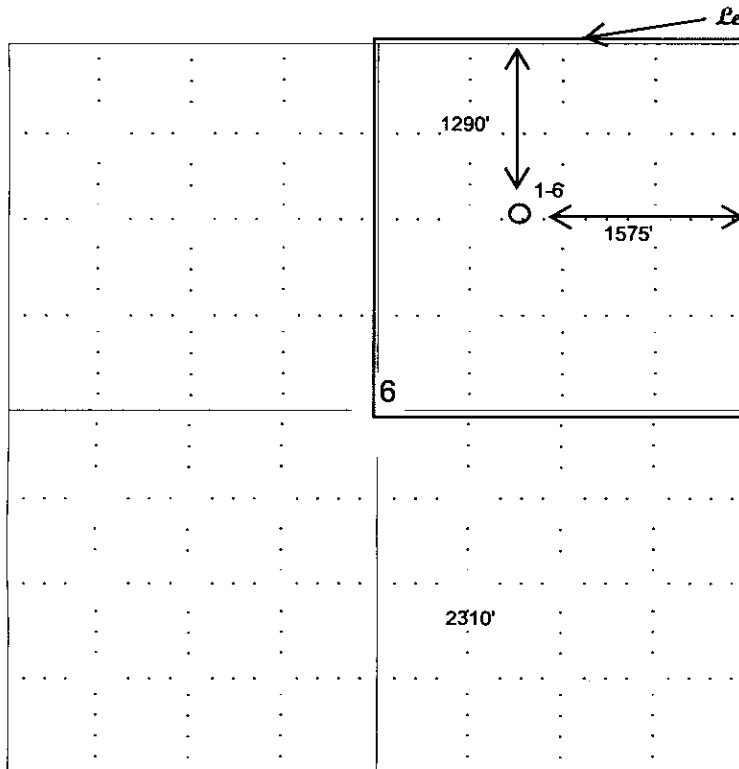

**NOTE: In all cases locate the spot of the proposed drilling location.**

**In plotting the proposed location of the well, you must show:**

1. The manner in which you are using the depicted plat by identifying section lines, i.e. 1 section, 1 section with 8 surrounding sections, 4 sections, etc.
2. The distance of the proposed drilling location from the section's south / north and east / west.
3. The distance to the nearest lease or unit boundary line.
4. If proposed location is located within a prorated or spaced field a certificate of acreage attribution plat must be attached: (C0-7 for oil wells; CG-8 for gas wells).

**KANSAS CORPORATION COMMISSION  
OIL & GAS CONSERVATION DIVISION  
APPLICATION FOR SURFACE PIT**

Form CDP-1  
April 2004  
Form must be Typed

*Submit in Duplicate*

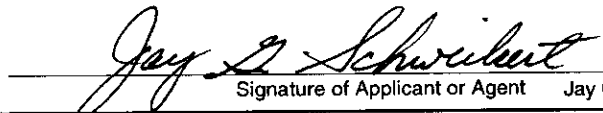
Operator Name: <b>Lario Oil &amp; Gas Company</b>		License Number: <b>5214</b>
Operator Address: <b>301 South Market Wichita, KS 67202</b>		
Contact Person: <b>Jay G. Schweikert</b>		Phone Number: ( <b>316</b> ) <b>265 - 5611</b>
Lease Name & Well No.: <b>Curran #1-6</b>		Pit Location (QQQQ): <b>Approx. 30N &amp; 75E of</b> <b>E2 - W2 - NE</b> Sec. <b>6</b> Twp. <b>18</b> R. <b>30</b> <input type="checkbox"/> East <input checked="" type="checkbox"/> West <b>1290</b> Feet from <input checked="" type="checkbox"/> North / <input type="checkbox"/> South Line of Section <b>1575</b> Feet from <input checked="" type="checkbox"/> East / <input type="checkbox"/> West Line of Section <b>Kingman Lane</b> County
Type of Pit: <input type="checkbox"/> Emergency Pit <input type="checkbox"/> Burn Pit <input type="checkbox"/> Settling Pit <input checked="" type="checkbox"/> Drilling Pit <input type="checkbox"/> Workover Pit <input type="checkbox"/> Haul-Off Pit <small>(If WP Supply API No. or Year Drilled)</small>	Pit is: <input checked="" type="checkbox"/> Proposed <input type="checkbox"/> Existing If Existing, date constructed: _____ Pit capacity: <b>7100</b> (bbls)	
Is the pit located in a Sensitive Ground Water Area? <input type="checkbox"/> Yes <input checked="" type="checkbox"/> No		Chloride concentration: _____ mg/l <small>(For Emergency Pits and Settling Pits only)</small>
Is the bottom below ground level? <input checked="" type="checkbox"/> Yes <input type="checkbox"/> No	Artificial Liner? <input type="checkbox"/> Yes <input checked="" type="checkbox"/> No	How is the pit lined if a plastic liner is not used?
Pit dimensions (all but working pits): <b>100</b> Length (feet) <b>100</b> Width (feet) <b>N/A: Steel Pits</b> Depth from ground level to deepest point: <b>4</b> (feet)		
If the pit is lined give a brief description of the liner material, thickness and installation procedure.		Describe procedures for periodic maintenance and determining liner integrity, including any special monitoring.
Distance to nearest water well within one-mile of pit <b>2750</b> feet    Depth of water well <b>137</b> feet		Depth to shallowest fresh water <b>70</b> feet. Source of information: _____ measured <input checked="" type="checkbox"/> well owner    _____ electric log    _____ KDWR
<b>Emergency, Settling and Burn Pits ONLY:</b> Producing Formation: _____ Number of producing wells on lease: _____ Barrels of fluid produced daily: _____ Does the slope from the tank battery allow all spilled fluids to flow into the pit? <input type="checkbox"/> Yes <input type="checkbox"/> No		<b>Drilling, Workover and Haul-Off Pits ONLY:</b> Type of material utilized in drilling/workover: <b>Bentonite Mud</b> Number of working pits to be utilized: <b>2</b> Abandonment procedure: <b>Allow for evaporation.</b> <b>Fill in &amp; cover pits.</b> Drill pits must be closed within 365 days of spud date.
I hereby certify that the above statements are true and correct to the best of my knowledge and belief.  <div style="display: flex; justify-content: space-between;"><div><b>10/3/06</b> Date</div><div> Signature of Applicant or Agent    Jay G. Schweikert</div></div>		

KCC OFFICE USE ONLY			
Date Received: <b>10/4/06</b>	Permit Number: _____	Permit Date: <b>10/4/06</b>	Lease Inspection: <input type="checkbox"/> Yes <input checked="" type="checkbox"/> No

Mail to: KCC - Conservation Division, 130 S. Market - Room 2078, Wichita, Kansas 67202

**RECEIVED**  
**OCT - 4 2006**  
**KCC WICHITA**

15-101-21972-0000