

For KCC Use: 10-11-06
 Effective Date: _____
 District # 3
 SGA? Yes No

KANSAS CORPORATION COMMISSION
 OIL & GAS CONSERVATION DIVISION

Form C-1
 December 2002
 Form must be Typed
 Form must be Signed
 All blanks must be Filled

NOTICE OF INTENT TO DRILL
 Must be approved by KCC five (5) days prior to commencing well

Expected Spud Date October 12, 2006
 month day year

Spot N 2 S 2 NE *per operator*
 NW SE NE Sec. 32 Twp. 31 S. R. 18
 East
 West
1320 3630 feet from N / S Line of Section
3630 1320 feet from E / W Line of Section
 Is SECTION Regular Irregular?

OPERATOR: License# 9313
 Name: James D. Lorenz
 Address: 543A 22000 Road
 City/State/Zip: Cherryvale, Kansas 67335-8515
 Contact Person: James D. Lorenz
 Phone: 620-328-4433

(Note: Locate well on the Section Plat on reverse side)
 County: Labette
 Lease Name: Lorenz Well #: 22
 Field Name: Dartnell

CONTRACTOR: License# 33374
 Name: L & S Well Service, LLC

Is this a Prorated / Spaced Field? Yes No
 Target Formation(s): Wildcat
 Nearest Lease or unit boundary: 330'

Well Drilled For:	Well Class:	Type Equipment:
<input checked="" type="checkbox"/> Oil <input checked="" type="checkbox"/> Gas	<input type="checkbox"/> Enh Rec <input type="checkbox"/> Storage	<input type="checkbox"/> Mud Rotary <input checked="" type="checkbox"/> Air Rotary
<input type="checkbox"/> OWWO <input type="checkbox"/> Seismic; # of Holes _____	<input type="checkbox"/> Disposal <input type="checkbox"/> Wildcat <input type="checkbox"/> Other _____	<input type="checkbox"/> Cable
<input type="checkbox"/> Other _____		

Ground Surface Elevation: _____ feet MSL
 Water well within one-quarter mile: Yes No
 Public water supply well within one mile: Yes No

If OWWO: old well information as follows:
 Operator: _____
 Well Name: _____
 Original Completion Date: _____ Original Total Depth: _____

Depth to bottom of fresh water: 100+
 Depth to bottom of usable water: 200+
 Surface Pipe by Alternate: 1 2

Directional, Deviated or Horizontal wellbore? Yes No

Length of Surface Pipe Planned to be set: 20' of 8 5/8"
 Length of Conductor Pipe required: none
 Projected Total Depth: 1000'

Bottom Hole Location: _____
 KCC DKT #: _____

Formation at Total Depth: Mississippi
 Water Source for Drilling Operations:
 Well Farm Pond Other XX

DWR Permit #: _____
 (Note: Apply for Permit with DWR)
 Will Cores be taken? Yes No
 If Yes, proposed zone: _____

AFFIDAVIT

The undersigned hereby affirms that the drilling, completion and eventual plugging of this well will comply with K.S.A. 55 et. seq.
 It is agreed that the following minimum requirements will be met:

1. Notify the appropriate district office **prior** to spudding of well;
2. A copy of the approved notice of intent to drill **shall be** posted on each drilling rig;
3. The minimum amount of surface pipe as specified below **shall be set** by circulating cement to the top; in all cases surface pipe **shall be set** through all unconsolidated materials plus a minimum of 20 feet into the underlying formation.
4. If the well is dry hole, an agreement between the operator and the district office on plug length and placement is necessary **prior to plugging**;
5. The appropriate district office will be notified before well is either plugged or production casing is cemented in;
6. If an ALTERNATE II COMPLETION, production pipe shall be cemented from below any usable water to surface within **120 days** of spud date. Or pursuant to Appendix "B" - Eastern Kansas surface casing order #133,891-C, which applies to the KCC District 3 area, alternate II cementing must be completed within 30 days of the spud date or the well shall be plugged. **In all cases, NOTIFY district office** prior to any cementing.

I hereby certify that the statements made herein are true and to the best of my knowledge and belief.

Date: 10-3-06 Signature of Operator or Agent: James D. Lorenz Title: Agent

For KCC Use ONLY
 API # 15 - 099-24121-0000
 Conductor pipe required None feet
 Minimum surface pipe required 20 feet per Alt. **XO 2**
 Approved by: Per 10-6-06
 This authorization expires: 4-6-07
 (This authorization void if drilling not started within 6 months of approval date.)
 Spud date: _____ Agent: _____

Remember to:
 - File Drill Pit Application (form CDP-1) with Intent to Drill;
 - File Completion Form ACO-1 within 120 days of spud date;
 - File acreage attribution plat according to field proration orders;
 - Notify appropriate district office 48 hours prior to workover or re-entry;
 - Submit plugging report (CP-4) after plugging is completed;
 - Obtain written approval before disposing or injecting salt water.
 - If this permit has expired (See: authorized expiration date) please check the box below and return to the address below.
 Well Not Drilled - Permit Expired
 Signature of Operator or Agent: _____
 Date: _____

Mail to: KCC - Conservation Division, 130 S. Market - Room 2078, Wichita, Kansas 67202

RECEIVED
 OCT - 5 2006
 KCC WICHITA

IN ALL CASES PLOT THE INTENDED WELL ON THE PLAT BELOW

Plat of acreage attributable to a well in a prorated or spaced field

If the intended well is in a prorated or spaced field, please fully complete this side of the form. If the intended well is in a prorated or spaced field complete the plat below showing that the well will be properly located in relationship to other wells producing from the common source of supply. Please show all the wells and within 1 mile of the boundaries of the proposed acreage attribution unit for gas wells and within 1/2 mile of the boundaries of the proposed acreage attribution unit for oil wells.

API No. 15 - 099-24121-0000
 Operator: James D. Lorenz
 Lease: Lorenz
 Well Number: 22
 Field: Dartnell
 Number of Acres attributable to well: 5
 QTR / QTR / QTR of acreage: NW - SE - NE

Location of Well: County: Labette
 1320' _____ feet from N / S Line of Section
 3630' _____ feet from E / W Line of Section
 Sec. 32 Twp. 31 S. R. 18 East West
 Is Section: Regular or Irregular
 If Section is Irregular, locate well from nearest corner boundary.
 Section corner used: NE NW SE SW

PLAT

(Show location of the well and shade attributable acreage for prorated or spaced wells.)
(Show footage to the nearest lease or unit boundary line.)

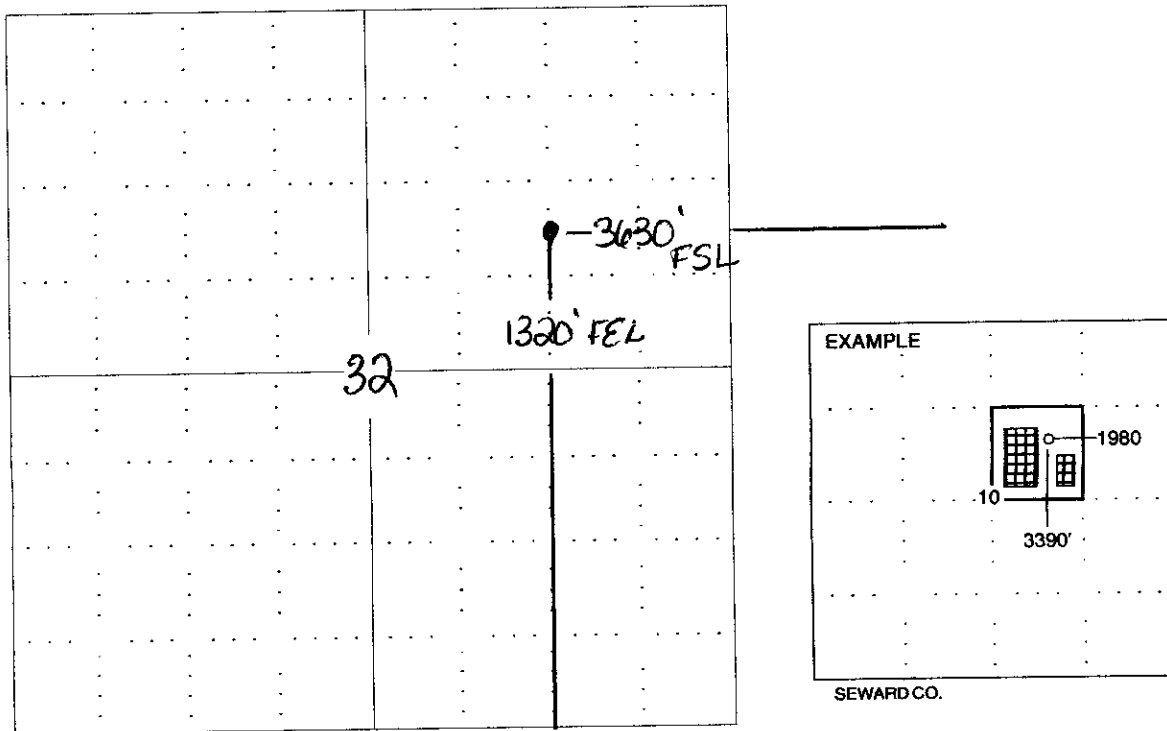

NOTE: In all cases locate the spot of the proposed drilling locaton.

In plotting the proposed location of the well, you must show:

1. The manner in which you are using the depicted plat by identifying section lines, i.e. 1 section, 1 section with 8 surrounding sections, 4 sections, etc.
2. The distance of the proposed drilling location from the section's south / north and east / west.
3. The distance to the nearest lease or unit boundary line.
4. If proposed location is located within a prorated or spaced field a certificate of acreage attribution plat must be attached: (CO-7 for oil wells; CG-8 for gas wells).

RECEIVED
 OCT - 5 2006
 KCC WICHITA

**KANSAS CORPORATION COMMISSION
OIL & GAS CONSERVATION DIVISION
APPLICATION FOR SURFACE PIT**

Form CDP-1
April 2004
Form must be Typed

Submit in Duplicate

Operator Name: James D. Lorenz		License Number: 9313
Operator Address: 543A 22000 Road Cherryvale, Kansas 67335-8515		
Contact Person: James D. Lorenz		Phone Number: (620) 328 - 4433
Lease Name & Well No.: Lorenz #22		Pit Location (QQQQ): NW SE NE
Type of Pit: <input type="checkbox"/> Emergency Pit <input type="checkbox"/> Burn Pit <input type="checkbox"/> Settling Pit <input checked="" type="checkbox"/> Drilling Pit <input type="checkbox"/> Workover Pit <input type="checkbox"/> Haul-Off Pit <small>(If WP Supply API No. or Year Drilled)</small>	Pit is: <input checked="" type="checkbox"/> Proposed <input type="checkbox"/> Existing If Existing, date constructed: 3680 4320' Pit capacity: 1603 (bbls)	Sec. 32 Twp. 31 R. 18 <input checked="" type="checkbox"/> East <input type="checkbox"/> West 4320' Feet from <input type="checkbox"/> North / <input checked="" type="checkbox"/> South Line of Section 3630' Feet from <input checked="" type="checkbox"/> East / <input type="checkbox"/> West Line of Section Labette County
Is the pit located in a Sensitive Ground Water Area? <input type="checkbox"/> Yes <input checked="" type="checkbox"/> No		Chloride concentration: _____ mg/l <small>(For Emergency Pits and Settling Pits only)</small>
Is the bottom below ground level? <input checked="" type="checkbox"/> Yes <input type="checkbox"/> No	Artificial Liner? <input type="checkbox"/> Yes <input checked="" type="checkbox"/> No	How is the pit lined if a plastic liner is not used? Native Mud
Pit dimensions (all but working pits): 30 Length (feet) 30 Width (feet) N/A: Steel Pits Depth from ground level to deepest point: 10 (feet)		
If the pit is lined give a brief description of the liner material, thickness and installation procedure.		Describe procedures for periodic maintenance and determining liner integrity, including any special monitoring. If rain has entered the pit, it will be pumped out and taken to the disposal well
Distance to nearest water well within one-mile of pit _____ feet Depth of water well _____ feet		Depth to shallowest fresh water _____ feet. Source of information: _____ _____ measured _____ well owner _____ electric log _____ KDWR
Emergency, Settling and Burn Pits ONLY: Producing Formation: _____ Number of producing wells on lease: _____ Barrels of fluid produced daily: _____ Does the slope from the tank battery allow all spilled fluids to flow into the pit? <input type="checkbox"/> Yes <input type="checkbox"/> No		Drilling, Workover and Haul-Off Pits ONLY: Type of material utilized in drilling/workover: fresh Number of working pits to be utilized: 1 Abandonment procedure: air dry and backfill Drill pits must be closed within 365 days of spud date.
I hereby certify that the above statements are true and correct to the best of my knowledge and belief.		
_____ Date		<i>James D. Lorenz</i> Signature of Applicant or Agent

KCC OFFICE USE ONLY

Date Received: **10/3/06** Permit Number: _____ Permit Date: **11/5/06** Lease Inspection: Yes No

Mail to: KCC - Conservation Division, 130 S. Market - Room 2078, Wichita, Kansas 67202

RECEIVED
OCT - 5 2006
KCC WICHITA

15-099 - 2421-0000