

For KCC Use: 10-11-06
Effective Date: 3
District # 3
SGA? ☐ Yes ☒ No

KANSAS CORPORATION COMMISSION
OIL & GAS CONSERVATION DIVISION

RECEIVED

KANSAS CORPORATION COMMISSION

Form C-1

December 2002

Form must be Typed

Form must be Signed

All blanks must be Filled

Ft. Scott

NOTICE OF INTENT TO DRILL

Must be approved by KCC five (5) days prior to commencing well

CONSERVATION DIVISION
WICHITA, KS

Expected Spud Date 10/10/06
month day year

OPERATOR: License# 33397
Name: Running Foxes Petroleum, Inc.
Address: 7060B Tucson Way
City/State/Zip: Centennial, CO 80112
Contact Person: Carol Sears
Phone: 303-327-7016

CONTRACTOR: License# 5786
Name: McGowan Drilling

Well Drilled For: ☐ Oil ☒ Gas ☐ OWWO ☐ Seismic; # of Holes ☐ Other
Well Class: ☐ Enh Rec ☐ Storage ☐ Disposal ☐ Other
Type Equipment: ☒ Mud Rotary ☐ Air Rotary ☐ Cable

If OWWO: old well information as follows:

Operator: _____
Well Name: _____
Original Completion Date: _____ Original Total Depth: _____

Directional, Deviated or Horizontal wellbore? ☐ Yes ☒ No

If Yes, true vertical depth: _____

Bottom Hole Location: _____

KCC DKT #: _____

Spot NE - SE - NW Sec. 30 Twp. 24 S. R. 24
1940 feet from N / S Line of Section
2055 feet from E / W Line of Section
Is SECTION ☒ Regular ☐ Irregular?

(Note: Locate well on the Section Plat on reverse side)

County: Bourbon
Lease Name: Yeager Well #: 6-30
Field Name: Wildcat

Is this a Prorated / Spaced Field? ☐ Yes ☒ No

Target Formation(s): Riverton

Nearest Lease or unit boundary: 585 feet

Ground Surface Elevation: 887 feet MSL

Water well within one-quarter mile: ☐ Yes ☒ No

Public water supply well within one mile: ☐ Yes ☒ No

Depth to bottom of fresh water: 100+

Depth to bottom of usable water: 200 feet

Surface Pipe by Alternate: ☐ 1 ☒ 2

Length of Surface Pipe Planned to be set: 20 feet

Length of Conductor Pipe required: None

Projected Total Depth: 750 feet

Formation at Total Depth: Mississippian

Water Source for Drilling Operations: ☐ Well ☐ Farm Pond ☒ Other Municipality

DWR Permit #: _____

(Note: Apply for Permit with DWR ☐)

Will Cores be taken? ☐ Yes ☒ No

If Yes, proposed zone: _____

AFFIDAVIT

RECEIVED
KANSAS CORPORATION COMMISSION

The undersigned hereby affirms that the drilling, completion and eventual plugging of this well will comply with K.S.A. 55 et. seq. OCT 02 2006

It is agreed that the following minimum requirements will be met:

1. Notify the appropriate district office prior to spudding of well;
2. A copy of the approved notice of intent to drill shall be posted on each drilling rig;
3. The minimum amount of surface pipe as specified below shall be set by circulating cement to the top; in all cases surface pipe shall be set through all unconsolidated materials plus a minimum of 20 feet into the underlying formation.
4. If the well is dry hole, an agreement between the operator and the district office on plug length and placement is necessary prior to plugging;
5. The appropriate district office will be notified before well is either plugged or production casing is cemented in;
6. If an ALTERNATE II COMPLETION, production pipe shall be cemented from below any usable water to surface within 120 days of spud date. Or pursuant to Appendix "B" - Eastern Kansas surface casing order #133,891-C, which applies to the KCC District 3 area, alternate II cementing must be completed within 30 days of the spud date or the well shall be plugged. In all cases, NOTIFY district office prior to any cementing.

I hereby certify that the statements made herein are true and to the best of my knowledge and belief.

Date: 9/29/06 Signature of Operator or Agent: Carol A. Sears Title: Land Manager

For KCC Use ONLY

API # 15 - 011-23218-0000

Conductor pipe required None feet

Minimum surface pipe required 20 feet per Alt. X 2

Approved by: 10-6-06

This authorization expires: 4-6-07

(This authorization void if drilling not started within 6 months of approval date.)

Spud date: _____ Agent: _____

Remember to:

- File Drill Pit Application (form CDP-1) with Intent to Drill;
- File Completion Form ACO-1 within 120 days of spud date;
- File acreage attribution plat according to field proration orders;
- Notify appropriate district office 48 hours prior to workover or re-entry;
- Submit plugging report (CP-4) after plugging is completed;
- Obtain written approval before disposing or injecting salt water.

- If this permit has expired (See: authorized expiration date) please check the box below and return to the address below.

☐ Well Not Drilled - Permit Expired

Signature of Operator or Agent: _____

Date: _____

Mail to: KCC - Conservation Division, 130 S. Market - Room 2078, Wichita, Kansas 67202

30 24 24E

IN ALL CASES PLOT THE INTENDED WELL ON THE PLAT BELOW*Plat of acreage attributable to a well in a prorated or spaced field*

Ft. Scott

If the intended well is in a prorated or spaced field, please fully complete this side of the form. If the intended well is in a prorated or spaced field complete the plat below showing that the well will be properly located in relationship to other wells producing from the common source of supply. Please show all the wells and within 1 mile of the boundaries of the proposed acreage attribution unit for gas wells and within 1/2 mile of the boundaries of the proposed acreage attribution unit for oil wells.

API No. 15 - 011-2328-0000
 Operator: Running Foxes Petroleum, Inc.
 Lease: Yeager
 Well Number: 6-30
 Field: Wildcat

Number of Acres attributable to well: _____
 QTR / QTR / QTR of acreage: NE - SE - NW

Location of Well: County: Bourbon
 _____ 1940 _____ feet from ☒ N / ☐ S Line of Section
 _____ 2055 _____ feet from ☐ E / ☒ W Line of Section
 Sec. 30 Twp. 24 S. R. 24 ☒ East ☐ West

Is Section: ☒ Regular or ☐ Irregular

If Section is Irregular, locate well from nearest corner boundary.

Section corner used: ☐ NE ☐ NW ☐ SE ☐ SW

PLAT

(Show location of the well and shade attributable acreage for prorated or spaced wells.)
 (Show footage to the nearest lease or unit boundary line.)

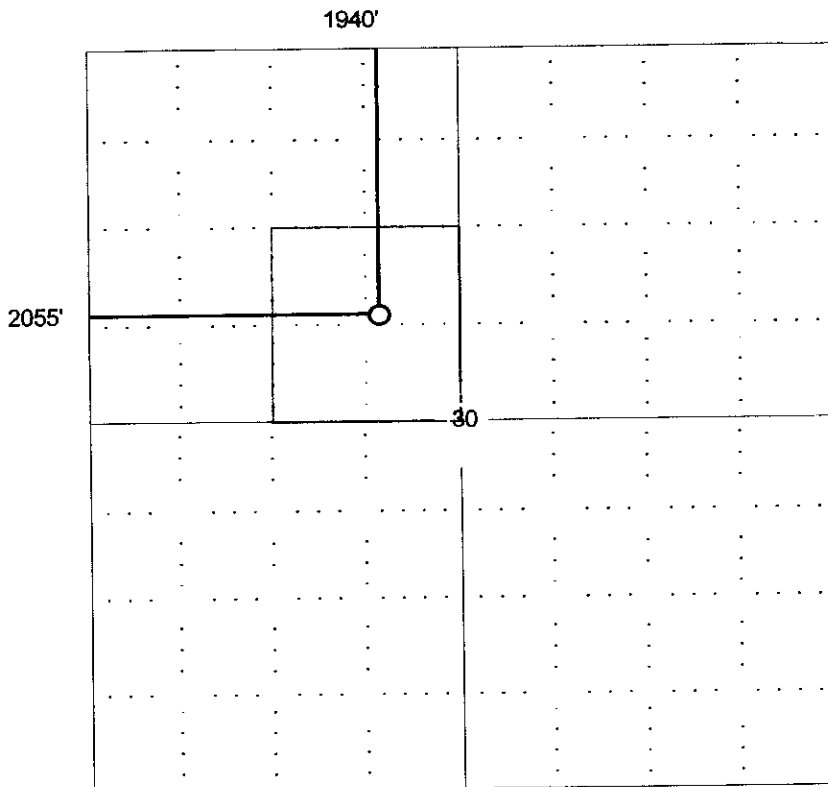

NOTE: In all cases locate the spot of the proposed drilling location.

RECEIVED
KANSAS CORPORATION COMMISSION

OCT 06 2006

CONSERVATION DIVISION
WICHITA, KS

RECEIVED
KANSAS CORPORATION COMMISSION

OCT 02 2006

CONSERVATION DIVISION
WICHITA, KS

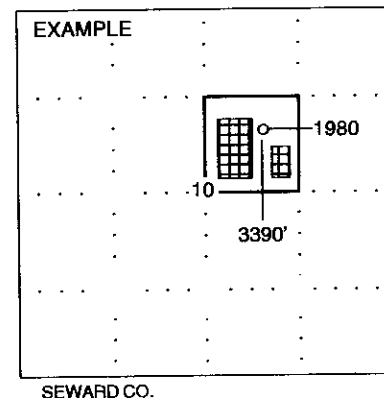

In plotting the proposed location of the well, you must show:

1. The manner in which you are using the depicted plat by identifying section lines, i.e. 1 section, 1 section with 8 surrounding sections, 4 sections, etc.
2. The distance of the proposed drilling location from the section's south / north and east / west.
3. The distance to the nearest lease or unit boundary line.
4. If proposed location is located within a prorated or spaced field a certificate of acreage attribution plat must be attached: (CO-7 for oil wells; CG-8 for gas wells).

RECEIVED
KANSAS CORPORATION COMMISSION
OIL & GAS CONSERVATION DIVISION
OCT 06 2006
APPLICATION FOR SURFACE PIT
CONSERVATION DIVISION
WICHITA, KS

Form CDP-1

April 2004

Form must be Typed

Ft. Scott

Submit in Duplicate

Operator Name: Running Foxes Petroleum, Inc.		License Number: 33397
Operator Address: 7060B Tucson Way, Centennial, CO 80112		
Contact Person: Carol A. Sears		Phone Number: (303) 327 - 7016
Lease Name & Well No.: Yeager #6-30		Pit Location (QQQQ): SW . NE . SE . NW ✓ Sec. 30 Twp. 24 R. 24 ✓ East <input type="checkbox"/> West 1940 Feet from <input checked="" type="checkbox"/> North / <input type="checkbox"/> South Line of Section 2055 Feet from <input type="checkbox"/> East / <input checked="" type="checkbox"/> West Line of Section Bourbon County
Type of Pit: <input type="checkbox"/> Emergency Pit <input type="checkbox"/> Burn Pit <input type="checkbox"/> Settling Pit <input checked="" type="checkbox"/> Drilling Pit <input type="checkbox"/> Workover Pit <input type="checkbox"/> Haul-Off Pit <small>(If WP Supply API No. or Year Drilled)</small>	Pit is: <input checked="" type="checkbox"/> Proposed <input type="checkbox"/> Existing If Existing, date constructed: _____ Pit capacity: _____ (bbls)	
Is the pit located in a Sensitive Ground Water Area? <input type="checkbox"/> Yes <input checked="" type="checkbox"/> No		Chloride concentration: _____ mg/l <small>(For Emergency Pits and Settling Pits only)</small>
Is the bottom below ground level? <input type="checkbox"/> Yes <input type="checkbox"/> No	Artificial Liner? <input type="checkbox"/> Yes <input type="checkbox"/> No	How is the pit lined if a plastic liner is not used?
Pit dimensions (all but working pits): 20' Length (feet) 20' Width (feet) N/A: Steel Pits Depth from ground level to deepest point: 5 (feet)		
If the pit is lined give a brief description of the liner material, thickness and installation procedure.		Describe procedures for periodic maintenance and determining liner integrity, including any special monitoring.
Distance to nearest water well within one-mile of pit _____ feet Depth of water well _____ feet		Depth to shallowest fresh water _____ feet. Source of information: _____ measured _____ well owner _____ electric log _____ KDWR
Emergency, Settling and Burn Pits ONLY: Producing Formation: _____ Number of producing wells on lease: _____ Barrels of fluid produced daily: _____ Does the slope from the tank battery allow all spilled fluids to flow into the pit? <input type="checkbox"/> Yes <input type="checkbox"/> No		Drilling, Workover and Haul-Off Pits ONLY: Type of material utilized in drilling/workover: Fresh water + native mud Number of working pits to be utilized: 2 Abandonment procedure: Evaporation + back fill Drill pits must be closed within 365 days of spud date.
I hereby certify that the above statements are true and correct to the best of my knowledge and belief. <div style="display: flex; justify-content: space-between;"><div style="text-align: center;">09/29/06 Date</div><div style="text-align: center;"> Signature of Applicant or Agent</div></div>		

KCC OFFICE USE ONLY

Date Received: 10/6/06 Permit Number: _____ Permit Date: 10/6/06 Lease Inspection: ☐ Yes ☒ No

Mail to: KCC - Conservation Division, 130 S. Market - Room 2078, Wichita, Kansas 67202