

For KCC Use:
Effective Date: 10-17-06
District # 1
SGA? Yes No

**KANSAS CORPORATION COMMISSION
OIL & GAS CONSERVATION DIVISION
NOTICE OF INTENT TO DRILL**

OWWO

Form C-1

December 2002

Form must be Typed
Form must be signed

All blanks must be Filled

Must be approved by KCC five (5) days prior to commencing well

Expected Spud Date 10/23/06
month day year

Spot: NW - SE - NW Sec. 21 Twp. 34S R. 33 East West

OPERATOR: License # 5447 ✓

1844 feet from N / S Line of Section

Name: OXY USA Inc.

1974 feet from E / W Line of Section

Address: P.O. Box 2528

Is SECTION X Regular _____ Irregular _____

City/State/Zip: Liberal, KS 67905

(Note: Locate well on the Section Plat on reverse side)

Contact Person: Vicki Carder

County: Seward

Phone: (620) 629-4242

Lease Name: Bruns Well #: 1

CONTRACTOR: License # 30606 ✓

Field Name: Salley

Name: Murfin Drilling Co., Inc.

Is this a Prorated / Spaced Field? Yes No

Well Drilled For: Well Class: Type Equipment:

Oil Gas Enh Rec Storage Infield Pool Ext Mud Rotary Air Rotary OWWO Disposal Wildcat Cable Seismic: _____ # of Holes Other _____

Target Formation(s): St. Louis

Nearest Lease or unit Boundary: 1844

Ground Surface Elevation: 2845' feet MSL

Water well within one-quarter mile Yes No

Public water supply well within one mile: Yes No

Depth to bottom of fresh water: 660

Depth to bottom of usable water: 660

Surface Pipe by Alternate: 1 2

If OWWO: old well information as follows:

Length of Surface Pipe Planned to be set: 8 5/8", 24# set @ 1566' ✓

Operator: Leben Oil Corporation

Length of Conductor Pipe Required: _____

Well Name: Bruns 1 (API - 15-175-20150)

Projected Total Depth: 6201 ✓

Original Completion Date: 06/30/71 Original Total Depth: 6600'

Formation at Total Depth: St. Louis ✓

Directional, Deviated or Horizontal wellbore? Yes No

Water Source for Drilling Operations:

IF Yes, true vertical depth _____

Well Farm Pond Other _____

Bottom Hole Location _____

DWR Permit # _____

KCC DKT #: _____

(Note: Apply for Permit with DWR)

Prorated & Spaced Hubston

Will Cores be Taken? Yes No

If Yes, Proposed zone: _____

AFFIDAVIT

The undersigned hereby affirms that the drilling, completion and eventual plugging of this well will comply with K.S.A. 55-101, et. Seq. It is agreed that the following minimum requirements will be met:

1. Notify the appropriate district office **prior** to spudding of well;
2. A copy of the approved notice of intent to drill **shall be** posted on each drilling rig;
3. The minimum amount of surface pipe as specified below **shall be set** by circulating cement to the top; in all cases surface pipe **shall be set** through all unconsolidated materials plus a minimum of 20 feet into the underlying formation.
4. If the well is dry hole, an agreement between the operator and the district office on plug length and placement is necessary **prior to plugging**;
5. The appropriate district office will be notified before well is either plugged or production casing is cemented in;
6. If an ALTERNATE II COMPLETION, production pipe shall be cemented from below any usable water to surface within **120 days** of spud date. Or pursuant to Appendix "B" - Eastern Kansas surface casing order #133,891-C, which applies to the KCC District 3 area, alternate II cementing must be completed within 30 days of the spud date or the well shall be plugged. **In all cases, NOTIFY district office** prior to any cementing.

I hereby certify that the statements made herein are true and to the best of my knowledge and belief.

Date: 10/04/06 Signature of Operator or Agent: Vicki Carder Title: Capital Project

For KCC Use ONLY

API # 15 - 15-175-20150-00-01

Conductor pipe required None feet

Minimum Surface pipe required 1566' feet per Alt. 1 ✓

Approved by: 10-12-06

This authorization expires: 4-12-07

(This authorization void if drilling not started within 6 months of effective date.)

Spud date: _____ Agent: _____

Remember to:

- File Drill Pit Application (form CDP-1) with Intent to Drill;
- File Completion Form ACO-1 within 120 days of spud date;
- File acreage attribution plat according to field proration orders;
- Notify appropriate district office 48 hours prior to workover or re-entry;
- Submit plugging report (CP-4) after plugging is completed;
- Obtain written approval before disposing or injecting salt water.
- If this permit has expired (see: authorized expiration date) please check the box below and return to the address below.

Well Not Drilled - Permit Expired

Signature of Operator or Agent: _____

Date: _____ **RECEIVED**

Mail to: KCC - Conservation Division, 130 S. Market - Room 2078, Wichita, Kansas 67202

OCT 10 2006

KCC WICHITA

21-34-33W

IN ALL CASES PLOT THE INTENDED WELL ON THE PLAT BELOW

Plat of acreage attributable to a well in a prorated or spaced field

If the intended well is in a prorated or spaced field, please fully complete this side of the form. If the intended well is in a prorated or spaced field complete the plat below showing that the well will be properly located in relationship to other wells producing from the common source of supply. Please show all the wells and within 1 mile of the boundaries of the proposed acreage attribution unit for gas wells and within 1/2 mile of the boundaries of the proposed acreage attribution unit for oil wells.

API No. 15 - 175-2015D-00-01
 Operator: _____
 Lease: _____
 Well Number: _____
 Field: _____
 Number of Acres attributable to well: _____
 QTR / QTR / QTR of acreage: _____ - _____ - _____

Location of Well: County _____
 _____ feet from N / S Line of Section
 _____ feet from E / W Line of Section
 Sec. _____ Twp. _____ R. _____ East West
 Is Section Regular or Irregular
 IF Section is Irregular, locate well from nearest corner boundary.
 Section corner used: NE NW SE SW

PLAT

(Show location of the well and shade attributable acreage for prorated or spaced wells.)

(Show footage to the nearest lease or unit boundary line.)

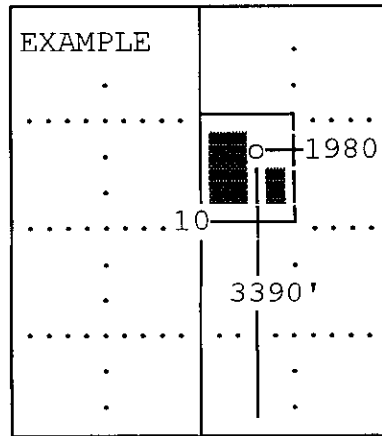
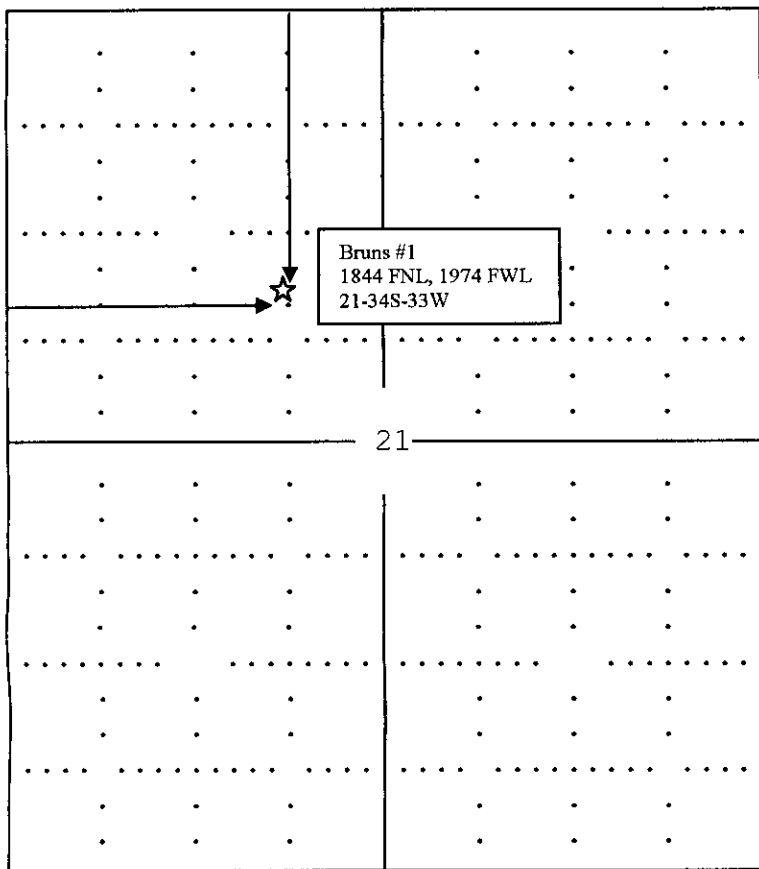

SEWARD CO.

Note: In all cases locate the spot of the proposed drilling location.

Seward County

In plotting the proposed location of the well, you must show:

1. The manner in which you are using the depicted plat by identifying section lines, i.e. 1 section, 1 section with 8 surrounding sections, 4 sections, etc.
2. The distance of the proposed drilling location from the sections south / north and east / west.
3. The distance to the nearest lease or unit boundary line.
4. If proposed location is located within a prorated or spaced field a certificate of acreage attribution plat must be attached: (CO-7 for oil wells; CG-8 for gas wells).

KANSAS CORPORATION COMMISSION
OIL & GAS CONSERVATION DIVISION
APPLICATION FOR SURFACE PIT

Form CDP-1
April 2004
Form must be Typed

Submit in Duplicate

Operator Name: OXY USA Inc.		License Number: 5447
Operator Address: P. O. Box 2528, Liberal, KS 67901		
Contact Person: Rusty Hanna		Phone Number: (620) 629 - 4200
Lease Name & Well No.: Bruns #1		Pit Location (QQQQ): _____ - <u>NW</u> - <u>SE</u> - <u>NW</u> Sec. <u>21</u> Twp. <u>34S</u> R. <u>33</u> <input type="checkbox"/> East <input checked="" type="checkbox"/> West <u>1844</u> Feet from <input checked="" type="checkbox"/> North / <input type="checkbox"/> South Line of Section <u>1974</u> Feet from <input type="checkbox"/> East / <input checked="" type="checkbox"/> West Line of Section <u>Seward</u> County
Type of Pit: <input type="checkbox"/> Emergency Pit <input type="checkbox"/> Burn Pit <input type="checkbox"/> Settling Pit <input checked="" type="checkbox"/> Drilling Pit <input type="checkbox"/> Workover Pit <input type="checkbox"/> Haul-Off Pit <small>(If WF Supply API No. or Year Drilled)</small>	Pit is: <input checked="" type="checkbox"/> Proposed <input type="checkbox"/> Existing If Existing, date constructed: _____ Pit capacity: <u>16000</u> (bbls)	
Is the pit located in a Sensitive Ground Water Area? <input type="checkbox"/> Yes <input checked="" type="checkbox"/> No		Chloride concentration: _____ mg/l <small>(For Emergency Pits and Settling Pits only)</small>
Is the bottom below ground level? <input checked="" type="checkbox"/> Yes <input type="checkbox"/> No	Artificial Liner? <input type="checkbox"/> Yes <input checked="" type="checkbox"/> No	How is the pit lined if a plastic liner is not used? Bentonite & Cuttings
Pit dimensions (all but working pits): <u>150</u> Length (feet) <u>150</u> Width (feet) _____ N/A: Steel Pits Depth from ground level to deepest point: <u>4</u> (feet)		
If the pit is lined give a brief description of the liner material, thickness and installation procedure.		Describe procedures for periodic maintenance and determining liner integrity, including any special monitoring.
Distance to nearest water well within one-mile of pit <u>3107</u> feet Depth of water well <u>260</u> feet		Depth to shallowest fresh water <u>147</u> feet. Source of information: <u>KH465 (6)</u> _____ measured _____ well owner _____ electric log _____ KDWR
Emergency, Settling and Burn Pits ONLY: Producing Formation: _____ Number of producing wells on lease: _____ Barrels of fluid produced daily: _____ Does the slope from the tank battery allow all spilled fluids to flow into the pit? <input type="checkbox"/> Yes <input type="checkbox"/> No		Drilling, Workover and Haul-Off Pits ONLY: Type of material utilized in drilling/workover: <u>Fresh Water Mud</u> Number of working pits to be utilized: _____ Abandonment procedure: <u>Evaporation and Backfill</u> Drill pits must be closed within 365 days of spud date.
I hereby certify that the above statements are true and correct to the best of my knowledge and belief.		
Date: <u>10/04/06</u>		Signature of Applicant or Agent: <u><i>W. J. Gardner</i></u>

15-175-20150-0001

KCC OFFICE USE ONLY			
Date Received: <u>10/10/06</u>	Permit Number: _____	Permit Date: <u>10/12/06</u>	Lease Inspection: <input type="checkbox"/> Yes <input checked="" type="checkbox"/> No

Mail to: KCC - Conservation Division, 130 S. Market - Room 2078, Wichita, Kansas 67202

RECEIVED
OCT 10 2006
KCC WICHITA

WELL PLUGGING RECORD

15-175-20150-0000

Give All Information Completely
Make Required Affidavit
Mail or Deliver Report to:
Conservation Division
State Corporation Commission
212 No. Market
Wichita, Kansas 67202

NORTH

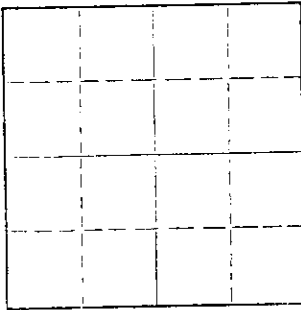

Locate well correctly on above
Section Plat

Seward Co., Kansas County, Sec. 21 Twp. 34S Rge. (E) 33(W)
Location as "NE/CNW/SE" or footage from lines: C SE NW
Lease Owner: Leben Oil Corporation
Lease Name: Bruns Well No. #1
Office Address: 100 Park Ave. Bldg. 333, Oklahoma City, Oklahoma
Character of Well (completed as Oil, Gas or Dry Hole) Dry Hole
Date well completed: June 12 1971
Application for plugging filed: June 12 1971
Application for plugging approved: June 12 1971
Plugging commenced: June 12 1971
Plugging completed: June 12 1971
Reason for abandonment of well or producing formation: Dry Hole

If a producing well is abandoned, date of last production: 19
Was permission obtained from the Conservation Division or its agents before plugging was commenced? Yes

Name of Conservation Agent who supervised plugging of this well: Edgar Eves
Producing formation: Depth to top: Bottom: Total Depth of Well: 6600 Feet
Show depth and thickness of all water, oil and gas formations.

OIL, GAS OR WATER RECORDS

CASING RECORD

FORMATION	CONTENT	FROM	TO	SIZE	PUT IN	PULLED OUT
				8 5/8"	1566	None

Describe in detail the manner in which the well was plugged, indicating where the mud fluid was placed and the method or methods used in introducing it into the hole. If cement or other plugs were used, state the character of same and depth placed, from _____ feet to _____ feet for each plug set.

Filled hole w/mud spotted 35 sks cement @ 1000'
Bridged w/hulls & plug @ 45' w/15 sks cement.

RECEIVED
STATE CORPORATION COMMISSION
JUN 22 1971
CONSERVATION DIVISION
Wichita, Kansas

(If additional description is necessary, use BACK of this sheet)

Name of Plugging Contractor: Leben Drilling, Inc.
Address: 100 Park Avenue Bldg, Suite 333, Oklahoma City, Oklahoma 73102

STATE OF OKLAHOMA COUNTY OF OKLAHOMA, ss.
Leslie Kite (employee of owner) or (owner or operator) of the above-described well, being first duly sworn on oath, says: That I have knowledge of the facts, statements, and matters herein contained and the log of the above-described well as filed and that the same are true and correct. So help me God.

(Signature) Leslie Kite

(Address)

SUBSCRIBED AND SWORN TO before me this 21st day of June, 1971

Shirley A. Thompson
Notary Public.

My commission expires April 29, 1975