

For KCC Use: 10-25-06
 Effective Date: 10-25-06
 District #: 2
 SGA? Yes No

KANSAS CORPORATION COMMISSION
 OIL & GAS CONSERVATION DIVISION

Form C-1
 December 2002
 Form must be Typed
 Form must be Signed
 All blanks must be Filled

NOTICE OF INTENT TO DRILL

Must be approved by the K.C.C. five (5) days prior to commencing well

Expected Spud Date NOVEMBER 21 2006
month day year

60' S & 160' E of CENTER East
NE - SW - SW Sec. 5 Twp. 19 S. R. 10 West
930 feet from N / S Line of Section
1150 feet from E / W Line of Section

OPERATOR: License # 3882 ✓
 Name: SAMUEL GARY JR. & ASSOCIATES, INC.
 Address: 1670 BROADWAY, SUITE 3300
 City/State/Zip: DENVER, CO 80202
 Contact Person: TOM FERTAL
 Phone: (303) 831-4673

Is SECTION x Regular Irregular?
 (Note: Locate well on the Section Plat on Reverse Side)

CONTRACTOR: License 8273 ✓
 Name: EXCELL SERVICES, INC

County: RICE
 Lease Name: MOONEY ET AL Well #: 2-5
 Field Name: WILDCAT

Is this a Prorated / Spaced Field? Yes No
 Target Formation(s): ARBUCKLE
 Nearest Lease or unit boundary: 930'

Ground Surface Elevation: Est. 1755 feet MSL
 Water well within one-quarter mile: Yes No
 Public water supply well within one mile: Yes No

Depth to bottom of fresh water: 150
 Depth to bottom of usable water: 300
 Surface Pipe by Alternate: 1 2

Length of Surface Pipe Planned to be set: 320'
 Length of Conductor pipe required: NONE
 Projected Total Depth: 3500'

Formation at Total Depth: ARBUCKLE
 Water Source for Drilling Operations:
 Well Farm Pond Other X

DWR Permit #: N/A
 (Note: Apply for Permit with DWR)
 Will Cores Be Taken? Yes No
 If yes, proposed zone: N/A

Well Drilled For: Oil Enh Rec Gas OWWO Seismic; # of Holes Other
 Well Class: Infield Pool Ext. Wildcat Other
 Type Equipment: Mud Rotary Air Rotary Cable

If OWWO: old well information as follows:
 Operator: _____
 Well Name: _____
 Original Completion Date: _____ Original Total Depth: _____

Directional, Deviated or Horizontal wellbore? Yes No
 If yes, true vertical depth: _____
 Bottom Hole Location: _____
 KCC DKT#: _____

AFFIDAVIT

The undersigned hereby affirms that the drilling, completion and eventual plugging of this well will comply with K.S.A. 55-101, et. seq. It is agreed that the following minimum requirements will be met:

1. Notify the appropriate district office **prior** to spudding of well;
2. A copy of the approved Notice of Intent to Drill **shall be** posted on each drilling rig;
3. The minimum amount of surface pipe as specified below **shall be set** by circulating cement to the top; in all cases surface pipe **shall be set** through all unconsolidated materials plus a minimum of 20 feet into the underlying formation;
4. If the well is a dry hole, an agreement between the operator and the district office on plug length and placement is necessary **prior to plugging**;
5. The appropriate district office will be notified before well is either plugged or production casing is cemented in;
6. If an ALTERNATE II COMPLETION, production pipe shall be cemented from below any usable water to surface within **120 days** of spud date. Or pursuant to Appendix "B" - Eastern Kansas surface casing order #133,891-C, which applies to the KCC District 3 area, alternate II cementing must be completed within 30 days of spud date or the well shall be plugged. **In all cases, NOTIFY district office** prior to any cementing.

I hereby certify that the statements made herein are true and to the best of my knowledge and belief.

Date: OCTOBER 19, 2006 Signature of Operator or Agent: Thomas J Fertal Title: SR. GEOLOGIST

RECEIVED
 KANSAS CORPORATION COMMISSION
 OCT 20 2006
 CONSERVATION DIVISION
 WICHITA, KS

Remember to:

- File Drill Pit Application (Form CDP-1) with Intent to Drill;
- File Completion Form ACO-1 within 120 days of spud date;
- File acreage attribution plat according to field proration orders;
- Notify appropriate district office 48 hours prior to workover or re-entry;
- Submit plugging report (CP-4) after plugging is completed;
- Obtain written approval before disposing or injecting salt water.

If this permit has expired (See: authorized expiration date) please check the box below and return to the address below.

Well Not Drilled - Permit Expired

Signature of Operator or Agent: _____

Date: _____

5
19
10W

For KCC use ONLY
 API # 15 - 159-22513-0000
 Conductor pipe required None feet
 Minimum surface pipe required 320 feet per Alt. 1
 Approved by: Put 10-20-06
 This authorization expires: 4-20-07
 (This authorization void if drilling not started within 6 months of effective date.)
 Spud date: _____ Agent: _____

IN ALL CASES PLOT THE INTENDED WELL ON THE PLAT BELOW

Plat of Acreage attributable to a well in a prorated or spaced field

If the intended well is in a prorated or spaced field, please fully complete this side of the form. If the intended well is in a prorated or spaced field complete the plat below showing that the well will be properly located in relationship to other wells producing from the common source of supply. Please show all the wells and within 1 mile of the boundaries of the proposed acreage attribution unit for gas wells and within 1/2 mile of the boundaries of the proposed acreage attribution unit for oil wells.

API No. 15 - 159-22513-0000
Operator: SAMUEL GARY JR & ASSOCIATES, INC.
Lease: MOONEY ET AL
Well Number: 2-5
Field:

Location of Well: County: RICE
930 feet from S Line of Section
1150 feet from W Line of Section
Sec. 5 Twp. 19 S. R. 10 East West

Is Section: Regular or Irregular

Number of Acres attributable to well:

QTR / QTR / QTR of acreage:

If Section is Irregular, locate well from nearest corner boundary.

Section corner used: NE NW SE SW

PLAT

(Show location of the well and shade attributable acreage for prorated or spaced wells.)
(Show footage to the nearest lease or unit boundary line.)

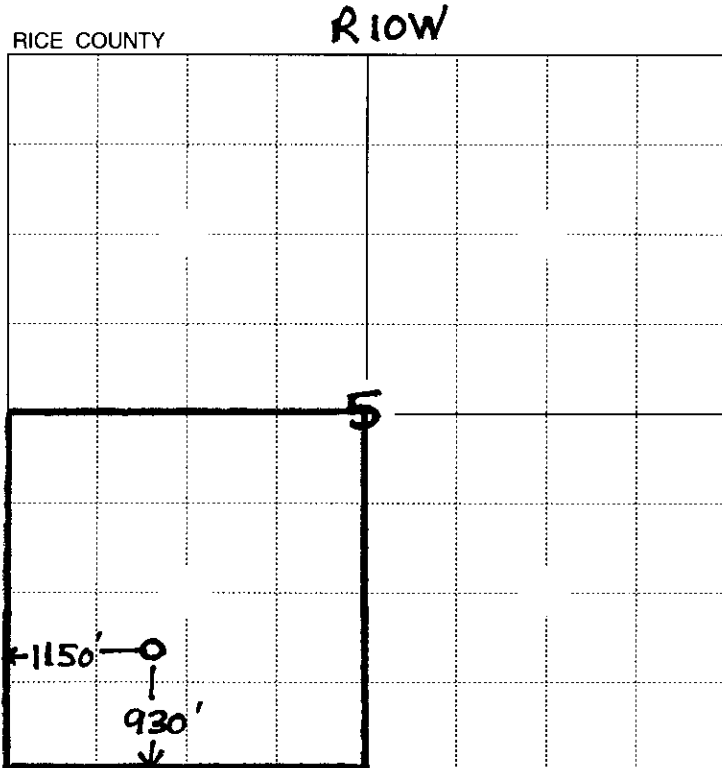

930' from nearest lease boundary

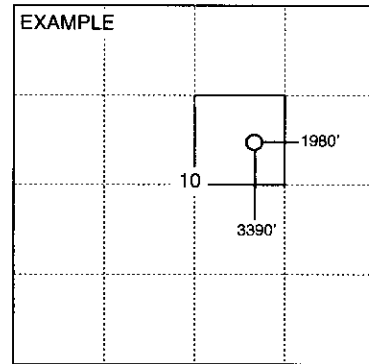

SEWARD CO.

RECEIVED KANSAS CORPORATION COMMISSION

OCT 20 2006

CONSERVATION DIVISION WICHITA, KS

NOTE: In all cases locate the spot of the proposed drilling location.

In plotting the proposed location of the well, you must show:

- 1. The manner in which you are using the depicted plat by identifying section lines, i.e. 1 section, 1 section with 8 surrounding sections, 4 sections, etc.
2. The distance of the proposed drilling location from the section's south / north and east / west.
3. The distance to the nearest lease or unit boundary line.
4. If proposed location is located within a prorated or spaced field a certificate of acreage attribution plat must be attached: (CO-7 for oil wells; CG-8 for gas wells).

**KANSAS CORPORATION COMMISSION
OIL & GAS CONSERVATION DIVISION
APPLICATION FOR SURFACE PIT**

Form CDP-1
April 2004
Form must be Typed

Submit in Duplicate

Operator Name: SAMUEL GARY JR. AND ASSOCIATES, INC.		License Number: 3882
Operator Address: 1670 BROADWAY, SUITE 3300 DENVER, CO 80202-4838		
Contact Person: TOM FERTAL		Phone Number: (303) 831 - 4673
Lease Name & Well No.: MOONEY 2-5		Pit Location (QQQQ): NE SW SW
Type of Pit: <input type="checkbox"/> Emergency Pit <input type="checkbox"/> Burn Pit <input type="checkbox"/> Settling Pit <input checked="" type="checkbox"/> Drilling Pit <input type="checkbox"/> Workover Pit <input type="checkbox"/> Haul-Off Pit <small>(If WP Supply API No. or Year Drilled)</small>	Pit is: <input checked="" type="checkbox"/> Proposed <input type="checkbox"/> Existing If Existing, date constructed: _____ Pit capacity: 4000 (bbls)	Sec. 5 Twp. 19 R. 10 <input type="checkbox"/> East <input checked="" type="checkbox"/> West 930 Feet from <input type="checkbox"/> North / <input checked="" type="checkbox"/> South Line of Section 1150 Feet from <input type="checkbox"/> East / <input checked="" type="checkbox"/> West Line of Section RICE County
Is the pit located in a Sensitive Ground Water Area? <input type="checkbox"/> Yes <input checked="" type="checkbox"/> No		Chloride concentration: _____ mg/l <small>(For Emergency Pits and Settling Pits only)</small>
Is the bottom below ground level? <input checked="" type="checkbox"/> Yes <input type="checkbox"/> No	Artificial Liner? <input type="checkbox"/> Yes <input checked="" type="checkbox"/> No	How is the pit lined if a plastic liner is not used? NATIVE MUD AND CLAY
Pit dimensions (all but working pits): 75 Length (feet) 75 Width (feet) N/A: Steel Pits Depth from ground level to deepest point: 4 (feet)		
If the pit is lined give a brief description of the liner material, thickness and installation procedure.		Describe procedures for periodic maintenance and determining liner integrity, including any special monitoring.
Distance to nearest water well within one-mile of pit 3683 feet Depth of water well 100 feet		Depth to shallowest fresh water 45 feet. Source of information: KHK65 (6) _____ measured _____ well owner _____ electric log _____ KDWR
Emergency, Settling and Burn Pits ONLY: Producing Formation: _____ Number of producing wells on lease: _____ Barrels of fluid produced daily: _____ Does the slope from the tank battery allow all spilled fluids to flow into the pit? <input type="checkbox"/> Yes <input type="checkbox"/> No		Drilling, Workover and Haul-Off Pits ONLY: Type of material utilized in drilling/workover: FRESH MUD Number of working pits to be utilized: 3 Abandonment procedure: ALLOW TO DRY, THEN BACKFILL Drill pits must be closed within 365 days of spud date.
I hereby certify that the above statements are true and correct to the best of my knowledge and belief.		
OCTOBER 19, 2006 Date		<i>Thomas J Fertal</i> Signature of Applicant or Agent

RECEIVED
KANSAS CORPORATION COMMISSION
OCT 20 2006
CONSERVATION DIVISION
WICHITA, KS

15-159-22513-0020

KCC OFFICE USE ONLY			
Date Received: 10/20/06	Permit Number: _____	Permit Date: 10/20/06	Lease Inspection: <input type="checkbox"/> Yes <input checked="" type="checkbox"/> No

Mail to: KCC - Conservation Division, 130 S. Market - Room 2078, Wichita, Kansas 67202