

Notice: Fill out COMPLETELY and return to Conservation Division at the address below within 60 days from plugging date.

KANSAS CORPORATION COMMISSION
OIL & GAS CONSERVATION DIVISION
WELL PLUGGING RECORD
K.A.R. 82-3-117

Form CP-4
December 2003
Type or Print on this Form
Form must be Signed
All blanks must be Filled

Lease Operator: John O. Farmer, Inc.
Address: P.O. Box 352, Russell, KS 67665
Phone: (785) 483-3144 Operator License #: 5135
Type of Well: oil Docket #: _____
(Oil, Gas D&A, SWD, ENHR, Water Supply Well, Cathodic, Other) (If SWD or ENHR)
The plugging proposal was approved on: _____ (Date)
by: District #4 (Darrel Dipman witnessed plugging for KCC) (KCC District Agent's Name)
Is ACO-1 filed? Yes No If not, is well log attached? Yes No
Producing Formation(s): List All (If needed attach another sheet)
Arbuckle Depth to Top: 3771' Bottom: 3781' T.D. 3781'
_____ Depth to Top: _____ Bottom: _____ T.D. _____
_____ Depth to Top: _____ Bottom: _____ T.D. _____

API Number: 15 - 137-00,669 - 60-00
Lease Name: Schoen "A"
Well Number: #2 (E-S/2 NE)
Spot Location (QQQQ): _____ - E - S/2 - NE
1980 Feet from North / South Section Line
1320 Feet from East / West Section Line
Sec. 35 Twp. 3 S. R. 24 East West
County: Norton
Date Well Completed: 10-13-53
Plugging Commenced: 9-8-06
Plugging Completed: 9-8-06

KCC
10/17/06
PKT
Per
CP2B
COPSD

Show depth and thickness of all water, oil and gas formations.

Oil, Gas or Water Records		Casing Record (Surface Conductor & Production)				
Formation	Content	From	To	Size	Put In	Pulled Out
Arbuckle	oil & water	3771'	3781'	8-5/8"	170'	-0-
				5-1/2"	3773'	-0-

Describe in detail the manner in which the well is plugged, indicating where the mud fluid was placed and the method or methods used in introducing it into the hole. If cement or other plugs were used, state the character of same depth placed from (bottom), to (top) for each plug set.

Ran tubing to 3050'. Pumped 75 sks. cement & 400# hulls. No returns. Pulled tubing to 1600'. Pumped 75 sks. cement & 400# hulls.
Cement to surface. Pulled tubing to surface. Connected to 5-1/2" casing & pumped 10 sks. cement. Maximum PSI 800#.
SIP 0#. Connected to 8-5/8" surface casing & pumped 30 sks. cement. Maximum PSI 75#. SIP 50#

Name of Plugging Contractor: Swift Services, Inc. Joe Servicing, Inc License #: 32382 3152
Address: P.O. Box 466, Ness City, KS 67560

KCC PKT
10/17/06
Per CP2B

Name of Party Responsible for Plugging Fees: John O. Farmer, Inc.
State of Kansas County, Russell, ss.

John O. Farmer III (Employee of Operator) or (Operator) on above-described well, being first duly sworn on oath, says: That I have knowledge of the facts statements, and matters herein contained, and the log of the above-described well is as filed, and the same are true and correct, so help me God.

(Signature) John O. Farmer III
(Address) P.O. Box 352, Russell, KS 67665

SUBSCRIBED and SWORN TO before me this 12th day of October, 20 06
Margaret A. Schulte My Commission Expires: _____
Notary Public

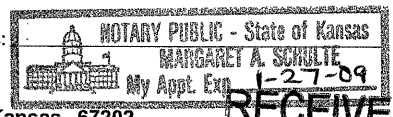

Mail to: KCC - Conservation Division, 130 S. Market - Room 2078, Wichita, Kansas 67202

RECEIVED
OCT 16 2006
KCC WICHITA

OPERATOR James, Chalmers & Farmer, Inc.

FORMATION RECORD

ADDRESS Russell, Kansas

Give detailed description and thickness of all formations drilled through, contents of sand, whether dry, water, oil or gas.

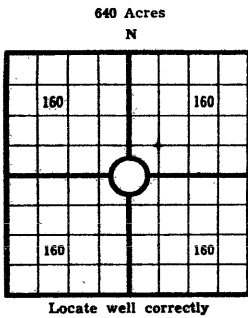

640 Acres
N

COUNTY Morton SEC 35 TWP 3 RGE 24
 COMPANY OPERATING James, Chalmers & Farmer, Inc.
 OFFICE ADDRESS Russell, Kansas
 FARM NAME James A. WELL NO. 3
 DRILLING STARTED 7-25, 1933, DRILLING FINISHED 10-11, 1933
 DATE OF FIRST PRODUCTION _____ COMPLETED _____
 WELL LOCATED 1/4 1/4 1/4 North of South
 Line and _____ ft. East of West Line of Quarter Section
 Elevation (Relative to sea level) DERRICK FLOOR _____ GROUND _____
 CHARACTER OF WELL (Oil, gas or dryhole) _____

OIL OR GAS SANDS OR ZONES

Name	From	To	Name	From	To
1			4		
2			5		
3			6		

Perforating Record If Any

Shot Record

Formation	From	To	No. of Shots	Formation	From	To	Size of Shot

CASING RECORD

Amount Set						Amount Pulled		Packer Record	
Size	Wt.	Thds.	Make	Ft.	In.	Size	Length	Depth Set	Make
8 5/8				170					
5 1/2				3773					

Liner Record: Amount _____ Kind _____ Top _____ Bottom _____

CEMENTING AND MUDDING

Size	Amount Set		Sacks Cement	Chemical		Method of Cementing	Amount	Mudding Method	Results (See Note)
	Ft.	In.		Gal.	Make				
8 5/8	170		125						
5 1/2	3773		73						

Note: What method was used to protect sands if outer strings were pulled? _____

NOTE: Were bottom hole plugs used? _____ If so, state kind, depth set and results obtained _____

TOOLS USED

Rotary Tools were used from _____ feet to _____ Cable tools were used from _____ feet to _____ feet, and from _____ feet to _____ feet, and from _____ feet to _____ feet to _____

Type Rig _____

INITIAL PRODUCTION TEST

Describe initial test: whether by flow through tubing or casing or by pumping _____

Amount of Oil Production _____ bbls. Size of choke, if any _____ Length of test _____ Water

Production _____ bbls. Gravity of oil _____ Type of Pump if pump is used, describe _____

Formation	Top	Bottom	Formation	Top	Bottom
Shale & sand	0	200			
Shale & shells	200	1050			
Shale & sand	1050	1150			
Shale & shells	1150	1640			
Sand, shale, shells	1640	1800			
Red Sand	1800	1950			
Shale & shells	1950	2050			
Anhydrite	2050	2065			
Shale & shells	2065	2490			
Lime & shale	2490	3773			

TOPS:
 Elevation 2463 E. S.
 Marker 3473
 Torpedo 3500
 Landing 3514
 Base of E. C. 3705
 Anhydrite 3772
 E. D. 3773

RECEIVED

OCT 16 2006

KCC WICHITA

I, the undersigned, being first duly sworn upon oath, state that this well record is true, correct and complete according to the records of this office and to the best of my knowledge and belief.

John W. Farmer
 Name and title of representative of company

Subscribed and sworn to before me this 10th day of October, 1933

My Commission expires April 23, 1934 Emmie Perryhill
 Notary Public.

WELL NO. _____ COUNTY _____ TWP _____ SEC _____ RGE _____

JOB LOG

SWIFT Services, Inc.

DATE 9-8-06 PAGE NO. 1

CUSTOMER John O. Farmer WELL NO. A#2 LEASE Schoen JOB TYPE PTA TICKET NO. 10540

CHART NO.	TIME	RATE (BPM)	VOLUME (BBL) (GAL)	PUMPS		PRESSURE (PSI)		DESCRIPTION OF OPERATION AND MATERIALS
				T	C	TUBING	CASING	
	1445							on loc setup Trks
								2 3/8" x 5 1/2"
								2 3/8" @ 3050' 5 1/2" @ 3773'
								PBTD 3100' 8 5/8" 170'
								1st Plug 3050'
	1430	4.5	0				800	start cement 75sks SMD 400# Halls
		4.5	41/0				800	End Cement / start water
	1440		4					Balanced no circ.
								2nd Plug 1600'
	1250	4.5	0					start cement 75sks SMD 400# Halls
			10				400	End cement / start wtr
	1800		1				400	Balanced
								*POH Hook up to 5 1/2"
	1840	1	0				0	start cement 10sks SMD
	1845		5				0	End cement hole in 5 1/2"
								Hook up to 8 5/8"
	1850	1.75	0				0	start cement 30sks
	1900		15				75	End cement
							50	shut in
								190sks SMD

Thank you

Nick, Josh, Don & Rob

RECEIVED

OCT 16 2006

KCC WICHITA