

OWWO

For KCC Use: 11-400
Effective Date: 4
District # 4
SGA? Yes No

KANSAS CORPORATION COMMISSION
OIL & GAS CONSERVATION DIVISION
NOTICE OF INTENT TO DRILL

Form C-1
December 2002
Form must be Typed
Form must be Signed
All blanks must be Filled

Must be approved by KCC five (5) days prior to commencing well

Expected Spud Date November 3 2006
month day year

Spot SW SE SE Sec. 12 Twp. 11 S. R. 33 East West

OPERATOR: License# 5363 ✓
Name: Berexco Inc.
Address: PO Box 20380
City/State/Zip: Wichita, KS 67208
Contact Person: Jeremy Ens
Phone: (316) 265-3311

990' 1025' per surveys feet from N / S Line of Section
feet from E / W Line of Section
Is SECTION Regular Irregular?

CONTRACTOR: License# 5147 ✓
Name: Beredco

(Note: Locate well on the Section Plat on reverse side)
County: Logan
Lease Name: Kruse O Well #: 1
Field Name: Cook

Well Drilled For: Oil Enh Rec Gas O&W Seismic; # of Holes Other
Well Class: Infield Pool Ext. Wildcat Other
Type Equipment: Mud Rotary Air Rotary Cable

Is this a Prorated / Spaced Field? Yes No
Target Formation(s): LKC, Johnson
Nearest Lease or unit boundary: 330'

If OWWO: old well information as follows:
Operator: Donald C. Slawson
Well Name: Kruse O #1
Original Completion Date: 8/23/78 Original Total Depth: 4621'

Ground Surface Elevation: 3076 feet MSL
Water well within one-quarter mile: Yes No
Public water supply well within one mile: Yes No
Depth to bottom of fresh water: 200'
Depth to bottom of usable water: 1600'

Directional, Deviated or Horizontal wellbore? Yes No
If Yes, true vertical depth: _____
Bottom Hole Location: _____
KCC DKT #: _____

Surface Pipe by Alternate: 1 2
Length of Surface Pipe Planned to be set: N/A, already set at 298'
Length of Conductor Pipe required: N/A
Projected Total Depth: 4621'
Formation at Total Depth: Johnson

Water Source for Drilling Operations: Well Farm Pond Other _____
DWR Permit #: _____
(Note: Apply for Permit with DWR)

Will Cores be taken? Yes No
If Yes, proposed zone: _____

AFFIDAVIT

The undersigned hereby affirms that the drilling, completion and eventual plugging of this well will comply with K.S.A. 55 et. seq.
It is agreed that the following minimum requirements will be met:

RECEIVED
KANSAS CORPORATION COMMISSION
OCT 30 2006
CONSERVATION DIVISION
WICHITA, KS

- 1. Notify the appropriate district office **prior** to spudding of well;
- 2. A copy of the approved notice of intent to drill **shall be** posted on each drilling rig;
- 3. The minimum amount of surface pipe as specified below **shall be set** by circulating cement to the top; in all cases surface pipe through all unconsolidated materials plus a minimum of 20 feet into the underlying formation.
- 4. If the well is dry hole, an agreement between the operator and the district office on plug length and placement is necessary **prior to plugging**;
- 5. The appropriate district office will be notified before well is either plugged or production casing is cemented in;
- 6. If an ALTERNATE II COMPLETION, production pipe shall be cemented from below any usable water to surface within **120 days** of spud date.
Or pursuant to Appendix "B" - Eastern Kansas surface casing order #133,891-C, which applies to the KCC District 3 area, alternate II cementing must be completed within 30 days of the spud date or the well shall be plugged. **In all cases, NOTIFY district office** prior to any cementing.

I hereby certify that the statements made herein are true and to the best of my knowledge and belief.

Date: 10/30/06 Signature of Operator or Agent: [Signature] Title: DISTRICT ENGINEER

For KCC Use ONLY
API # 15 - 109-20110-00-01
Conductor pipe required None feet
Minimum surface pipe required 298 feet per Alt. 102
Approved by: Ruth 10-30-06
This authorization expires: 4-30-07
(This authorization void if drilling not started within 6 months of approval date.)
Spud date: _____ Agent: _____

Remember to:
- File Drill Pit Application (form CDP-1) with Intent to Drill;
- File Completion Form ACO-1 within 120 days of spud date;
- File acreage attribution plat according to field proration orders;
- Notify appropriate district office 48 hours prior to workover or re-entry;
- Submit plugging report (CP-4) after plugging is completed;
- Obtain written approval before disposing or injecting salt water.
- If this permit has expired (See: authorized expiration date) please check the box below and return to the address below.
 Well Not Drilled - Permit Expired
Signature of Operator or Agent: _____
Date: _____

12
11
33W

IN ALL CASES PLOT THE INTENDED WELL ON THE PLAT BELOW

Plat of acreage attributable to a well in a prorated or spaced field

If the intended well is in a prorated or spaced field, please fully complete this side of the form. If the intended well is in a prorated or spaced field complete the plat below showing that the well will be properly located in relationship to other wells producing from the common source of supply. Please show all the wells and within 1 mile of the boundaries of the proposed acreage attribution unit for gas wells and within 1/2 mile of the boundaries of the proposed acreage attribution unit for oil wells.

API No. 15 - 109-20110-00-01
Operator: Berexco Inc.
Lease: Kruse O
Well Number: 1
Field: Cook
Number of Acres attributable to well: _____
QTR / QTR / QTR of acreage: SW - SE - SE

Location of Well: County: Logan
330 feet from N / S Line of Section
990-1025 per survey feet from E / W Line of Section
Sec. 12 Twp. 11 S. R. 33 East West
Is Section: Regular or Irregular
If Section is Irregular, locate well from nearest corner boundary.
Section corner used: NE NW SE SW

PLAT

*(Show location of the well and shade attributable acreage for prorated or spaced wells.)
(Show footage to the nearest lease or unit boundary line.)*

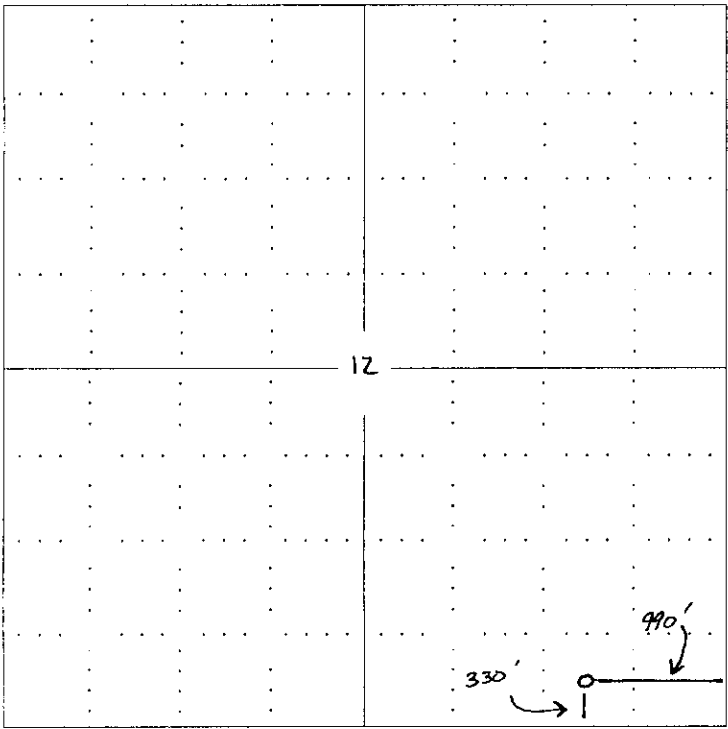

RECEIVED
KANSAS CORPORATION COMMISSION
OCT 30 2006
CONSERVATION DIVISION
WICHITA, KS

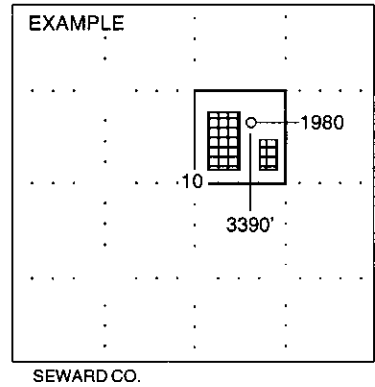

NOTE: In all cases locate the spot of the proposed drilling location. *LEASE LINE*

In plotting the proposed location of the well, you must show:

1. The manner in which you are using the depicted plat by identifying section lines, i.e. 1 section, 1 section with 8 surrounding sections, 4 sections, etc.
2. The distance of the proposed drilling location from the section's south / north and east / west.
3. The distance to the nearest lease or unit boundary line.
4. If proposed location is located within a prorated or spaced field a certificate of acreage attribution plat must be attached: (C0-7 for oil wells; CG-8 for gas wells).

**KANSAS CORPORATION COMMISSION
OIL & GAS CONSERVATION DIVISION
APPLICATION FOR SURFACE PIT**

Form CDP-1
April 2004
Form must be Typed

Submit in Duplicate

Operator Name: Berexco Inc.		License Number: 5363
Operator Address: PO Box 20380 Wichita, KS 67208		
Contact Person: Jeremy Ensz		Phone Number: (316) 265 - 3311
Lease Name & Well No.: Kruse O #1		Pit Location (QQQQ): SW SE SE
Type of Pit: <input type="checkbox"/> Emergency Pit <input type="checkbox"/> Burn Pit <input type="checkbox"/> Settling Pit <input checked="" type="checkbox"/> Drilling Pit <input type="checkbox"/> Workover Pit <input type="checkbox"/> Haul-Off Pit <small>(If WP Supply API No. or Year Drilled)</small>	Pit is: <input checked="" type="checkbox"/> Proposed <input type="checkbox"/> Existing If Existing, date constructed: _____ Pit capacity: _____ (bbls)	Sec. 12 Twp. 11 R. 33 <input type="checkbox"/> East <input checked="" type="checkbox"/> West 330 Feet from <input type="checkbox"/> North / <input checked="" type="checkbox"/> South Line of Section 900/1025 per survey Feet from <input checked="" type="checkbox"/> East / <input type="checkbox"/> West Line of Section Logan _____ County
Is the pit located in a Sensitive Ground Water Area? <input type="checkbox"/> Yes <input checked="" type="checkbox"/> No		Chloride concentration: _____ mg/l <small>(For Emergency Pits and Settling Pits only)</small>
Is the bottom below ground level? <input checked="" type="checkbox"/> Yes <input type="checkbox"/> No	Artificial Liner? <input type="checkbox"/> Yes <input checked="" type="checkbox"/> No	How is the pit lined if a plastic liner is not used?
Pit dimensions (all but working pits): 100 Length (feet) 100 Width (feet) _____ N/A: Steel Pits Depth from ground level to deepest point: 4 (feet)		
If the pit is lined give a brief description of the liner material, thickness and installation procedure.		Describe procedures for periodic maintenance and determining liner integrity, including any special monitoring.
Distance to nearest water well within one-mile of pit 1450 feet Depth of water well 200 feet		Depth to shallowest fresh water 200 feet. Source of information: _____ measured _____ well owner _____ electric log <input checked="" type="checkbox"/> KDWR
Emergency, Settling and Burn Pits ONLY: Producing Formation: _____ Number of producing wells on lease: _____ Barrels of fluid produced daily: _____ Does the slope from the tank battery allow all spilled fluids to flow into the pit? <input type="checkbox"/> Yes <input type="checkbox"/> No		Drilling, Workover and Haul-Off Pits ONLY: Type of material utilized in drilling/workover: Bentonite Number of working pits to be utilized: 4 Abandonment procedure: Allow pits to dry, backfill when conditions permit _____ Drill pits must be closed within 365 days of spud date.
I hereby certify that the above statements are true and correct to the best of my knowledge and belief.		RECEIVED KANSAS CORPORATION COMMISSION OCT 30 2006 CONSERVATION DIVISION WICHITA, KS
Date: <u>10/28/06</u>		Signature of Applicant or Agent: 
KCC OFFICE USE ONLY		
Date Received: <u>10/30/06</u> Permit Number: _____ Permit Date: <u>10/30/06</u> Lease Inspection: <input type="checkbox"/> Yes <input checked="" type="checkbox"/> No		

15-109-20110-00-01

Mail to: KCC - Conservation Division, 130 S. Market - Room 2078, Wichita, Kansas 67202

15-109-20110-00-01



Fall & Associates

Stake and Elevation Service

710 W. 5th Street

P.O. Box 404

Concordia, KS. 66901

1-800-536-2621

Date 10-27-06

Invoice Number 1026062

BEREXCO, INC.

1

Kruse
~~Kruse~~ "O"

Operator

Number

Farm Name

Logan-KS

12

11s

33w

330' FSL 1025' FEL

County-State

S

T

R

Location

Berexco, Inc.
P.O. Box 20380
Wichita, KS. 67208

Elevation 3075 Gr.

Ordered By: Jeremy

Scale 1"=1000'

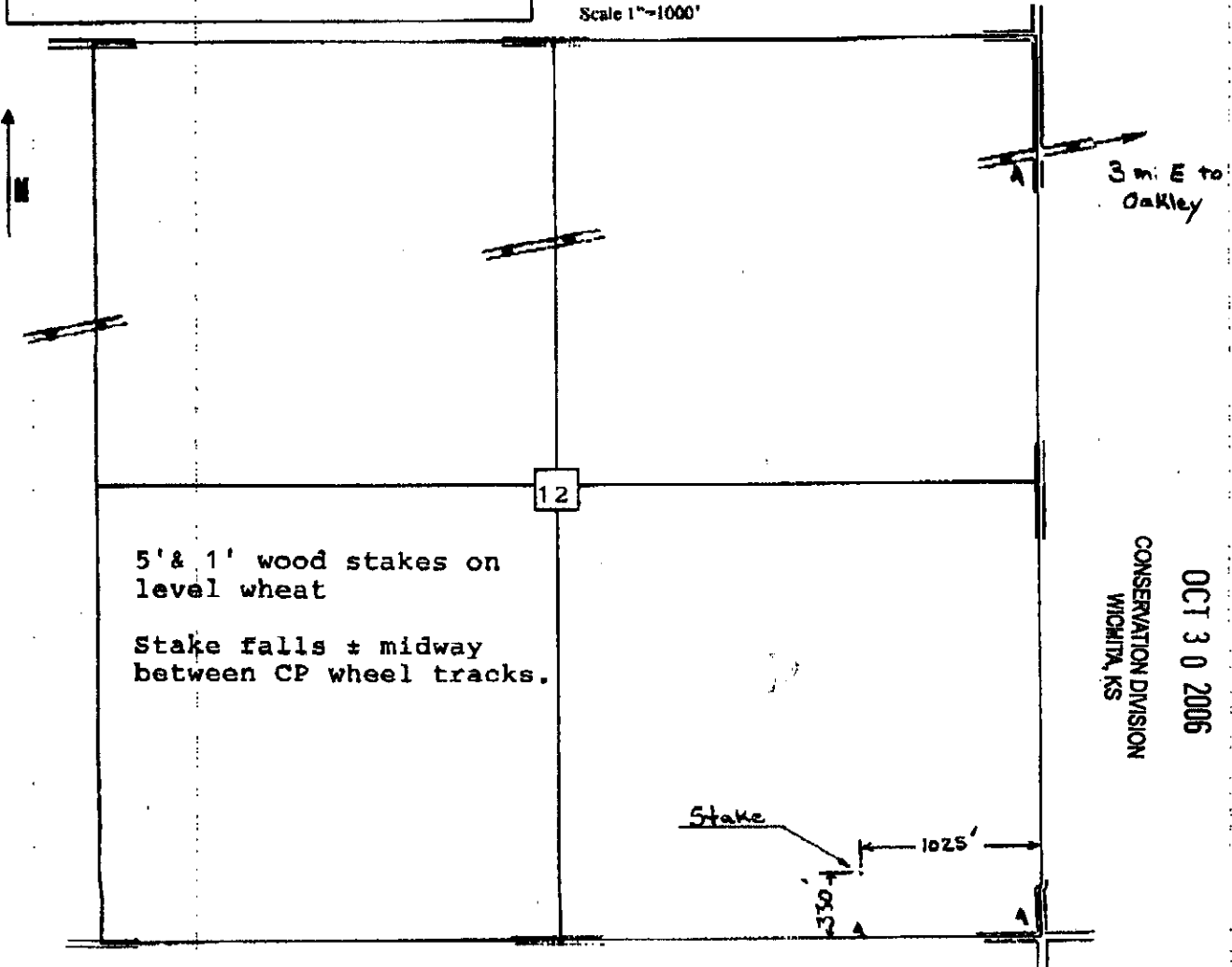

RECEIVED
KANSAS CORPORATION COMMISSION
OCT 30 2006
CONSERVATION DIVISION
WICHITA, KS

STATE OF KANSAS
CORPORATION COMMISSION

WELL PLUGGING RECORD

All information Completely
Required Affidavit
or Deliver Report to:
Conservation Division
State Corporation Commission
P. O. Box 17027
Wichita, Kansas 67217
NORTH

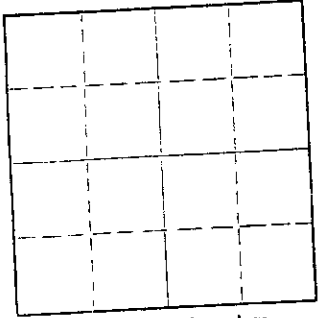

Logan County, Sec. 12 Twp. 11 Rge. 33W (E) (W)
Location as "NE/CNWKSWK" or footage from lines: SW SE SE
Lease Owner: Donald C. Slawson
Lease Name: Kruse 'O' Well No. 1
Office Address: 200 Douglas Building Wichita, Kansas 67202
Character of Well (completed as Oil, Gas or Dry Hole): Dry Hole
Date well completed: August 14 1978
Application for plugging filed: August 14 1978
Application for plugging approved: August 14 1978
Plugging commenced: August 14 1978
Plugging completed: August 14, 1978
Reason for abandonment of well or producing formation: Dry Hole
If a producing well is abandoned, date of last production: 19__
Was permission obtained from the Conservation Division or its agents before plugging was commenced? yes

Name of Conservation Agent who supervised plugging of this well: Gilbert Balthazor
Depth to top: Bottom: Total Depth of Well: 4624' Feet
Producing formation: _____
Show depth and thickness of all water, oil and gas formations.

CASING RECORD

OIL, GAS OR WATER RECORDS

FORMATION	CONTENT	FROM	TO	SIZE	PUT IN	PULLED OUT
	290.09	surface	298'	8 5/8"		

Describe in detail the manner in which the well was plugged, indicating where the mud fluid was placed and the method or methods used in introducing it into the hole. If cement or other plugs were used, state the character of same and depth placed, from _____ feet to _____ feet for each plug set.

1st plug @ 1500' w/70 sx
2nd plug @ 240' w/20 sx
Top plug @ 40' w/10 sx

RECEIVED
STATE CORPORATION COMMISSION
NOV 20 1978
CONSERVATION DIVISION
Wichita, Kansas

(If additional description is necessary, use BACK of this sheet)
Name of Plugging Contractor: Slawson Drilling Company, Inc.
Address: 200 Douglas Building Wichita, Kansas 67202

STATE OF KANSAS, COUNTY OF SEDGWICK, ss.
R.J. THATCHER (employee of owner) or (owner or operator) of the above-described well, being first duly sworn on oath, says: That I have knowledge of the facts, statements, and matters herein contained and the log of the above-described well as filed and that the same are true and correct. So help me God.
(Signature) R. J. THATCHER 200 Douglas Bldg., Wich, KS
(Address)

SUBSCRIBED AND SWORN TO before me this 10th day of November, 1978
Sherry L. Milford
Notary Public.

My commission expires 6/12/82

