

IN ALL CASES PLOT THE INTENDED WELL ON THE PLAT BELOW

Plat of acreage attributable to a well in a prorated or spaced field

If the intended well is in a prorated or spaced field, please fully complete this side of the form. If the intended well is in a prorated or spaced field complete the plat below showing that the well will be properly located in relationship to other wells producing from the common source of supply. Please show all the wells and within 1 mile of the boundaries of the proposed acreage attribution unit for gas wells and within 1/2 mile of the boundaries of the proposed acreage attribution unit for oil wells.

API No. 15 - 017-20892-0000
Operator: Shawmar Oil & Gas Company, Inc.
Lease: METHVIN
Well Number: 2
Field: Lipps

Location of Well: County: Chase
Appx. 365 feet from N / S Line of Section
Appx. 2005 feet from E / W Line of Section
Sec. 28 Twp. 18 S. R. 6 East West

Number of Acres attributable to well:
QTR / QTR / QTR of acreage: SE/4 - SE/4 - SW/4

Is Section: Regular or Irregular

If Section is Irregular, locate well from nearest corner boundary.
Section corner used: NE NW SE SW

PLAT

(Show location of the well and shade attributable acreage for prorated or spaced wells.)
(Show footage to the nearest lease or unit boundary line.)

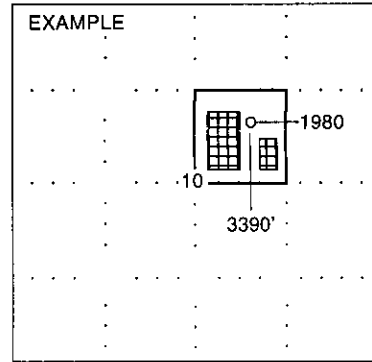
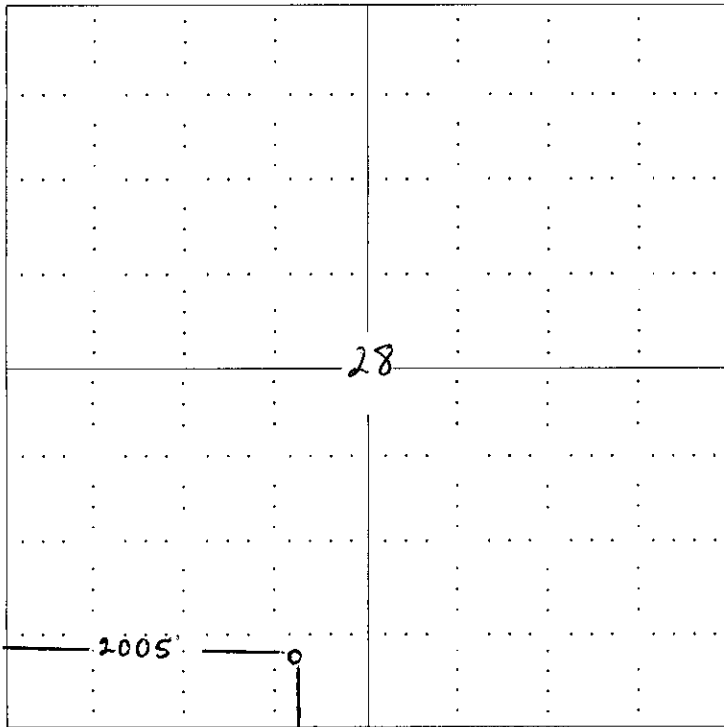

NOTE: In all cases locate the spot of the proposed drilling locaton.

In plotting the proposed location of the well, you must show:

- 1. The manner in which you are using the depicted plat by identifying section lines, i.e. 1 section, 1 section with 8 surrounding sections, 4 sections, etc.
2. The distance of the proposed drilling location from the section's south / north and east / west.
3. The distance to the nearest lease or unit boundary line.
4. If proposed location is located within a prorated or spaced field a certificate of acreage attribution plat must be attached: (C0-7 for oil wells, CG-8 for gas wells).

RECEIVED
OCT 27 2006
KCC WICHITA

**KANSAS CORPORATION COMMISSION
OIL & GAS CONSERVATION DIVISION
APPLICATION FOR SURFACE PIT**

Form CDP-1
April 2004
Form must be Typed

Submit in Duplicate

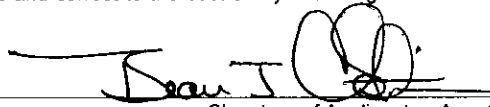
Operator Name: Shawmar Oil & Gas Company, Inc.		License Number: 5192
Operator Address: PO Box 9, Marion, KS 66861		
Contact Person: Beau J. Cloutier		Phone Number: (620) 382 - 2932
Lease Name & Well No.: METHVIN #2		Pit Location (QQQQ): _____ SE/4 SE/4 SW/4 Sec. 28 Twp. 18 R. 6 <input checked="" type="checkbox"/> East <input type="checkbox"/> West Appx. 365 Feet from <input type="checkbox"/> North / <input checked="" type="checkbox"/> South Line of Section Appx. 2005 Feet from <input type="checkbox"/> East / <input checked="" type="checkbox"/> West Line of Section Chase _____ County
Type of Pit: <input type="checkbox"/> Emergency Pit <input type="checkbox"/> Burn Pit <input type="checkbox"/> Settling Pit <input checked="" type="checkbox"/> Drilling Pit <input type="checkbox"/> Workover Pit <input type="checkbox"/> Haul-Off Pit <small>(If WP Supply API No. or Year Drilled)</small>	Pit is: <input checked="" type="checkbox"/> Proposed <input type="checkbox"/> Existing If Existing, date constructed: _____ Pit capacity: 800 _____ (bbls)	
Is the pit located in a Sensitive Ground Water Area? <input type="checkbox"/> Yes <input checked="" type="checkbox"/> No		Chloride concentration: <u>N/a</u> _____ mg/l <small>(For Emergency Pits and Settling Pits only)</small>
Is the bottom below ground level? <input checked="" type="checkbox"/> Yes <input type="checkbox"/> No	Artificial Liner? <input checked="" type="checkbox"/> Yes <input type="checkbox"/> No	How is the pit lined if a plastic liner is not used? N/a
Pit dimensions (all but working pits): <u>30</u> Length (feet) <u>20</u> Width (feet) _____ N/A: Steel Pits <u>30</u> Depth from ground level to deepest point: <u>5</u> _____ (feet)		
If the pit is lined give a brief description of the liner material, thickness and installation procedure. 6 mm 40x100		Describe procedures for periodic maintenance and determining liner integrity, including any special monitoring.
Distance to nearest water well within one-mile of pit <u>N/a</u> feet Depth of water well <u>150</u> feet		Depth to shallowest fresh water <u>100</u> feet. Source of information: _____ measured <input checked="" type="checkbox"/> well owner _____ electric log _____ KDWR
Emergency, Settling and Burn Pits ONLY: Producing Formation: _____ Number of producing wells on lease: _____ Barrels of fluid produced daily: _____ Does the slope from the tank battery allow all spilled fluids to flow into the pit? <input type="checkbox"/> Yes <input type="checkbox"/> No		Drilling, Workover and Haul-Off Pits ONLY: Type of material utilized in drilling/workover: <u>air/mud</u> Number of working pits to be utilized: _____ Abandonment procedure: <u>let dry and cover</u> _____ Drill pits must be closed within 365 days of spud date.
I hereby certify that the above statements are true and correct to the best of my knowledge and belief.		
<u>October 26, 2006</u> Date	 Signature of Applicant or Agent	

15-017-20892-0225

KCC OFFICE USE ONLY			
Date Received: <u>10/27/06</u>	Permit Number: _____	Permit Date: <u>10/27/06</u>	Lease Inspection: <input type="checkbox"/> Yes <input checked="" type="checkbox"/> No

Mail to: KCC - Conservation Division, 130 S. Market - Room 2078, Wichita, Kansas 67202

RECEIVED

OCT 27 2006

KCC WICHITA