

For KCC Use:
 Effective Date: 11-4-06
 District # 1
 SGA? Yes No

KANSAS CORPORATION COMMISSION
 OIL & GAS CONSERVATION DIVISION

Form C-1

December 2002

Form must be Typed
 Form must be Signed
 All blanks must be Filled

NOTICE OF INTENT TO DRILL

Must be approved by KCC five (5) days prior to commencing well

Expected Spud Date November 4 2006
month day year

Spot
 App. C NE - NW Sec. 7 Twp. 33 S. R. 14 East West

OPERATOR: License# 32811 ✓
 Name: Osage Resources, L.L.C.
 Address: 1605 E. 56th Avenue
 City/State/Zip: Hutchinson, Kansas 67502
 Contact Person: Benjamin W. Crouch
 Phone: 620-664-9622

774 feet from N / S Line of Section
1956 feet from E / W Line of Section
 Is SECTION Regular Irregular?

(Note: Locate well on the Section Plat on reverse side)

CONTRACTOR: License# 33789 ✓
 Name: D & B Drilling, L.L.C.

County: Barber
 Lease Name: Osage Well #: 104
 Field Name: Osage Gas Area

Well Drilled For:	Well Class:	Type Equipment:
<input type="checkbox"/> Oil <input checked="" type="checkbox"/> Gas <input type="checkbox"/> OWWO <input type="checkbox"/> Seismic; # of Holes <input type="checkbox"/> Other	<input type="checkbox"/> Enh Rec <input type="checkbox"/> Storage <input type="checkbox"/> Disposal <input type="checkbox"/> Other	<input type="checkbox"/> Infield <input type="checkbox"/> Pool Ext. <input checked="" type="checkbox"/> Wildcat <input type="checkbox"/> Other
		<input checked="" type="checkbox"/> Mud Rotary <input type="checkbox"/> Air Rotary <input type="checkbox"/> Cable

Is this a Prorated / Spaced Field? Yes No
 Target Formation(s): Mississippian ✓
 Nearest Lease or unit boundary: 774 ✓

Ground Surface Elevation: 1885 feet MSL
 Water well within one-quarter mile: Yes No
 Public water supply well within one mile: Yes No

Depth to bottom of fresh water: 100'
 Depth to bottom of usable water: 180'

Surface Pipe by Alternate: 1 2
 Length of Surface Pipe Planned to be set: 200' ✓

Length of Conductor Pipe required: None ✓
 Projected Total Depth: 5600' ✓

Formation at Total Depth: Arbuckle ✓
 Water Source for Drilling Operations:

Well Farm Pond Other ✓
 DWR Permit #:

(Note: Apply for Permit with DWR)

Will Cores be taken? Yes No
 If Yes, proposed zone:

If OWWO: old well information as follows:

Operator:
 Well Name:
 Original Completion Date: Original Total Depth:

Directional, Deviated or Horizontal wellbore? Yes No

If Yes, true vertical depth:

Bottom Hole Location:

KCC DKT #:

AFFIDAVIT

The undersigned hereby affirms that the drilling, completion and eventual plugging of this well will comply with K.S.A. 55 et. seq.

It is agreed that the following minimum requirements will be met:

1. Notify the appropriate district office **prior** to spudding of well;
2. A copy of the approved notice of intent to drill **shall be** posted on each drilling rig;
3. The minimum amount of surface pipe as specified below **shall be set** by circulating cement to the top; in all cases surface pipe **shall be set** through all unconsolidated materials plus a minimum of 20 feet into the underlying formation.
4. If the well is dry hole, an agreement between the operator and the district office on plug length and placement is necessary **prior to plugging**;
5. The appropriate district office will be notified before well is either plugged or production casing is cemented in;
6. If an ALTERNATE II COMPLETION, production pipe shall be cemented from below any usable water to surface within **120 days** of spud date. Or pursuant to Appendix "B" - Eastern Kansas surface casing order #133,891-C, which applies to the KCC District 3 area, alternate II cementing must be completed within 30 days of the spud date or the well shall be plugged. **In all cases, NOTIFY district office** prior to any cementing.

I hereby certify that the statements made herein are true and to the best of my knowledge and belief.

Date: 10-24-06 Signature of Operator or Agent: Benjamin W. Crouch Title: Vice President

For KCC Use ONLY	
API # 15 - <u>007-23089-0000</u>	
Conductor pipe required <u>None</u> feet	
Minimum surface pipe required <u>200</u> feet per Alt. <u>1</u> X	
Approved by: <u>RWA/10-30-06</u>	
This authorization expires: <u>4-30-07</u>	
<small>(This authorization void if drilling not started within 6 months of approval date.)</small>	
Spud date: <u> </u>	Agent: <u> </u>

Remember to:

- File Drill Pit Application (form CDP-1) with Intent to Drill;
- File Completion Form ACO-1 within 120 days of spud date;
- File acreage attribution plat according to field proration orders;
- Notify appropriate district office 48 hours prior to workover or re-entry;
- Submit plugging report (CP-4) after plugging is completed;
- Obtain written approval before disposing or injecting salt water.

Well Not Drilled - Permit Expired

Signature of Operator or Agent:
 Date:

Mail to: KCC - Conservation Division, 130 S. Market - Room 2078, Wichita, Kansas 67202

RECEIVED
 OCT 26 2006
 KCC WICHITA

7
 33
 MW

IN ALL CASES PLOT THE INTENDED WELL ON THE PLAT BELOW

Plat of acreage attributable to a well in a prorated or spaced field

If the intended well is in a prorated or spaced field, please fully complete this side of the form. If the intended well is in a prorated or spaced field complete the plat below showing that the well will be properly located in relationship to other wells producing from the common source of supply. Please show all the wells and within 1 mile of the boundaries of the proposed acreage attribution unit for gas wells and within 1/2 mile of the boundaries of the proposed acreage attribution unit for oil wells.

API No. 15 - 007-23089-000
 Operator: Osage Resources, L.L.C.
 Lease: Osage
 Well Number: 104
 Field: Aetna Gas Area

Location of Well: County: Barber
774 feet from N / S Line of Section
1956 feet from E / W Line of Section
 Sec. 7 Twp. 33 S. R. 14 East West

Number of Acres attributable to well: _____
 QTR / QTR / QTR of acreage: App. C - NE - NW

Is Section: Regular or Irregular

If Section is Irregular, locate well from nearest corner boundary.
 Section corner used: NE NW SE SW

PLAT

*(Show location of the well and shade attributable acreage for prorated or spaced wells.)
 (Show footage to the nearest lease or unit boundary line.)*

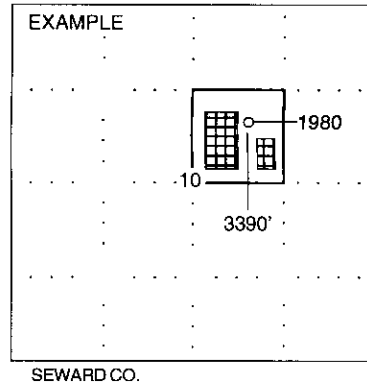
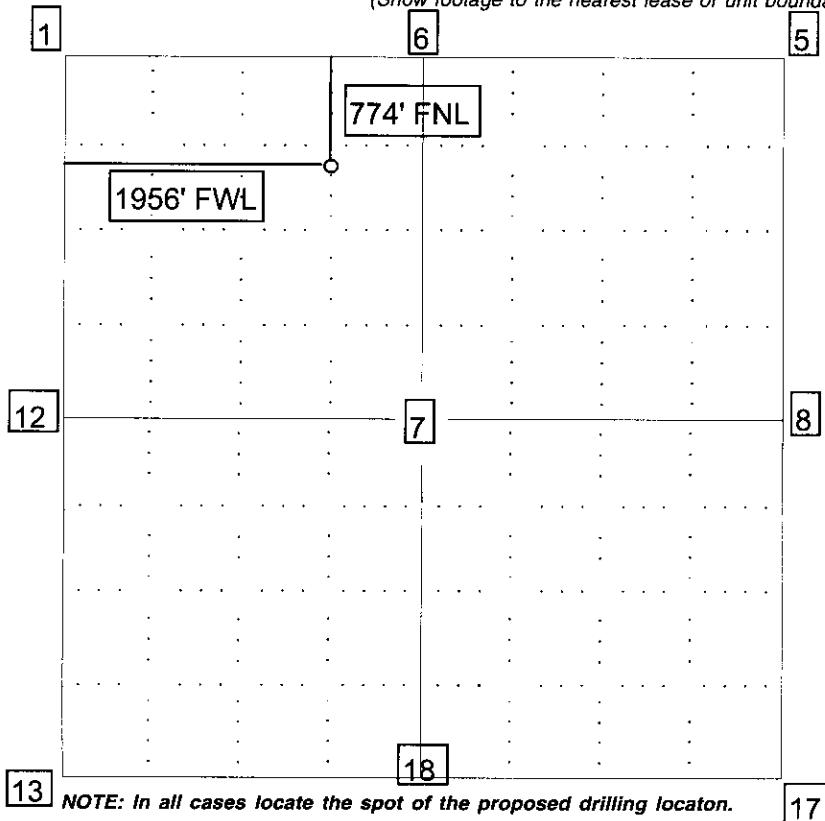

In plotting the proposed location of the well, you must show:

1. The manner in which you are using the depicted plat by identifying section lines, i.e. 1 section, 1 section with 8 surrounding sections, 4 sections, etc.
2. The distance of the proposed drilling location from the section's south / north and east / west.
3. The distance to the nearest lease or unit boundary line.
4. If proposed location is located within a prorated or spaced field a certificate of acreage attribution plat must be attached: (CO-7 for oil wells, CG-8 for gas wells).

RECEIVED
 OCT 26 2006
 KCC WICHITA

KANSAS CORPORATION COMMISSION
OIL & GAS CONSERVATION DIVISION
APPLICATION FOR SURFACE PIT

Form CDP-1
April 2004
Form must be Typed

Submit in Duplicate

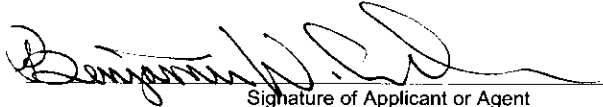
Operator Name: Osage Resources, L.L.C.		License Number: 32811
Operator Address: 1605 E. 56th Avenue, Hutchinson, Kansas 67502		
Contact Person: Benjamin W. Crouch		Phone Number: (620) 664 - 9622
Lease Name & Well No.: Osage No. 104		Pit Location (QQQQ): App. C NE NW Sec. 7 Twp. 33 R. 14 <input type="checkbox"/> East <input checked="" type="checkbox"/> West 774 Feet from <input checked="" type="checkbox"/> North / <input type="checkbox"/> South Line of Section 1956 Feet from <input type="checkbox"/> East / <input checked="" type="checkbox"/> West Line of Section Barber County
Type of Pit: <input type="checkbox"/> Emergency Pit <input type="checkbox"/> Burn Pit <input type="checkbox"/> Settling Pit <input checked="" type="checkbox"/> Drilling Pit <input type="checkbox"/> Workover Pit <input type="checkbox"/> Haul-Off Pit <small>(If WP Supply API No. or Year Drilled)</small>	Pit is: <input checked="" type="checkbox"/> Proposed <input type="checkbox"/> Existing If Existing, date constructed: _____ Pit capacity: 4500 (bbls)	
Is the pit located in a Sensitive Ground Water Area? <input checked="" type="checkbox"/> Yes <input checked="" type="checkbox"/> No		Chloride concentration: _____ mg/l <small>(For Emergency Pits and Settling Pits only)</small>
Is the bottom below ground level? <input checked="" type="checkbox"/> Yes <input type="checkbox"/> No	Artificial Liner? <input type="checkbox"/> Yes <input checked="" type="checkbox"/> No	How is the pit lined if a plastic liner is not used? Native clay
Pit dimensions (all but working pits): 60 Length (feet) 60 Width (feet) N/A: Steel Pits Depth from ground level to deepest point: 5 (feet)		
If the pit is lined give a brief description of the liner material, thickness and installation procedure. NA		Describe procedures for periodic maintenance and determining liner integrity, including any special monitoring. NA
Distance to nearest water well within one-mile of pit NA feet Depth of water well _____ feet		Depth to shallowest fresh water _____ feet. Source of information: _____ measured _____ well owner _____ electric log _____ KDWR
Emergency, Settling and Burn Pits ONLY: Producing Formation: _____ Number of producing wells on lease: _____ Barrels of fluid produced daily: _____ Does the slope from the tank battery allow all spilled fluids to flow into the pit? <input type="checkbox"/> Yes <input type="checkbox"/> No		Drilling, Workover and Haul-Off Pits ONLY: Type of material utilized in drilling/workover: Bentonite Drilling Mud Number of working pits to be utilized: 3 Abandonment procedure: Pits allowed to evaporate until dry then backfill. Drill pits must be closed within 365 days of spud date.
I hereby certify that the above statements are true and correct to the best of my knowledge and belief.		
10-24-06 Date		 Signature of Applicant or Agent

15-007-23089-0000

KCC OFFICE USE ONLY		Away draw RFASAC
Date Received: 10/26/04	Permit Number: _____	Permit Date: 10/27/04 Lease Inspection: <input checked="" type="checkbox"/> RECEIVED

Mail to: KCC - Conservation Division, 130 S. Market - Room 2078, Wichita, Kansas 67202

OCT 26 2006
KCC WICHITA

KANSAS

CORPORATION COMMISSION

KATHLEEN SEBELIUS, GOVERNOR
BRIAN J. MOLINE, CHAIR
ROBERT E. KREHBIEL, COMMISSIONER
MICHAEL C. MOFFET, COMMISSIONER

October 27, 2006

Mr. Benjamin W. Crouch
Osage Resources, LLC
1605 E. 56th Avenue
Hutchinson, KS 67502

RE: Drilling Pit Application
Osage Lease Well No. 104
NW/4 Sec. 07-33S-14W
Barber County, Kansas

Dear Mr. Crouch:

District staff has inspected the above referenced location and has determined that the reserve pit shall be constructed **without slots**, the bottom shall be flat and reasonably level, and the free fluids must be removed. The fluids are to be removed from the reserve pit as soon as the Hutchinson Salt section has been drilled through and displacement of the fluids into the reserve pit has occurred. The fluids should be removed again as soon as practical after drilling operations have ceased. **Please keep the pits away from the draw.**

If production casing is set all completion fluids shall be removed from the working pits daily. NO completion fluids or non-exempt wastes shall be placed in the reserve pit.

The fluids should be taken to an authorized disposal well. Please call the District Office at (620) 225-8888 when the fluids have been removed. Please file form CDP-5 (August 2004), Exploration and Production Waste Transfer, within 30 days of fluid removal. Conservation division forms are available through our office and on the KCC web site: www.kcc.state.ks.us/conservation/forms.

A copy of this letter should be posted in the doghouse along with the approved Intent to Drill.

If you have any questions or concerns please feel free to contact the undersigned at the above address.

Sincerely,



Kathy Haynes
Environmental Protection and Remediation Department

cc: S Durrant