

For KCC Use:  
 Effective Date: 11-5-06  
 District # 3  
 SGA?  Yes  No

KANSAS CORPORATION COMMISSION  
 OIL & GAS CONSERVATION DIVISION

Form C-1  
 December 2002

Form must be Typed  
 Form must be Signed  
 All blanks must be Filled

NOTICE OF INTENT TO DRILL

Must be approved by KCC five (5) days prior to commencing well

Expected Spud Date November 1, 2006  
 month day year

~~445-490-4705~~  
 Spot SE-NE-NE  East  
 ? ~~498~~ - ~~1558~~ - ~~4785~~ Sec. 27 Twp. 33 S. R. 15  West  
 1000 feet from  N /  S Line of Section  
 400 feet from  E /  W Line of Section

OPERATOR: License# 33181  
 Name: Jordan Wilson  
 Address: 5994 Palm Rd.  
 City/State/Zip: Neosho, MO. 64850-5326  
 Contact Person: Jordan Wilson  
 Phone: 417-455-3578

Is SECTION  Regular  Irregular?  
 (Note: Locate well on the Section Plat on reverse side)  
 County: Montgomery

CONTRACTOR: License# Finney Drilling 5989  
 Name: Finney Drilling Co.

Lease Name: Clarkson 41 Well #: 5  
 Field Name: Jefferson-Sycamore  
 Is this a Prorated / Spaced Field?  Yes  No

Well Drilled For:  Oil  Gas  OWWO  Seismic; # of Holes  Other  
 Enh Rec  Storage  Disposal  
 Well Class:  Infield  Pool Ext.  Wildcat  Other  
 Type Equipment:  Mud Rotary  Air Rotary  Cable

Target Formation(s): Wayside  
 Nearest Lease or unit boundary: 500ft  
 Ground Surface Elevation: 300 EST 840 Top feet MSL

If OWWO: old well information as follows:  
 Operator: \_\_\_\_\_  
 Well Name: \_\_\_\_\_  
 Original Completion Date: \_\_\_\_\_ Original Total Depth: \_\_\_\_\_

Water well within one-quarter mile:  Yes  No  
 Public water supply well within one mile:  Yes  No  
 Depth to bottom of fresh water: 150  
 Depth to bottom of usable water: 200

Directional, Deviated or Horizontal wellbore?  Yes  No  
 If Yes, true vertical depth: \_\_\_\_\_  
 Bottom Hole Location: \_\_\_\_\_  
 KCC DKT #: \_\_\_\_\_

Surface Pipe by Alternate:  1  2  
 Length of Surface Pipe Planned to be set: 50ft  
 Length of Conductor Pipe required: 50ft  
 Projected Total Depth: 1100

Formation at Total Depth: 850wayside  
 Water Source for Drilling Operations:  
 Well  Farm Pond  Other tank truck  
 DWR Permit #: \_\_\_\_\_

(Note: Apply for Permit with DWR )  
 Will Cores be taken?  Yes  No  
 If Yes, proposed zone: \_\_\_\_\_

AFFIDAVIT

The undersigned hereby affirms that the drilling, completion and eventual plugging of this well will comply with K.S.A. 55 et. seq.  
 It is agreed that the following minimum requirements will be met:

1. Notify the appropriate district office **prior** to spudding of well;
2. A copy of the approved notice of intent to drill **shall be** posted on each drilling rig;
3. The minimum amount of surface pipe as specified below **shall be set** by circulating cement to the top; in all cases surface pipe **shall be set** through all unconsolidated materials plus a minimum of 20 feet into the underlying formation.
4. If the well is dry hole, an agreement between the operator and the district office on plug length and placement is **necessary prior to plugging**;
5. The appropriate district office will be notified before well is either plugged or production casing is cemented in;
6. If an ALTERNATE II COMPLETION, production pipe shall be cemented from below any usable water to surface within **120 days** of spud date.  
 Or pursuant to Appendix "B" - Eastern Kansas surface casing order #133,891-C, which applies to the KCC District 3 area, alternate II cementing must be completed within 30 days of the spud date or the well shall be plugged. **In all cases, NOTIFY district office** prior to any cementing.

I hereby certify that the statements made herein are true and to the best of my knowledge and belief.

Date: 10-26-06 Signature of Operator or Agent: Jordan Wilson Title: President

For KCC Use ONLY  
 API # 15 - 125-31250-0000  
 Conductor pipe required None feet  
 Minimum surface pipe required 20 feet per Alt. XO 2  
 Approved by RWH 10-31-06  
 This authorization expires: 4-30-07  
 (This authorization void if drilling not started within 6 months of approval date.)  
 Spud date: \_\_\_\_\_ Agent: \_\_\_\_\_

Remember to:  
 - File Drill Pit Application (form CDP-1) with Intent to Drill;  
 - File Completion Form ACO-1 within 120 days of spud date;  
 - File acreage attribution plat according to field proration orders;  
 - Notify appropriate district office 48 hours prior to workover or plug;  
 - Submit plugging report (CP-4) after plugging is completed;  
 - Obtain written approval before disposing or injecting salt water.  
 - If this permit has expired (See: authorized expiration date) please check the box below and return to the address below.  
 Well Not Drilled - Permit Expired  
 Signature of Operator or Agent: \_\_\_\_\_  
 Date: \_\_\_\_\_

RECEIVED  
 OCT 30 2006  
 KCC WICHITA  
 RECEIVED  
 OCT 23 2006  
 KCC WICHITA

Mail to: KCC - Conservation Division, 130 S. Market - Room 2078, Wichita, Kansas 67202

**IN ALL CASES PLOT THE INTENDED WELL ON THE PLAT BELOW**

*Plat of acreage attributable to a well in a prorated or spaced field*

**If the intended well is in a prorated or spaced field, please fully complete this side of the form.** If the intended well is in a prorated or spaced field complete the plat below showing that the well will be properly located in relationship to other wells producing from the common source of supply. Please show all the wells and within 1 mile of the boundaries of the proposed acreage attribution unit for gas wells and within 1/2 mile of the boundaries of the proposed acreage attribution unit for oil wells.

API No. 15 - 125-31250-0000  
Operator: Jordan Wilson  
Lease: Clarkson 41  
Well Number: 5  
Field: Jefferson-Sycamore

Location of Well: County: Montgomery  
1000 feet from  N /  S Line of Section  
400 feet from  E /  W Line of Section  
Sec. 27 Twp. 33 S. R. 15  East  West

Number of Acres attributable to well: 10  
QTR / QTR / QTR of acreage: 485 - 1555 - 4765  
SE - NE - NE

Is Section:  Regular or  Irregular

**If Section is Irregular, locate well from nearest corner boundary.**

Section corner used:  NE  NW  SE  SW

**PLAT**

*(Show location of the well and shade attributable acreage for prorated or spaced wells.)  
(Show footage to the nearest lease or unit boundary line.)*

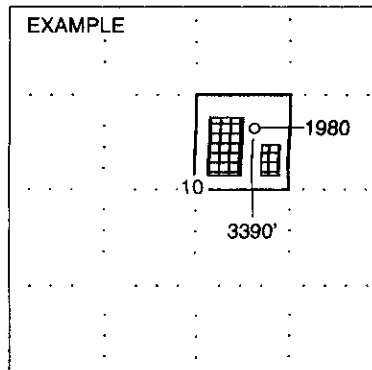
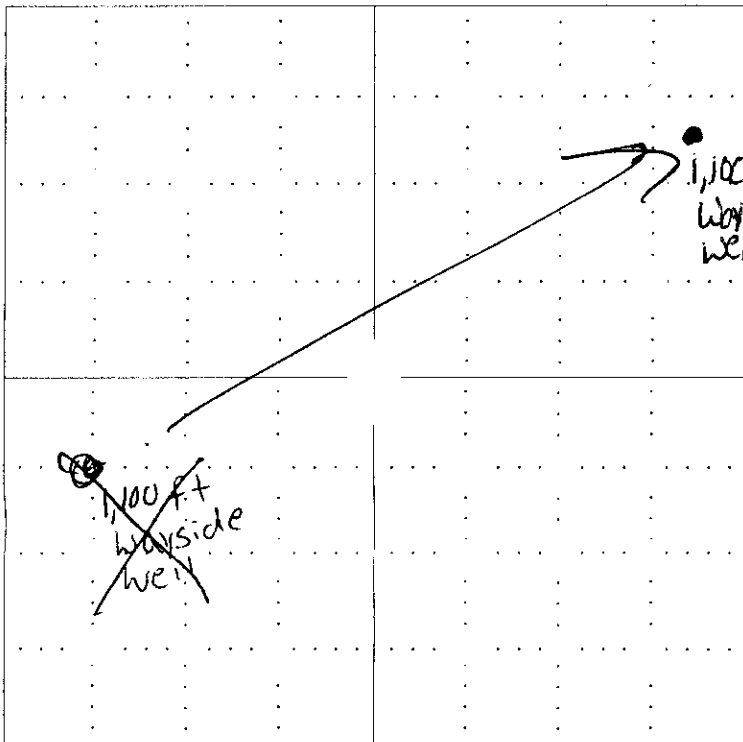

**NOTE: In all cases locate the spot of the proposed drilling location.**

**In plotting the proposed location of the well, you must show:**

1. The manner in which you are using the depicted plat by identifying section lines, i.e. 1 section, 1 section with 8 surrounding sections, 4 sections, etc.
2. The distance of the proposed drilling location from the section's south / north and east / west.
3. The distance to the nearest lease or unit boundary line.
4. If proposed location is located within a prorated or spaced field a certificate of acreage attribution plat must be attached: (CO-7 for oil wells; CG-8 for gas wells).

RECEIVED

OCT 30 2006

KCC WICHITA

RECEIVED

OCT 23 2006

KCC WICHITA

KANSAS CORPORATION COMMISSION  
OIL & GAS CONSERVATION DIVISION  
**APPLICATION FOR SURFACE PIT**

Form CDP-1  
April 2004  
Form must be Typed

*Submit in Duplicate*

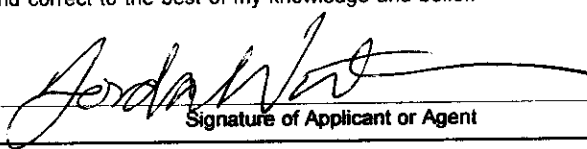
Operator Name: <b>Jordan Wilson</b>		License Number: <b>33181</b>
Operator Address: <b>5994 Palm RD Neosho, Mo. 64850</b>		
Contact Person: <b>Jordan Wilson</b>		Phone Number: ( <b>417</b> ) <b>455 - 3578</b>
Lease Name & Well No.: <b>Clarkson 41 well #5</b>		Pit Location (QQQQ): <b>495</b> <sup>SE</sup> <b>1555</b> <sup>NE</sup> <b>4785</b> <sup>NE</sup> <b>4125</b>
Type of Pit: <input type="checkbox"/> Emergency Pit <input type="checkbox"/> Burn Pit <input type="checkbox"/> Settling Pit <input checked="" type="checkbox"/> Drilling Pit <input type="checkbox"/> Workover Pit <input type="checkbox"/> Haul-Off Pit <small>(If WP Supply API No. or Year Drilled)</small>	Pit is: <input checked="" type="checkbox"/> Proposed <input type="checkbox"/> Existing If Existing, date constructed: _____ Pit capacity: <b>500</b> _____ (bbls)	Sec. <b>27</b> Twp. <b>33</b> R. <b>15</b> <input checked="" type="checkbox"/> East <input type="checkbox"/> West <b>1000</b> Feet from <input checked="" type="checkbox"/> North / <input type="checkbox"/> South Line of Section <b>400</b> Feet from <input checked="" type="checkbox"/> East / <input type="checkbox"/> West Line of Section <b>Montgomery</b> _____ County
Is the pit located in a Sensitive Ground Water Area? <input type="checkbox"/> Yes <input checked="" type="checkbox"/> No		Chloride concentration: <b>N/A</b> _____ mg/l <small>(For Emergency Pits and Settling Pits only)</small>
Is the bottom below ground level? <input type="checkbox"/> Yes <input checked="" type="checkbox"/> No	Artificial Liner? <input type="checkbox"/> Yes <input checked="" type="checkbox"/> No	How is the pit lined if a plastic liner is not used? <b>other</b>
Pit dimensions (all but working pits): <b>15</b> Length (feet) <b>10</b> Width (feet) <b>no</b> N/A: Steel Pits Depth from ground level to deepest point: <b>10</b> (feet)		
If the pit is lined give a brief description of the liner material, thickness and installation procedure. <b>no</b>		Describe procedures for periodic maintenance and determining liner integrity, including any special monitoring. <b>N/A</b>
Distance to nearest water well within one-mile of pit <b>1000</b> feet    Depth of water well <b>300</b> feet		Depth to shallowest fresh water <b>150</b> feet. Source of information: _____ measured <input checked="" type="checkbox"/> well owner    _____ electric log    _____ KDWR
<b>Emergency, Settling and Burn Pits ONLY:</b> Producing Formation: _____ Number of producing wells on lease: _____ Barrels of fluid produced daily: _____ Does the slope from the tank battery allow all spilled fluids to flow into the pit? <input type="checkbox"/> Yes <input type="checkbox"/> No		<b>Drilling, Workover and Haul-Off Pits ONLY:</b> Type of material utilized in drilling/workover: <b>WATER</b> Number of working pits to be utilized: <b>1</b> Abandonment procedure: <b>Bulldozer</b> Drill pits must be closed within 365 days of spud date.
I hereby certify that the above statements are true and correct to the best of my knowledge and belief.		
<b>10-26-06</b> Date	 Signature of Applicant or Agent	<b>RECEIVED</b> <b>OCT 30 2006</b>

15-28-3182-0300

<b>KCC OFFICE USE ONLY</b>			
Date Received: <b>10/23/06</b>	Permit Number: _____	Permit Date: <b>10/23/06</b>	Lease Inspection: <input checked="" type="checkbox"/> <b>RECEIVED</b>

Mail to: KCC - Conservation Division, 130 S. Market - Room 2078, Wichita, Kansas 67202

**OCT 23 2006**  
**KCC WICHITA**