

EFFECTIVE DATE: 9-14-92

State of Kansas

FORM MUST BE TYPE

DISTRICT # 4

NOTICE OF INTENTION TO DRILL

FORM MUST BE SIGNED

SEAT Yes  No

Must be approved by the K.C.C. five (5) days prior to commencing well

ALL BLANKS MUST BE FILLED

Expected Spud Date 9 11 92  
month day year

Spot NW NW SW Sec 10 Twp 10 S Rg 12 East  West

OPERATOR: License # 5184  
Name: Shields Oil Producers, Inc.  
Address: Shields Bldg.  
City/State/Zip: Russell, Kansas 67665  
Contact Person: M. L. Ratts  
Phone: 913-483-3141

2310 feet from South / North line of Section  
330 feet from East / West line of Section  
IS SECTION  REGULAR  IRREGULAR

CONTRACTOR: License #: 5184  
Name: Shields Drilling Company

(NOTE: Locate well on the Section Plat on Reverse Side  
County: Osborne

Well Drilled For: Well Class: Type Equipment:  
 Oil ... Enh Rec ... Infield  Mud Rotary  
 Gas ... Storage ... Pool Ext. ... Air Rotary  
 OWWO ... Disposal  Wildcat ... Cable  
 Seismic; ... # of Holes ... Other  
 Other

Lease Name: Langley Well #: 2  
Field Name: Wildcat

If OWWO: old well information as follows:  
Operator: \_\_\_\_\_  
Well Name: \_\_\_\_\_  
Comp. Date: \_\_\_\_\_ Old Total Depth \_\_\_\_\_

Is this a Prorated/Spaced Field? ... yes  no  
Target Formation(s): Kansas City

Directional, Deviated or Horizontal wellbore? ... yes  no  
If yes, true vertical depth: \_\_\_\_\_  
Bottom Hole Location: \_\_\_\_\_

Nearest lease or unit boundary: 330  
Ground Surface Elevation: 1750 feet MSL

Water well within one-quarter mile: ... yes  no  
Public water supply well within one mile: ... yes  no

Depth to bottom of fresh water: 180  
Depth to bottom of usable water: 580

Surface Pipe by Alternate: 1  2  
Length of Surface Pipe Planned to be set: 200

Length of Conductor pipe required: None  
Projected Total Depth: 3290

Formation at Total Depth: Base KC  
Water Source for Drilling Operations:

... well  farm pond ... other  
DWR Permit #: \_\_\_\_\_

Will Cores Be Taken?: ... yes  no  
If yes, proposed zone: \_\_\_\_\_

AFFIDAVIT

The undersigned hereby affirms that the drilling, completion and eventual plugging of this well will comply with K.S.A. 55-101, et. seq.

It is agreed that the following minimum requirements will be met:

1. Notify the appropriate district office prior to spudding of well;
2. A copy of the approved notice of intent to drill shall be posted on each drilling rig;
3. The minimum amount of surface pipe as specified below shall be set by circulating cement to the top; in all cases surface pipe shall be set through all unconsolidated materials plus a minimum of 20 feet into the underlying formation;
4. If the well is dry hole, an agreement between the operator and the district office on plug length and placement is necessary prior to plugging;
5. The appropriate district office will be notified before well is either plugged or production casing is cemented in;
6. IF AN ALTERNATE IS COMPLETED, PRODUCTION PIPE SHALL BE CEMENTED FROM BELOW ANY USABLE WATER TO SURFACE WITHIN 120 DAYS OF SPUD DATE. IN ALL CASES, NOTIFY DISTRICT OFFICE PRIOR TO ANY CEMENTING.

I hereby certify that the statements made herein are true and to the best of my knowledge and belief.

Date: 9-9-92 Signature of Operator or Agent: M. L. Ratts Title: Prod. Supt.

FOR KCC USE:  
 API # 15- 141-20273-00-00  
 Conductor pipe required None feet  
 Minimum surface pipe required 200' feet per Alt.   
 Approved by: C.B. 9-9-92  
 This authorization expires: 3-9-93  
 (This authorization void if drilling not started within 6 months of effective date.)  
 Spud date: \_\_\_\_\_ Agent: \_\_\_\_\_

REMEMBER TO:

- File Drill Pit Application (form CDP-1) with Intent to Drill;
- File Completion Form ACO-1 within 120 days of spud date;
- File acreage attribution plat according to field proration orders;
- Notify appropriate district office 48 hours prior to workover or re-entry;
- Submit plugging report (CP-6) after plugging is completed;
- Obtain written approval before disposing or injecting salt water.

RECEIVED  
STATE CORPORATION COMMISSION  
9-10-92  
SEP 10 1992  
CONSERVATION DIVISION  
Wichita, Kansas

Mail to: Conservation Division, 200 Colorado Derby Building, 202 W. First St., Wichita, Kansas 67202-1286.

IN ALL CASES PLOT THE INTENDED WELL ON THE PLAT BELOW

PLAT OF ACREAGE ATTRIBUTABLE TO A WELL IN A PRORATED OR SPACED FIELD

If the intended well is in a prorated or spaced field, please fully complete this side of the form. If the intended well is in a prorated or spaced field complete the plat below showing that the well will be properly located in relationship to other wells producing from the common source of supply. Please show all the wells within 1 mile of the boundaries of the proposed acreage attribution unit for gas wells and within 1/2 mile of the boundaries of the proposed acreage attribution unit for oil wells.

API NO. 15- \_\_\_\_\_  
 OPERATOR \_\_\_\_\_ LOCATION OF WELL: COUNTY \_\_\_\_\_  
 LEASE \_\_\_\_\_ feet from south/north line of section  
 WELL NUMBER \_\_\_\_\_ feet from east/west line of section  
 FIELD \_\_\_\_\_ SECTION \_\_\_\_\_ TWP \_\_\_\_\_ RG \_\_\_\_\_

NUMBER OF ACRES ATTRIBUTABLE TO WELL \_\_\_\_\_ IS SECTION \_\_\_\_\_ REGULAR or \_\_\_\_\_ IRREGULAR  
 QTR/QTR/QTR OF ACREAGE \_\_\_\_\_ IF SECTION IS IRREGULAR, LOCATE WELL FROM NEAREST CORNER BOUNDARY.  
 Section corner used: \_\_\_\_\_ NE \_\_\_\_\_ NW \_\_\_\_\_ SE \_\_\_\_\_ SW  
PLAT

(Show location of the well and shade attributable acreage for prorated or spaced wells.)  
 (Show footage to the nearest lease or unit boundary line.)

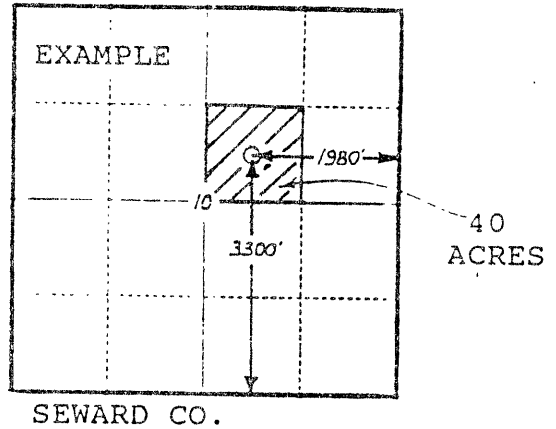
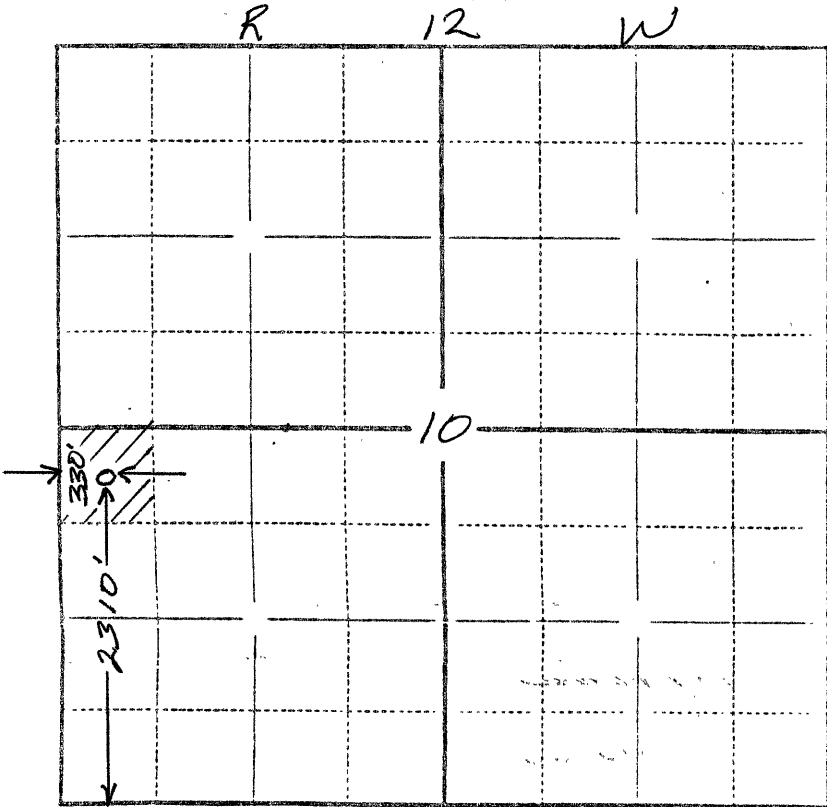

*OSBORNE CO.*

In plotting the proposed location of the well, you must show:

- 1) The manner in which you are using the depicted plat by identifying section lines, i.e. 1 section, 1 section with 8 surrounding sections, 4 sections, etc.;
- 2) the distance of the proposed drilling location from the section's south/north and east/west lines; and
- 3) the distance to the nearest lease or unit boundary line.