

*Corrected



For KCC Use: 11606
Effective Date: 11/07/2006
District # 1
SGA? Yes No

KANSAS CORPORATION COMMISSION
OIL & GAS CONSERVATION DIVISION

1006920

Form C-1
November 2005

Form must be Typed
Form must be Signed
Comments must be Filled

NOTICE OF INTENT TO DRILL **CORRECTED**

Must be approved by KCC five (5) days prior to commencing

Expected Spud Date: 11/07/2006
month day year

OPERATOR: License# 30606
Name: Murfin Drilling Co., Inc.
Address 1: 250 N. Water, Ste 300
Address 2:
City: Wichita State: KS Zip: 67202
Contact Person: Shauna Gunzelman
Phone: 316-267-3241

CONTRACTOR: License# 30606
Name: Murfin Drilling Co., Inc.

Well Drilled For:	Well Class:	Type Equipment:
<input checked="" type="checkbox"/> Oil	<input type="checkbox"/> Enh Rec	<input checked="" type="checkbox"/> Mud Rotary
<input checked="" type="checkbox"/> Gas	<input type="checkbox"/> Storage	<input type="checkbox"/> Air Rotary
	<input type="checkbox"/> Disposal	<input type="checkbox"/> Cable
	<input checked="" type="checkbox"/> Wildcat	
<input type="checkbox"/> Seismic; # of Holes	<input type="checkbox"/> Other	
<input type="checkbox"/> Other:		

If OWWO: old well information as follows:

Operator: _____
Well Name: _____
Original Completion Date: _____ Original Total Depth: _____

Directional, Deviated or Horizontal wellbore? Yes No
If Yes, true vertical depth: _____
Bottom Hole Location: _____
KCC DKT #: _____

Spot Description: _____
N2 - NW - SW Sec. 7 Twp. 32 S. R. 20 E W
2,310 feet from N / S Line of Section
860 feet from E / W Line of Section

Is SECTION: Regular Irregular?
(Note: Locate well on the Section Plat on reverse side)

County: Corniche
Lease Name: Gene Well # - 7
Field Name: Wildcat

Is this a Prorated / Spaced Field? Yes No

Target Formation(s): Morrow, Mississippi

Nearest Lease or unit boundary line (in footage): 660

Ground Surface Elevation: 1921 feet MSL

Water well within one-quarter mile: Yes No

Public water supply well within one mile: Yes No

Depth to bottom of fresh water: 150

Depth to bottom of usable water: 180

Surface Pipe by Alternate: I II

Length of Surface Pipe Planned to be set: 600

Length of Conductor Pipe (if any): 0

Projected Total Depth: 5400

Formation at Total Depth: Mississippi

Water Source for Drilling Operations:

Well Farm Pond Other: _____

DWR Permit #: _____
(Note: Apply for Permit with DWR)

Will Cores be taken? Yes No

If Yes, proposed zone: _____

*Name Change was GAL Unit #2-7
is Gene #1-7

AFFIDAVIT

The undersigned hereby affirms that the drilling, completion and eventual plugging of this well will comply with K.S.A. 55 et. seq.
It is agreed that the following minimum requirements will be met:

1. Notify the appropriate district office prior to spudding of well;
2. A copy of the approved notice of intent to drill shall be posted on each drilling rig;
3. The minimum amount of surface pipe as specified below shall be set by circulating cement to the top; in all cases surface pipe shall be set through all unconsolidated materials plus a minimum of 20 feet into the underlying formation.
4. If the well is dry hole, an agreement between the operator and the district office on plug length and placement is necessary prior to plugging;
5. The appropriate district office will be notified before well is either plugged or production casing is cemented in;
6. If an ALTERNATE II COMPLETION, production pipe shall be cemented from below any usable water to surface within 120 DAYS of spud date. Or pursuant to Appendix "B" - Eastern Kansas surface casing order #133,891-C, which applies to the KCC District 3 area, alternate II cementing must be completed within 30 days of the spud date or the well shall be plugged. In all cases, NOTIFY district office prior to any cementing.

I hereby certify that the statements made herein are true and to the best of my knowledge and belief.

Date: 10/26/06 Signature of Operator or Agent: Shauna Gunzelman Title: Agent

For KCC Use ONLY
API # 15 - 033-21487-0000
Conductor pipe required None feet
Minimum surface pipe required 200 feet per ALT. I II
Approved by: RH 11-06 / RH 11-7-06
This authorization expires: 5-1-07
(This authorization void if drilling not started within 6 months of approval date.)
Spud date: _____ Agent: _____

- Remember to:
- File Drill Pit Application (form GDP-1) with Intent to Drill;
 - File Completion Form ACO-1 within 120 days of spud date;
 - File acreage attribution plat according to field proration orders;
 - Notify appropriate district office 48 hours prior to workover or re-entry;
 - Submit plugging report (CP-4) after plugging is completed (within 60 days);
 - Obtain written approval before disposing or injecting salt water.
- If this permit has expired (See: authorized expiration date) please check the box below and return to the address below.
 Well Not Drilled - Permit Expired Date: _____
Signature of Operator or Agent: _____

Mail to: KCC - Conservation Division, 130 S. Market - Room 2078, Wichita, Kansas 67202

RECEIVED

NOV 01 2006

KCC WICHITA

RECEIVED

NOV 06 2006

KCC WICHITA

7
32
20
 M
 W



1006920

IN ALL CASES PLOT THE INTENDED WELL ON THE PLAT BELOW

Plat of acreage attributable to a well in a prorated or spaced field

CORRECTED

If the intended well is in a prorated or spaced field, please fully complete this side of the form. If the intended well is in a prorated or spaced field complete the plat below showing that the well will be properly located in relationship to other wells producing from the common source of supply. Please show all the wells and within 1 mile of the boundaries of the proposed acreage attribution unit for gas wells and within 1/2 mile of the boundaries of the proposed acreage attribution unit for oil wells.

API No. 15 - 033-21487-0000
 Operator: Murfin Drilling Co., Inc.
 Lease: Gene #1-7
 Well Number: 1-7
 Field: Wildcat

Location of Well: County: Comanche
2,310 feet from N / S Line of Section
660 feet from E / W Line of Section
 Sec. 7 Twp. 32 S. R. 20 E W

Number of Acres attributable to well: _____
 QTR/QTR/QTR/QTR of acreage: _____ - N2 - NW - SW

is Section: Regular or Irregular

If Section is irregular, locate well from nearest corner boundary.
 Section corner used: NE NW SE SW

PLAT

(Show location of the well and shade attributable acreage for prorated or spaced wells.)
 (Show footage to the nearest lease or unit boundary line.)

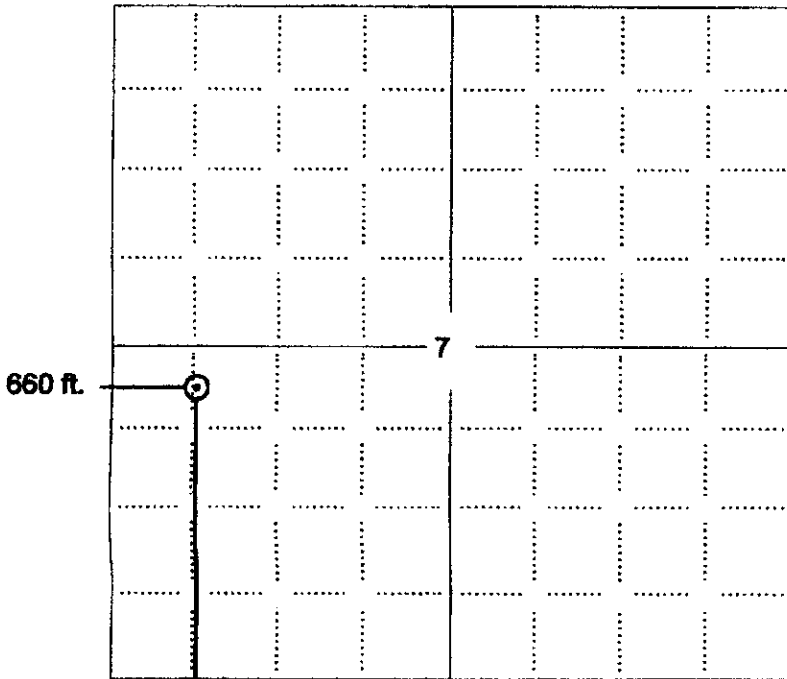

NOTE: In all cases locate the spot of the proposed drilling location.

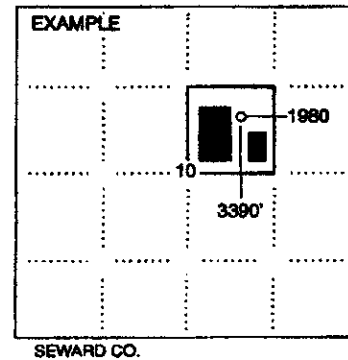

- 2310 ft.**
- In plotting the proposed location of the well, you must show:
1. The manner in which you are using the depicted plat by identifying section lines, i.e. 1 section, 1 section with 8 surrounding sections, 4 sections, etc.
 2. The distance of the proposed drilling location from the south / north and east / west outside section lines.
 3. The distance to the nearest lease or unit boundary line (in footage).
 4. If proposed location is located within a prorated or spaced field a certificate of acreage attribution plat must be attached: (CO-7 for oil wells; CG-8 for gas wells).

RECEIVED
 NOV 06 2006
 KCC WICHITA

Corrected
 Name change
 was GAL Unit #2-7
 is Gene #1-7

KANSAS CORPORATION COMMISSION 1006920
 OIL & GAS CONSERVATION DIVISION
APPLICATION FOR SURFACE PIT

Form GDP-1
 April 2004
 Form must be Typed

Submit in Duplicate

CORRECTED

Operator Name: Murfin Drilling Co., Inc.		License Number: 30606
Operator Address: 250 N. Water, Ste 300		Wichita KS 67202
Contact Person: Shauna Gunzelman		Phone Number: 316-267-3241
Lease Name & Well No.: Gene #1-7		Pit Location (QQQQ): N2 NW SW
Type of Pit: <input type="checkbox"/> Emergency Pit <input type="checkbox"/> Burn Pit <input type="checkbox"/> Settling Pit <input checked="" type="checkbox"/> Drilling Pit <input type="checkbox"/> Workover Pit <input type="checkbox"/> Haul-Off Pit <small>(If WP Supply API No. or Year Drilled)</small>	Pit is: <input checked="" type="checkbox"/> Proposed <input type="checkbox"/> Existing If Existing, date constructed: _____ Pit capacity: 600 (bbls)	Sec. 7 Twp. 32 R. 20 <input type="checkbox"/> East <input checked="" type="checkbox"/> West 2,310 Feet from <input type="checkbox"/> North <input checked="" type="checkbox"/> South Line of Section 660 Feet from <input type="checkbox"/> East <input checked="" type="checkbox"/> West Line of Section Comanche County
Is the pit located in a Sensitive Ground Water Area? <input checked="" type="checkbox"/> Yes <input type="checkbox"/> No		Chloride concentration: _____ mg/l <small>(For Emergency Pits and Settling Pits only)</small>
Is the bottom below ground level? <input checked="" type="checkbox"/> Yes <input type="checkbox"/> No	Artificial Liner? <input type="checkbox"/> Yes <input checked="" type="checkbox"/> No	How is the pit lined if a plastic liner is not used? Bentonite and solids from drilling operation self seal pits
Pit dimensions (all but working pits): 100 Length (feet) 100 Width (feet) <input type="checkbox"/> N/A: Steel Pits Depth from ground level to deepest point: 4 (feet) <input type="checkbox"/> No Pit		
If the pit is lined give a brief description of the liner material, thickness and installation procedure.		Describe procedures for periodic maintenance and determining liner integrity, including any special monitoring.
Distance to nearest water well within one-mile of pit 1378 feet Depth of water well 42 feet		Depth to shallowest fresh water 10 feet. Source of information: <input type="checkbox"/> measured <input type="checkbox"/> well owner <input type="checkbox"/> electric log <input checked="" type="checkbox"/> KDWR
Emergency, Settling and Burn Pits ONLY: Producing Formation: _____ Number of producing wells on lease: _____ Barrels of fluid produced daily: _____ Does the slope from the tank battery allow all spilled fluids to flow into the pit? <input type="checkbox"/> Yes <input type="checkbox"/> No		Drilling, Workover and Haul-Off Pits ONLY: Type of material utilized in drilling/workover: Bentonite Number of working pits to be utilized: 4 Abandonment procedure: Allow pits to evaporate until dry then backfill when conditions allow Drill pits must be closed within 365 days of spud date.
I hereby certify that the above statements are true and correct to the best of my knowledge and belief.		
10/26/06 Date		Shauna Gunzelman Signature of Applicant or Agent
KCC OFFICE USE ONLY		
Date Received: 11/1/06 Permit Number: _____ Permit Date: 11/1/06		RFAC <input checked="" type="checkbox"/> RFAS <input checked="" type="checkbox"/> Lease Inspection: <input type="checkbox"/> Yes <input type="checkbox"/> No

15-033-21487-0000

Mail to: KCC - Conservation Division, 130 S. Market - Room 2078, Wichita, Kansas 67202

RECEIVED
 NOV 8 1 2006

RECEIVED
 NOV 8 5 2006
 KCC WICHITA

KCC WICHITA

KANSAS

CORPORATION COMMISSION

KATHLEEN SEBELIUS, GOVERNOR

BRIAN J. MOLINE, CHAIR

ROBERT E. KREHBIEL, COMMISSIONER

MICHAEL C. MOFFET, COMMISSIONER

October 30, 2006

Ms. Shauna Gunzelman
Murfin Drilling Co., Inc.
250 N. Water Ste 300
Wichita, KS 67202

CORRECTED

RE: Drilling Pit Application Name Change
 GAL Lease Well No. 2-7 is Gene #1-7
 SW/4 Sec. 07-32S-20W
 Comanche County, Kansas

Dear Ms. Gunzelman:

District staff has inspected the above referenced location and has determined that the reserve pit shall be constructed **without slots**, the bottom shall be flat and reasonably level, and **compact the sides and bottom with clay**. The free fluids must be removed. The fluids are to be removed from the reserve pit as soon as the Hutchinson Salt section has been drilled through and displacement of the fluids into the reserve pit has occurred. The fluids should be removed again as soon as practical after drilling operations have ceased.

If production casing is set all completion fluids shall be removed from the working pits daily. NO completion fluids or non-exempt wastes shall be placed in the reserve pit.

The fluids should be taken to an authorized disposal well. Please call the District Office at (620) 225-8888 when the fluids have been removed. Please file form CDP-5 (August 2004), Exploration and Production Waste Transfer, within 30 days of fluid removal. Conservation division forms are available through our office and on the KCC web site: www.kcc.state.ks.us/conservation/forms.

A copy of this letter should be posted in the doghouse along with the approved Intent to Drill. If you have any questions or concerns please feel free to contact the undersigned at the above address.

Sincerely,

Kathy Haynes

Environmental Protection and Remediation Department

cc: S Durrant

Conservation Division, Finney State Office Building, 130 S. Market, Room 207B, Wichita, KS 67202-3802
Voice 316.337.6200 Fax 316.337.6211 www.kcc.state.ks.us

RECEIVED
NOV 06 2006
KCC WICHITA