

For KCC Use: 11-13-06  
 Effective Date: \_\_\_\_\_  
 District # \_\_\_\_\_  
 SGA?  Yes  No

**KANSAS CORPORATION COMMISSION**  
**OIL & GAS CONSERVATION DIVISION**  
**NOTICE OF INTENT TO DRILL**

Form C-1  
 December 2002  
 Form must be Typed  
 Form must be Signed  
 All blanks must be Filled

Must be approved by KCC five (5) days prior to commencing well

Expected Spud Date November 15 2006  
 month day year

OPERATOR: License# KLN 4767  
 Name: Ritchie Exploration, Inc.  
 Address: PO 783188  
 City/State/Zip: Wichita, KS 67278-3188  
 Contact Person: Craig Caulk  
 Phone: 316-691-9500

CONTRACTOR: License# KLN 5822  
 Name: Val Energy, Inc.

<b>Well Drilled For:</b>	<b>Well Class:</b>	<b>Type Equipment:</b>
<input checked="" type="checkbox"/> Oil <input checked="" type="checkbox"/> Enh Rec	<input checked="" type="checkbox"/> Infield	<input checked="" type="checkbox"/> Mud Rotary
<input checked="" type="checkbox"/> Gas <input type="checkbox"/> Storage	<input type="checkbox"/> Pool Ext.	<input type="checkbox"/> Air Rotary
<input type="checkbox"/> OWWO <input type="checkbox"/> Disposal	<input type="checkbox"/> Wildcat	<input type="checkbox"/> Cable
<input type="checkbox"/> Seismic; # of Holes _____	<input type="checkbox"/> Other _____	
<input type="checkbox"/> Other _____		

If OWWO: old well information as follows:  
 Operator: \_\_\_\_\_  
 Well Name: \_\_\_\_\_  
 Original Completion Date: \_\_\_\_\_ Original Total Depth: \_\_\_\_\_

Directional, Deviated or Horizontal wellbore?  Yes  No

If Yes, true vertical depth: \_\_\_\_\_

Bottom Hole Location: \_\_\_\_\_

KCC DKT #: \_\_\_\_\_

Oil & Gas Leases Attached.

Spot 236'N + 15'E of  East  
 N/2 - NW - NW Sec. 20 Twp. 27 S. R. 23  West  
94 feet from  N /  S Line of Section  
675 feet from  E /  W Line of Section  
 is SECTION  Regular  Irregular?

(Note: Locate well on the Section Plat on reverse side)

County: Ford  
 Lease Name: Carson 20B Well #: 2  
 Field Name: Carson

Is this a Prorated / Spaced Field?  Yes  No

Target Formation(s): Mississippian

Nearest Lease or unit boundary: 510'

Ground Surface Elevation: 2427.7 feet MSL

Water well within one-quarter mile:  Yes  No

Public water supply well within one mile:  Yes  No

Depth to bottom of fresh water: 260

Depth to bottom of usable water: 820

Surface Pipe by Alternate:  1  2

Length of Surface Pipe Planned to be set: 400'

Length of Conductor Pipe required: 60" of 20" Conductor

Projected Total Depth: 5100'

Formation at Total Depth: Mississippian

Water Source for Drilling Operations:

Well  Farm Pond Other  X

DWR Permit #: \_\_\_\_\_

(Note: Apply for Permit with DWR )

Will Cores be taken?  Yes  No

If Yes, proposed zone: \_\_\_\_\_

**AFFIDAVIT**

The undersigned hereby affirms that the drilling, completion and eventual plugging of this well will comply with K.S.A. 55 et. seq.

It is agreed that the following minimum requirements will be met:

1. Notify the appropriate district office **prior** to spudding of well;
2. A copy of the approved notice of intent to drill **shall be** posted on each drilling rig;
3. The minimum amount of surface pipe as specified below **shall be set** by circulating cement to the top; in all cases surface pipe **shall be set** through all unconsolidated materials plus a minimum of 20 feet into the underlying formation.
4. If the well is dry hole, an agreement between the operator and the district office on plug length and placement is necessary **prior to plugging**;
5. The appropriate district office will be notified before well is either plugged or production casing is cemented in;
6. If an ALTERNATE II COMPLETION, production pipe shall be cemented from below any usable water to surface within **120 days** of spud date.  
 Or pursuant to Appendix "B" - Eastern Kansas surface casing order #133,891-C, which applies to the KCC District 3 area, alternate II cementing must be completed within 30 days of the spud date or the well shall be plugged. **In all cases, NOTIFY district office** prior to any cementing.

I hereby certify that the statements made herein are true and to the best of my knowledge and belief.

Date: November 2, 2006 Signature of Operator or Agent: [Signature] Title: GIS Specialist

**For KCC Use ONLY**

API # 15 - 057-20578-0000

Conductor pipe required None feet

Minimum surface pipe required 280 feet per Alt. Y(2)

Approved by: [Signature] 11-8-06

This authorization expires: 5-8-07  
 (This authorization void if drilling not started within 6 months of effective date.)

Spud date: \_\_\_\_\_ Agent: \_\_\_\_\_

**Remember to:**

- File Drill Pit Application (form CDP-1) with Intent to Drill;
- File Completion Form ACO-1 within 120 days of spud date;
- File acreage attribution plat according to field proration orders;
- Notify appropriate district office 48 hours prior to workover or re-entry;
- Submit plugging report (CP-4) after plugging is completed;
- Obtain written approval before disposing or injecting salt water.
- If this permit has expired (See: authorized expiration date) please check the box below and return to the address below.

Well Not Drilled - Permit Expired  
 Signature of Operator or Agent: \_\_\_\_\_  
 Date: \_\_\_\_\_

Mail to: KCC - Conservation Division, 130 S. Market - Room 2078, Wichita, Kansas 67202

RECEIVED  
 NOV 03 2006  
 KCC WICHITA

20  
 27  
 23W

### IN ALL CASES PLOT THE INTENDED WELL ON THE PLAT BELOW

Plat of acreage attributable to a well in a prorated or spaced field

If the intended well is in a prorated or spaced field, please fully complete this side of the form. If the intended well is in a prorated or spaced field complete the plat below showing that the well will be properly located in relationship to other wells producing from the common source of supply. Please show all the wells and within 1 mile of the boundaries of the proposed acreage attribution unit for gas wells and within 1/2 mile of the boundaries of the proposed acreage attribution unit for oil wells.

API No. 15 - 057-20578-000  
Operator: Ritchie Exploration, Inc.  
Lease: Carson 20B  
Well Number: 2  
Field: \_\_\_\_\_

Number of Acres attributable to well: \_\_\_\_\_  
QTR / QTR / QTR of acreage: N/2 - NW - NW

Location of Well: County: Ford  
94 feet from  N /  S Line of Section  
675 feet from  E /  W Line of Section  
Sec. 20 Twp. 27 S. R. 23  East  West

Is Section:  Regular or  Irregular

If Section is Irregular, locate well from nearest corner boundary.  
Section corner used:  NE  NW  SE  SW

### PLAT

(Show location of the well and shade attributable acreage for prorated or spaced wells.)  
(Show footage to the nearest lease or unit boundary line.)

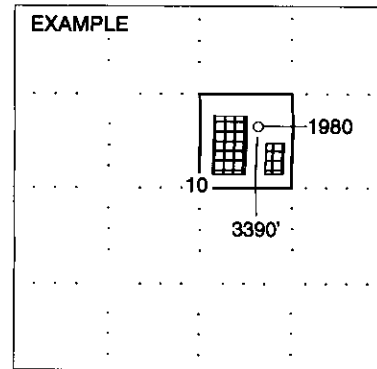
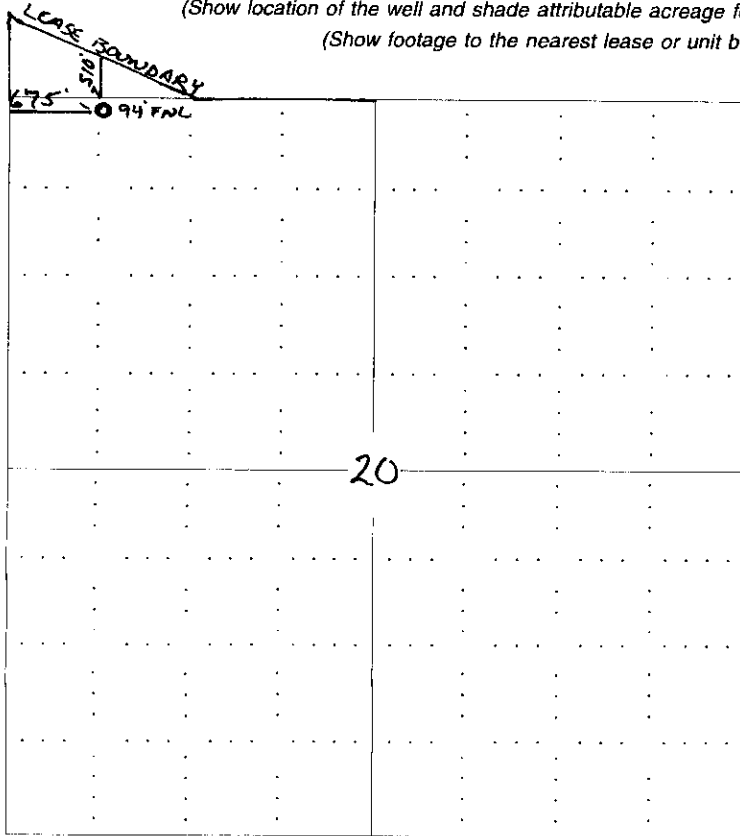

NOTE: In all cases locate the spot of the proposed drilling location.

#### In plotting the proposed location of the well, you must show:

1. The manner in which you are using the depicted plat by identifying section lines, i.e. 1 section, 1 section with 8 surrounding sections, 4 sections, etc.
2. The distance of the proposed drilling location from the section's south / north and east / west.
3. The distance to the nearest lease or unit boundary line.
4. If proposed location is located within a prorated or spaced field a certificate of acreage attribution plat must be attached: (CO-7 for oil wells; CG-8 for gas wells).

RECEIVED

NOV 03 2006

KCC WICHITA

**KANSAS CORPORATION COMMISSION  
OIL & GAS CONSERVATION DIVISION  
APPLICATION FOR SURFACE PIT**

Form GDP-1  
April 2004  
Form must be Typed

*Submit in Duplicate*

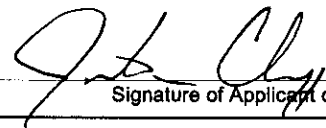
Operator Name: <b>Ritchie Exploration, Inc.</b>		License Number: <b>KLN 4767</b>
Operator Address: <b>PO 783188 Wichita, KS 67278-3188</b>		
Contact Person: <b>John Niernberger</b>		Phone Number: ( <b>316</b> ) <b>691 - 9500</b>
Lease Name & Well No.: <b>#2 Carson 20B</b>		Pit Location (QQQQ): 238°N 15°E <u>  N/2  </u> <u>  NW  </u> <u>  NW  </u>
Type of Pit: <input type="checkbox"/> Emergency Pit <input type="checkbox"/> Burn Pit <input type="checkbox"/> Settling Pit <input checked="" type="checkbox"/> Drilling Pit <input type="checkbox"/> Workover Pit <input type="checkbox"/> Haul-Off Pit <small>(If WP Supply API No. or Year Drilled)</small>	Pit is: <input checked="" type="checkbox"/> Proposed <input type="checkbox"/> Existing If Existing, date constructed: _____ Pit capacity: <b>1602.9</b> (bbls)	Sec. <u>  20  </u> Twp. <u>  27S  </u> R. <u>  23  </u> <input type="checkbox"/> East <input checked="" type="checkbox"/> West <u>  94  </u> Feet from <input checked="" type="checkbox"/> North / <input type="checkbox"/> South Line of Section <u>  675  </u> Feet from <input type="checkbox"/> East / <input checked="" type="checkbox"/> West Line of Section <b>Ford</b> _____ County
Is the pit located in a Sensitive Ground Water Area? <input checked="" type="checkbox"/> Yes <input type="checkbox"/> No		Chloride concentration: _____ mg/l <small>(For Emergency Pits and Settling Pits only)</small>
Is the bottom below ground level? <input checked="" type="checkbox"/> Yes <input type="checkbox"/> No	Artificial Liner? <input type="checkbox"/> Yes <input checked="" type="checkbox"/> No	How is the pit lined if a plastic liner is not used? <b>Bentonite / Chemical Mud</b>
Pit dimensions (all but working pits): <u>  50  </u> Length (feet) <u>  60  </u> Width (feet) <b>N/A: Steel Pits</b> Depth from ground level to deepest point: <u>  3  </u> (feet)		
If the pit is lined give a brief description of the liner material, thickness and installation procedure.		Describe procedures for periodic maintenance and determining liner integrity, including any special monitoring.
Distance to nearest water well within one-mile of pit <u>  550  </u> feet    Depth of water well <u>  115  </u> feet	Depth to shallowest fresh water <u>  13  </u> feet. Source of information: <u>  K H K &amp; C  </u> <input checked="" type="checkbox"/> <u>  1  </u> _____ measured    _____ well owner    _____ electric log    _____ KDWR	
<b>Emergency, Settling and Burn Pits ONLY:</b> Producing Formation: _____ Number of producing wells on lease: _____ Barrels of fluid produced daily: _____ Does the slope from the tank battery allow all spilled fluids to flow into the pit? <input type="checkbox"/> Yes <input type="checkbox"/> No	<b>Drilling, Workover and Haul-Off Pits ONLY:</b> Type of material utilized in drilling/workover: <u>  Fresh / Chemical Mud  </u> Number of working pits to be utilized: <u>  1  </u> Abandonment procedure: <u>  Haul Off Fluids, Dry, Backfill  </u> _____ Drill pits must be closed within 365 days of spud date.	
I hereby certify that the above statements are true and correct to the best of my knowledge and belief.		
<u>  November 2, 2006  </u> Date	 Signature of Applicant or Agent	<b>RECEIVED</b> <b>NOV 9 3 2006</b>
<b>KCC OFFICE USE ONLY</b>		
Date Received: <u>  11/3/06  </u> Permit Number: _____ Permit Date: <u>  11/7/06  </u> Lease Inspection: <input checked="" type="checkbox"/> Yes <input type="checkbox"/> No	<b>KCC WICHITA</b> <i>Steel Pits</i>	

15-057-205 78-0000

Mail to: KCC - Conservation Division, 130 S. Market - Room 2078, Wichita, Kansas 67202

# KANSAS

## CORPORATION COMMISSION

KATHLEEN SEBELIUS, GOVERNOR  
BRIAN J. MOLINE, CHAIR  
ROBERT E. KREHBIEL, COMMISSIONER  
MICHAEL C. MOFFET, COMMISSIONER

November 7, 2006

Mr. Craig Caulk  
Ritchie Exploration, Inc.  
PO Box 783188  
Wichita, KS 67278-3188

Re: Drilling Pit Application  
Carson 20 B Lease Well No. 2  
NW/4 Sec. 20-27S-23W  
Ford County, Kansas

Dear Mr. Caulk:

District staff has inspected the location and has determined that an unsealed condition will present a pollution threat to water resources.

District staff has instructed that no earthen pits are to be used at the location. Steel pits are to be used. Please inform the Commission in writing as to which disposal well you will utilize to dispose of the contents in the steel pits and the amount of fluid that will be disposed. **If a haul-off pit is necessary please file, form CDP-1, Application for Surface Pit.** This location will have to be inspected prior to approval of the haul-off pit application.

If fluids are taken to an authorized disposal well, please call the District Office at (316) 630-4000. Please file form CDP-5, Exploration and Production Waste Transfer, within 30 days of fluid removal. Conservation division forms are available through our office and on the KCC web site: [www.kcc.state.ks.us/conservation/forms](http://www.kcc.state.ks.us/conservation/forms).

Sincerely,

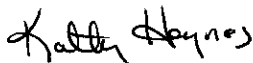

Kathy Haynes  
Environmental Protection and Remediation Department

Cc: File

# KANSAS

CORPORATION COMMISSION

KATHLEEN SEBELIUS, GOVERNOR

BRIAN J. MOLINE, CHAIR

ROBERT E. KREHBIEL, COMMISSIONER

MICHAEL C. MOFFET, COMMISSIONER

## HAUL-OFF PIT APPLICATION FILING REQUIREMENTS

### 82-3-607. DISPOSAL OF DIKE AND PIT CONTENTS.

- (a) Each operator shall perform one of the following when disposing of dike or pit contents:
- (1) Remove the liquid contents to a disposal well or other oil and gas operation approved by the commission or to road maintenance or construction locations approved by the department;
  - (2) dispose of reserve pit waste down the annular space of a well completed according to the alternate I requirements of K.A.R. 82-3-106, if the waste to be disposed of was generated during the drilling and completion of the well; or
  - (3) dispose of the remaining solid contents in any manner required by the commission. The requirements may include any of the following:
    - (A) Burial in place, in accordance with the grading and restoration requirements in K.A.R. 82-3-602 (f);
    - (B) removal and placement of the contents in an on-site disposal area approved by the commission;
    - (C) removal and placement of the contents in an off-site disposal area on acreage owned by the same landowner or to another producing lease or unit operated by the same operator, if prior written permission from the landowner has been obtained; or
    - (D) removal of the contents to a permitted off-site disposal area approved by the department.
- (b) Each violation of this regulation shall be punishable by the following:
- (1) A \$1,000 penalty for the first violation;
  - (2) a \$2,500 penalty for the second violation; and
  - (3) a \$5,000 penalty and an operator license review for the third violation.

### **Complete and return with Haul-Off Pit Application, Form CDP1(2004)**

Haul-off pit will be located in an on-site disposal area:  Yes  No

Haul-off pit is located in an off-site disposal area on acreage owned by the same landowner:  
 Yes  No If yes, written permission from the land owner must be obtained. Attach written permission to haul-off pit application.

Haul-off pit is located in an off-site disposal area on another **producing** lease or unit operated by the same operator:  Yes  No If yes, written permission from the land owner must be obtained. Attach permission and a copy of the lease assignment that covers the acreage where the haul-off pit is to be located, to the haul-off pit application.

Conservation Division, Finney State Office Building, 130 S. Market, Room 2078, Wichita, KS 67202-3802

Voice 316.337.6200 Fax 316.337.6211 www.kcc.state.ks.us