

For KCC Use:  
Effective Date: 5-13-2001  
District #: 4  
SGA?  Yes  No

KANSAS CORPORATION COMMISSION  
OIL & GAS CONSERVATION DIVISION

Form C-1  
September 1999  
Form must be Typed  
Form must be Signed  
All blanks must be Filled

NOTICE OF INTENT TO DRILL

Must be approved by KCC five (5) days prior to commencing well

Expected Spud Date 5 10 2001  
month day year

OPERATOR: License# 5184  
Name: Shields Oil Producers, Inc.  
Address: Shields Bldg.  
City/State/Zip: Russell, KS 67665  
Contact Person: Burton Beery  
Phone: 785-483-3141

CONTRACTOR: License# 5184 99998  
Name: Company Tools

<b>Well Drilled For:</b>	<b>Well Class:</b>	<b>Type Equipment:</b>
<input checked="" type="checkbox"/> Oil	<input type="checkbox"/> Enh Rec	<input checked="" type="checkbox"/> Mud Rotary
<input type="checkbox"/> Gas	<input type="checkbox"/> Storage	<input type="checkbox"/> Air Rotary
<input type="checkbox"/> OWWO	<input type="checkbox"/> Disposal	<input type="checkbox"/> Cable
<input type="checkbox"/> Seismic; # of Holes	<input type="checkbox"/> Wildcat	
<input type="checkbox"/> Other	<input type="checkbox"/> Other	

If OWWO: old well information as follows:  
Operator: \_\_\_\_\_  
Well Name: \_\_\_\_\_  
Original Completion Date: \_\_\_\_\_ Original Total Depth: \_\_\_\_\_  
Directional, Deviated or Horizontal wellbore?  Yes  No  
If Yes, true vertical depth: \_\_\_\_\_  
Bottom Hole Location: \_\_\_\_\_  
KCC DKT #: \_\_\_\_\_

Spot 120' East  East  
NW - SW - NW Sec. 9 Twp. 10 S. R. 12  West  
3630 feet from (S) / N (circle one) Line of Section  
4830 feet from (E) / W (circle one) Line of Section  
Is SECTION  Regular  Irregular?  
*(Note: Locate well on the Section Plat on reverse side)*  
County: Osborne  
Lease Name: Hirst "B" Well #: 1  
Field Name: Fallis SIGLE  
Is this a Prorated / Spaced Field?  Yes  No  
Target Information(s): Kansas City  
Nearest Lease or unit boundary: 330  
Ground Surface Elevation: 1908 feet MSL  
Water well within one-quarter mile:  Yes  No  
Public water supply well within one mile:  Yes  No  
Depth to bottom of fresh water: 250 180  
Depth to bottom of usable water: 650  
Surface Pipe by Alternate: 1  2  
Length of Surface Pipe Planned to be set: 200  
Length of Conductor Pipe required: None  
Projected Total Depth: 3500  
Producing Formation Target: Base Kansas City  
Water Source for Drilling Operations:  
Well \_\_\_\_\_ Farm Pond  Other \_\_\_\_\_  
DWR Permit #: \_\_\_\_\_  
*(Note: Apply for Permit with DWR )*  
Will Cores be taken?  Yes  No  
If Yes, proposed zone: \_\_\_\_\_

AFFIDAVIT

The undersigned hereby affirms that the drilling, completion and eventual plugging of this well will comply with K.S.A. 55-101, et. seq. APR 27 2001  
It is agreed that the following minimum requirements will be met:

1. Notify the appropriate district office **prior** to spudding of well;
2. A copy of the approved notice of intent to drill **shall be** posted on each drilling rig;
3. The minimum amount of surface pipe as specified below **shall be set** by circulating cement to the top; in all cases surface pipe **shall be set** through all unconsolidated materials plus a minimum of 20 feet into the underlying formation.
4. If the well is dry hole, an agreement between the operator and the district office on plug length and placement is necessary **prior to plugging**;
5. The appropriate district office will be notified before well is either plugged or production casing is cemented in;
6. If an ALTERNATE ii COMPLETION, production pipe shall be cemented from below any usable water to surface within **120 days** of spud date. **In all cases, NOTIFY district office** prior to any cementing.

I hereby certify that the statements made herein are true and to the best of my knowledge and belief.

Date: 4-26-01 Signature of Operator or Agent: Burton Beery Title: Drlg. Supt.

CONSERVATION DIVISION  
Wichita, Kansas

RECEIVED  
STATE CORPORATION COMMISSION

**For KCC Use ONLY**  
API # 15 - 141-20351-0000  
Conductor pipe required NONE feet  
Minimum surface pipe required 200 feet per Alt.  (2)  
Approved by: JK 5-8-2001  
This authorization expires: 11-8-2001  
*(This authorization void if drilling not started within 6 months of effective date.)*  
Spud date: \_\_\_\_\_ Agent: \_\_\_\_\_

Remember to:

- File Drill Pit Application (form CDP-1) with Intent to Drill;
- File Completion Form ACO-1 within 120 days of spud date;
- File acreage attribution plat according to field proration orders;
- Notify appropriate district office 48 hours prior to workover or re-entry;
- Submit plugging report (CP-4) after plugging is completed;
- Obtain written approval before disposing or injecting salt water.

Mail to: KCC - Conservation Division, 130 S. Market - Room 2078, Wichita, Kansas 67202

9  
10  
12W

**IN ALL CASES PLOT THE INTENDED WELL ON THE PLAT BELOW**

*Plat of acreage attributable to a well in a prorated or spaced field*

*If the intended well is in a prorated or spaced field, please fully complete this side of the form.* If the intended well is in a prorated or spaced field complete the plat below showing that the well will be properly located in relationship to other wells producing from the common source of supply. Please show all the wells and within 1 mile of the boundaries of the proposed acreage attribution unit for gas wells and within 1/2 mile of the boundaries of the proposed acreage attribution unit for oil wells.

API No. 15 - \_\_\_\_\_  
 Operator: \_\_\_\_\_  
 Lease: \_\_\_\_\_  
 Well Number: \_\_\_\_\_  
 Field: \_\_\_\_\_  
 Number of Acres attributable to well: \_\_\_\_\_  
 QTR / QTR / QTR of acreage: \_\_\_\_\_ - \_\_\_\_\_ - \_\_\_\_\_

Location of Well: County: \_\_\_\_\_  
 \_\_\_\_\_ feet from S / N (circle one) Line of Section  
 \_\_\_\_\_ feet from E / W (circle one) Line of Section  
 Sec. \_\_\_\_\_ Twp. \_\_\_\_\_ S. R. \_\_\_\_\_  East  West  
 Is Section \_\_\_\_\_ Regular or \_\_\_\_\_ Irregular  
**If Section is Irregular, locate well from nearest corner boundary.**  
 Section corner used: \_\_\_NE \_\_\_NW \_\_\_SE \_\_\_SW

**PLAT**

*(Show location of the well and shade attributable acreage for prorated or spaced wells.)  
 (Show footage to the nearest lease or unit boundary line.)*

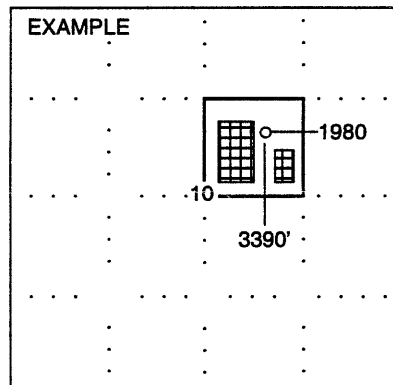
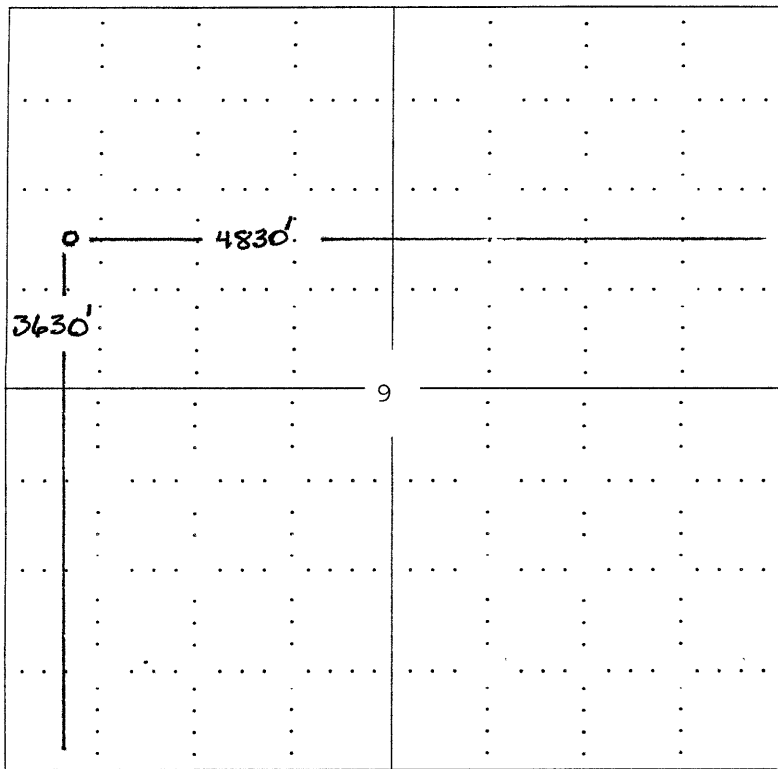

**NOTE: In all cases locate the spot of the proposed drilling location.**

**In plotting the proposed location of the well, you must show:**

1. The manner in which you are using the depicted plat by identifying section lines, i.e. 1 section, 1 section with 8 surrounding sections, 4 sections, etc.
2. The distance of the proposed drilling location from the section's south / north and east / west.
3. The distance to the nearest lease or unit boundary line.
4. If proposed location is located within a prorated or spaced field a certificate of acreage attribution plat must be attached: (CO-7 for oil wells; CG-8 for gas wells).