

EFFECTIVE DATE:

State of Kansas

DISTRICT #

NOTICE OF INTENTION TO DRILL

SGA? Yes  No

Must be approved by the K.C.C. five (5) days prior to commencing well

Expected Spud Date 12 month 1 day 94 year

Spot 150' W of NE SE NE Sec 9 Twp 10 S Rg 12

OPERATOR: License # 5184 Name: Shields Oil Producers, Inc. Address: Shields Bldg. City/State/Zip: Russell, KS 67665 Contact Person: M. L. Ratts Phone: 913-483-3141

3630 feet from South North line of Sect 480 feet from East West line of Sect IS SECTION X REGULAR IRREGULAR?

(NOTE: Locate well on the Section Plat on Reverse Side) County: Osborne Lease Name: Sigle Well #: 4 Field Name: Sigle

CONTRACTOR: License #: 5184 Name: Company Tools

Is this a Prorated/Spaced Field? yes X no Target Formation(s): Kansas City Nearest lease or unit boundary: 330

Table with columns: Well Drilled For, Well Class, Type Equipment. Rows include Oil, Gas, OWD, Seismic, etc.

Ground Surface Elevation: 1780 Water well within one-quarter mile: yes X Public water supply well within one mile: yes X Depth to bottom of fresh water: 200 Depth to bottom of usable water: 600 Surface Pipe by Alternate: 1 X 2 Length of Surface Pipe Planned to be set: 200 Length of Conductor pipe required: None

If OWD: old well information as follows: Operator: Well Name: Comp. Date: Old Total Depth

Projected Total Depth: 3275 Formation at Total Depth: Base KC Water Source for Drilling Operations: well X farm pond oth

Directional, Deviated or Horizontal wellbore? yes X no If yes, true vertical depth: Bottom Hole Location:

DWR Permit #: Will Cores Be Taken? yes X no If yes, proposed zone:

AFFIDAVIT

The undersigned hereby affirms that the drilling, completion and eventual plugging of this well with K.S.A. 101, et. seq.

It is agreed that the following minimum requirements will be met:

- 1. Notify the appropriate district office prior to spudding of well;
2. A copy of the approved notice of intent to drill shall be posted on each drilling rig;
3. The minimum amount of surface pipe as specified below shall be set by circulating cement to the top; in all cases surface pipe shall be set through all unconsolidated materials plus a minimum of 20 feet into the underlying formation;
4. If the well is dry hole, an agreement between the operator and the district office on plug length and placement necessary prior to plugging;
5. The appropriate district office will be notified before well is either plugged or production casing is cemented in;
6. IF AN ALTERNATE II COMPLETION, PRODUCTION PIPE SHALL BE CEMENTED FROM BELOW ANY USABLE WATER TO SURFACE WITHIN 120 DAYS OF SPUD DATE. IN ALL CASES, NOTIFY DISTRICT OFFICE PRIOR TO ANY CEMENTING.

I hereby certify that the statements made herein are true and to the best of my knowledge and belief.

Date: 11-8-94 Signature of Operator or Agent: M. Ratts Title: Supt

FOR KCC USE: API # 15- 141-20289-00-00 Conductor pipe required 7100 feet Minimum surface pipe required 200 feet per Alt. X2 Approved by: 11-9-94 G This authorization expires: 5-9-95 (This authorization void if drilling not started within 6 months of effective date.) Spud date: Agent:

REMEMBER TO:

- File Drill Pit Application (form CDP-1) with Intent to Drill;
- File Completion Form ACO-1 within 120 days of spud date;
- File acreage attribution plat according to field proration orders;
- Notify appropriate district office 48 hours prior to workover or re-entry;
- Submit plugging report (CP-4) after plugging is completed;
- Obtain written approval before disposing or injecting salt water.

Mail to: Conservation Division, 200 Colorado Derby Building, 202 W. First St., Wichita, Kansas 67202-1286.

RECEIVED STATE CORPORATION COMMISSION

NOV 09 1994

9 10 12

IN ALL CASES PLOT THE INTENDED WELL ON THE PLAT BELOW

**PLAT OF ACREAGE ATTRIBUTABLE TO A WELL IN A PRORATED OR SPACED FIELD**

If the intended well is in a prorated or spaced field, please fully complete this side of the form. If the intended well is in a prorated or spaced field complete the plat below showing that the well will be properly located in relationship to other wells producing from the common source of supply. Please show all the wells within 1 mile of the boundaries of the proposed acreage attribution unit for gas wells and within 1/2 mile of the boundaries of the proposed acreage attribution unit for oil wells.

API NO. 15- \_\_\_\_\_  
OPERATOR \_\_\_\_\_  
LEASE \_\_\_\_\_  
WELL NUMBER \_\_\_\_\_  
FIELD \_\_\_\_\_

LOCATION OF WELL: COUNTY \_\_\_\_\_  
\_\_\_\_\_ feet from south/north line of section  
\_\_\_\_\_ feet from east/west line of section  
SECTION \_\_\_\_\_ TWP \_\_\_\_\_ RG \_\_\_\_\_

NUMBER OF ACRES ATTRIBUTABLE TO WELL \_\_\_\_\_  
QTR/QTR/QTR OF ACREAGE \_\_\_\_\_

IS SECTION \_\_\_\_\_ REGULAR or \_\_\_\_\_ IRREGULAR  
IF SECTION IS IRREGULAR, LOCATE WELL FROM NEAREST CORNER BOUNDARY.

Section corner used: \_\_\_\_\_ NE \_\_\_\_\_ NW \_\_\_\_\_ SE \_\_\_\_\_ SW

**PLAT**

(Show location of the well and shade attributable acreage for prorated or spaced wells.)  
(Show footage to the nearest lease or unit boundary line.)

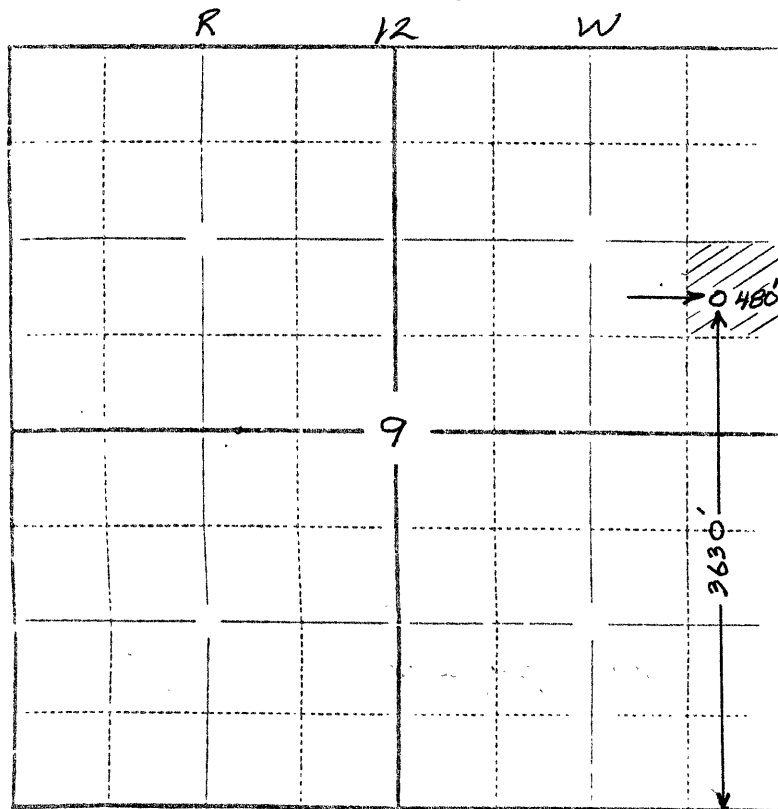

*Osborne Co.*

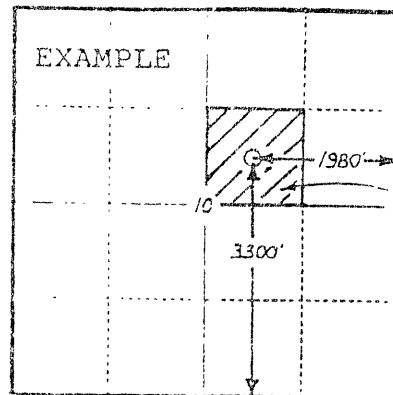

40 ACRES

SEWARD CO.

In plotting the proposed location of the well, you must show:

- 1) The manner in which you are using the depicted plat by identifying section lines, i.e. 1 section, 1 section with 8 surrounding sections, 4 sections, etc.;
- 2) the distance of the proposed drilling location from the section's south/north and east/west lines; and
- 3) the distance to the nearest lease or unit boundary line.