

15-141-20093-00-00

STATE OF KANSAS
STATE CORPORATION COMMISSION
Give All Information Completely
Make Required Affidavit
Mail or Deliver Report to:
Conservation Division
State Corporation Commission
212 North Market, Insurance Bldg.
Wichita, Kansas

WELL PLUGGING RECORD

Osborne County. Sec. 3 Twp. 10S Rge. 15W (W)
Location as "NE/CNW%SW%" or footage from lines SW NW SW
Lease Owner Woodman & Iannitti Oil Company
Lease Name Hobrock Well No. #3
Office Address 1008 Douglas Bldg., 104 South Broadway, Wichita, KS 67202
Character of Well (completed as Oil, Gas or Dry Hole) Dry Hole
Date well completed June 14, 19 81
Application for plugging filed Yes 19
Application for plugging approved 19
Plugging commenced 19
Plugging completed 12:15 P.M., June 14, 19 81
Reason for abandonment of well or producing formation

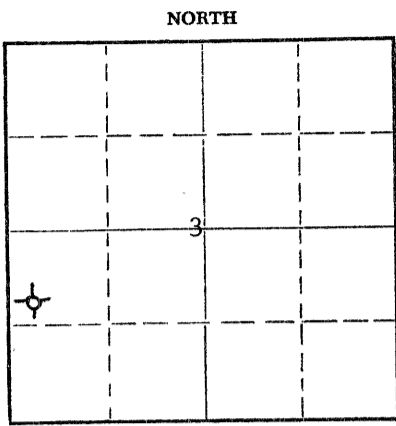

Locate well correctly on above Section Plat

If a producing well is abandoned, date of last production 19
Was permission obtained from the Conservation Division or its agents before plugging was commenced? Yes

Name of Conservation Agent who supervised plugging of this well Gilbert Toman
Producing formation Depth to top Bottom Total Depth of Well Feet
Show depth and thickness of all water, oil and gas formations.

OIL, GAS OR WATER RECORDS

CASING RECORD

FORMATION	CONTENT	FROM	TO	SIZE	PUT IN	PULLED OUT

Describe in detail the manner in which the well was plugged, indicating where the mud fluid was placed and the method or methods used in introducing it into the hole. If cement or other plugs were used, state the character of same and depth placed, from feet to feet for each plug set.

Plug #1 @ 830' w/50 sx. cement
Plug #2 @ 250' w/30 sx. cement
Plug #3 @ 40' w/10 sx. cement

Received
6-19-81

(If additional description is necessary, use BACK of this sheet)

Name of Plugging Contractor John O. Farmer, Inc.
Address P.O. Box 352, Russell, KS 67665

STATE OF Kansas, COUNTY OF Russell, ss.
John O. Farmer III (Employee of Owner) or (owner or operator) of the above-described well, being first duly sworn on oath, says: That I have knowledge of the facts, statements, and matters herein contained and the log of the above-described well as filed and that the same are true and correct. So help me God.

(Signature) John O. Farmer
P.O. Box 352, Russell, KS 67665
(Address)

SUBSCRIBED AND SWORN TO before me this 17th day of June, 19 81

Margaret A. Schulte
Margaret A. Schulte Notary Public.

January 27, 1985



KANSAS DRILLERS LOG

S. 3 T. 10S R. 15W ^{EX}_W

API No. 15 — 141 — 20,093-00-00
 County Number

Loc. SW NW SW
 County Osborne

Operator
Woodman & Iannitti Oil Company

Address
1008 Douglas Bldg., 104 South Broadway, Wichita, KS 67202

Well No. #3 Lease Name Hobrock

Footage Location
990 feet from (N) ~~E~~ line 330 feet from ~~E~~ (W) line

Principal Contractor John O. Farmer, Inc. Geologist John L. James

Spud Date 6-5-81 Total Depth 3625' P.E.T.D.

Date Completed 6-14-81 Oil Purchaser

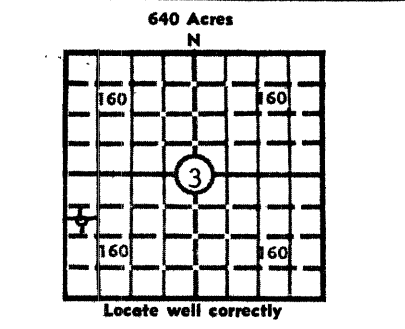

Elev.: Gr. _____
 DF _____ KB 2008

CASING RECORD

Report of all strings set — surface, intermediate, production, etc.

Purpose of string	Size hole drilled	Size casing set (in O.D.)	Weight lbs/ft.	Setting depth	Type cement	Sacks	Type and percent additives
Surface	12-1/4"	8-5/8"	24	241'	Common	175	

LINER RECORD

PERFORATION RECORD

Top, ft.	Bottom, ft.	Sacks cement	Shots per ft.	Size & type	Depth interval'

TUBING RECORD

Size	Setting depth	Packer set at

ACID, FRACTURE, SHOT, CEMENT SQUEEZE RECORD

Amount and kind of material used	Depth interval treated

RECEIVED
 STATE CORPORATION COMMISSION

JUN 19 1981

INITIAL PRODUCTION

6-19-81
 CONSERVATION DIVISION
 Wichita, Kansas

Date of first production _____ Producing method (flowing, pumping, gas lift, etc.) _____

RATE OF PRODUCTION PER 24 HOURS
 Oil _____ bbls. Gas _____ MCF bbls. Water _____ Gas-oil ratio _____ CFPB

Disposition of gas (vented, used on lease or sold) _____ Producing interval (s) _____

INSTRUCTIONS: As provided in KCC Rule 82-2-125, within 90 days after completion of a well, one completed copy of this Drillers Log shall be transmitted to the State Geological Survey of Kansas, 4150 Monroe Street, Wichita, Kansas 67209. Copies of this form are available from the Conservation Division, State Corporation Commission, 3830 So. Meridian (P.O. Box 17027), Wichita, Kansas 66217. Phone AC 316-522-2206. If confidential custody is desired, please note Rule 82-2-125. Drillers Logs will be on open file in the Oil and Gas Division, State Geological Survey of Kansas, Lawrence, Kansas 66044.

Operator Woodman & Iannitti Oil Company DESIGNATE TYPE OF COMP.: OIL, GAS, DRY HOLE, SWDW, ETC.:

Well No. #3 Lease Name Hobrock Dry Hole

S 3 T 10S R 15W K W

WELL LOG

Show all important zones of porosity and contents thereof; cored intervals, and all drill-stem tests, including depth interval tested, cushion used, time tool open, flowing and shut-in pressures, and recoveries.

SHOW GEOLOGICAL MARKERS, LOGS RUN, OR OTHER DESCRIPTIVE INFORMATION.

FORMATION DESCRIPTION, CONTENTS, ETC.	TOP	BOTTOM	NAME	DEPTH
Surface Clay & Rock	0	95		
Blue Shale	95	241		
Shale & Sand	241	900		
Red Bed	900	1200		
Anhydrite	1200	1410		
Shale & Lime	1410	1910		
Lime & Shale	1910	2085		
Shale & Lime	2085	2370		
Lime & Shale	2370	2515		
Shale & Lime	2515	2790		
Lime & Shale	2790	3278		
Lime	3278	3530		
Lime & Shale	3530	3625		
DST #1 3214-78 Open 15 & 30 Recovered 90' mud, IFP 83-95, FBHP 850				
DST #2 3332-55 Open 20 & 30 Recovered 185' watery mud IFP 36-118, FBHP 1049				
DST #3 3387-3445 Open 60 & 30 Recovered 15' watery mud IFP 40-59, FBHP 415				
DST #4 3610-25 Open 30,30,30,30 Recovered 1360' salt water IFP 59-403, IBHP 932 FFP 438-603 FBHP 920				
Topeka	2941			
Heebner	3180			
Toronto	3202			
Lansing	3222	-1225	10' low	
Cong. Sand	3600	-1602	14' low	

USE ADDITIONAL SHEETS, IF NECESSARY, TO COMPLETE WELL RECORD.

Date Received _____
 Signature John D. Farmer III
 Vice-President
 Title
 June 17, 1981
 Date