

Amended

**CORRECTED**  
API 15-165-21806-0000 **\*CORRECTED** - well No. & footage  
**\*CORRECTED** was well No. 4- is well No. 5  
**\*CORRECTED** was 1840' FSL- is 1870' FSL

For KCC Use:  
Effective Date: 10-17-06  
District #: 1  
SGA?  Yes  No

**KANSAS CORPORATION COMMISSION  
OIL & GAS CONSERVATION DIVISION  
NOTICE OF INTENT TO DRILL**

**2ND  
CORRECTED**

Form C-1  
December 2002  
Form must be Typed  
Form must be Signed  
Blank must be Filled

Must be approved by KCC five (5) days prior to commencing well

Expected Spud Date: DEC. 5 2006  
month day year

**\* WAS 210' N SW-NE-SW  
IS: 220' N SW-NE-SW**  
Spot 220 NSW NE SW Sec. 30 Twp. 18 S. R. 17  
 East  West  
**\* 1870** feet from  N /  S Line of Section  
**\* 1650** feet from  E /  W Line of Section  
Is SECTION  Regular  Irregular?

OPERATOR: License# 3792  
Name: J & D Investments  
Address: 1584 Smokey Hill River Rd.  
City/State/Zip: Hays, Kansas 67601  
Contact Person: Jason Dinges  
Phone: 785-623-8060

CONTRACTOR: License# 33724  
Name: Warren Drilling LLC.

(Note: Locate well on the Section Plat on reverse side)  
County: Rush  
Lease Name: Tammen \* Well #: 5  
Field Name: Rush Center SE  
Is this a Prorated / Spaced Field?  Yes  No  
Target Formation(s): Arbuckle  
Nearest Lease or unit boundary: 330

Well Drilled For: Well Class: Type Equipment:  
 Oil  Enh Rec  Infield  Mud Rotary  
 Gas  Storage  Pool Ext.  Air Rotary  
 OAWO  Disposal  Wildcat  Cable  
 Seismic; # of Holes  Other  
 Other

Ground Surface Elevation: 2030 est feet MSL  
Water well within one-quarter mile:  Yes  No  
Public water supply well within one mile:  Yes  No  
Depth to bottom of fresh water: 73  
Depth to bottom of usable water: 400  
Surface Pipe by Alternate:  1  2  
Length of Surface Pipe Planned to be set: 1100  
Length of Conductor Pipe required: n/a  
Projected Total Depth: 3850  
Formation at Total Depth: Arbuckle

If OWWO: old well information as follows:  
Operator: \_\_\_\_\_  
Well Name: \_\_\_\_\_  
Original Completion Date: \_\_\_\_\_ Original Total Depth: \_\_\_\_\_  
Directional, Deviated or Horizontal wellbore?  Yes  No  
If Yes, true vertical depth: \_\_\_\_\_  
Bottom Hole Location: \_\_\_\_\_  
KCC DKT #: \_\_\_\_\_

Water Source for Drilling Operations:  
 Well  Farm Pond  Other \_\_\_\_\_  
DWR Permit #: \_\_\_\_\_  
(Note: Apply for Permit with DWR )  
Will Cores be taken?  Yes  No  
If Yes, proposed zone: \_\_\_\_\_

**AFFIDAVIT**

The undersigned hereby affirms that the drilling, completion and eventual plugging of this well will comply with K.S.A. 55 et. seq.  
It is agreed that the following minimum requirements will be met:  
1. Notify the appropriate district office **prior** to spudding of well;  
2. A copy of the approved notice of intent to drill **shall be posted** on each drilling rig;  
3. The minimum amount of surface pipe as specified below **shall be set** by circulating cement to the top; in all cases surface pipe **shall be set** through all unconsolidated materials plus a minimum of 20 feet into the underlying formation.  
4. If the well is dry hole, an agreement between the operator and the district office on plug length and placement is necessary **prior to plugging**;  
5. The appropriate district office will be notified before well is either plugged or production casing is cemented in;  
6. If an ALTERNATE II COMPLETION, production pipe shall be cemented from below any usable water to surface within **120 days** of spud date.  
Or pursuant to Appendix "B" - Eastern Kansas surface casing order #133,891-C, which applies to the KCC District 3 area, alternate II cementing must be completed within 30 days of the spud date or the well shall be plugged. **In all cases, NOTIFY district office** prior to any cementing.

I hereby certify that the statements made herein are true and to the best of my knowledge and belief.  
Date: 11-24-06 Signature of Operator or Agent: Jason Dinges Title: owner

**For KCC Use ONLY**  
API # 15 - 165-21806-0000  
Conductor pipe required None feet  
Minimum surface pipe required 420 feet per Alt. OV  
Approved by: Patt 10-12-06 / PCM 10-13-06 / Pat 11-28-06  
This authorization expires: 4-12-07  
(This authorization void if drilling not started within 6 months of approval date.)  
Spud date: \_\_\_\_\_ Agent: \_\_\_\_\_

**Remember to:**  
- File Drill Pit Application (form GDP-1) with Intent to Drill;  
- File Completion Form ACO-1 within 120 days of spud date;  
- File acreage attribution plat according to field proration orders;  
- Notify appropriate district office 48 hours prior to workover or re-entry;  
- Submit plugging report (CP-4) after plugging is completed;  
- Obtain written approval before disposing or injecting salt water.  
- If this permit has expired (See: authorized expiration date) check the box below and return to the address below.  
 Well Not Drilled - Permit Expired  
Signature of Operator or Agent: \_\_\_\_\_  
Date: \_\_\_\_\_

30-1877W

**RECEIVED**  
NOV 27 2006  
**KCC WICHITA**

**IN ALL CASES PLOT THE INTENDED WELL ON THE PLAT BELOW**

*Plat of acreage attributable to a well in a prorated or spaced field*

*If the intended well is in a prorated or spaced field, please fully complete this side of the form. If the intended well is in a prorated or spaced field complete the plat below showing that the well will be properly located in relationship to other wells producing from the common source of supply. Please show all the wells and within 1 mile of the boundaries of the proposed acreage attribution unit for gas wells and within 1/2 mile of the boundaries of the proposed acreage attribution unit for oil wells.*

API No. 15 - 165-21806-0000  
 Operator: J & D Investments  
 Lease: TAMMEN  
 Well Number: # 5  
 Field: Rush Center SE  
 Number of Acres attributable to well: \_\_\_\_\_  
 QTR / QTR / QTR of acreage: \_\_\_\_\_

Location of Well: County: Rush  
 \_\_\_\_\_ 1870 feet from  N /  S Line of Section  
 \_\_\_\_\_ 1650 feet from  E /  W Line of Section  
 Sec. 30 Twp. 18 S. R. 17  East  West

Is Section:  Regular or  Irregular

**If Section is Irregular, locate well from nearest corner boundary.**

Section corner used:  NE  NW  SE  SW

**PLAT**

*(Show location of the well and shade attributable acreage for prorated or spaced wells.)*

*(Show footage to the nearest lease or unit boundary line.)*

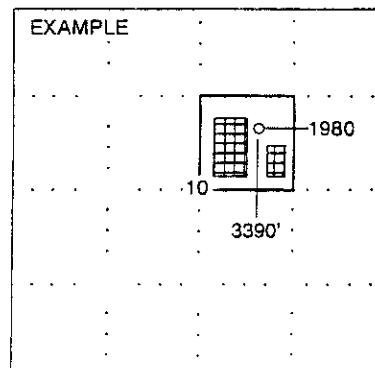
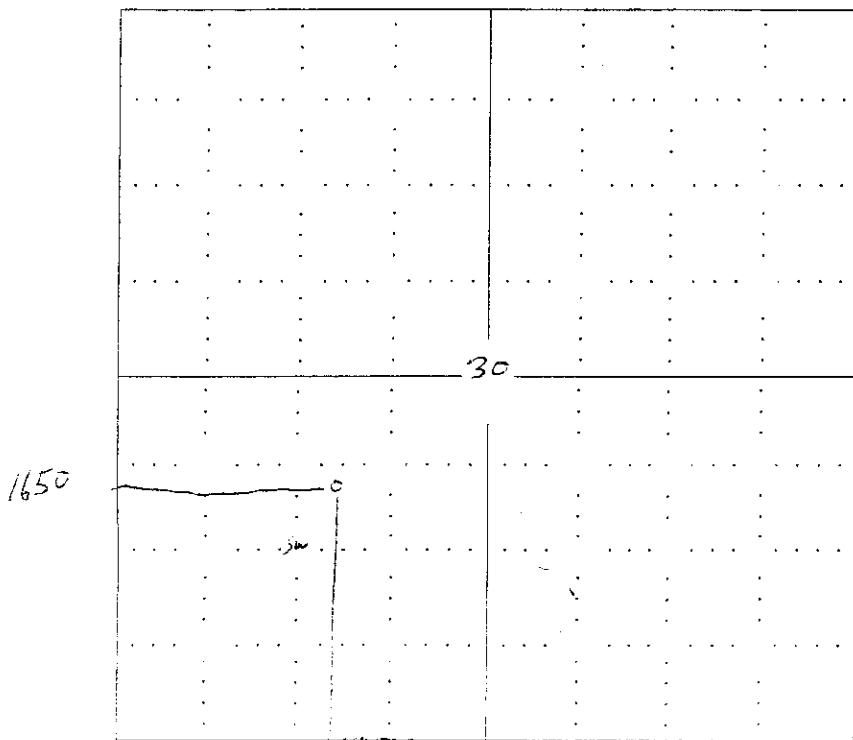

**NOTE: in all cases locate the spot of the proposed drilling locaton.**

**In plotting the proposed location of the well, you must show:**

1. The manner in which you are using the depicted plat by identifying section lines, i.e. 1 section, 1 section with 8 surrounding sections, 4 sections, etc.
2. The distance of the proposed drilling location from the section's south / north and east / west.
3. The distance to the nearest lease or unit boundary line.
4. If proposed location is located within a prorated or spaced field a certificate of acreage attribution plat must be attached: (CO-7 for oil wells; CG-8 for gas wells).

KANSAS CORPORATION COMMISSION  
OIL & GAS CONSERVATION DIVISION  
APPLICATION FOR SURFACE PIT

**\*CORRECTED**

Form GDP-1  
April 2004  
Date must be Typed

Submit in Duplicate

Operator Name: <u>J &amp; D Investments</u>		License Number: <u>3792</u>
Operator Address: <u>1584 Smokey Hill River Rd., Hays, Ks. 67601</u>		
Contact Person: <u>Jason Dinges</u>		Phone Number: ( <u>785</u> ) <u>623-8060</u>
* Lease Name & Well No.: <u>Tammen #5</u>		Pit Location (QQQQ): <u>SW NE SW</u>
Type of Pit: <input type="checkbox"/> Emergency Pit <input type="checkbox"/> Burn Pit <input type="checkbox"/> Settling Pit <input checked="" type="checkbox"/> Drilling Pit <input type="checkbox"/> Workover Pit <input type="checkbox"/> Haul-Off Pit <small>(If WP Supply API No. or Year Drilled)</small>	Pit is: <input checked="" type="checkbox"/> Proposed <input type="checkbox"/> Existing If Existing, date constructed: _____ Pit capacity: _____ (bbls)	Sec. <u>30</u> Twp. <u>18</u> R. <u>17</u> <input type="checkbox"/> East <input checked="" type="checkbox"/> West * <u>1870</u> feet from <input type="checkbox"/> North / <input checked="" type="checkbox"/> South Line of Section <u>1650</u> Feet from <input type="checkbox"/> East / <input checked="" type="checkbox"/> West Line of Section <u>Rush</u> County
Is the pit located in a Sensitive Ground Water Area? <input checked="" type="checkbox"/> Yes <input type="checkbox"/> No		Chloride concentration: _____ mg/l <small>(For Emergency Pits and Settling Pits only)</small>
Is the bottom below ground level? <input checked="" type="checkbox"/> Yes <input type="checkbox"/> No	Artificial Liner? <input type="checkbox"/> Yes <input checked="" type="checkbox"/> No	How is the pit lined if a plastic liner is not used?
Pit dimensions (all but working pits): <u>75</u> Length (feet) <u>75</u> Width (feet)    N/A: Steel Pits Depth from ground level to deepest point: <u>4</u> (feet)		
If the pit is lined give a brief description of the liner material, thickness and installation procedure.		Describe procedures for periodic maintenance and determining liner integrity, including any special monitoring.
Distance to nearest water well within one-mile of pit <u>1575</u> feet    Depth of water well <u>73</u> feet		Depth to shallowest fresh water <u>73</u> feet. Source of information: _____ measured <input checked="" type="checkbox"/> well owner    _____ electric log    _____ KDWR
<b>Emergency, Settling and Burn Pits ONLY:</b> Producing Formation: _____ Number of producing wells on lease: _____ Barrels of fluid produced daily: _____ Does the slope from the tank battery allow all spilled fluids to flow into the pit? <input type="checkbox"/> Yes <input type="checkbox"/> No		<b>Drilling, Workover and Haul-Off Pits ONLY:</b> Type of material utilized in drilling/workover: <u>Drilling mud &amp; cuttings</u> Number of working pits to be utilized: <u>3</u> Abandonment procedure: <u>Haul free water to disposal, let pits dry, backfill with soil, and level location</u> Drill pits must be closed within 365 days of spud date.
I hereby certify that the above statements are true and correct to the best of my knowledge and belief.		
<u>11.27-06</u> Date	<u>Jason Dinges</u> Signature of Applicant or Agent	RECEIVED NOV 27 2006
<b>KCC OFFICE USE ONLY</b>		
Date Received: _____	Permit Number: _____	Permit Date: _____    Lease Inspection: <input type="checkbox"/> Yes <input type="checkbox"/> No