

This form shall be filed in duplicate with the Kansas Corporation Commission, 200 Colorado Derby Building, Wichita, Kansas 67202, within ten days after the completion of the well; regardless of how the well was completed.

Attach separate letter of request if the information is to be held confidential. If confidential, only file one copy. Information on side one will be of public record and side two will then be held confidential.

Circle one: Oil, Gas, Dry, (SWD) OWWO, Injection. Type and complete ALL sections. Applications must be filed for dual completion, commingling, SWD and injection, T.A.

Attach wireline logs (i.e. electrical log, sonic log, gamma ray neutron log, etc.). KCC # (316) 263-3238. (Rules 82-2-105 & 82-2-125)

OPERATOR Graham-Michaelis Corporation

API NO. 15-141-20,132 -00-00

ADDRESS P. O. Box 247  
Wichita, Kansas 67201

COUNTY Osborne

FIELD South Ruggles

\*\*CONTACT PERSON Jack L. Yinger  
PHONE 316-264-8394

PROD. FORMATION

LEASE Greene

PURCHASER

WELL NO. 2 - 27 SWD

ADDRESS

WELL LOCATION W/2 W/2 E/2 SW/4

DRILLING Revlin Drilling, Inc.

1350 Ft. from South Line and

CONTRACTOR

1490 Ft. from West Line of

ADDRESS P. O. Box 293

the SW/4 SEC. 27 TWP. 10S RGE. 15W

Russell, Kansas 67665

WELL PLAT

PLUGGING

CONTRACTOR

ADDRESS

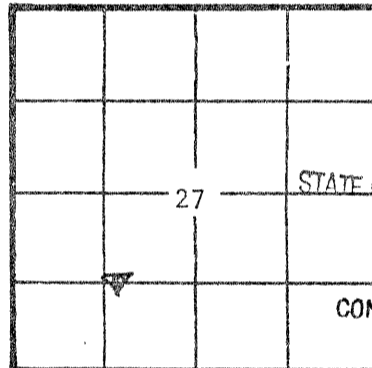

TOTAL DEPTH 3700' PBDT

SPUD DATE 4-7-82 DATE COMPLETED 4-18-82

ELEV: GR 1870' DF KB 1875'

DRILLED WITH (CABLE) (ROTARY) (AIR) TOOLS

Amount of surface pipe set and cemented Set @ 265' w/175 sx. DV Tool Used? Yes

KCC  
KGS  
(Office Use)  
Received  
8-30-82  
CONSERVATION DIVISION  
Wichita Kansas

AFFIDAVIT

STATE OF Kansas, COUNTY OF Sedgwick SS, I,

JACK L. YINGER OF LAWFUL AGE, BEING FIRST DULY SWORN UPON HIS OATH,

DEPOSES THAT HE IS VICE PRESIDENT (FOR)(OF) GRAHAM-MICHAELIS CORPORATION

OPERATOR OF THE GREENE LEASE, AND IS DULY AUTHORIZED TO MAKE

THIS AFFIDAVIT FOR AND ON THE BEHALF OF SAID OPERATOR, THAT WELL NO. 2-27 ON

SAID LEASE HAS BEEN COMPLETED AS OF THE 24th DAY OF May, 1982, AND THAT

ALL INFORMATION ENTERED HEREIN WITH RESPECT TO SAID WELL IS TRUE AND CORRECT.

FURTHER AFFIANT SAITH NOT.

SUBSCRIBED AND SWORN BEFORE ME THIS 17th DAY OF June, 1982.

ALDINE M. JOHNSON  
NOTARY PUBLIC  
STATE OF KANSAS  
My Appointment Expires:  
3-19-85

(S) Jack L. Yinger  
Aldine M. Johnson  
NOTARY PUBLIC

MY COMMISSION EXPIRES:

\*\*The person who can be reached by phone regarding any questions concerning this information. Within 45 days of completion, a witnessed initial test by the Commission is required if the well produces more than 25 BOPD or is located in a Basic Order Pool.

Show all important zones of porosity and contents thereof; cored intervals, and all drill-stem tests, including depth interval tested, cushion used, time tool open, flowing and shut-in pressures, and recoveries.

SHOW GEOLOGICAL MARKERS, LOGS RUN, OR OTHER DESCRIPTIVE INFORMATION.

FORMATION DESCRIPTION, CONTENTS, ETC.	TOP	BOTTOM	NAME	DEPTH
Rock	0	40	Log Tops:	
Shale	40	258		
Sand & Shale	258	1176	Heebner	2986 (-1111)
Shale	1176	2020		
Lime	2020	2245	Lansing	3037 (-1162)
Shale & Lime	2245	2790		
Lime	2790	2980	Base K.C.	3298 (-1423)
Lime & Shale	2980	3060		
Lime	3060	3125	Arbuckle	3478 (-1603)
Shale & Lime	3125	3255		
Lime	3255	3382	L.T.D.	3696 (-1821)
Conglomerate	3382	3388	R.T.D.	3700 (-1825)
Sand	3388	3393	Ran Petro-Log	Radiation Guard
Lime & Shale	3393	3444	Log.	
Arbuckle	3444	3540		
Lime	3540	3625		
Arbuckle	3625	3700		
R.T.D.	3700			
DST #1 2752-2790 - Miss run. Packer failure. DST #2 2728-2790 - Miss run. Packer failure. DST #3 2986-3077 - 30-60-45-90. Strong blow in 8 minutes. Recovered 806' muddy water. IFF 116-223#. FFP 262-437#. ISIP 998#. FSIP 911#. BHT 113°.				
DST #4 3106-3125 - 30-60-45-90. Strong blow in 10 minutes. Recovered 496' gas in pipe, 120' gassy muddy oil. IFF 29-38#. FFP 38-38#. ISIP 321#. FSIP 321#.				
DST #5 3191-3255 - 30-30-45-45. Weak blow. Died in 25 minutes. Recovered 45' drilling mud. IFF 48-58#. FFP 68-68#. ISIP 998#. FSIP 920#. BHT 120°.				
DST #6 3356-3388 - 30-30-45-45. Weak blow. Died in 21 minutes. Recovered 30' drilling mud with few oil spots on top of tool.				
DST #7 3372-3390 - 30-60-45-90. Recovered 70' dil cut mud. IFF 40-40#/30". FFP 48-48#/60"; ISIP 773#/45"; FSIP 773#/90". BHT 114°.				
Injecting salt water through open hole Arbuckle from 3529' to 3700'. Ran 2-7/8" fiberglass tubing open ended to 3529'.				

RELEASED

9-1-83  
SEP 01 1983

Report of all strings set— surface, intermediate, production, etc. CASING RECORD (New) or (Used)

Purpose of string	Size hole drilled	Size casing set in O.D.	Weight lbs/ft.	Setting depth	Type cement	Sacks	additives
To protect fresh water	12 1/4"	8-5/8"	24#	265'	Common QuickSet	175	
Production	7-7/8"	5-1/2"	14#	3535'	Common	200	10% Salt
					50-50 Poz	375	6% Gel

FROM CONFIDENTIAL

LINER RECORD

PERFORATION RECORD

Top, ft	Bottom ft	Sacks cement	Shots per ft.	Size & type	Depth interval
TUBING RECORD					
Size	Setting depth	Packer set at			
2-7/8"	3514'				

ACID, FRACTURE, SHOT, CEMENT SQUEEZE RECORD

Amount and kind of material used	Depth interval treated

Date of first production	Producing method (flowing, pumping, gas lift, etc.)	Gravity
--------------------------	---	---------

RATE OF PRODUCTION PER 24 HOURS	Oil	Gas	Water	Gas-oil ratio
	bbls.	bbls.	%	bbls.
Disposition of gas (vented, used on lease or sold)			MCF	CFPB
Perforations				

This form shall be filed in duplicate with the Kansas Corporation Commission, 200 Colorado Derby Building, Wichita, Kansas 67202, within ten days after the completion of the well, regardless of how the well was completed.

Attach separate letter of request if the information is to be held confidential. If confidential, only file one copy. Information on side one will be of public record and side two will then be held confidential.

Circle one: Oil, Gas, Dry, (SWD) OWWO, Injection. Type and complete ALL sections. Applications must be filed for dual completion, commingling, SWD and injection, T.A. Attach wireline logs (i.e. electrical log, sonic log, gamma ray neutron log, etc.). KCC # (316) 263-3238. (Rules 82-2-105 & 82-2-125)

OPERATOR Graham-Michaelis Corporation

API NO. 15-141-20,132 00-00

ADDRESS P. O. Box 247

COUNTY Osborne

Wichita, Kansas 67201

FIELD South Ruggles

\*\*CONTACT PERSON Jack L. Yinger

PROD. FORMATION

PHONE 316-264-8394

LEASE Greene

PURCHASER

WELL NO. 2 - 27 SWD

ADDRESS

WELL LOCATION W/2 W/2 E/2 SW/4

DRILLING Revlin Drilling, Inc.

1350 Ft. from South Line and

CONTRACTOR

1490 Ft. from West Line of

ADDRESS P. O. Box 293

the SW/4 SEC. 27 TWP. 10S RGE. 15W

Russell, Kansas 67665

WELL PLAT

PLUGGING

CONTRACTOR

ADDRESS

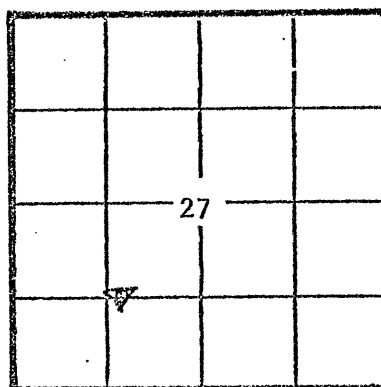

KCC [checked] KGS [checked] (Office Use)

TOTAL DEPTH 3700' PBTD

SPUD DATE 4-7-82 DATE COMPLETED 4-18-82

ELEV: GR 1870' DF KB 1875'

DRILLED WITH (SABER) (ROTARY) (AKR) TOOLS

Amount of surface pipe set and cemented Set @ 265' w/175 sx. DV Tool Used? Yes

AFFIDAVIT

STATE OF Kansas, COUNTY OF Sedgwick SS, I,

JACK L. YINGER OF LAWFUL AGE, BEING FIRST DULY SWORN UPON HIS OATH,

DEPOSES THAT HE IS VICE PRESIDENT (FOR)(OF) GRAHAM-MICHAELIS CORPORATION

OPERATOR OF THE GREENE LEASE, AND IS DULY AUTHORIZED TO MAKE

THIS AFFIDAVIT FOR AND ON THE BEHALF OF SAID OPERATOR, THAT WELL NO. 2-27 ON

SAID LEASE HAS BEEN COMPLETED AS OF THE 24th DAY OF May, 1982, AND THAT

ALL INFORMATION ENTERED HEREIN WITH RESPECT TO SAID WELL IS TRUE AND CORRECT.

FURTHER I SWORN SAITH NOT.

RECEIVED STATE INFORMATION COMMISSION 8-30-82 AUG 30 1982 CONSERVATION DIVISION Wichita, Kansas

SUBSCRIBED AND SWORN BEFORE ME THIS 17th DAY OF June, 1982.

ALDINE M. JOHNSON NOTARY PUBLIC STATE OF KANSAS My Appointment Expires: 3-19-85

(S) Jack L. Yinger Aldine M. Johnson NOTARY PUBLIC

MY COMMISSION EXPIRES:

\*\*The person who can be reached by phone regarding any questions concerning this information. Within 45 days of completion, a witnessed initial test by the Commission is required if the well produces more than 25 BOPD. or is located in a Basic Order Pool.

CONFIDENTIAL

**SIDE TWO**

**WELL LOG**

SHOW GEOLOGICAL MARKERS, LOGS RUN, OR OTHER DESCRIPTIVE INFORMATION.

Show all important zones of porosity and contents thereof; cored intervals, and all drill-stem test including depth interval tested, cushion time tool open, flowing and shut-in pressures, and recovery.

FORMATION DESCRIPTION, CONTENTS, ETC.	TOP	BOTTOM	NAME	DEPTH
Rock	0	40	Log Tops:	
Shale	40	258		
Sand & Shale	258	1176	Heebner	2986 (-1111)
Shale	1176	2020		
Lime	2020	2245	Lansing	3037 (-1162)
Shale & Lime	2245	2790		
Lime	2790	2980	Base K.C.	3298 (-1423)
Lime & Shale	2980	3060		
Lime	3060	3125	Arbuckle	3478 (-1603)
Shale & Lime	3125	3255		
Lime	3255	3382	L.T.D.	3696 (-1821)
Conglomerate	3382	3388	R.T.D.	3700 (-1825)
Sand	3388	3393	Ran Petro-Log	Radiation Guard
Lime & Shale	3393	3444	Log.	
Arbuckle	3444	3540		
Lime	3540	3625		
Arbuckle	3625	3700		
R.T.D.	3700			
DST #1 2752-2790 - Miss run. Packer failure.				
DST #2 2728-2790 - Miss run. Packer failure.				
DST #3 2986-3077 - 30-60-45-90. Strong blow in 8 minutes. Recovered 806' muddy water. IFP 116-223#. FFP 262-437#. ISIP 998#. FSIP 911#. BHT 113°.				
DST #4 3106-3125 - 30-60-45-90. Strong blow in 10 minutes. Recovered 496' gas in pipe, 120' gassy muddy oil. IFP 29-38#. FFP 38-38#. ISIP 321#. FSIP 321.				
DST #5 3191-3255 - 30-30-45-45. Weak blow. Died in 25 minutes. Recovered 45' drilling mud. IFP 48-58#. FFP 68-68#. ISIP 998#. FSIP 920#. BHT 120°.				
DST #6 3356-3388 - 30-30-45-45. Weak blow. Died in 21 minutes. Recovered 30' drilling mud with few oil spots on top of tool.				
DST #7 3372-3390 - 30-60-45-90. Recovered 70' oil cut mud. IFP 40-40#/30". FFP 48-48#/60"; ISIP 773#/45"; FSIP 773#/90". BHT 114°.				
Injecting salt water through open hole Arbuckle from 3529' to 3700'. Ran 2-7/8" fiberglass tubing open ended to 3529'.				

Report of all strings set— surface, intermediate, production, etc. **CASING RECORD** (New) or (Used)

Purpose of string	Size hole drilled	Size casing set in O.D.	Weight lbs/ft.	Setting depth	Type cement	Socks	Type and percent additives
To protect fresh water	12 1/4"	8-5/8"	24#	265'	Common QuickSet	175	
Production	7-7/8"	5-1/2"	14#	3535'	Common	200	10% Salt
					50-50 Poz	375	6% Gel

**LINER RECORD**

**PERFORATION RECORD**

Top, ft.	Bottom ft.	Sacks cement	Shots per ft.	Size & type	Depth interval

TUBING RECORD		
Size	Setting depth	Packer set at
2-7/8"	3514'	

**ACID, FRACTURE, SHOT, CEMENT SQUEEZE RECORD**

Amount and kind of material used	Depth interval treated

Date of first production	Producing method (flowing, pumping, gas lift, etc.)	Gravity
RATE OF PRODUCTION PER 24 HOURS	Oil bbls.	Gas MCF
Disposition of gas (vented, used on lease or sold)	Water %	Gas-oil ratio bbls. CFPR
Perforations		