

STATE CORPORATION COMMISSION OF KANSAS  
OIL & GAS CONSERVATION DIVISION  
WELL COMPLETION OR RECOMPLETION FORM  
ACO-1 WELL HISTORY  
DESCRIPTION OF WELL AND LEASE

5 API NO. 15-141-20,025-00-01  
County Osborne  
Approx. S/2 NW NE 27 Twp. 10S Rge. 15 East  
Sec. 22 Twp. 10S Rge. 15 West

Operator: License # 6600  
Name Don Karst Well Service, Inc.  
Address 201 E. 9th  
City/State/Zip Hays, KS 67601

4380 Ft North from Southeast Corner of Section  
2120 Ft West from Southeast Corner of Section  
(Note: Locate well in section plat below)

Purchaser FARMLAND INDUSTRIES

Lease Name Greene "OWWO" Well #. 1  
Field Name Ruggels, South

Operator Contact Person Don Karst  
Phone 913-483-3958

Producing Formation Conglomerate  
Elevation: Ground 1781 KB 1786

Contractor: License # 8241  
Name Emphasis Oil Operations

Wellsite Geologist David Shumaker  
Phone 913-483-5519

Designate Type of Completion  
New Well Re-Entry Workover  
Oil Gas Dry SWD Inj Other (Core, Water Supply etc.)  
Temp Abd Delayed Comp.

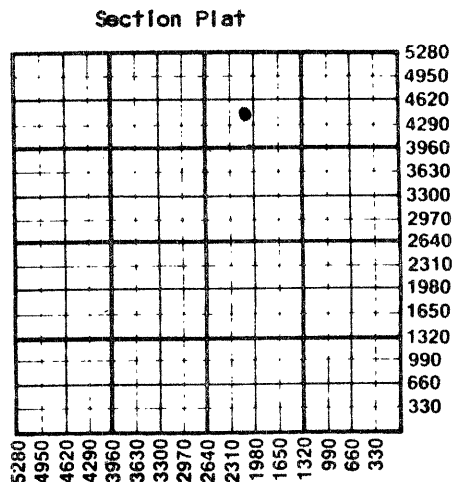

If OWWO: old well info as follows:  
Operator C-G Drilling Co. & H. Rosen Oil Co.  
Well Name Greene  
Comp. Date 10/4/74 Old Total Depth 3340

WATER SUPPLY INFORMATION

Disposition of Produced Water: Disposal  
Docket # Repressuring

WELL HISTORY

Drilling Method: Mud Rotary Air Rotary Cable  
Spud Date 9/25/86 Date Reached TD 9/27/86 Completion Date 10-24-86  
Total Depth 3387' PBTD

Questions on this portion of the ACO-1 call:  
Water Resources Board (913) 296-3717

Source of Water:  
Division of Water Resources Permit #  
Groundwater Ft North from Southeast Corner (Well) Ft West from Southeast Corner of Sec Twp Rge East West  
Surface Water 650 Ft North from Southeast Corner (Stream, pond etc) 1100 Ft West from Southeast Corner Sec 22 Twp 10S Rge 15 East West  
Other (explain) (purchased from city, R.W.D. #)

Amount of Surface Pipe Set and Cemented at 181 feet  
Multiple Stage Cementing Collar Used? Yes No  
If yes, show depth set feet  
If alternate 2 completion, cement circulated from feet depth to w/ SX cmt  
Cement Company Name  
Invoice #

INSTRUCTIONS: This form shall be completed in duplicate and filed with the Kansas Corporation Commission, 200 Colorado Derby Building, Wichita, Kansas 67202, within 90 days after completion or recompletion of any well. Rule 82-3-130 and 82-3-107 apply.  
Information on side two of this form will be held confidential for a period of 12 months if requested in writing and submitted with the form. See rule 82-3-107 for confidentiality in excess of 12 months.  
One copy of all wireline logs and drillers time log shall be attached with this form. Submit CP-4 form with all plugged wells. Submit CP-111 form with all temporarily abandoned wells.

All requirements of the statutes, rules and regulations promulgated to regulate the oil and gas industry have been fully complied with and the statements herein are complete and correct to the best of my knowledge.

Signature Donald D. Karst  
Title Owner Date 1-2-87

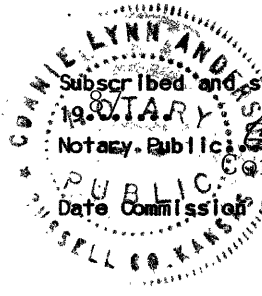

Subscribed and sworn to before me this 2nd day of January 1987  
Notary Public Connie Lynn Anderson  
Date Commission Expires 3-29-87

Received  
1-9-87  
JAN 9 1987

K.C.C. OFFICE USE ONLY  
F Letter of Confidentiality Attached  
C Wireline Log Received  
C Drillers Timelog Received  
Distribution  
KCC SWD/Rep NGPA  
KGS Plug Other  
(Specify)

Sec 27 Twp 10 Rge 15 W

SIDE TWO

Operator Name ..... Don Karst Well Service, Inc. .... Lease Name..... Greene "OWWO"..... Well #...1.....

Sec..... 27 ..... Twp..... 10S ..... Rge..... 15 .....  East  West County..... Osborne.....

WELL LOG

INSTRUCTIONS: Show important tops and base of formations penetrated. Detail all cores. Report all drill stem tests giving interval tested, time tool open and closed, flowing and shut-in pressures, whether shut-in pressure reached static level, hydrostatic pressures, bottom hole temperature, fluid recovery, and flow rates if gas to surface during test. Attach extra sheet if more space is needed. Attach copy of log.

Drill Stem Tests Taken  Yes  No  
 Samples Sent to Geological Survey  Yes  No  
 Cores Taken  Yes  No

Formation Description  
 Log  Sample

Name	Top	Bottom
Anhydrite	+872	
Grd Haven	-581	
Dry Shale	-591	
Dover	-612	
Langsdon Shale	-615	
Tarkio Lime	-651	
Willard Shale	-678	
Elmont Lime	-710	
Topeka	-865	
Heebner	-1112	
Toronto	-1134	
LKC	-1160	
BKC	-1424	
Conglomerate	-1512	
Sandy Congl.	-1517	
Old LTD	-1549	
New LTD	-1599	

CASING RECORD <input type="checkbox"/> New <input type="checkbox"/> Used							
Report all strings set-conductor, surface, intermediate, production, etc.							
Purpose of String	Size Hole Drilled	Size Casing Set (in O.D.)	Weight Lbs/Ft.	Setting Depth	Type of Cement	#Sacks Used	Type and Percent Additives
Surface	previously set			181			
Production	7-7/8"	5-1/2"		3377	60/40 poz	150	10% salt, 5% gilsonit
PERFORATION RECORD				Acid, Fracture, Shot, Cement Squeeze Record			
Shots Per Foot	Specify Footage of Each Interval Perforated			(Amount and Kind of Material Used)		Depth	
2	3000-3004'			1500 Gal NS 15%		4'	
2	2984-2987'			Retreat 4000 gal 28% NE		3'	
2	2690 1/2 - 2695 1/2'			2250 gal 28% NE		5'	
TUBING RECORD				Liner Run <input type="checkbox"/> Yes <input type="checkbox"/> No			
Size		Set At		Packer at			
2-3/8"		3286'					
Date of First Production		Producing Method					
10-24-86		<input type="checkbox"/> Flowing <input checked="" type="checkbox"/> Pumping <input type="checkbox"/> Gas Lift <input type="checkbox"/> Other (explain).....					
Estimated Production Per 24 Hours		Oil	Gas	Water	Gas-Oil Ratio	Gravity	
		2 1/2	nil	17			
		Bbls	MCF	Bbls	CFPB		

METHOD OF COMPLETION

Production Interval

Disposition of gas:  Vented  Open Hole  Perforation  
 Sold  Other (Specify) .....  
 Used on Lease  Dually Completed  
 Commingled

Conglomerate  
 .....

EMPHASIS OIL OPERATIONS

P. O. Box 506  
Russell, KS 67665

DRILLERS LOG

OPERATOR: Don Karst Well Service, Inc.  
201 E. 9th  
Hays, KS 67601

CONTRACTOR: Emphasis Oil Operations  
Box 506  
Russell, KS 67665

LEASE: Greene "OWWO"

WELL #1

LOCATION: Approx. S/2 NW NE  
Section 27-10S-15W  
Osborne County, Kansas

Rotary Total Depth: 3387'

Elevation: 1786' K.B.

Commenced: 9/25/86

Completed: 9/27/86

Casing: 8-5/8" previously set @ 181'

Status: Oil Well

DEPTHS & FORMATIONS

(All measurements from K.B.)

Cement	60'	Cavings & Cement	520'
Mud	90'	Cement	575'
Cement	190'	Cavings	3345'
Cavings & Mud	420'	Lime (R.T.D.)	3387'

STATE OF KANSAS )  
                          ) ss  
COUNTY OF RUSSELL)

Kyle B. Branum, of Emphasis Oil Operations, states that the above and foregoing is a true and correct log of the above captioned well, to the best of his knowledge.

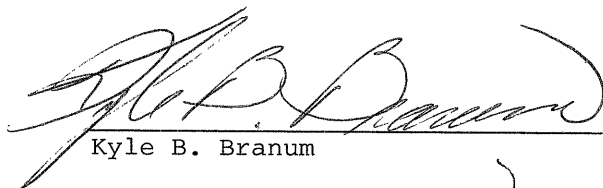
  
Kyle B. Branum

Subscribed and sworn to before me this 29th of September, 1986.  
My Commission Expires: July 29, 1989.

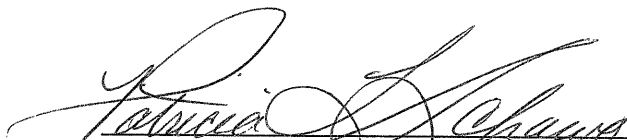
  
Patricia L. Schawo, Notary Public

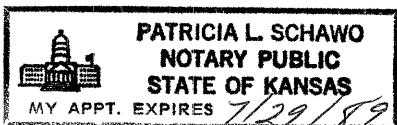

STATE CORPORATION COMMISSION

JAN 9 1987

CONSERVATION DIVISION  
Wichita, Kansas