

STATE OF KANSAS
STATE CORPORATION COMMISSION

WELL PLUGGING RECORD

Give All Information Completely
Make Required Affidavit
Mail or Deliver Report to
Conservation Division
State Corporation Comm.
245 North Water
Wichita, KS 67202

Rooks County. Sec. 30 Twp. 9S Rge. 17W E/W
Location as "NE/CNW $\frac{1}{4}$ SW $\frac{1}{4}$ " or footage from lines
SW/4 SW/4 SE/4

Lease Owner Frontier Oil Company
Lease Name Garvert Well No. 1
Office Address 1720 KSB&T Building, Wichita, Ks. 67202
Character of Well (Completed as Oil, Gas or Dry Hole)

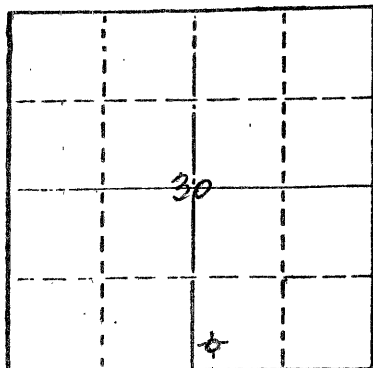

Locate well correctly on above
Section Plat

D & A
Date Well completed June 5, 1980
Application for plugging filed June 5, 1980
Application for plugging approved June 5, 1980
Plugging commenced June 6, 1980
Plugging completed June 6, 1980
Reason for abandonment of well or producing formation

D & A
If a producing well is abandoned, date of last production 19

Was permission obtained from the Conservation Division or its agents before plugging was commenced? Yes

Name of Conservation Agent who supervised plugging of this well Leo F. Massey

Producing formation _____ Depth to top _____ Bottom _____ Total Depth of Well 3,633'

Show depth and thickness of all water, oil and gas formations.

OIL, GAS OR WATER RECORDS

CASING RECORD

FORMATION	CONTENT	FROM	TO	SIZE	PUT IN	PULLED OUT
				8 5/8"	280'	-0-

Describe in detail the manner in which the well was plugged, indicating where the mud fluid was placed and the method or methods used in introducing it into the hold. If cement or other plugs were used, state the character of same and depth placed, from _____ feet to _____ feet for each plug set.

Plug #1 @ 740' w/70 sx cement
#2 @ 240' w/20 sx cement
Bridge @ 40' w/10 sx cement
5 sx cement in rathole

RECEIVED
STATE CORPORATION COMMISSION

AUG - 5 1980
8-5-80
CONSERVATION DIVISION
Wichita, Kansas

(If additional description is necessary, use BACK of this sheet)

Name of Plugging Contractor Red Tiger Drilling Company
1720 KSB&T Building, Wichita, Kansas 67202

STATE OF Kansas COUNTY OF Sedgwick, ss.
Gloria Fawcett (employee of owner) ~~owner or operator~~

of the above-described well, being first duly sworn on oath, says: That I have knowledge of the facts, statements, and matters herein contained and the log of the above-described well as filed and that the same are true and correct. So help me God.

(Signature) Gloria Fawcett
1720 KSB&T Building, Wichita, Ks. 67202
(Address)

SUBSCRIBED AND SWORN TO before me this 10th day of June, 1980.

My commission expires _____

Joyce A. Hagermann
Notary Public.

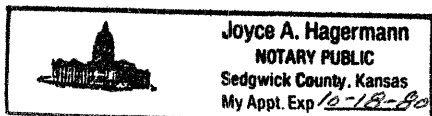

KANSAS

WELL COMPLETION REPORT AND
DRILLER'S LOG

API No. 15 — 163 — 21,075-00-00
County Number

S. 30 T. 9S R. 17W E
W
Loc. SW/4 SW/4 SE/4
County Rooks

Operator
Frontier Oil Company

Address
1720 KSB&T Building, Wichita, Ks. 67202

Well No. 1 Lease Name Garvert

Footage Location
feet from (N) (S) line feet from (E) (W) line

Principal Contractor Red Tiger Drilling Co. Geologist Richard Parker

Spud Date 5/24/80 Date Completed 6/6/80 Total Depth 3,633' P.B.T.D.

Directional Deviation Oil and/or Gas Purchaser

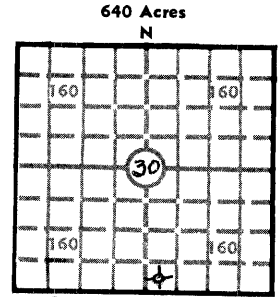

Elev.: Gr. _____
DF _____ KB 2,117'

CASING RECORD

Report of all strings set — surface, intermediate, production, etc.

Purpose of string	Size hole drilled	Size casing set (in O.D.)	Weight lbs/ft.	Setting depth	Type cement	Sacks	Type and percent additives
Surface	12 1/4"	8 5/8"	28#	286'	Common	180	3% C.C., 2% Gel

LINER RECORD

PERFORATION RECORD

Top, ft.	Bottom, ft.	Sacks cement	Shots per ft.	Size & type	Depth interval

TUBING RECORD

Size	Setting depth	Packer set at

ACID, FRACTURE, SHOT, CEMENT SQUEEZE RECORD

Amount and kind of material used	Depth interval treated

INITIAL PRODUCTION

Date of first production _____ Producing method (flowing, pumping, gas lift, etc.) _____

RATE OF PRODUCTION PER 24 HOURS

Oil	Gas	Water	Gas-oil ratio
bbis.	MCF	bbis.	CFPB

Disposition of gas (vented, used on lease or sold) _____ Producing interval (s) _____

RECEIVED
STATE CORPORATION COMMISSION
AUG - 5 1980
8 5 - 80
CONSERVATION DIVISION
Wichita, Kansas

INSTRUCTIONS: As provided in KCC Rule 82-2-125, within 90 days after completion of a well, one completed copy of this Drillers Log shall be transmitted to the State Geological Survey of Kansas, 4150 Monroe Street, Wichita, Kansas 67209. Copies of this form are available from the Conservation Division, State Corporation Commission, 245 No. Water, Wichita, Kansas 67202. Phone AC 316-522-2206. If confidential custody is desired, please note Rule 82-2-125. Drillers Logs will be on open file in the Oil and Gas Division, State Geological Survey of Kansas, Lawrence, Kansas 66044.

Operator **Frontier Oil Company** DESIGNATE TYPE OF COMP.: OIL, GAS, DRY HOLE, SWDW, ETC.: **Dry Hole**

Well No. **1** Lease Name **Garvert**

S **30** T **9S** R **17** ^E/_W

WELL LOG

Show all important zones of porosity and contents thereof; cored intervals, and all drill-stem tests, including depth interval tested, cushion used, time tool open, flowing and shut-in pressures, and recoveries. SHOW GEOLOGICAL MARKERS, LOGS RUN, OR OTHER DESCRIPTIVE INFORMATION.

FORMATION DESCRIPTION, CONTENTS, ETC.	TOP	BOTTOM	NAME	DEPTH
Shale	0	945		
Sand	945	1105		
Shale	1105	1393		
Anhydrite	1393	1432		
Shale	1432	2075		
Shale w/Lime Streaks	2075	2290		
Shale & Lime	2290	2707		
Lime & Shale	2707	2865		
Lime	2865	3633		

USE ADDITIONAL SHEETS, IF NECESSARY, TO COMPLETE WELL RECORD.

Date Received _____

Signature James B. Dittus

Title _____

Date 8-4-80