

SIDE ONE

STATE CORPORATION COMMISSION OF KANSAS  
OIL & GAS CONSERVATION DIVISION  
WELL COMPLETION OR RECOMPLETION FORM  
ACO-1 WELL HISTORY  
DESCRIPTION OF WELL AND LEASE

Operator: License # 6600  
Name Don Karst Well Service, Inc.  
Address 201 E. 29th  
City/State/Zip Hays, KS 67601

Purchaser Farmland Industries  
Coffeyville, KS 67337

Operator Contact Person Don Karst  
Phone (913) 483-3958

Contractor: License # 8241  
Name Emphasis Oil Operations

Wellsite Geologist Dave Shoemaker  
Phone

Designate Type of Completion  
 New Well  Re-Entry  Workover  
 Oil  SWD  Temp Abd  
 Gas  Inj  Delayed Comp.  
 Dry  Other (Core, Water Supply etc.)  
If **OWWO**: old well info as follows:  
Operator  
Well Name  
Comp. Date Old Total Depth

WELL HISTORY

Drilling Method:  
 Mud Rotary  Air Rotary  Cable  
2/9/86 2/27/86 3-20-86  
Spud Date Date Reached TD Completion Date  
3440 RTD  
Total Depth PBTD  
Amount of Surface Pipe Set and Cemented at 644 feet  
Multiple Stage Cementing Collar Used?  Yes  No  
If yes, show depth set feet  
If alternate 2 completion, cement circulated from feet depth to w/ SX cmt  
Cement Company Name  
Invoice #

API NO. 15-141-20.226-00-00  
County Osborne  
SE SE NW Sec 22 Twp 10 Rge 15 East  
SE SE NW Sec 22 Twp 10 Rge 15 West

2970 Ft North from Southeast Corner of Section  
2970 Ft West from Southeast Corner of Section  
(Note: Locate well in section plat below)

Lease Name Elliott Well # 1

Field Name Ruggles ext?

Producing Formation Kansas City & Toronto

Elevation: Ground 1792 KB 1797

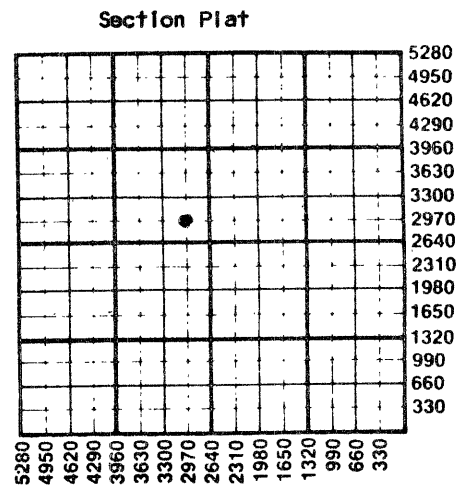

WATER SUPPLY INFORMATION

Disposition of Produced Water:  Disposal  
Docket #  Repressuring

Questions on this portion of the ACO-1 call:  
Water Resources Board (913) 296-3717  
Source of Water:  
Division of Water Resources Permit #  
 Groundwater Ft North from Southeast Corner (Well) Ft West from Southeast Corner of Sec Twp Rge East West  
 Surface Water 3300 Ft North from Southeast Corner (Stream, pond etc) 990 Ft West from Southeast Corner Sec 22 Twp 10 Rge 15 East West  
 Other (explain) (purchased from city, R.W.D. #)

INSTRUCTIONS: This form shall be completed in duplicate and filed with the Kansas Corporation Commission, 200 Colorado Derby Building, Wichita, Kansas 67202, within 90 days after completion or recompletion of any well. Rule 82-3-130 and 82-3-107 apply. Information on side two of this form will be held confidential for a period of 12 months if requested in writing and submitted with the form. See rule 82-3-107 for confidentiality in excess of 12 months. One copy of all wireline logs and drillers time log shall be attached with this form. Submit CP-4 form with all plugged wells. Submit CP-111 form with all temporarily abandoned wells.

All requirements of the statutes, rules and regulations promulgated to regulate the oil and gas industry have been fully complied with and the statements herein are complete and correct to the best of my knowledge.

Signature Donald D. Karst  
Title President Date 4-17-86

Subscribed and sworn to before me this 17 day of April 1986  
Notary Public Conne Lynn Anderson  
Date Commission Expires March 29, 1987

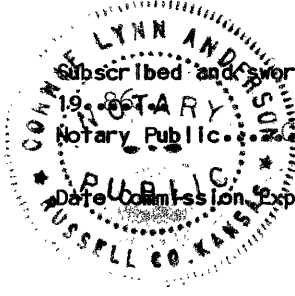

APR 21 1986  
4-21-86  
CONSERVATION DIVISION  
Wichita, Kansas

K.C.C. OFFICE USE ONLY  
F Letter of Confidentiality Attached  
C  Wireline Log Received  
C  Drillers Timelog Received  
Distribution  
 KCC  SWD/Rep  NGPA  
 KGS  Plug  Other  
(Specify)

Sec. 84  
Twp. 10  
Rge. 15  
W

SIDE TWO

Operator Name Don Karst Well Service, Inc. Lease Name Elliott Well # 1

Sec. 22 Twp. 10 Rge. 15  East  West County Osborne

WELL LOG

INSTRUCTIONS: Show important tops and base of formations penetrated. Detail all cores. Report all drill stem tests giving interval tested, time tool open and closed, flowing and shut-in pressures, whether shut-in pressure reached static level, hydrostatic pressures, bottom hole temperature, fluid recovery, and flow rates if gas to surface during test. Attach extra sheet if more space is needed. Attach copy of log.

Drill Stem Tests Taken  Yes  No  
 Samples Sent to Geological Survey  Yes  No  
 Cores Taken  Yes  No

Formation Description  
 Log  Sample

DST #1 2962-3020  
 Tool Open: 45-45-45-45  
 Rec: 480' Gas  
 125' Oil Cut Mud  
 FP: 75-92  
 FFP: 100-109  
 BHP: 369-361

| Name             | Top  | Bottom  |
|------------------|------|---------|
| Anhydrite        | 956  | (+841)  |
| Base Anhy        | 991  | (+806)  |
| Topeka           | 2661 | (-864)  |
| Heebner          | 2906 | (-1109) |
| Toronto          | 2928 | (-1131) |
| Douglas          | 2939 | (-1142) |
| LKC              | 2959 | (-1162) |
| Base KC          | 3220 | (-1423) |
| Conglomerate     | 3316 | (-1519) |
| Conglomerate Snd | 3326 | (-1529) |
| Arbuckle         | 3365 | (-1568) |
| RTD              | 3440 | (-1643) |
| LTD              | 3444 | (-1647) |

DST #2 3020-3070  
 Tool Open: 45-45-45-45  
 Rec: 475' Muddy water  
 FP: 126-192  
 FFP: 251-280  
 BHP: 402-394

| CASING RECORD <input type="checkbox"/> New <input type="checkbox"/> Used  |   |  |                |  |                |   |                            |
|---|---|--|----------------|--|----------------|---|----------------------------|
| Report all strings set-conductor, surface, intermediate, production, etc. |   |  |                |  |                |   |                            |
| Purpose of String   | Size Hole Drilled                           | Size Casing Set (in O.D.)  | Weight Lbs/Ft. | Setting Depth  | Type of Cement | #Sacks Used   | Type and Percent Additives |
| Surface   | 12-1/4                                      | 8-5/8  | 20             | 644  | 60/40POZ       | 280   | 3%cc, 2%gel                |
| Production  | 7-7/8                                       | 5-1/2  | 14             | 3436   | 60/40POZ       | 200   | 10% salt                   |
| PERFORATION RECORD  |   |  |                | Acid, Fracture, Shot, Cement Squeeze Record (Amount and Kind of Material Used) |                |   |                            |
| Shots Per Foot  | Specify Footage of Each Interval Perforated |  |                |  |                |   | Depth                      |
| 1   | 2989-3004, 3010 (Limited Entry)             |  |                | 1500 gal 15% NE  |                |   |                            |
|   |   |  |                | Retreated 4,000 gal 15% RE   |                |   |                            |
| 4   | 2986-90, 3002-05, 3009-12                   |  |                |  |                |   |                            |
| 4   | 2928-32                                     |  |                | 500 gal 15% NE   |                |   | 4'                         |
|   |   |  |                | Retreated 4,000 gal 15% RE   |                |   |                            |
| TUBING RECORD   |   | Size   | Set At         | Packer at  | Liner Run      | <input type="checkbox"/> Yes <input checked="" type="checkbox"/> No |                            |
|   |   | 2-3/8"   | 3401'          |  |                |   |                            |
| Date of First Production  |   | Producing Method   |                |  |                |   |                            |
| March 20, 1986  |   | <input type="checkbox"/> Flowing <input checked="" type="checkbox"/> Pumping <input type="checkbox"/> Gas Lift <input type="checkbox"/> Other (explain)..... |                |  |                |   |                            |
| Estimated Production Per 24 Hours   |   | Oil  | Gas            | Water  | Gas-Oil Ratio  | Gravity   |                            |
|   |   | 35   |                | 20   |                |   |                            |
|   |   | Bbls   | MCF            | Bbls   | CFPB           |   |                            |

METHOD OF COMPLETION

Production Interval

Disposition of gas:  Vented  Open Hole  Perforation  
 Sold  Other (Specify) .....  
 Used on Lease  Dually Completed  Commingled

2989 - 3010