

For KCC Use: 12-24-06
 Effective Date: 12-24-06
 District # 4
 SGA? Yes No

KANSAS CORPORATION COMMISSION
 OIL & GAS CONSERVATION DIVISION
NOTICE OF INTENT TO DRILL

Form C-1
 December 2002
 Form must be Typed
 Form must be Signed
 All blanks must be Filled

Must be approved by KCC five (5) days prior to commencing well

Expected Spud Date December 26 2006
 month day year

Spot 40' W of East
 SW SE NW Sec. 6 Twp. 14 S. R. 21 West
2310' feet from N / S Line of Section
1610' feet from E / W Line of Section

OPERATOR: License# 33554 ✓
 Name: K. & B. Norton Oil & Investments, L.L.C.
 Address: 510 W. 36th Street
 City/State/Zip: Hays, KS 67601-1508
 Contact Person: Ken Norton
 Phone: 785-628-3422

Is SECTION Regular Irregular?
 (Note: Locate well on the Section Plat on reverse side)

CONTRACTOR: License# 33575
 Name: W.W. Drilling, L.L.C.

County: Trego
 Lease Name: Deutscher Well #: 1
 Field Name: Cedar View East

Well Drilled For:	Well Class:	Type Equipment:
<input checked="" type="checkbox"/> Oil <input type="checkbox"/> Enh Rec	<input type="checkbox"/> Infield	<input type="checkbox"/> Mud Rotary ✓
<input type="checkbox"/> Gas <input type="checkbox"/> Storage	<input checked="" type="checkbox"/> Pool Ext.	<input type="checkbox"/> Air Rotary
<input type="checkbox"/> OWWO <input type="checkbox"/> Disposal	<input type="checkbox"/> Wildcat	<input type="checkbox"/> Cable
<input type="checkbox"/> Seismic; # of Holes	<input type="checkbox"/> Other	
<input type="checkbox"/> Other		

Is this a Prorated / Spaced Field? Yes No
 Target Formation(s): Cherokee Sand/Arbuckle

Nearest Lease or unit boundary: 330'
 Ground Surface Elevation: 2252' feet MSL

Water well within one-quarter mile: Yes No
 Public water supply well within one mile: Yes No

Depth to bottom of fresh water: 180
 Depth to bottom of usable water: 200

Surface Pipe by Alternate: 1 2
 Length of Surface Pipe Planned to be set: 250'

Length of Conductor Pipe required: N/A
 Projected Total Depth: 4130'

Formation at Total Depth: Arbuckle
 Water Source for Drilling Operations:
 Well Farm Pond Other _____

DWR Permit #: _____
 (Note: Apply for Permit with DWR)

Will Cores be taken? Yes No
 If Yes, proposed zone: _____

If OWWO: old well information as follows:
 Operator: _____
 Well Name: _____
 Original Completion Date: _____ Original Total Depth: _____

Directional, Deviated or Horizontal wellbore? Yes No

If Yes, true vertical depth: _____

Bottom Hole Location: _____

KCC DKT #: _____

AFFIDAVIT

The undersigned hereby affirms that the drilling, completion and eventual plugging of this well will comply with K.S.A. 55 et. seq.
 It is agreed that the following minimum requirements will be met:

1. Notify the appropriate district office **prior** to spudding of well;
2. A copy of the approved notice of intent to drill **shall be** posted on each drilling rig;
3. The minimum amount of surface pipe as specified below **shall be set** by circulating cement to the top; in all cases surface pipe **shall be set** through all unconsolidated materials plus a minimum of 20 feet into the underlying formation.
4. If the well is dry hole, an agreement between the operator and the district office on plug length and placement is necessary **prior to plugging**;
5. The appropriate district office will be notified before well is either plugged or production casing is cemented in;
6. If an ALTERNATE II COMPLETION, production pipe shall be cemented from below any usable water to surface within **120 days** of spud date. Or pursuant to Appendix "B" - Eastern Kansas surface casing order #133,891-C, which applies to the KCC District 3 area, alternate II cementing must be completed within 30 days of the spud date or the well shall be plugged. **In all cases, NOTIFY district office** prior to any cementing.

I hereby certify that the statements made herein are true and to the best of my knowledge and belief.

Date: 12/18/06 Signature of Operator or Agent: Kenneth A. Norton Title: President, K. & B. Norton Oil + Investment, L.L.C.

For KCC Use ONLY
 API # 15 - 195-22415-0000
 Conductor pipe required None feet
 Minimum surface pipe required 200 feet per Alt. **X2**
 Approved by: Put 12-19-06
 This authorization expires: 6-19-07
 (This authorization void if drilling not started within 6 months of approval date.)
 Spud date: _____ Agent: _____

Remember to:

- File Drill Pit Application (form CDP-1) with Intent to Drill;
- File Completion Form ACO-1 within 120 days of spud date;
- File acreage attribution plat according to field proration orders;
- Notify appropriate district office 48 hours prior to workover or re-entry;
- Submit plugging report (CP-4) after plugging is completed;
- Obtain written approval before disposing or injecting salt water.
- If this permit has expired (See: authorized expiration date) please check the box below and return to the address below.
 Well Not Drilled - Permit Expired
 Signature of Operator or Agent: _____
 Date: _____

Mail to: KCC - Conservation Division, 130 S. Market - Room 2078, Wichita, Kansas

RECEIVED

DEC 19 2006

CONSERVATION DIVISION
 WICHITA, KS

6
14
21

IN ALL CASES PLOT THE INTENDED WELL ON THE PLAT BELOW

Plat of acreage attributable to a well in a prorated or spaced field

If the intended well is in a prorated or spaced field, please fully complete this side of the form. If the intended well is in a prorated or spaced field complete the plat below showing that the well will be properly located in relationship to other wells producing from the common source of supply. Please show all the wells and within 1 mile of the boundaries of the proposed acreage attribution unit for gas wells and within 1/2 mile of the boundaries of the proposed acreage attribution unit for oil wells.

API No. 15 - 195-22415-0000
 Operator: K. & B. Norton Oil & Investments, L.L.C.
 Lease: Deutscher
 Well Number: 1
 Field: Cedar View East
 Number of Acres attributable to well: _____
 QTR / QTR / QTR of acreage: SW - SE - NW

Location of Well: County: Trego
2310' feet from N / S Line of Section
1610' feet from E / W Line of Section
 Sec. 6 Twp. 14 S. R. 21 East West
 Is Section: Regular or Irregular
 If Section is Irregular, locate well from nearest corner boundary.
 Section corner used: NE NW SE SW

PLAT

*(Show location of the well and shade attributable acreage for prorated or spaced wells.)
 (Show footage to the nearest lease or unit boundary line.)*

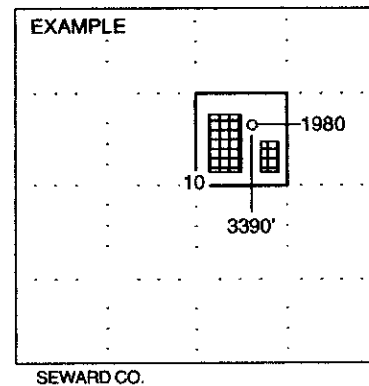
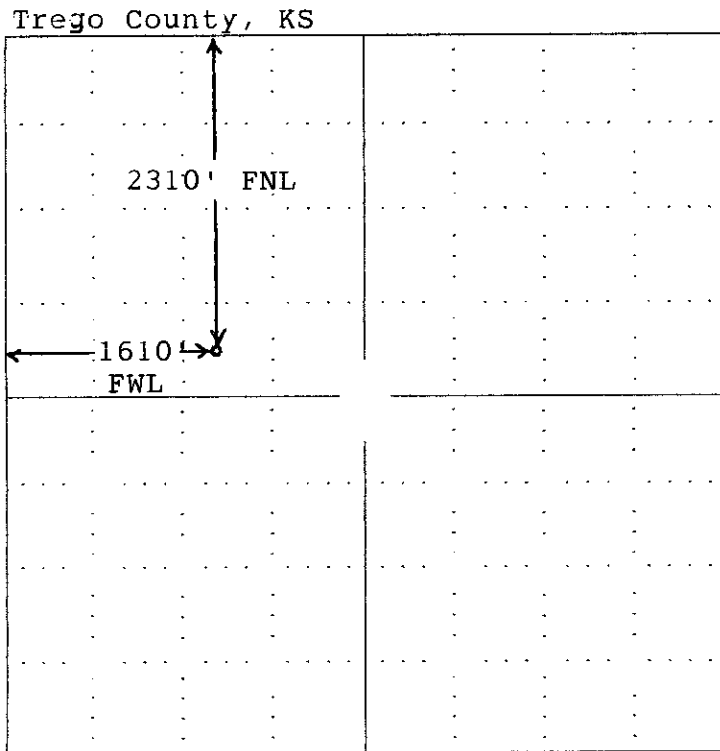

NOTE: In all cases locate the spot of the proposed drilling location.

In plotting the proposed location of the well, you must show:

1. The manner in which you are using the depicted plat by identifying section lines, i.e. 1 section, 1 section with 8 surrounding sections, 4 sections, etc.
2. The distance of the proposed drilling location from the section's south / north and east / west.
3. The distance to the nearest lease or unit boundary line.
4. If proposed location is located within a prorated or spaced field a certificate of acreage attribution plat must be attached (CG-8 for gas wells).

RECEIVED
 KANSAS CORPORATION COMMISSION

DEC 19 2006

CONSERVATION DIVISION
 WICHITA, KS

**KANSAS CORPORATION COMMISSION
OIL & GAS CONSERVATION DIVISION
APPLICATION FOR SURFACE PIT**

Form CDP-1
April 2004
Form must be Typed

Submit in Duplicate

Operator Name: K. & B. Norton Oil & Investments, L.L.C.		License Number: #33554
Operator Address: 510 W. 36th St.; Hays, KS 67601-1508		
Contact Person: Ken Norton		Phone Number: (785) 628 - 3422
Lease Name & Well No.: Deutscher #1		Pit Location (QQQQ): 60' E . SW . SE . NW
Type of Pit: <input type="checkbox"/> Emergency Pit <input type="checkbox"/> Burn Pit <input type="checkbox"/> Settling Pit <input checked="" type="checkbox"/> Drilling Pit <input type="checkbox"/> Workover Pit <input type="checkbox"/> Haul-Off Pit <small>(If WP Supply API No. or Year Drilled)</small>	Pit is: <input checked="" type="checkbox"/> Proposed <input type="checkbox"/> Existing If Existing, date constructed: _____ Pit capacity: Approx. 100 (bbls)	Sec. 6 Twp. 14 R. 21 <input type="checkbox"/> East <input checked="" type="checkbox"/> West 2310' Feet from <input checked="" type="checkbox"/> North / <input type="checkbox"/> South Line of Section 1710' Feet from <input type="checkbox"/> East / <input checked="" type="checkbox"/> West Line of Section Trego _____ County
Is the pit located in a Sensitive Ground Water Area? <input type="checkbox"/> Yes <input checked="" type="checkbox"/> No		Chloride concentration: <u>N/A</u> mg/l <small>(For Emergency Pits and Settling Pits only)</small>
Is the bottom below ground level? <input checked="" type="checkbox"/> Yes <input type="checkbox"/> No	Artificial Liner? <input checked="" type="checkbox"/> Yes <input type="checkbox"/> No	How is the pit lined if a plastic liner is not used? Fresh Water Pit will be lined (6 mil plastic), Drilling Pit will be Native Clay mixture.
Pit dimensions (all but working pits): <u>80</u> Length (feet) <u>20</u> Width (feet) _____ N/A: Steel Pits Depth from ground level to deepest point: <u>5</u> (feet)		
If the pit is lined give a brief description of the liner material, thickness and installation procedure. Native Clay		Describe procedures for periodic maintenance and determining liner integrity, including any special monitoring. The drilling crew will maintain a watch on the drilling pits, in addition the company pumper will monitor the pits on a daily basis to ensure quality and integrity of the pits.
Distance to nearest water well within one-mile of pit <u>NA</u> feet Depth of water well _____ feet		Depth to shallowest fresh water _____ feet. Source of information: _____ measured _____ well owner _____ electric log _____ KDWR
Emergency, Settling and Burn Pits ONLY: Producing Formation: _____ Number of producing wells on lease: _____ Barrels of fluid produced daily: _____ Does the slope from the tank battery allow all spilled fluids to flow into the pit? <input type="checkbox"/> Yes <input type="checkbox"/> No		Drilling, Workover and Haul-Off Pits ONLY: Type of material utilized in drilling/workover: <u>Fresh Water</u> Number of working pits to be utilized: <u>Two (2), Fresh Water, Drilling Pit</u> Abandonment procedure: <u>Extra materials will be disposed of as per KCC regulations, water will be allowed to evaporate, pits will be covered once they have dried and can be restored to original condition.</u> Drill pits must be closed within 365 days of spud date.
I hereby certify that the above statements are true and correct to the best of my knowledge and belief.		
<u>Dec 18/06</u> Date		<u>Kenneth A Norton</u> Signature of Applicant or Agent

15-195-20115-0000

KCC OFFICE USE ONLY			
Date Received: <u>12/19/06</u>	Permit Number: _____	Permit Date: <u>12/19/06</u>	Lease Inspection: <input type="checkbox"/> Yes <input checked="" type="checkbox"/> No

Mail to: KCC - Conservation Division, 130 S. Market - Room 2078, Wichita, Kansas 67202

RECEIVED
KANSAS CORPORATION COMMISSION
DEC 19 2006
CONSERVATION DIVISION
WICHITA, KS