

For KCC Use: 1-207
 Effective Date: _____
 District # _____
 SGA? Yes No

KANSAS CORPORATION COMMISSION
 OIL & GAS CONSERVATION DIVISION
NOTICE OF INTENT TO DRILL

Form C-1
 December 2002
Form must be Typed
Form must be Signed
All blanks must be Filled

Must be approved by KCC five (5) days prior to commencing well

Expected Spud Date January 10 2007
month day year

OPERATOR: License# 5144
 Name: Mull Drilling Company, Inc.
 Address: P.O. Box 2758
Wichita KS 67201-2758
 Contact Person: Mark Shreve
 Phone: 316-264-6366 Ext. 13

CONTRACTOR: License# 5929
 Name: Duke Drilling Co., Inc.

Well Drilled For:	Well Class:	Type Equipment:
<input checked="" type="checkbox"/> Oil	<input type="checkbox"/> Enh Rec	<input type="checkbox"/> Infield
<input type="checkbox"/> Gas	<input type="checkbox"/> Storage	<input type="checkbox"/> Pool Ext.
<input type="checkbox"/> OAWO	<input type="checkbox"/> Disposal	<input checked="" type="checkbox"/> Wildcat
<input type="checkbox"/> Seismic; # of Holes _____	<input type="checkbox"/> Other _____	<input type="checkbox"/> Cable
<input type="checkbox"/> Other _____		

If OWWO: old well information as follows:
 Operator: _____
 Well Name: _____
 Original Completion Date: _____ Original Total Depth: _____

Directional, Deviated or Horizontal wellbore? Yes No
 If Yes, true vertical depth: _____
 Bottom Hole Location: _____
 KCC DKT #: _____

Spot NW - SE - NW Sec. 15 Twp. 17 S. R. 28
 East
 West
1476 feet from N / S Line of Section
1722 feet from E / W Line of Section

Is SECTION Regular Irregular?
 (Note: Locate well on the Section Plat on reverse side)

County: Lane
 Lease Name: Borell Well #: 1-15
 Field Name: Wildcat

Is this a Prorated / Spaced Field? Yes No
 Target Formation(s): Lansing/KC, Marmaton, Cherokee
 Nearest Lease or unit boundary: 918'

Ground Surface Elevation: 2746.8 feet MSL
 Water well within one-quarter mile: Yes No
 Public water supply well within one mile: Yes No

Depth to bottom of fresh water: 180'
 Depth to bottom of usable water: 1350'
 Surface Pipe by Alternate: 1 2
 Length of Surface Pipe Planned to be set: 200'

Length of Conductor Pipe required: None
 Projected Total Depth: 4650'
 Formation at Total Depth: Mississippian

Water Source for Drilling Operations:
 Well Farm Pond Other
 DWR Permit #: Contractor will apply

(Note: Apply for Permit with DWR)
 Will Cores be taken? Yes No
 If Yes, proposed zone: _____

AFFIDAVIT

The undersigned hereby affirms that the drilling, completion and eventual plugging of this well will comply with K.S.A. 55 et. seq.
 It is agreed that the following minimum requirements will be met:

1. Notify the appropriate district office **prior** to spudding of well;
2. A copy of the approved notice of intent to drill **shall be** posted on each drilling rig;
3. The minimum amount of surface pipe as specified below **shall be set** by circulating cement to the top; in all cases surface pipe **shall be set** through all unconsolidated materials plus a minimum of 20 feet into the underlying formation.
4. If the well is dry hole, an agreement between the operator and the district office on plug length and placement is necessary **prior to plugging**;
5. The appropriate district office will be notified before well is either plugged or production casing is cemented in;
6. If an ALTERNATE II COMPLETION, production pipe shall be cemented from below any usable water to surface within **120 days** of spud date.
 Or pursuant to Appendix "B" - Eastern Kansas surface casing order #133,891-C, which applies to the KCC District 3 area, alternate II cementing must be completed within 30 days of the spud date or the well shall be plugged. **In all cases, NOTIFY district office** prior to any cementing.

I hereby certify that the statements made herein are true and to the best of my knowledge and belief.
 Date: 12/27/2006 Signature of Operator or Agent: Conie Morrison Title: Senior Geologist

For KCC Use ONLY
 API # 15 - 101-22001-00-00
 Conductor pipe required NONE feet
 Minimum surface pipe required 200 feet per Alt. 2
 Approved by: WJM 12-28-06
 This authorization expires: 6-28-07
 (This authorization void if drilling not started within 6 months of approval date.)
 Spud date: _____ Agent: _____

- Remember to:**
- File Drill Pit Application (form CDP-1) with Intent to Drill;
 - File Completion Form ACO-1 within 120 days of spud date;
 - File acreage attribution plat according to field proration orders;
 - Notify appropriate district office 48 hours prior to workover or re-entry;
 - Submit plugging report (CP-4) after plugging is completed;
 - Obtain written approval before disposing or injecting salt water.

If this permit has expired (See: authorized expiration date) please check the box below and return to the address below.
 Well Not Drilled - Permit Expired
 Signature of Operator or Agent: _____

RECEIVED
 KANSAS CORPORATION COMMISSION

Mail to: KCC - Conservation Division, 130 S. Market - Room 2078, Wichita, Kansas, 67202
 DEC 28 2006

CONSERVATION DIVISION
 WICHITA, KS

15
 17
 28W

IN ALL CASES PLOT THE INTENDED WELL ON THE PLAT BELOW

Plat of acreage attributable to a well in a prorated or spaced field

If the intended well is in a prorated or spaced field, please fully complete this side of the form. If the intended well is in a prorated or spaced field complete the plat below showing that the well will be properly located in relationship to other wells producing from the common source of supply. Please show all the wells and within 1 mile of the boundaries of the proposed acreage attribution unit for gas wells and within 1/2 mile of the boundaries of the proposed acreage attribution unit for oil wells.

API No. 15 - 101-22001-00-50
Operator: Mull Drilling Company, Inc.
Lease: Borell 1-15
Well Number: 1-15
Field: Wildcat

Number of Acres attributable to well: 40
QTR / QTR / QTR of acreage: NW - SE - NW

Location of Well: County: Lane
1476 feet from N / S Line of Section
1722 feet from E / W Line of Section
Sec. 15 Twp. 17 S. R. 28 East West

Is Section: Regular or Irregular

If Section Is Irregular, locate well from nearest corner boundary.
Section corner used: NE NW SE SW

PLAT

*(Show location of the well and shade attributable acreage for prorated or spaced wells.)
(Show footage to the nearest lease or unit boundary line.)*

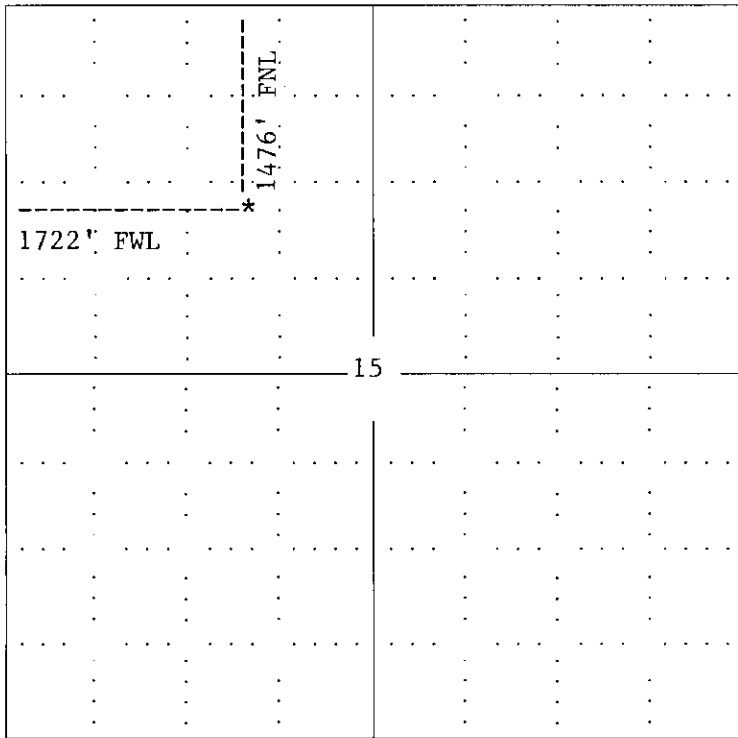

NOTE: In all cases locate the spot of the proposed drilling location.

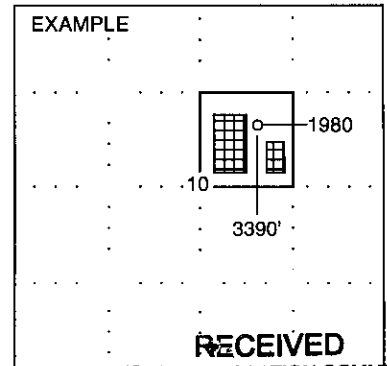

RECEIVED
SEWARD COUNTY KANSAS CORPORATION COMMISSION

DEC 28 2006

**CONSERVATION DIVISION
WICHITA, KS**

In plotting the proposed location of the well, you must show:

1. The manner in which you are using the depicted plat by identifying section lines, i.e. 1 section, 1 section with 8 surrounding sections, 4 sections, etc.
2. The distance of the proposed drilling location from the section's south / north and east / west.
3. The distance to the nearest lease or unit boundary line.
4. If proposed location is located within a prorated or spaced field a certificate of acreage attribution plat must be attached: (CO-7 for oil wells; CG-8 for gas wells).

**KANSAS CORPORATION COMMISSION
OIL & GAS CONSERVATION DIVISION
APPLICATION FOR SURFACE PIT**

Form CDP-1
April 2004
Form must be Typed

Submit in Duplicate

Operator Name: Mull Drilling Company, Inc.		License Number: 5144
Operator Address: P.O. Box 2758 Wichita KS 67201-2758		
Contact Person: Mark Shreve		Phone Number: (316) 264 - 6366
Lease Name & Well No.: Borell #1-15		Pit Location (QQQQ): NE - NW - SE - NW
Type of Pit: <input type="checkbox"/> Emergency Pit <input type="checkbox"/> Burn Pit <input type="checkbox"/> Settling Pit <input checked="" type="checkbox"/> Drilling Pit <input type="checkbox"/> Workover Pit <input type="checkbox"/> Haul-Off Pit <small>(If WP Supply API No. or Year Drilled)</small>	Pit is: <input checked="" type="checkbox"/> Proposed <input type="checkbox"/> Existing If Existing, date constructed: _____ Pit capacity: _____ (bbls)	Sec. 15 Twp. 17S R. 28 <input type="checkbox"/> East <input checked="" type="checkbox"/> West 1476 Feet from <input checked="" type="checkbox"/> North / <input type="checkbox"/> South Line of Section 1722 Feet from <input type="checkbox"/> East / <input checked="" type="checkbox"/> West Line of Section Lane _____ County _____
Is the pit located in a Sensitive Ground Water Area? <input type="checkbox"/> Yes <input checked="" type="checkbox"/> No		Chloride concentration: _____ mg/l <small>(For Emergency Pits and Settling Pits only)</small>
Is the bottom below ground level? <input type="checkbox"/> Yes <input checked="" type="checkbox"/> No	Artificial Liner? <input type="checkbox"/> Yes <input checked="" type="checkbox"/> No	How is the pit lined if a plastic liner is not used? Will use steel pits
Pit dimensions (all but working pits): _____ Length (feet) _____ Width (feet) X N/A: Steel Pits Depth from ground level to deepest point: _____ (feet)		
If the pit is lined give a brief description of the liner material, thickness and installation procedure.		Describe procedures for periodic maintenance and determining liner integrity, including any special monitoring.
Distance to nearest water well within one-mile of pit 3393 feet Depth of water well 148 feet	Depth to shallowest fresh water 108 feet. 6 Source of information: JR-HGS _____ measured _____ well owner _____ electric log _____ KDWR	
Emergency, Settling and Burn Pits ONLY: Producing Formation: _____ Number of producing wells on lease: _____ Barrels of fluid produced daily: _____ Does the slope from the tank battery allow all spilled fluids to flow into the pit? <input type="checkbox"/> Yes <input type="checkbox"/> No	Drilling, Workover and Haul-Off Pits ONLY: Type of material utilized in drilling/workover: Bentonite Sealer/Mud Number of working pits to be utilized: 3 Abandonment procedure: Will haul fluids offsite. _____ Drill pits must be closed within 365 days of spud date.	
I hereby certify that the above statements are true and correct to the best of my knowledge and belief.		
12/27/06 Date	 Signature of Applicant or Agent	RECEIVED KANSAS CORPORATION COMMISSION DEC 28 2006 CONSERVATION DIVISION WICHITA, KS
KCC OFFICE USE ONLY		
Date Received: 12/28/06 Permit Number: _____ Permit Date: 12/28/06 Lease Inspection: <input type="checkbox"/> Yes <input checked="" type="checkbox"/> No	Per Oper: Steel Pits	

Mail to: KCC - Conservation Division, 130 S. Market - Room 2078, Wichita, Kansas 67202